

본 제품의 규격은 품질개선을 위하여 예고없이 변경될 수 있으므로 제품구입시 문의 바랍니다.
Since specifications of products can be changed without inform in order to improve the quality, please call us to confirm them.

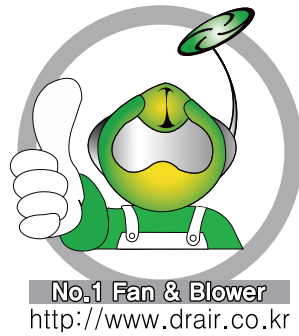

자연과 환경, 그리고 사람을 생각하는 브랜드

DR 환기송풍기 CENTRIFUGAL FAN DR-SFD series

May 2016 (Rev.00)



 **대륜산업주식회사**
Dae Ryun Ind. Co., Ltd.

본사/공장 565-902 전라북도 완주군 봉동읍 완주산단7로115 (둔산리 926-3번지)
TEL (063)262-5100 FAX (063)262-5107
서울사업소 445-862 경기도 화성시 마도면 마도로 608 (청원리 32-1번지)
TEL (031)8047-5161 FAX (031)8047-5163
고객서비스센터 1644-5153



 **대륜산업주식회사**
Dae Ryun Ind. Co., Ltd.

INDEX

1. Index, AMCA Seal Information	----- 2 PAGE
2. Product Characteristic	----- 3 PAGE
3. Overall Dimensions	----- 4 PAGE
4. Performance Curves and Sound Data	----- 5 ~ 11 PAGE



대륜산업(주)가 획득한 DR-SFD SERIES SIROCCO FAN의 AMCA seal에 대한 내용입니다. 등급표시는 AMCA 211과 AMCA 311에 의거 테스트 및 절차에 따른 것이며, AMCA 보증프로그램의 요구사항과 일치합니다.

"Dae-Ryun Ind. Co., Ltd." certifies that the "DR-SFD" Sirocco Fans shown herein are licensed to bear the AMCA Seal. The ratings shown are based on tests and procedures performed in accordance with AMCA Publication 211 and AMCA Publication 311 and comply with the requirements of the AMCA Certified Ratings Program."



형상

IMPELLER FORWARD CURVE TYPE(전곡형)

특징

- 익 현장이 짧으며 날개폭이 넓고 익수가 많음
- 같은 주속도의 다른 FAN보다 풍량이 많음
- 풍압 60mmAq 이하의 저압에서 저속으로 정속운전이 가능함
- 특성곡선상의 정압곡선이 다른 원심형 송풍기에 비하여 완만하기 때문에 풍량변동에 대한 풍압의 변화가 적고, 따라서 여러개의 급·배기할 경우, 그 일부를 패쇄하여도 큰 영향을 받지 않음
- 일정회전수 아래에서 소요동력이 풍량의 증가에 따라서 점차 증가됨
- 다른 원심형 송풍기에 비하여 가격이 저렴함

※ KS 인증업체 <KS B 6326-편 흡입식045(450)>

용도

- 일 반 급·배기, 송풍 난방 냉방, 건조용등 그 사용범위가 매우 넓음

송풍기 회전방향 (흡입구 측 기준으로 바라본 토출구 위치)

A	B	C	D	E	F	G	H
1-W	2-Z	3-W	4-Z	5-W	5-Z	6-W	6-Z

송풍기의 모델명 읽는 방법 예시

모 델 명 : DR - SF #3 D D

DR - 대륜산업(주)의 약자
SF - 베어링 지지방법 (D:양지형 / S:편지형)
#3 - Single Suction(D:양흡입형 / S:편흡입형)
D - Impeller의 외경등을 6inch로 나눈값 (Fan No.)
D - Fan 기종 (Sirocco Fan)
D - 제작회사 표기 (대륜산업의 약자)

SIROCCO FAN의 특징

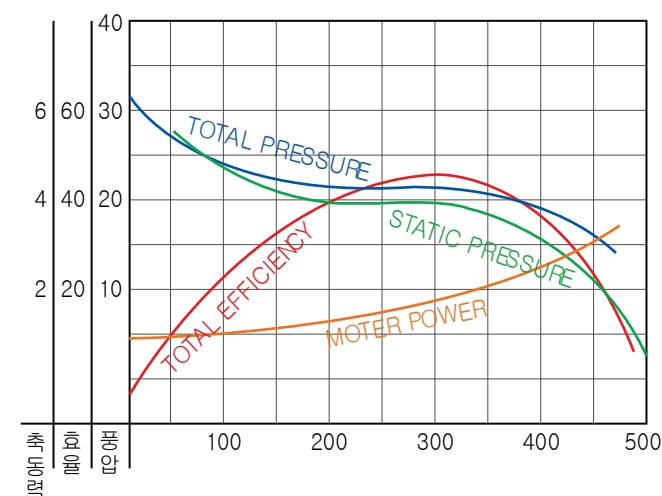

- 압력곡선은 풍량 0"의 첫점에서 최고의 압력을 나타내고 풍량증가와 함께 압력이 감소하여 곡률을 형성하지만 더욱 풍량이 증가하면 압력이 상승해서 산을 이루며 차차 압력이 저감되는 형이 됨
그러나 축류 송풍기보다 많이 누워있으므로 풍량의 변화에 대하여 풍압의 변화가 적어 병렬 운전에는 부적합함
- 효율은 대체적으로 낮은편임
- 동력곡선은 풍량 0"에서 최저를 나타내고 풍량증가와 함께 급속히 증가하는 형상을 가지므로 전동기 출력선정에 여유를 가질 필요가 있음

벨트 구동형 시로코팬 (양흡입)

Belt driven Sirocco Fan

▶ 양흡입 시로코팬 규격표

외형도

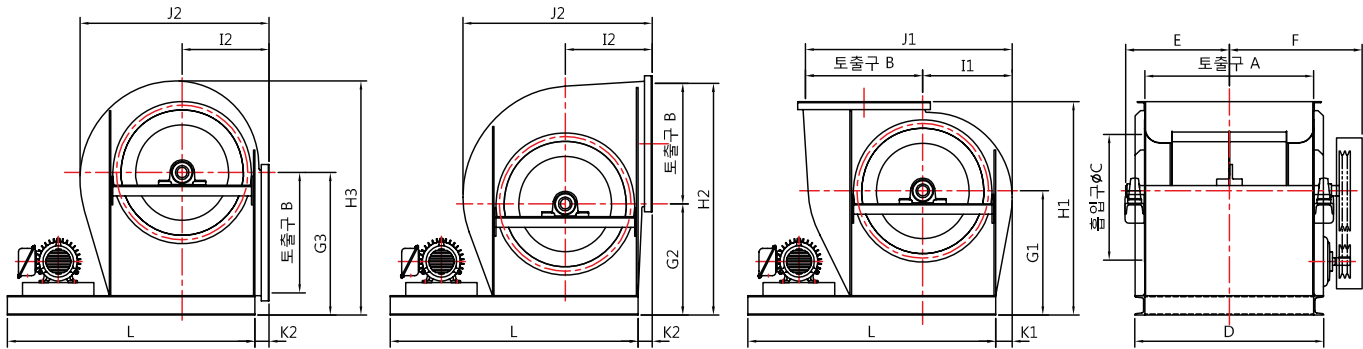

규격표

(단위:mm)

MODEL	토출구		흡입구	FAN 베이스 폭	FAN 폭		센터높이			FAN 높이			FAN 상부 길이				FAN 베이스 길이 (모터 용량에 따라 길이가 변경됨)		
	A	B	C	D	E	F	G1	G2	G3	H1	H2	H3	I1	I2	J1	J2	K1	K2	L
DR-SF#2DD	440	305	320	520	310	390	335	305	380	575	610	620	240	240	545	510	40	40	910
DR-SF#2.5DD	550	380	400	630	365	445	410	370	465	685	750	760	295	275	675	610	45	25	990
DR-SF#3DD	660	460	480	740	430	540	475	425	545	815	885	895	350	340	810	740	65	55	1070
DR-SF#3.5DD	770	530	560	850	485	595	545	485	615	935	1015	1025	410	390	940	860	75	55	1270
DR-SF#4DD	880	610	640	960	540	670	610	540	695	1055	1150	1160	465	445	1075	980	85	65	1360
DR-SF#4.5DD	990	690	720	1070	595	735	680	600	775	1175	1290	1300	525	495	1215	1100	95	65	1510
DR-SF#5DD	1100	760	800	1180	650	800	745	655	845	1295	1415	1425	580	550	1340	1220	100	70	1610

*상기 자료는 품질관리를 위해 예고없이 변경될 수 있습니다.



벨트 구동형 시로코팬 (양흡입)

Belt driven Sirocco Fan

성능곡선

Dae-Ryun Ind. Co., LTD									DR-SFD Series				Model :		DR-SF#2DD					
Wheel DIA. : 300 mm									Outlet Dim : 440 X 305 mm				Outlet Area : 0.134 m ²							
Det.	N	Pt	Ps	Q	H	EtaT	EtaS	LwiA	Det.	N	Pt	Ps	Q	H	EtaT	EtaS	LwiA			
	[r/min]	[Pa]	[Pa]	m ³ /min	[kW]	[%]	[%]	[dB]		[r/min]	[Pa]	[Pa]	m ³ /min	[kW]	[%]	[%]	[dB]			
1	700	100	32	84	0.54	25.9	8.5	83	1	800	131	42	96	0.80	25.9	8.5	86			
2		127	73	74	0.46	34.1	20.0	81	2		166	95	85	0.68	34.1	20.0	84			
3		146	103	65	0.39	40.6	29.3	79	3		190	135	74	0.58	40.6	29.3	82			
4		156	123	56	0.33	44.5	35.8	76	4		203	161	64	0.49	44.5	35.8	79			
5		160	137	47	0.27	46.2	40.2	73	5		209	178	53	0.40	46.2	40.2	77			
6		143	128	37	0.22	40.0	36.4	75	6		187	167	42	0.33	40.0	36.4	78			
1	900	165	53	108	1.14	25.9	8.5	89	1	1000	204	66	120	1.56	25.9	8.5	94			
2		210	121	96	0.97	34.1	20.0	86	2		259	149	106	1.33	34.1	20.0	92			
3		241	171	84	0.82	40.6	29.3	84	3		297	211	93	1.13	40.6	29.3	91			
4		257	204	73	0.70	44.5	35.8	82	4		318	251	81	0.95	44.5	35.8	88			
5		264	226	60	0.57	46.2	40.2	79	5		326	279	67	0.78	46.2	40.2	86			
6		237	211	47	0.47	40.0	36.4	81	6		292	261	52	0.64	40.0	36.4	87			
1	1100	247	80	132	2.08	25.9	8.5	96	1	1200	294	95	144	2.70	25.9	8.5	98			
2		314	180	117	1.77	34.1	20.0	94	2		373	215	128	2.30	34.1	20.0	95			
3		360	255	102	1.50	40.6	29.3	92	3		428	304	112	1.94	40.6	29.3	94			
4		385	304	89	1.27	44.5	35.8	90	4		458	362	97	1.64	44.5	35.8	91			
5		395	337	74	1.04	46.2	40.2	88	5		470	401	80	1.35	46.2	40.2	89			
6		353	316	58	0.85	40.0	36.4	89	6		421	376	63	1.10	40.0	36.4	91			
1	1300	345	112	156	3.43	25.9	8.5	99	1	1400	400	129	168	4.28	25.9	8.5	101			
2		438	252	138	2.92	34.1	20.0	97	2		508	292	149	3.65	34.1	20.0	98			
3		502	356	121	2.47	40.6	29.3	95	3		583	413	130	3.08	40.6	29.3	97			
4		537	425	105	2.09	44.5	35.8	93	4		623	492	113	2.61	44.5	35.8	95			
5		552	471	87	1.72	46.2	40.2	91	5		640	546	94	2.14	46.2	40.2	93			
6		494	441	68	1.39	40.0	36.4	92	6		572	512	74	1.74	40.0	36.4	94			
1	1500	459	148	180	5.26	25.9	8.5	102	1	1600	523	169	192	6.38	25.9	8.5	104			
2		583	335	160	4.49	34.1	20.0	100	2		664	382	170	5.44	34.1	20.0	101			
3		669	475	140	3.79	40.6	29.3	98	3		761	540	149	4.60	40.6	29.3	100			
4		715	565	121	3.20	44.5	35.8	96	4		814	643	129	3.89	44.5	35.8	98			
5		735	627	101	2.63	46.2	40.2	94	5		836	714	107	3.20	46.2	40.2	96			
6		657	587	79	2.14	40.0	36.4	95	6		748	668	84	2.59	40.0	36.4	97			

- The A-Weighted sound rating shown have been calculated per AMCA Standard 301.
- Value shown are for inlet LwiA sound power levels for installation type B - free inlet, ducted outlet.
- Performance certified is for installation type B - free inlet, ducted outlet.
- Performance ratings do not include the effects of apputenances(accessories), Power rating Kw does not include transmission losses

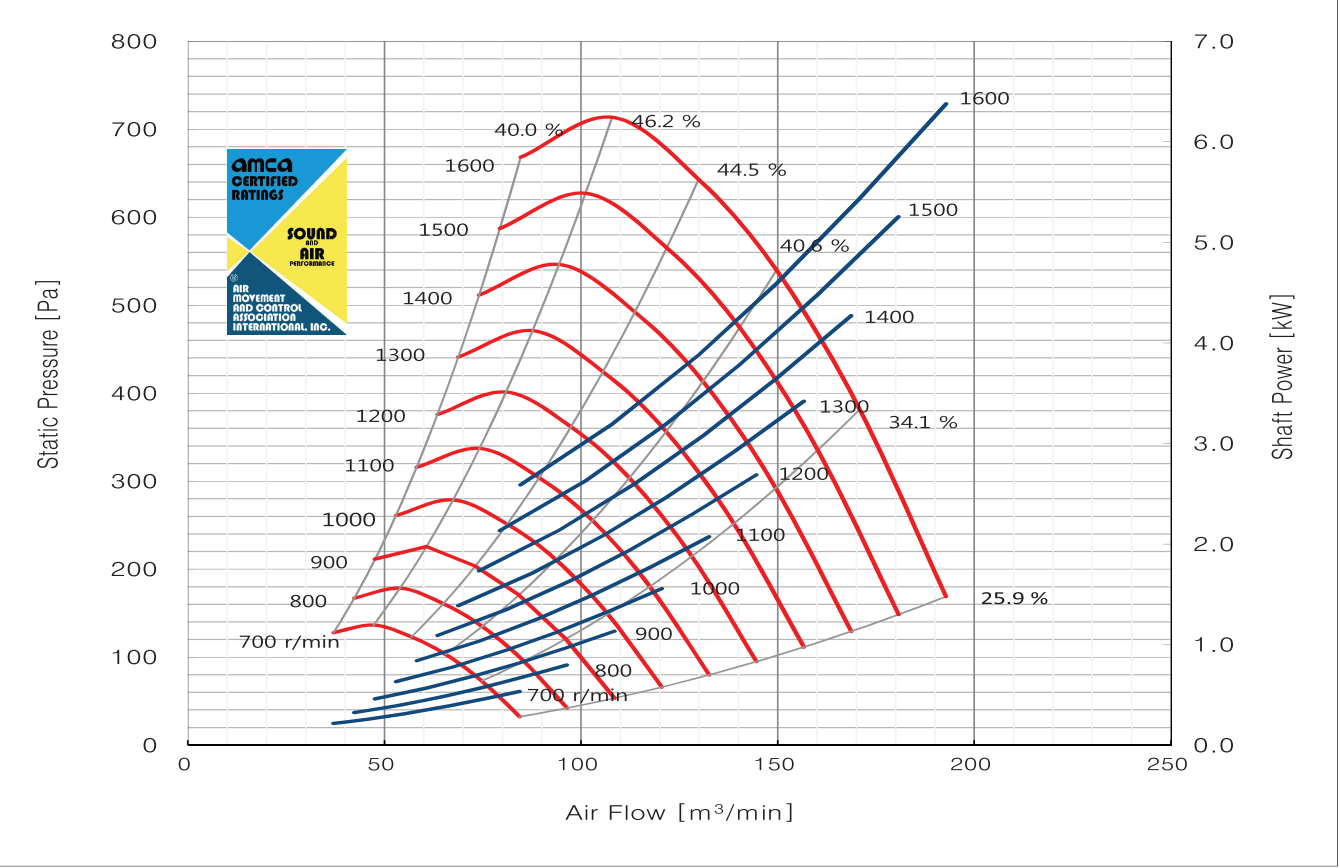

*상기 자료는 품질관리를 위해 예고없이 변경될 수 있습니다.

벨트 구동형 시로코팬 (양흡입)

Belt driven Sirocco Fan

성능곡선

Dae-Ryun Ind. Co., LTD

DR-SFD Series

Model : DR-SF#2.5DD

Wheel DIA. : 375 mm

Outlet Dim : 550 X 380 mm

Outlet Area : 0.21 m²

Det.	N [r/min]	Pt [Pa]	Ps [Pa]	Q m ³ /min	H [kW]	EtaT [%]	EtaS [%]	LwiA [dB]	Det.	N [r/min]	Pt [Pa]	Ps [Pa]	Q m ³ /min	H [kW]	EtaT [%]	EtaS [%]	LwiA [dB]
1	550	96	31	129	0.80	25.9	8.5	85	1	630	127	41	148	1.19	25.9	8.5	88
2		123	70	114	0.68	34.1	20.0	82	2		161	92	131	1.02	34.1	20.0	85
3		140	100	100	0.57	40.6	29.3	81	3		184	131	115	0.86	40.6	29.3	83
4		150	119	87	0.49	44.5	35.8	78	4		197	156	99	0.73	44.5	35.8	81
5		154	132	72	0.40	46.2	40.2	75	5		202	173	82	0.60	46.2	40.2	78
6		138	123	56	0.33	40.0	36.4	77	6		181	162	65	0.49	40.0	36.4	80
1	710	161	52	167	1.71	25.9	8.5	91	1	790	199	64	185	2.35	25.9	8.5	93
2		204	117	148	1.46	34.1	20.0	88	2		253	145	164	2.00	34.1	20.0	90
3		234	166	129	1.23	40.6	29.3	86	3		290	206	144	1.69	40.6	29.3	88
4		250	198	112	1.04	44.5	35.8	83	4		310	245	125	1.43	44.5	35.8	86
5		257	220	93	0.86	46.2	40.2	81	5		318	272	103	1.18	46.2	40.2	83
6		230	206	73	0.70	40.0	36.4	82	6		285	255	81	0.96	40.0	36.4	85
1	870	241	78	204	3.13	25.9	8.5	95	1	950	288	93	223	4.08	25.9	8.5	97
2		307	176	181	2.67	34.1	20.0	92	2		366	210	198	3.48	34.1	20.0	94
3		352	249	158	2.26	40.6	29.3	90	3		419	297	173	2.94	40.6	29.3	92
4		376	297	137	1.91	44.5	35.8	88	4		448	354	150	2.49	44.5	35.8	90
5		386	330	114	1.57	46.2	40.2	85	5		460	393	125	2.04	46.2	40.2	88
6		345	309	89	1.28	40.0	36.4	87	6		412	368	98	1.66	40.0	36.4	89
1	1030	338	109	242	5.20	25.9	8.5	102	1	1110	393	127	261	6.50	25.9	8.5	103
2		430	247	214	4.43	34.1	20.0	99	2		499	287	231	5.55	34.1	20.0	101
3		493	350	188	3.74	40.6	29.3	98	3		572	406	202	4.68	40.6	29.3	99
4		527	416	163	3.17	44.5	35.8	95	4		612	484	175	3.96	44.5	35.8	97
5		541	462	135	2.60	46.2	40.2	93	5		629	537	146	3.26	46.2	40.2	94
6		484	433	106	2.11	40.0	36.4	94	6		562	503	114	2.64	40.0	36.4	96
1	1190	452	146	279	8.01	25.9	8.5	104	1	1270	514	166	298	9.74	25.9	8.5	106
2		574	330	248	6.83	34.1	20.0	102	2		653	376	264	8.31	34.1	20.0	103
3		658	467	217	5.77	40.6	29.3	101	3		749	532	231	7.01	40.6	29.3	102
4		703	556	188	4.88	44.5	35.8	98	4		801	633	201	5.93	44.5	35.8	99
5		722	617	156	4.01	46.2	40.2	96	5		823	703	167	4.87	46.2	40.2	97
6		646	578	122	3.26	40.0	36.4	97	6		736	658	131	3.96	40.0	36.4	99

- The A-Weighted sound rating shown have been calculated per AMCA Standard 301
- Value shown are for inlet LwiA sound power levels for installation type B - free inlet, ducted outlet.
- Performance certified is for installation type B - free inlet, ducted outlet.
- Performance ratings do not include the effects of apputenances(accessories), Power rating Kw does not include transmission losses

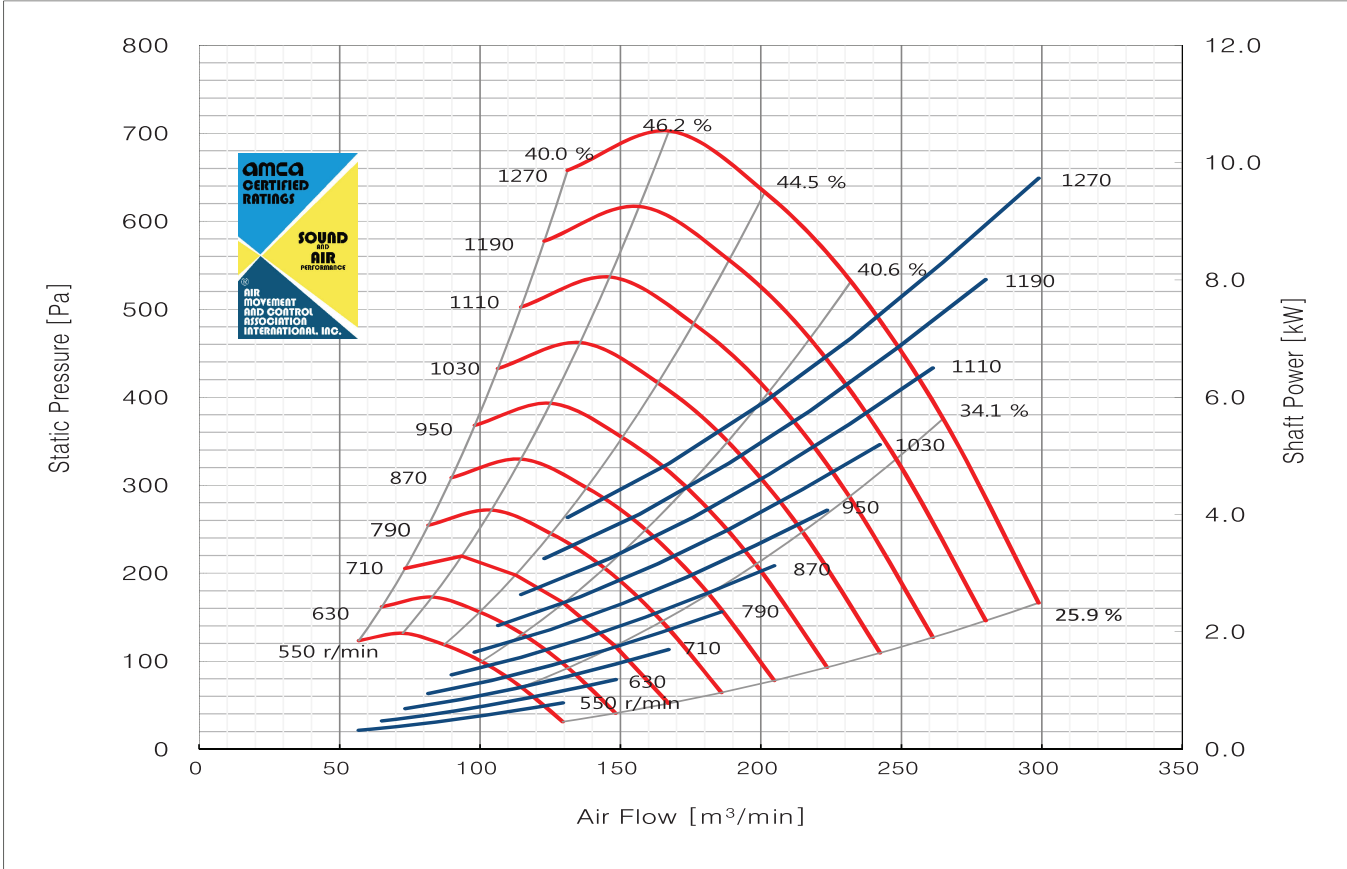

*상기 자료는 품질관리를 위해 예고없이 변경될 수 있습니다.



벨트 구동형 시로코팬 (양흡입)

Belt driven Sirocco Fan

성능곡선

Dae-Ryun Ind. Co., LTD

DR-SFD Series

Model : DR-SF#3DD

Wheel DIA. : 450 mm

Outlet Dim : 660 X 460 mm

Outlet Area : 0.302 m²

Det.	N [r/min]	Pt [Pa]	Ps [Pa]	Q m ³ /min	H [kW]	EtaT [%]	EtaS [%]	LwiA [dB]	Det.	N [r/min]	Pt [Pa]	Ps [Pa]	Q m ³ /min	H [kW]	EtaT [%]	EtaS [%]	LwiA [dB]
1	450	150	88	180	0.95	46.9	28.2	83	1	520	200	118	208	1.46	46.9	28.2	86
2		163	113	160	0.80	53.8	38.1	81	2		217	151	185	1.23	53.8	38.1	85
3		169	130	141	0.68	58.3	45.7	81	3		226	174	163	1.04	58.3	45.7	84
4		170	141	120	0.55	61.0	51.5	81	4		227	188	138	0.85	61.0	51.5	83
5		161	140	100	0.45	58.8	52.0	80	5		214	186	116	0.70	58.8	52.0	83
6		143	129	81	0.38	51.2	46.8	81	6		191	172	93	0.58	51.2	46.8	84
1	590	257	152	236	2.13	46.9	28.2	89	1	660	322	190	264	2.97	46.9	28.2	92
2		280	195	210	1.79	53.8	38.1	87	2		350	244	235	2.51	53.8	38.1	90
3		291	224	185	1.52	58.3	45.7	87	3		365	281	207	2.13	58.3	45.7	89
4		292	243	157	1.24	61.0	51.5	87	4		366	304	176	1.73	61.0	51.5	89
5		276	240	131	1.02	58.8	52.0	86	5		345	300	147	1.42	58.8	52.0	88
6		246	221	106	0.84	51.2	46.8	87	6		307	276	119	1.18	51.2	46.8	89
1	730	394	232	292	4.02	46.9	28.2	96	1	800	473	279	320	5.29	46.9	28.2	98
2		428	298	260	3.40	53.8	38.1	95	2		514	358	285	4.47	53.8	38.1	97
3		446	343	229	2.88	58.3	45.7	95	3		536	412	251	3.78	58.3	45.7	97
4		448	371	194	2.34	61.0	51.5	95	4		537	446	213	3.08	61.0	51.5	97
5		423	367	162	1.92	58.8	52.0	94	5		507	441	178	2.53	58.8	52.0	96
6		376	338	131	1.59	51.2	46.8	95	6		452	406	144	2.09	51.2	46.8	97
1	870	559	330	348	6.81	46.9	28.2	100	1	940	653	385	376	8.58	46.9	28.2	102
2		608	423	310	5.74	53.8	38.1	99	2		710	494	335	7.24	53.8	38.1	100
3		633	488	273	4.86	58.3	45.7	98	3		740	569	295	6.13	58.3	45.7	100
4		636	527	232	3.96	61.0	51.5	98	4		742	616	250	5.00	61.0	51.5	100
5		600	522	194	3.25	58.8	52.0	98	5		701	609	209	4.10	58.8	52.0	99
6		534	480	157	2.69	51.2	46.8	98	6		624	561	169	3.39	51.2	46.8	100
1	1010	753	444	404	10.64	46.9	28.2	103	1	1080	861	508	432	13.01	46.9	28.2	105
2		819	571	360	8.98	53.8	38.1	102	2		937	652	385	10.98	53.8	38.1	103
3		854	657	317	7.61	58.3	45.7	101	3		976	752	339	9.30	58.3	45.7	102
4		857	711	269	6.20	61.0	51.5	101	4		980	813	288	7.57	61.0	51.5	102
5		809	703	225	5.08	58.8	52.0	100	5		925	804	241	6.21	58.8	52.0	101
6		720	647	182	4.20	51.2	46.8	101	6		823	740	195	5.14	51.2	46.8	102

- The A-Weighted sound rating shown have been calculated per AMCA Standard 301
- Value shown are for inlet LwiA sound power levels for installation type B - free inlet, ducted outlet.
- Performance certified is for installation type B - free inlet, ducted outlet.
- Performance ratings do not include the effects of apputenances(accessories), Power rating Kw does not include transmission losses

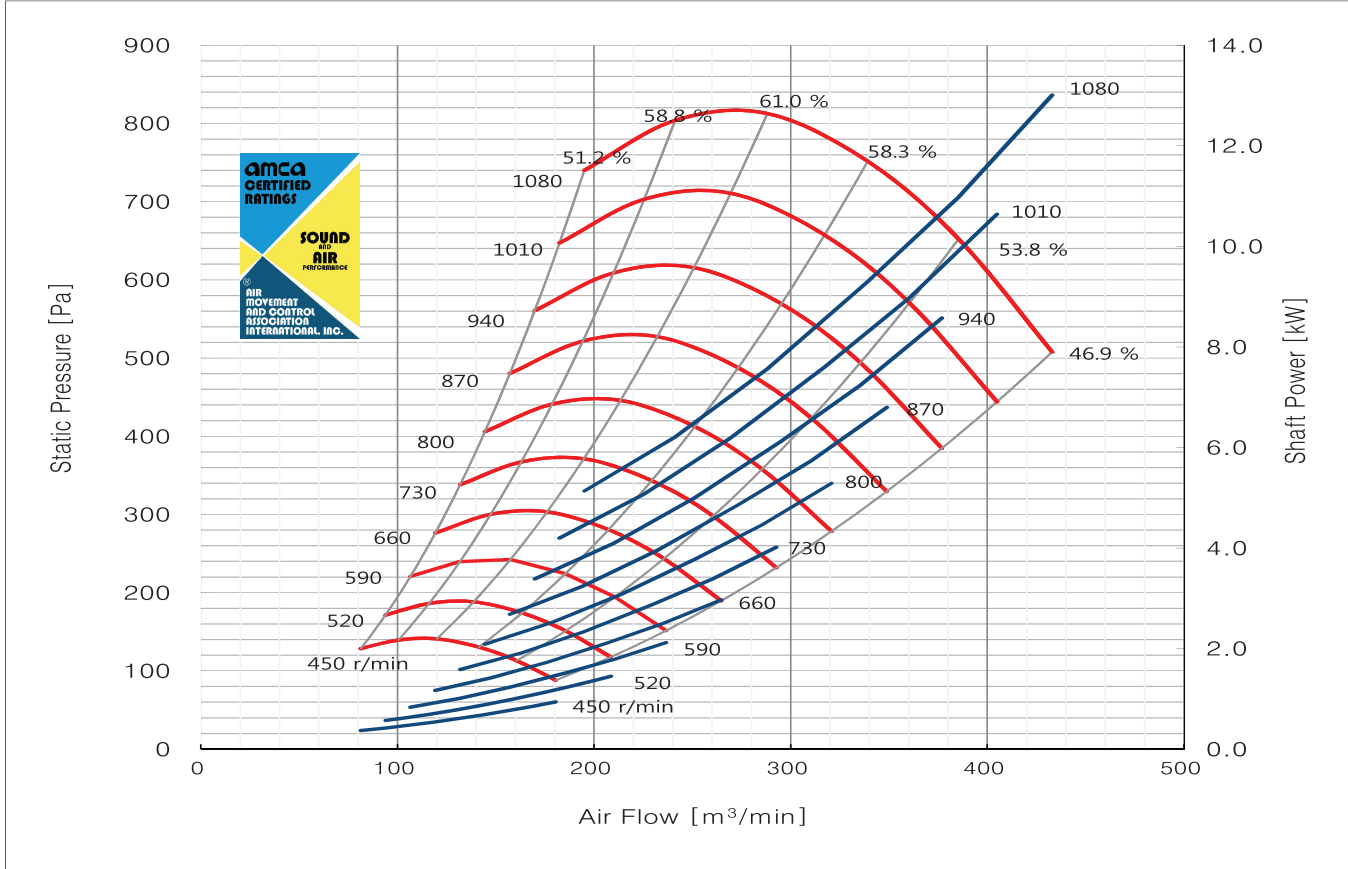

*상기 자료는 품질관리를 위해 예고없이 변경될 수 있습니다.

벨트 구동형 시로코팬 (양흡입)

Belt driven Sirocco Fan

성능곡선

Dae-Ryun Ind. Co., LTD

DR-SFD Series

Model : DR-SF#3.5DD

Wheel DIA. : 525 mm

Outlet Dim : 770 X 535 mm

Outlet Area : 0.411 m²

Det.	N [r/min]	Pt [Pa]	Ps [Pa]	Q m ³ /min	H [kW]	EtaT [%]	EtaS [%]	LwiA [dB]	Det.	N [r/min]	Pt [Pa]	Ps [Pa]	Q m ³ /min	H [kW]	EtaT [%]	EtaS [%]	LwiA [dB]
1	420	177	105	267	1.66	46.9	28.2	86	1	480	232	137	305	2.47	46.9	28.2	89
2		193	134	237	1.40	53.8	38.1	85	2		252	175	271	2.09	53.8	38.1	88
3		201	155	209	1.19	58.3	45.7	84	3		262	202	239	1.77	58.3	45.7	87
4		202	167	177	0.97	61.0	51.5	83	4		263	219	203	1.44	61.0	51.5	87
5		190	165	148	0.79	58.8	52.0	83	5		249	216	170	1.18	58.8	52.0	86
6		169	152	120	0.66	51.2	46.8	84	6		221	199	137	0.98	51.2	46.8	87
1	540	293	173	343	3.52	46.9	28.2	92	1	600	362	213	381	4.83	46.9	28.2	94
2		319	222	305	2.97	53.8	38.1	90	2		394	274	339	4.07	53.8	38.1	93
3		332	256	269	2.52	58.3	45.7	89	3		410	316	299	3.45	58.3	45.7	92
4		333	277	228	2.05	61.0	51.5	89	4		412	341	254	2.81	61.0	51.5	92
5		315	274	191	1.68	58.8	52.0	88	5		389	338	212	2.31	58.8	52.0	91
6		280	252	154	1.39	51.2	46.8	89	6		346	311	172	1.91	51.2	46.8	92
1	660	438	258	420	6.42	46.9	28.2	97	1	720	521	307	458	8.34	46.9	28.2	101
2		476	332	373	5.42	53.8	38.1	95	2		567	395	407	7.04	53.8	38.1	100
3		496	382	329	4.59	58.3	45.7	94	3		591	455	359	5.96	58.3	45.7	99
4		498	413	279	3.74	61.0	51.5	94	4		593	492	304	4.85	61.0	51.5	99
5		470	409	233	3.07	58.8	52.0	93	5		560	486	255	3.98	58.8	52.0	99
6		418	376	189	2.54	51.2	46.8	94	6		498	448	206	3.29	51.2	46.8	99
1	780	612	361	496	10.60	46.9	28.2	102	1	840	709	418	534	13.23	46.9	28.2	104
2		665	463	441	8.94	53.8	38.1	101	2		771	537	475	11.17	53.8	38.1	103
3		693	534	388	7.57	58.3	45.7	101	3		804	619	418	9.46	58.3	45.7	102
4		695	577	330	6.17	61.0	51.5	101	4		807	669	355	7.70	61.0	51.5	102
5		657	571	276	5.06	58.8	52.0	100	5		762	662	297	6.32	58.8	52.0	102
6		584	526	223	4.19	51.2	46.8	101	6		678	609	240	5.23	51.2	46.8	102
1	900	814	480	572	16.28	46.9	28.2	106	1	960	926	546	611	19.75	46.9	28.2	107
2		885	617	509	13.74	53.8	38.1	104	2		1007	702	543	16.67	53.8	38.1	106
3		923	710	448	11.63	58.3	45.7	104	3		1050	808	478	14.12	58.3	45.7	105
4		926	768	381	9.47	61.0	51.5	104	4		1053	874	406	11.50	61.0	51.5	105
5		874	760	318	7.77	58.8	52.0	103	5		995	865	340	9.43	58.8	52.0	104
6		778	700	258	6.43	51.2	46.8	104	6		885	796	275	7.80	51.2	46.8	105

- The A-Weighted sound rating shown have been calculated per AMCA Standard 301
- Value shown are for inlet LwiA sound power levels for installation type B - free inlet, ducted outlet.
- Performance certified is for installation type B - free inlet, ducted outlet.
- Performance ratings do not include the effects of apputenances(accessories), Power rating Kw does not include transmission losses

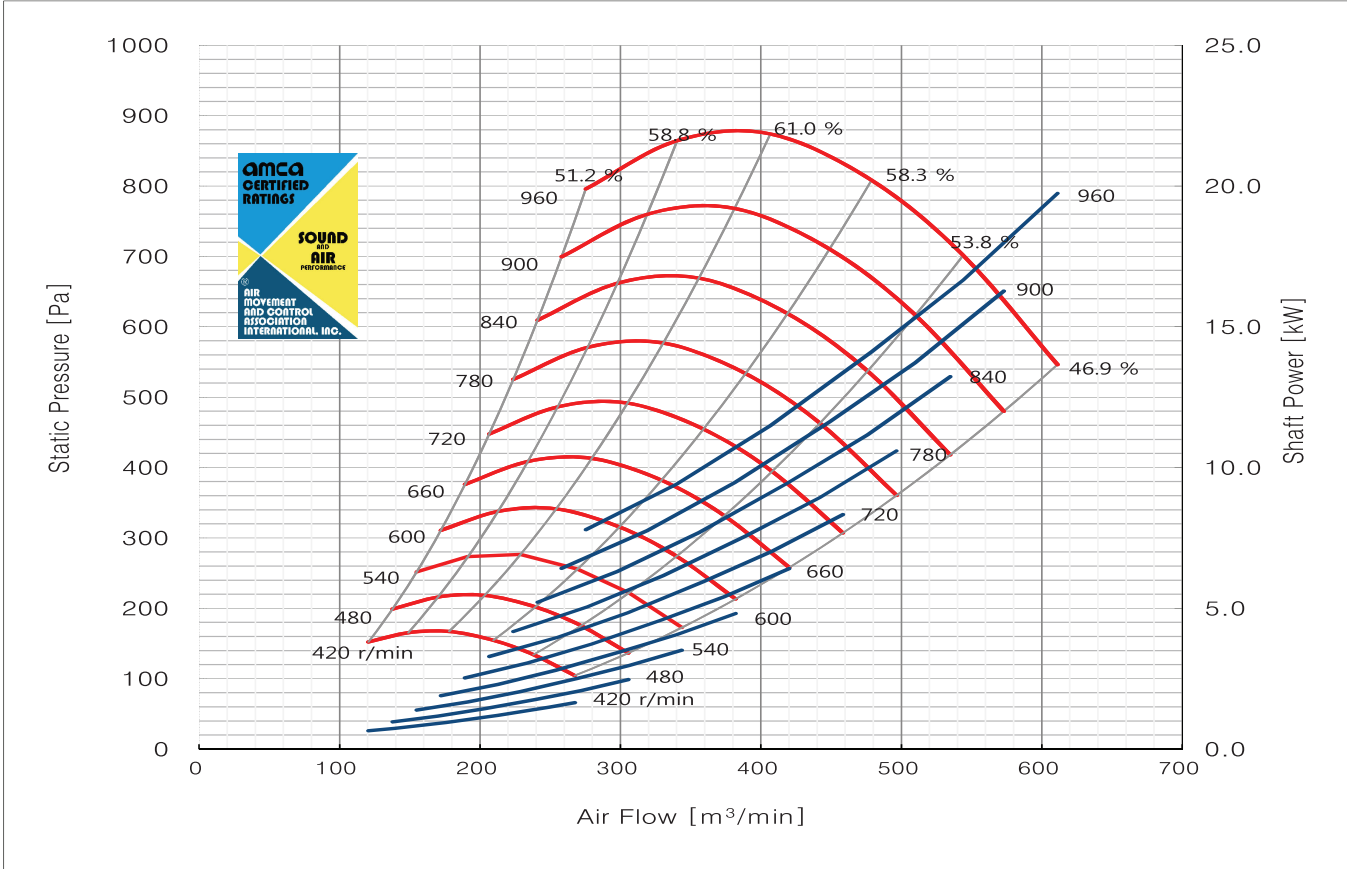

*상기 자료는 품질관리를 위해 예고없이 변경될 수 있습니다.



벨트 구동형 시로코팬 (양흡입)

Belt driven Sirocco Fan

성능곡선

Dae-Ryun Ind. Co., LTD

DR-SFD Series

Model : DR-SF#4DD

Wheel DIA. : 600 mm

Outlet Dim : 880 X 610 mm

Outlet Area : 0.536 m²

Det.	N [r/min]	Pt [Pa]	Ps [Pa]	Q m ³ /min	H [kW]	EtaT [%]	EtaS [%]	LwiA [dB]	Det.	N [r/min]	Pt [Pa]	Ps [Pa]	Q m ³ /min	H [kW]	EtaT [%]	EtaS [%]	LwiA [dB]
1	360	170	100	342	2.04	46.9	28.2	87	1	420	232	137	399	3.23	46.9	28.2	90
2		185	129	304	1.72	53.8	38.1	85	2		252	175	355	2.73	53.8	38.1	89
3		193	148	267	1.46	58.3	45.7	85	3		262	202	312	2.31	58.3	45.7	88
4		193	161	227	1.19	61.0	51.5	85	4		263	219	265	1.88	61.0	51.5	88
5		183	159	190	0.97	58.8	52.0	84	5		249	216	222	1.54	58.8	52.0	87
6		163	146	154	0.81	51.2	46.8	85	6		221	199	179	1.28	51.2	46.8	88
1	480	303	178	456	4.82	46.9	28.2	93	1	540	383	226	513	6.86	46.9	28.2	96
2		329	229	405	4.07	53.8	38.1	92	2		416	290	456	5.79	53.8	38.1	94
3		343	264	357	3.44	58.3	45.7	91	3		434	334	401	4.90	58.3	45.7	93
4		344	285	303	2.81	61.0	51.5	91	4		435	361	341	3.99	61.0	51.5	93
5		325	282	253	2.30	58.8	52.0	90	5		411	357	285	3.27	58.8	52.0	92
6		289	260	205	1.90	51.2	46.8	91	6		366	329	231	2.71	51.2	46.8	93
1	600	473	279	570	9.40	46.9	28.2	98	1	660	572	337	627	12.52	46.9	28.2	101
2		514	358	507	7.94	53.8	38.1	97	2		622	433	558	10.56	53.8	38.1	99
3		536	412	446	6.72	58.3	45.7	96	3		648	499	491	8.94	58.3	45.7	98
4		537	446	379	5.47	61.0	51.5	96	4		650	540	417	7.28	61.0	51.5	98
5		507	441	317	4.49	58.8	52.0	95	5		614	534	349	5.97	58.8	52.0	97
6		452	406	256	3.71	51.2	46.8	96	6		547	491	282	4.94	51.2	46.8	98
1	720	681	401	684	16.25	46.9	28.2	105	1	780	799	471	741	20.66	46.9	28.2	107
2		740	516	608	13.71	53.8	38.1	104	2		869	605	659	17.43	53.8	38.1	106
3		771	594	535	11.61	58.3	45.7	103	3		905	697	580	14.76	58.3	45.7	105
4		774	642	455	9.46	61.0	51.5	103	4		908	754	493	12.02	61.0	51.5	105
5		731	635	380	7.75	58.8	52.0	103	5		858	746	412	9.86	58.8	52.0	105
6		650	585	308	6.42	51.2	46.8	103	6		763	686	333	8.16	51.2	46.8	105
1	840	926	546	798	25.80	46.9	28.2	108	1	900	1064	627	855	31.73	46.9	28.2	110
2		1007	702	710	21.77	53.8	38.1	107	2		1157	806	761	26.78	53.8	38.1	108
3		1050	808	625	18.44	58.3	45.7	106	3		1205	928	669	22.67	58.3	45.7	108
4		1053	874	531	15.01	61.0	51.5	106	4		1209	1003	569	18.46	61.0	51.5	108
5		995	865	444	12.31	58.8	52.0	106	5		1142	993	476	15.14	58.8	52.0	107
6		885	796	359	10.18	51.2	46.8	106	6		1016	914	385	12.53	51.2	46.8	108

- The A-Weighted sound rating shown have been calculated per AMCA Standard 301
- Value shown are for inlet LwiA sound power levels for installation type B - free inlet, ducted outlet.
- Performance certified is for installation type B - free inlet, ducted outlet.
- Performance ratings do not include the effects of apputenances(accessories), Power rating Kw does not include transmission losses

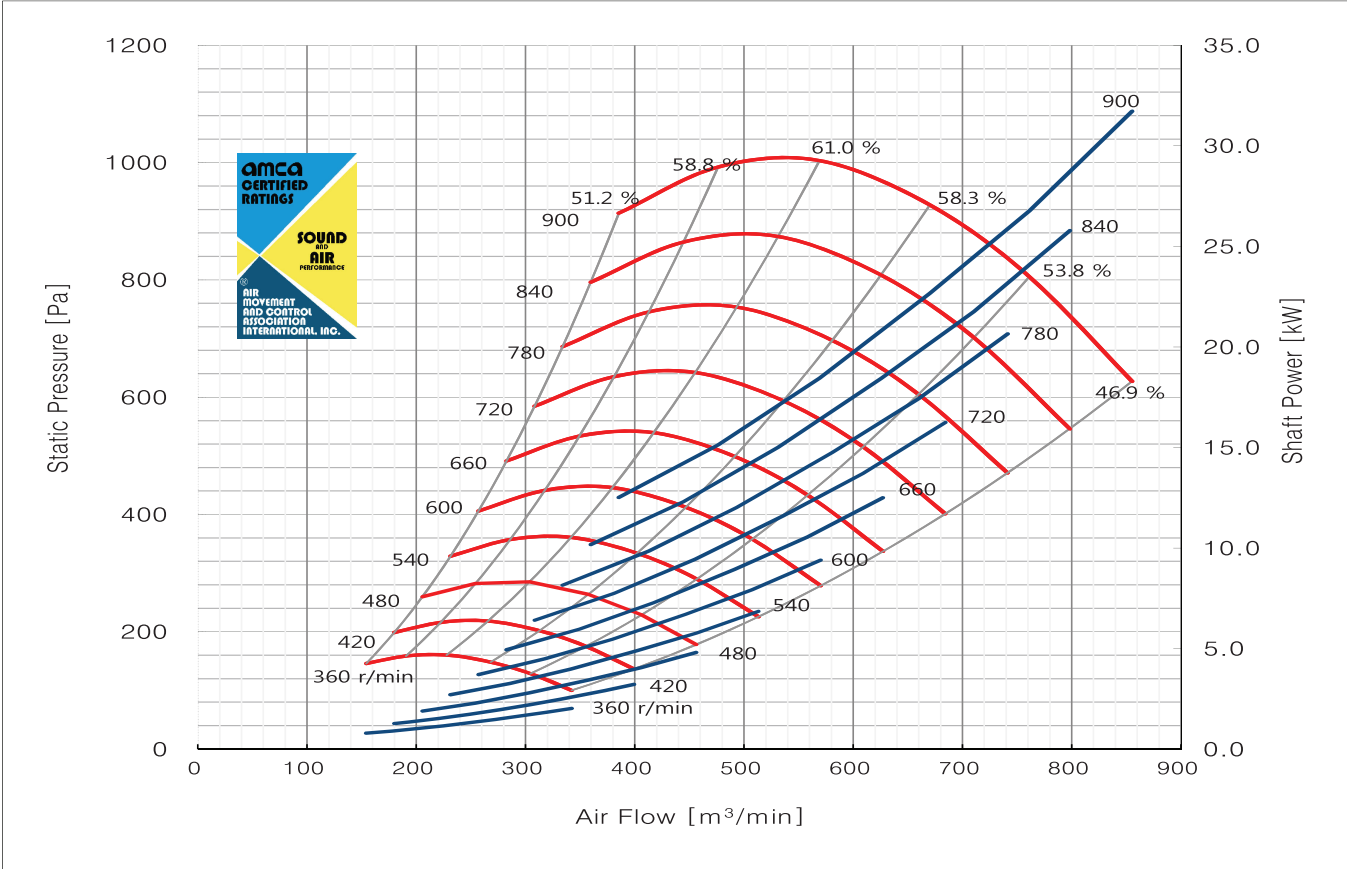

*상기 자료는 품질관리를 위해 예고없이 변경될 수 있습니다.

벨트 구동형 시로코팬 (양흡입)

Belt driven Sirocco Fan

성능곡선

Dae-Ryun Ind. Co., LTD

DR-SFD Series

Model : DR-SF#4.5DD

Wheel DIA. : 675 mm

Outlet Dim : 990 X 690 mm

Outlet Area : 0.679 m²

Det.	N	Pt	Ps	Q	H	EtaT	EtaS	LwiA	Det.	N	Pt	Ps	Q	H	EtaT	EtaS	LwiA
	[r/min]	[Pa]	[Pa]	m³/min	[kW]	[%]	[%]	[dB]		[r/min]	[Pa]	[Pa]	m³/min	[kW]	[%]	[%]	[dB]
1	320	121	59	412	2.43	33.8	16.6	79	1	370	162	78	476	3.75	33.8	16.6	82
2		134	83	369	2.12	38.3	24.1	77	2		179	111	427	3.28	38.3	24.1	80
3		194	147	351	1.86	60.1	46.3	77	3		260	196	406	2.87	60.1	46.3	80
4		198	157	324	1.69	62.4	50.4	76	4		265	210	375	2.61	62.4	50.4	79
5		198	166	280	1.41	64.7	55.3	76	5		264	222	324	2.17	64.7	55.3	79
6		181	156	248	1.21	61.1	53.6	76	6		242	209	287	1.87	61.1	53.6	79
1	420	209	101	540	5.48	33.8	16.6	85	1	470	262	126	604	7.67	33.8	16.6	87
2		231	143	485	4.79	38.3	24.1	83	2		289	178	543	6.71	38.3	24.1	86
3		334	253	461	4.20	60.1	46.3	82	3		419	317	515	5.88	60.1	46.3	85
4		341	270	425	3.81	62.4	50.4	81	4		427	339	476	5.34	62.4	50.4	84
5		341	286	368	3.18	64.7	55.3	81	5		426	359	412	4.45	64.7	55.3	84
6		312	269	326	2.73	61.1	53.6	81	6		391	337	364	3.82	61.1	53.6	84
1	520	320	155	669	10.39	33.8	16.6	90	1	570	385	186	733	13.69	33.8	16.6	92
2		354	218	601	9.09	38.3	24.1	88	2		425	263	658	11.97	38.3	24.1	90
3		513	388	570	7.96	60.1	46.3	87	3		616	466	625	10.49	60.1	46.3	89
4		523	415	527	7.22	62.4	50.4	86	4		628	498	578	9.51	62.4	50.4	88
5		522	439	456	6.02	64.7	55.3	86	5		627	527	499	7.93	64.7	55.3	88
6		479	412	403	5.17	61.1	53.6	86	6		575	495	442	6.81	61.1	53.6	88
1	620	455	220	797	17.61	33.8	16.6	96	1	670	532	257	862	22.22	33.8	16.6	98
2		503	311	716	15.40	38.3	24.1	95	2		587	363	774	19.43	38.3	24.1	96
3		729	551	680	13.49	60.1	46.3	94	3		851	643	735	17.03	60.1	46.3	96
4		743	589	628	12.24	62.4	50.4	94	4		868	688	679	15.45	62.4	50.4	95
5		742	624	543	10.20	64.7	55.3	94	5		867	729	587	12.88	64.7	55.3	95
6		680	586	481	8.77	61.1	53.6	94	6		795	684	520	11.06	61.1	53.6	95
1	720	614	296	926	27.58	33.8	16.6	99	1	770	702	339	990	33.73	33.8	16.6	101
2		678	419	832	24.11	38.3	24.1	98	2		775	479	889	29.49	38.3	24.1	99
3		983	743	790	21.13	60.1	46.3	97	3		1124	850	845	25.84	60.1	46.3	99
4		1002	795	730	19.17	62.4	50.4	97	4		1146	909	780	23.44	62.4	50.4	98
5		1001	841	631	15.98	64.7	55.3	96	5		1145	962	675	19.54	64.7	55.3	98
6		918	790	559	13.73	61.1	53.6	97	6		1049	904	597	16.79	61.1	53.6	98

- The A-Weighted sound rating shown have been calculated per AMCA Standard 301
- Value shown are for inlet LwiA sound power levels for installation type B - free inlet, ducted outlet.
- Performance certified is for installation type B - free inlet, ducted outlet.
- Performance ratings do not include the effects of apputenances(accessories), Power rating Kw does not include transmission losses

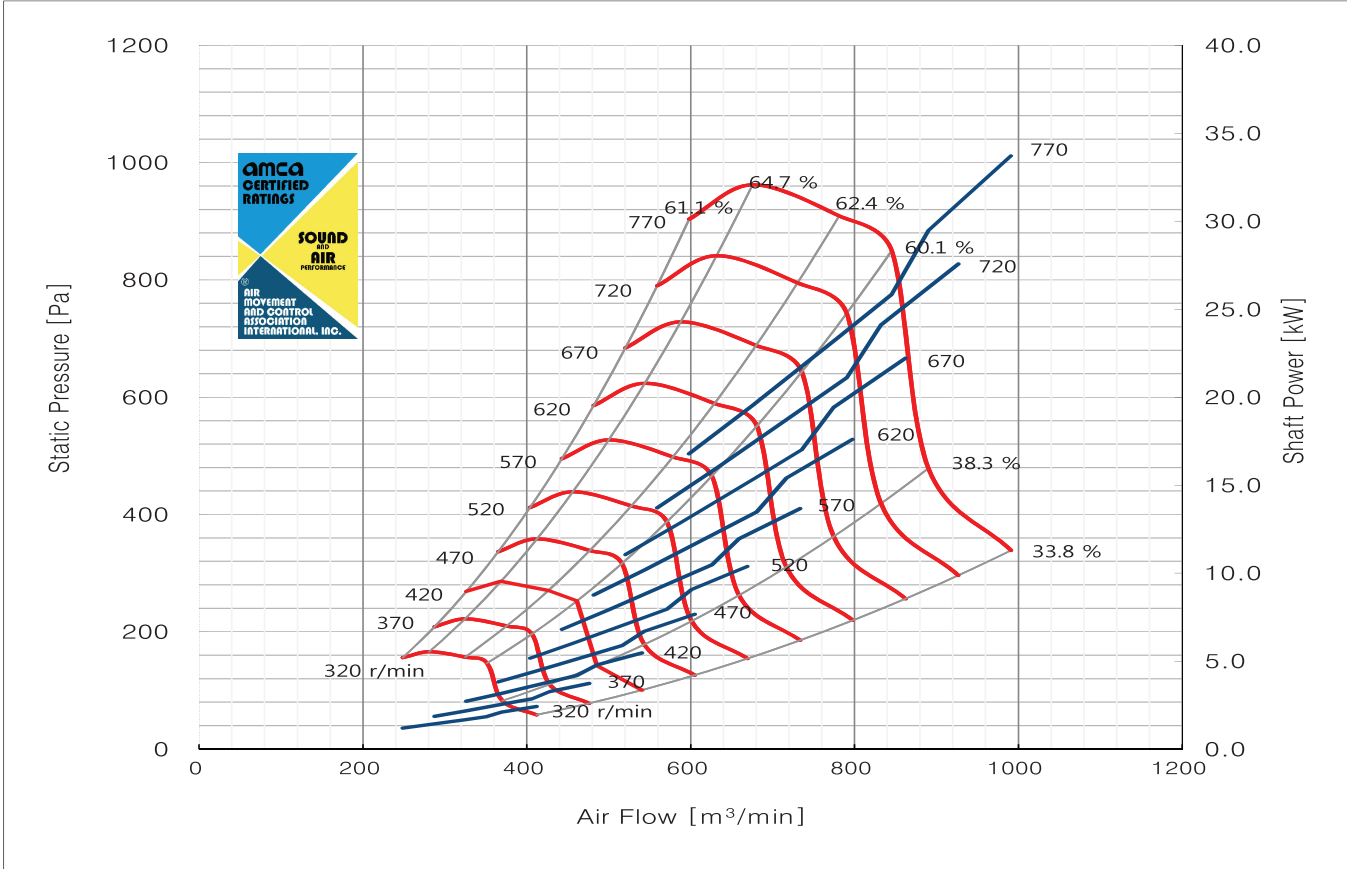

*상기 자료는 품질관리를 위해 예고없이 변경될 수 있습니다.



벨트 구동형 시로코팬 (양흡입)

Belt driven Sirocco Fan

성능곡선

Dae-Ryun Ind. Co., LTD

DR-SFD Series

Model : DR-SF#5DD

Wheel DIA. : 750 mm

Outlet Dim : 1100 X 760 mm

Outlet Area : 0.838 m²

Det.	N	Pt	Ps	Q	H	EtaT	EtaS	LwiA	Det.	N	Pt	Ps	Q	H	EtaT	EtaS	LwiA
	[r/min]	[Pa]	[Pa]	m³/min	[kW]	[%]	[%]	[dB]		[r/min]	[Pa]	[Pa]	m³/min	[kW]	[%]	[%]	[dB]
1	270	107	51	477	2.47	33.8	16.6	77	1	320	150	72	564	4.10	33.8	16.6	82
2		118	73	428	2.16	38.3	24.1	75	2		165	102	507	3.59	38.3	24.1	80
3		171	129	406	1.89	60.1	46.3	73	3		240	181	481	3.15	60.1	46.3	80
4		174	138	375	1.72	62.4	50.4	72	4		244	194	445	2.85	62.4	50.4	79
5		174	146	324	1.43	64.7	55.3	72	5		244	205	384	2.38	64.7	55.3	79
6		159	137	287	1.23	61.1	53.6	72	6		224	193	340	2.05	61.1	53.6	79
1	370	200	97	653	6.34	33.8	16.6	85	1	420	258	124	741	9.27	33.8	16.6	88
2		221	137	586	5.55	38.3	24.1	84	2		285	176	665	8.11	38.3	24.1	86
3		320	242	557	4.86	60.1	46.3	83	3		413	312	632	7.11	60.1	46.3	86
4		327	259	514	4.41	62.4	50.4	82	4		421	334	584	6.45	62.4	50.4	85
5		326	274	445	3.68	64.7	55.3	82	5		420	353	505	5.37	64.7	55.3	84
6		299	258	394	3.16	61.1	53.6	82	6		385	332	447	4.62	61.1	53.6	85
1	470	323	156	829	12.99	33.8	16.6	91	1	520	395	191	917	17.60	33.8	16.6	93
2		357	220	745	11.36	38.3	24.1	89	2		437	270	824	15.39	38.3	24.1	91
3		517	391	707	9.96	60.1	46.3	88	3		633	479	783	13.48	60.1	46.3	90
4		527	418	653	9.03	62.4	50.4	87	4		645	512	723	12.23	62.4	50.4	89
5		526	443	565	7.53	64.7	55.3	87	5		644	542	625	10.20	64.7	55.3	89
6		483	416	500	6.47	61.1	53.6	87	6		591	509	553	8.76	61.1	53.6	89
1	570	475	229	1006	23.17	33.8	16.6	95	1	620	562	271	1094	29.82	33.8	16.6	99
2		525	324	903	20.26	38.3	24.1	93	2		621	383	982	26.08	38.3	24.1	98
3		761	575	858	17.75	60.1	46.3	92	3		900	680	933	22.85	60.1	46.3	98
4		776	615	793	16.11	62.4	50.4	91	4		918	728	862	20.73	62.4	50.4	97
5		774	651	685	13.43	64.7	55.3	91	5		916	770	745	17.28	64.7	55.3	97
6		710	611	607	11.54	61.1	53.6	91	6		840	723	660	14.84	61.1	53.6	97
1	670	656	317	1182	37.63	33.8	16.6	101	1	720	758	366	1270	46.70	33.8	16.6	102
2		725	448	1062	32.90	38.3	24.1	100	2		837	517	1141	40.83	38.3	24.1	101
3		1051	794	1008	28.83	60.1	46.3	99	3		1213	917	1084	35.78	60.1	46.3	100
4		1072	850	932	26.16	62.4	50.4	98	4		1237	981	1001	32.46	62.4	50.4	100
5		1070	899	806	21.80	64.7	55.3	98	5		1235	1039	866	27.06	64.7	55.3	100
6		981	845	713	18.73	61.1	53.6	98	6		1133	976	766	23.24	61.1	53.6	100

- The A-Weighted sound rating shown have been calculated per AMCA Standard 301
- Value shown are for inlet LwiA sound power levels for installation type B - free inlet, ducted outlet.
- Performance certified is for installation type B - free inlet, ducted outlet.
- Performance ratings do not include the effects of apputenances(accessories), Power rating Kw does not include transmission losses

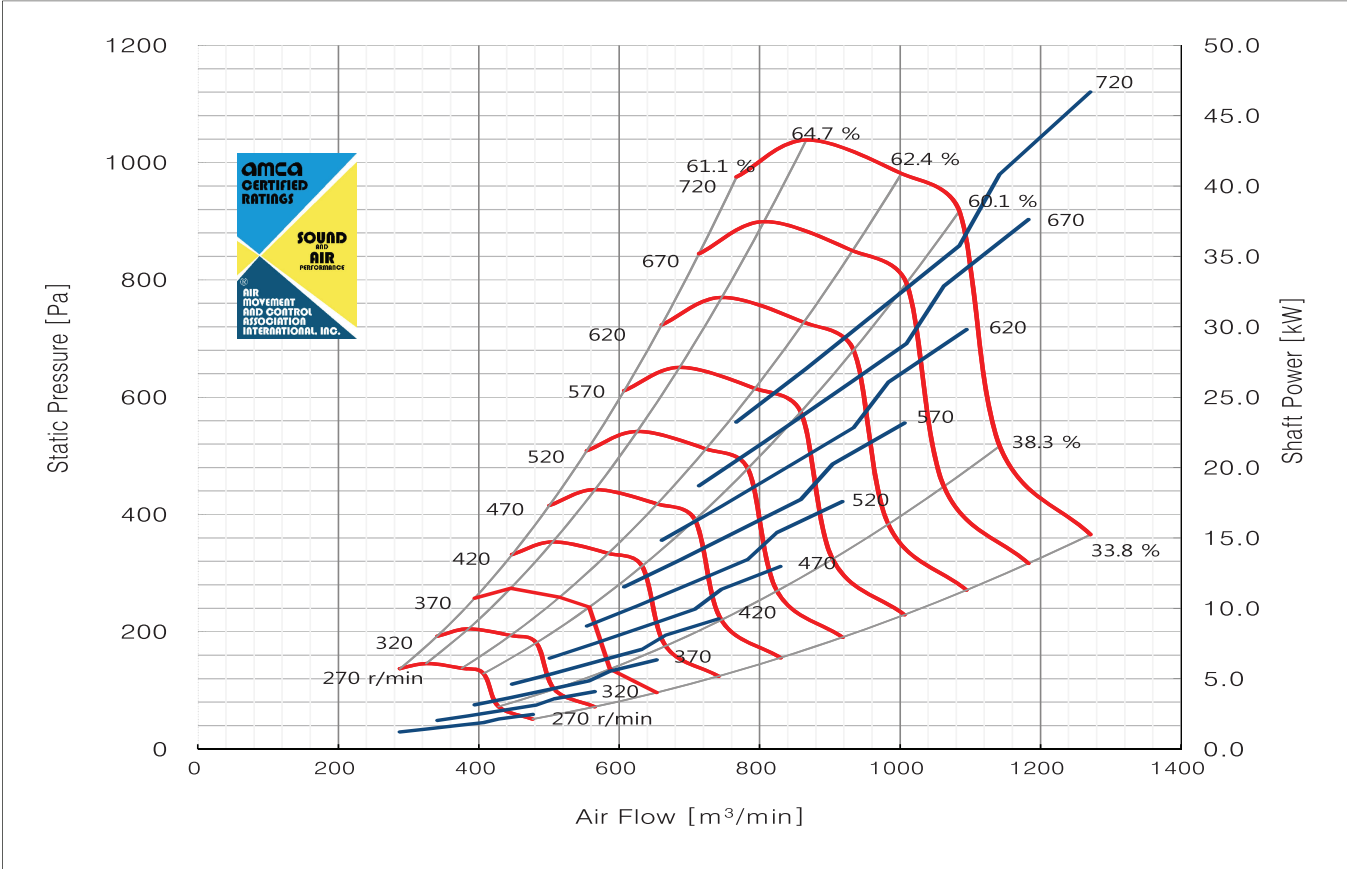

*상기 자료는 품질관리를 위해 예고없이 변경될 수 있습니다.