

#### MODEL 45C672, 5NKH6, 5NKH7, 45C680, 5NKH8, 45C679, 5NKH9, 45C682, 5NKJ0, 45C681, 5NKJ1, 45C673, 45C674

Heavy duty Extruded Aluminum construction designed to protect the air intake and exhaust openings in the exterior walls of any building from rain and weather while still providing efficient airflow. The drainable blade design provides the best protection against water entering the opening by channeling water away from the blades and down the jambs. This eliminates water cascading from blade to blade. The adjustable rear blades allow for tight shutoff of the opening when needed.

#### STANDARD CONSTRUCTION:

##### FRAME

- 4" deep channel x .080 thick Extruded Aluminum.

##### BLADES

- Drainable style, .080 thick Extruded Aluminum, positioned at a 45 degree angle and spaced approximately 4" centers.

##### SEALS

- Extruded TPV.

##### LINKAGE

- On-blade type with a Thumb Screw Operator as standard.

##### BIRDSCREEN

- ½" Flattened Aluminum in a removable frame mounted on the interior.

##### CONSTRUCTION

- Screwed.

##### FINISH

- Mill.

##### MINIMUM SIZE

- 12" W x 12" H

##### MAXIMUM SINGLE SECTION SIZE

- 60" W x 96" H

##### OPTIONS (AT ADDITIONAL COST)

- Up to 48" W x 48" H, 100 to 240 VAC, 50/60 Hz Motor Pack.
- Over 48" W x 48" H, 24 to 240 VAC, 50/60 Hz Motor Pack.
- 1-½" Flange

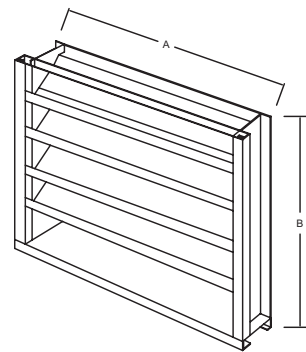

FRONT VIEW

Note: Above "A" and "B" dimensions are undersized by ½" + or - normal tolerance of .0625".

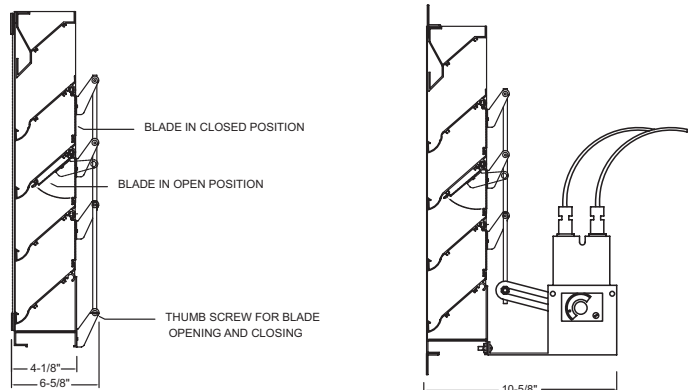

SIDE VIEW  
(w/ Std. Thumb Screw)

SIDE VIEW  
(w/ Optional Motor  
and Flanged Frame)



Dayton Electric Manufacturing Company certifies that the louvers shown herein are licensed to bear the AMCA Seal. The ratings shown are based on tests and procedures performed in accordance with AMCA Publication 511 and comply with the requirements of the AMCA Certified Ratings Program. The AMCA Certified Ratings Seal applies to Air Performance and Water Penetration ratings.

## PERFORMANCE DATA

AMCA Standard 500-L provides a method for testing and rating louvers. These tests were performed under certain sets of laboratory conditions. These performance ratings do not guarantee that other environmental conditions may actually occur. Use safety factors when selecting louver sizes based upon performance.

### FREE AREA CHART (SQ. FT.):

		LOUVER WIDTH IN INCHES							
		18	24	30	36	42	48	54	60
LOUVER HEIGHT IN INCHES	18	0.70	0.98	1.25	1.53	1.81	2.09	2.37	2.65
	24	1.06	1.49	1.91	2.34	2.76	3.18	3.61	4.03
	30	1.36	1.91	2.45	2.99	3.54	4.08	4.63	5.17
	36	1.73	2.42	3.11	3.80	4.49	5.18	5.87	6.56
	42	2.03	2.84	3.65	4.46	5.26	6.07	6.88	7.69
	48	2.39	3.35	4.30	5.26	6.21	<b>7.22</b>	8.12	9.08
	54	2.69	3.76	4.84	5.92	6.99	8.07	9.14	10.22
	60	3.05	4.28	5.50	6.72	7.94	9.16	10.38	11.60
	66	3.35	4.69	6.04	7.38	8.72	10.06	11.40	12.74
	72	3.72	5.21	6.69	8.18	9.67	11.15	12.64	14.13
	78	4.02	5.62	7.23	8.84	10.44	12.05	13.66	15.27
	84	4.38	6.13	7.89	9.64	11.39	13.15	14.90	16.65
	90	4.68	6.55	8.43	10.30	12.17	14.04	15.92	17.79
96	5.05	7.06	9.08	11.10	13.12	15.14	17.16	19.17	



Dayton Electric Manufacturing Company certifies that the louvers shown herein are licensed to bear the AMCA Seal. The ratings shown are based on tests and procedures performed in accordance with AMCA Publication 511 and comply with the requirements of the AMCA Certified Ratings Program. The AMCA Certified Ratings Seal applies to Air Performance and Water Penetration ratings.

### PRESSURE DROP

Standard Air - .075 lbs per cubic foot  
Test size - 48" x 48" (Intake)

Ratings do not include the effect of a birdscreen

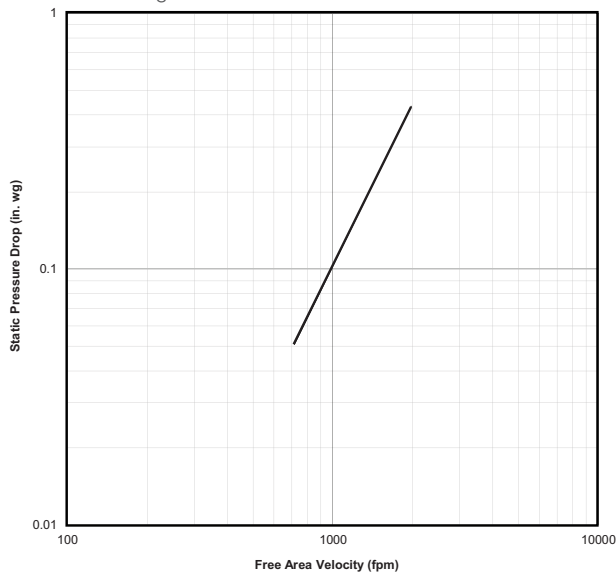

### WATER PENETRATION

Standard Air - .075 lbs. per cubic foot  
Test size - 48" x 48" for a 15 minute duration

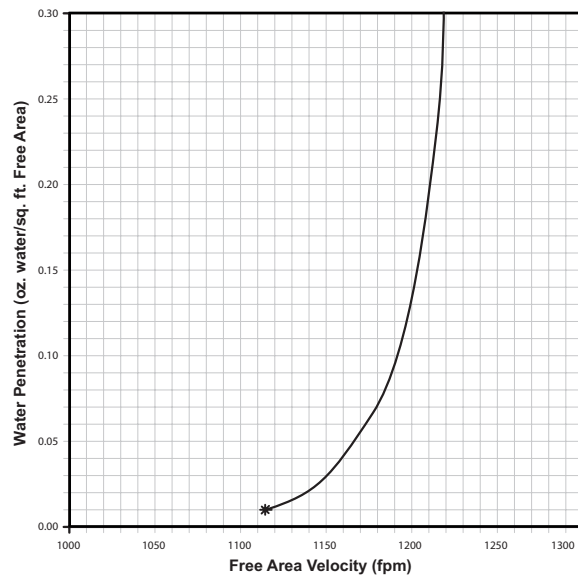

The beginning point of water penetration at .01 oz./sq. ft. is 1118 fpm free area velocity.

Find it at Grainger.

Call or visit your local branch or go to [grainger.com/dayton](http://grainger.com/dayton) for complete product line information.

**Dayton**®