

- ° 0

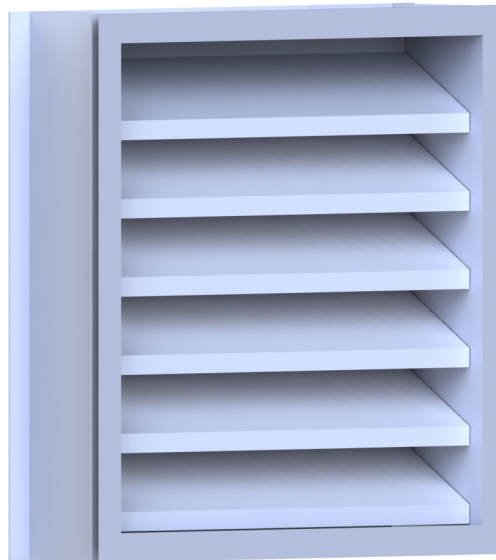

The EAL External Air Louver is most widely used for its high eyesight coverage, and protection against water penetration.

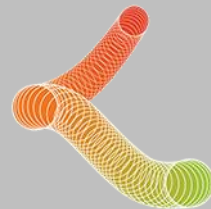

Ⓢ) - CE

- 1- 360° VIEW (CLICK AND ROTATE) ----- PAGE: 3**
- 2- PRODUCT FEATURES ----- PAGE: 4**
- 3- DIMENSIONS ----- PAGE: 5**
- 4- MOUNTING METHODS ----- PAGE: 7**
- 5- PERFORMANCE TABLE ----- PAGE: 8**

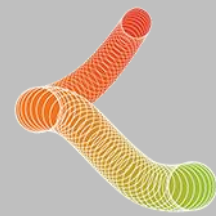

PRODUCT FEATURES

▪ **Properties:**

- For Supply & Exhaust Ventilation Systems.
- Designed for outdoor installation.
- They prevent the entry of, large particles in the air or animals, into the ducting system.
- The blades are made from wide, straight profile.
- Low Pressure Drop.
- High Effective Area.
- Tested according to AMCA Air Performance and Wind Driven Rain.
- Tested according to ASHRAE 70-06.

▪ **Material:**

- The Frame and Blades are made from high quality Extruded Aluminum profiles.
- Color Coated RAL 9010 (white).

▪ **Optional Accessories:**

- Wire Mesh.
- Aluminum Filter.
- Volume Damper.

DIMENSIONS

FREE AREA IN SQ.FT

FREE AREA CALCULATIONS ARE BASED ON TEST UNITS WITHOUT BIRD SCREEN

		Width (In)												
		12	18	24	30	36	42	48	54	60	66	72	78	84
Height	12	0.43	0.67	0.91	1.15	1.40	1.64	1.88	2.12	2.23	2.60	2.84	3.08	3.32
	18	0.60	0.94	1.28	1.62	1.95	2.29	2.63	2.96	3.30	3.64	3.98	4.31	4.65
	24	0.95	1.48	2.01	2.54	3.07	3.60	4.13	4.66	5.19	5.72	6.25	6.78	7.31
	30	1.12	1.75	2.37	3.00	3.63	4.25	4.88	5.51	6.13	6.76	7.39	8.01	8.64
	36	1.47	2.29	3.11	3.92	4.74	5.56	6.38	7.20	8.02	8.84	9.66	10.48	11.30
	42	1.64	2.56	3.47	4.39	5.3	6.22	7.13	8.05	8.96	9.88	10.79	11.71	12.62
	48	1.90	2.96	4.02	5.08	6.14	7.20	8.26	9.32	10.38	11.44	12.50	13.56	14.62
	54	2.16	3.36	4.57	5.77	6.98	8.18	9.38	10.59	11.79	13.00	14.20	15.41	16.61
	60	2.50	3.90	5.30	6.69	8.09	9.49	10.89	12.28	13.68	15.08	16.47	17.87	19.27
	66	2.68	4.17	5.66	7.16	8.65	10.14	11.64	13.13	14.62	16.12	17.61	19.10	20.60
In	72	3.02	4.71	6.39	8.08	9.77	11.45	13.14	14.82	16.51	18.20			
	78	3.19	4.98	6.76	8.54	10.32	12.11	13.89	15.67	17.45	19.24			
	84	3.54	5.51	7.49	9.46	11.44	13.42	15.39	17.37	19.34	21.32			



“Klimacontra SARL certifies that the EAL Louver shown herein is licensed to bear the AMCA Certified Ratings Program seal. The ratings shown are based on tests and procedures performed in accordance with AMCA Publication 511 and comply with the requirements of the AMCA Certified Ratings Program. The AMCA Certified Ratings Program seal applies to Wind Driven Rain and Air Performance ratings only.

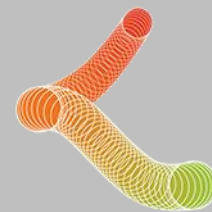

Dimensions:

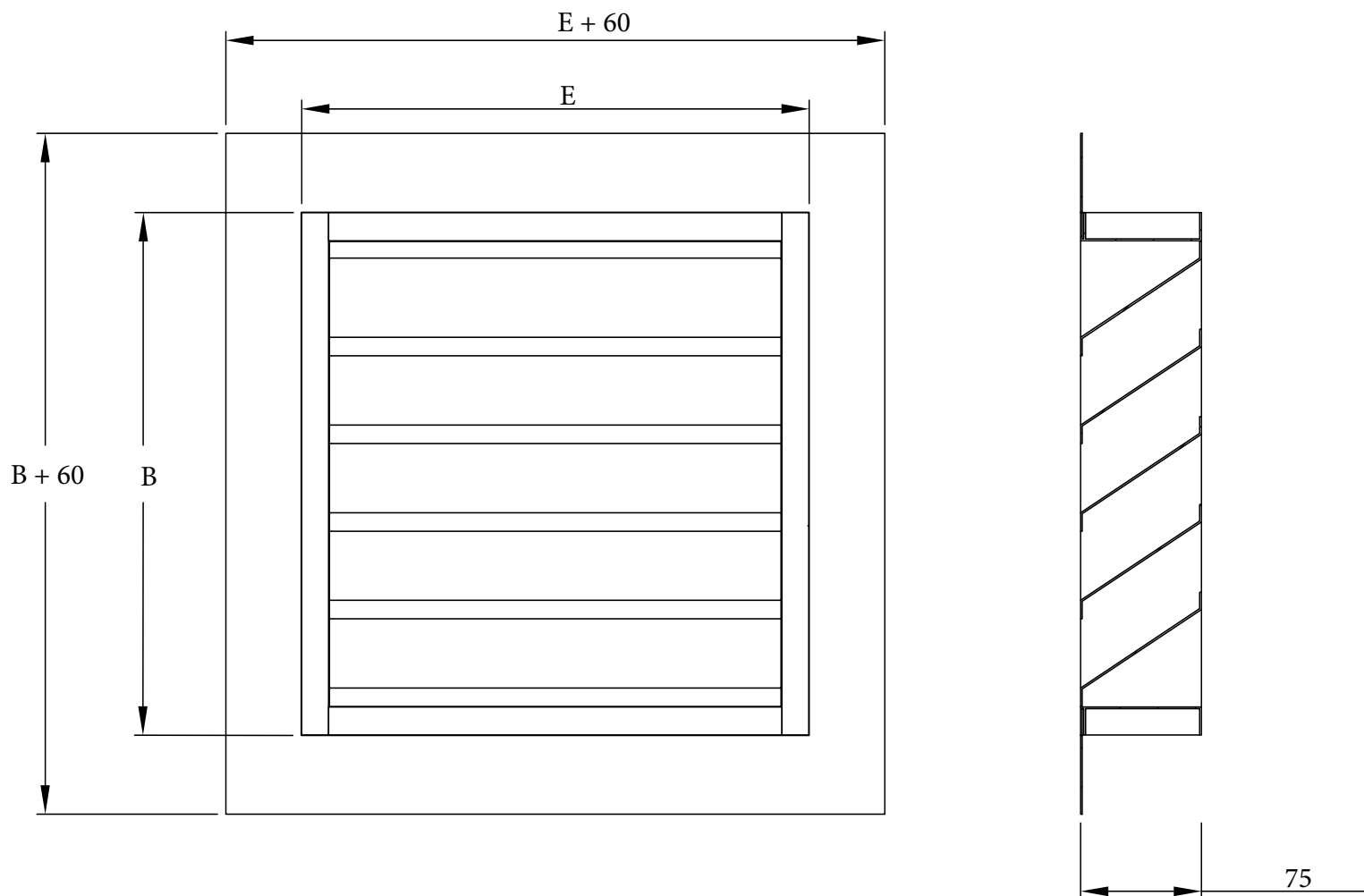
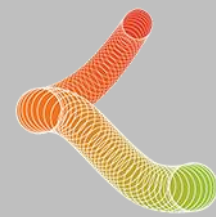

Table:

<i>W</i>	<i>200</i>	<i>400</i>	<i>600</i>	<i>800</i>	<i>1000</i>	<i>1200</i>	<i>1400</i>	<i>1600</i>	<i>1800</i>	<i>2000</i>	<i>2200</i>
<i>H</i>	<i>200</i>	<i>400</i>	<i>600</i>	<i>800</i>	<i>1000</i>	<i>1200</i>	<i>1400</i>	<i>1600</i>	<i>1800</i>	<i>2000</i>	<i>2200</i>



Mounting Methods

Mounting by Screw:

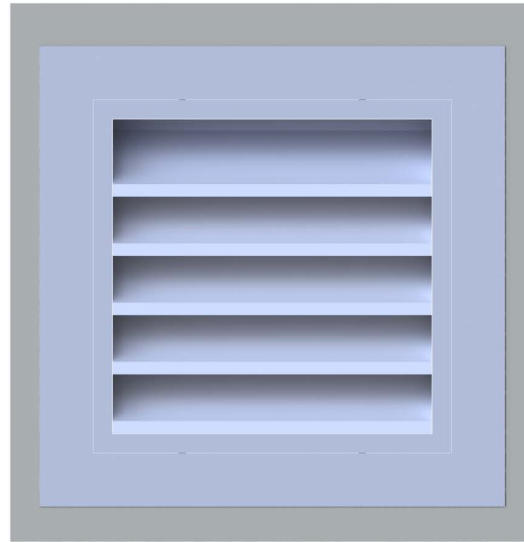

Concealed angle clips:

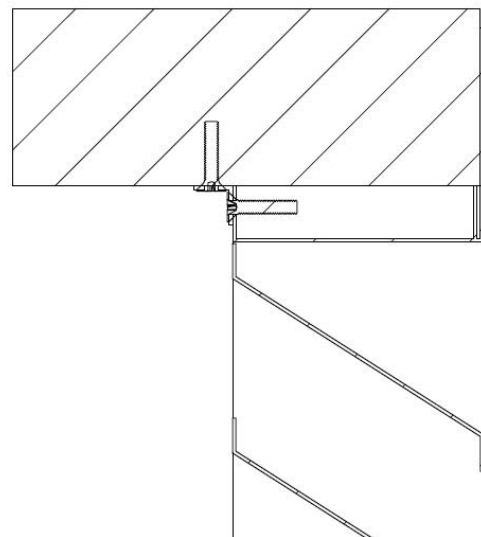
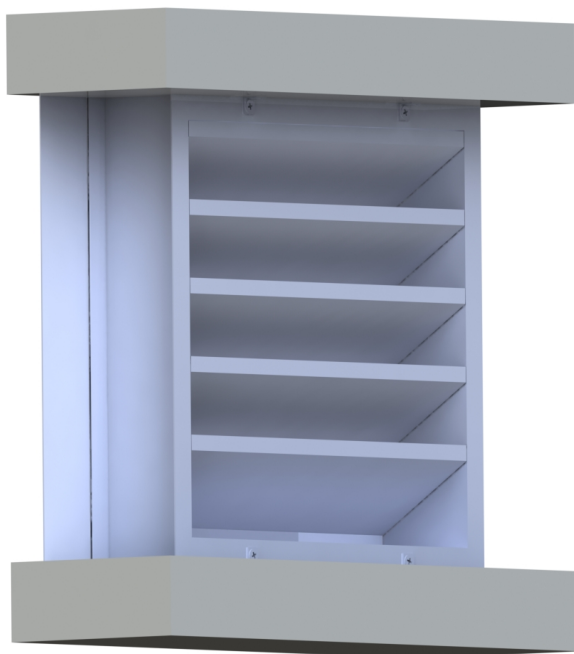

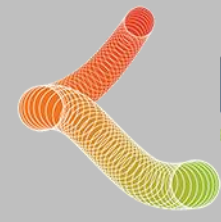

Performance Table

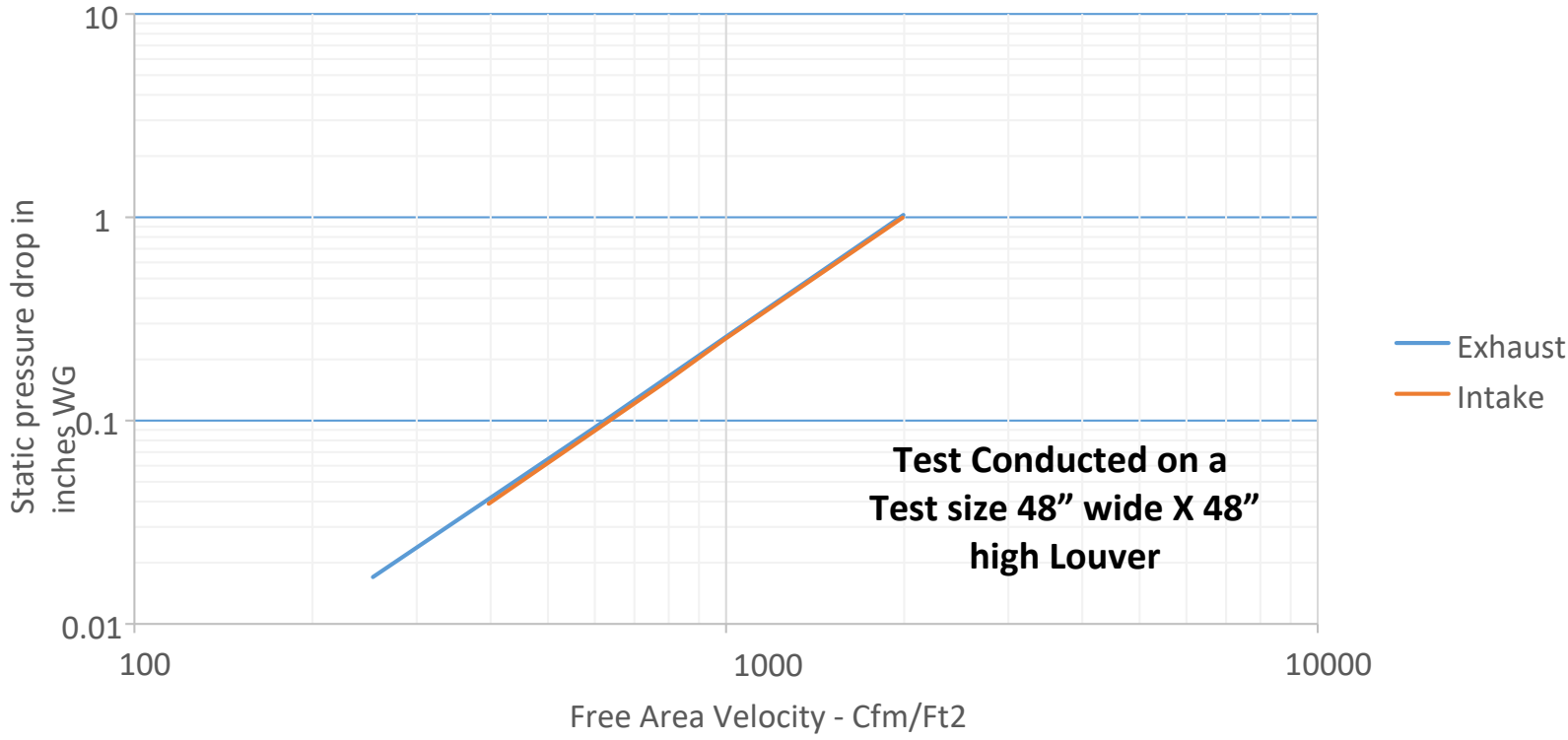

WIND-DRIVEN RAIN PERFORMANCE				
Wind Velocity (mph)	Core Velocity (fpm)	Penetration class	Rainfall Rate (in. per Hour)	Effectiveness (%)
29	495.62	C	3	80.2

Test size is 39.375" x 39.375" core area, 47".75 x 47.75" nominal.