



Double Inlet Centrifugal Fan Forward Curve

*Quick,
Convenient And Clean*



DFT

Double Inlet Centrifugal Fan - DFT

- Double inlet fans with forward curve impellers
- Sizes from 7inch up to 20inch wheel diameter
- Super light construction. Especially suitable for under ceiling packaged unit.
- Low vibration. Unique reinforced design of bearing block greatly reduce fan vibrations, especially for twin fans.
- High reliability. Theoretical life span of ball bearing no less than 20,000 hours if follow manufacturer's installation and operation instruction.



DLK Ventilatoren Sdn Bhd certifies that the DFT L/R fan shown herein is licensed to bear the AMCA Seal.

The ratings shown are based on tests and procedures performed in accordance with AMCA publication 211 and AMCA publication 311 and comply with the requirements of the AMCA Certified Ratings Program.



Operating Limits								
		7-7	9-9	10-10	12-12	15-15	18-18	20-20
Max installed Power (kw)	L	1.1	2.2	2.2	3	5.5	7.5	-
	R	1.1	2.2	2.2	4	5.5	11	11
	L2	1.5	3	3	5.5	7.5	11	-
	R2	1.5	3	4	7.5	11	15	18.5
Max speed (rpm)	L	2400	2000	1600	1400	1100	900	-
	R	2400	2000	1600	1500	1100	1100	-
	L2	2200	1800	1500	1300	1100	900	-
	R2	2200	1800	1600	1400	1200	1000	-
Fan weight (kg)	L	6.5	9	11	17	24	42	-
	R	8.5	10.5	12	20	30	47	-
	L2	15	19	25	37	52	88	-
	R2	20	27	30	48	66	103	-
Temperature (min-20°C)	L	85	85	85	85	85	85	-
	R	85	85	85	85	85	85	-
	L2	85	85	85	85	85	85	-
	R2	85	85	85	85	85	85	-
Bearing Dynamic load (N)	L	12800	12800	12800	14000	14000	19500	-
	R	12800	12800	12800	14000	14000	19500	25700
	L2	12800	14000	19500	19500	25700	29100	-
	R2	12800	14000	19500	19500	25700	29100	32500
Bearing number	L	FH204	FH204	FH204	FH205	FH205	FH206	-
	R	FH204	FH204	FH204	FH205	FH205	FH206	FH207
	L2	FH204	UK205	UK206	UK206	UK207	UK208	-
	R2	FH204	UK205	UK206	UK206	UK207	UK208	UK209



DIMENSIONS DFT-L

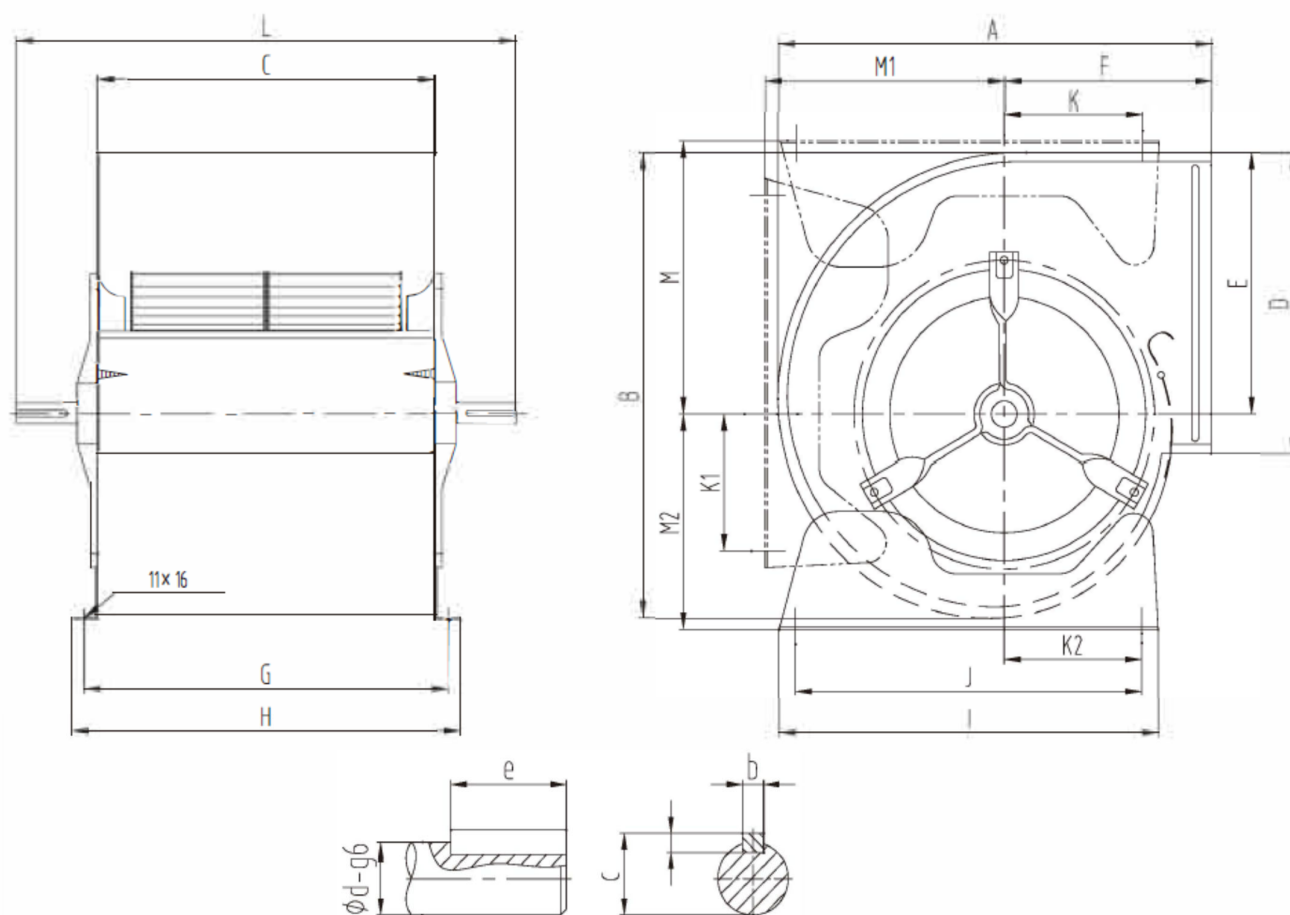

Model	A	B	C	D	E	F	G	H	I	J	L	K	K1	K2	M	M1	M2	a	b	c	d	e
DFT 7-7L	319	328	259	228	188	155	285	309	240	200	370	110	90	90	220	167	143	6	6	22.5	20	30
DFT 9-9L	380	388	298	262	217	185	324	348	332	300	447	119	122	123	255	199	176	6	6	22.5	20	40
DFT 10-10L	425	444	331	289	251	203	357	381	372	340	490	136	130	135	289	227	197	6	6	22.5	20	55
DFT 12-12L	492	524	395	343	296	230	421	445	440	408	564	161	151	161	334	266	229	7	8	28	25	50
DFT 15-15L	569	610	471	404	341	264	497	521	527	495	635	197	210	201	379	309	271	7	8	28	25	50
DFT 18-18L	685	740	557	478	413	314	583	607	638	606	740	262	285	278	455	376	341	7	8	33	30	55

All dimensions in mm

DIMENSIONS DFT-R

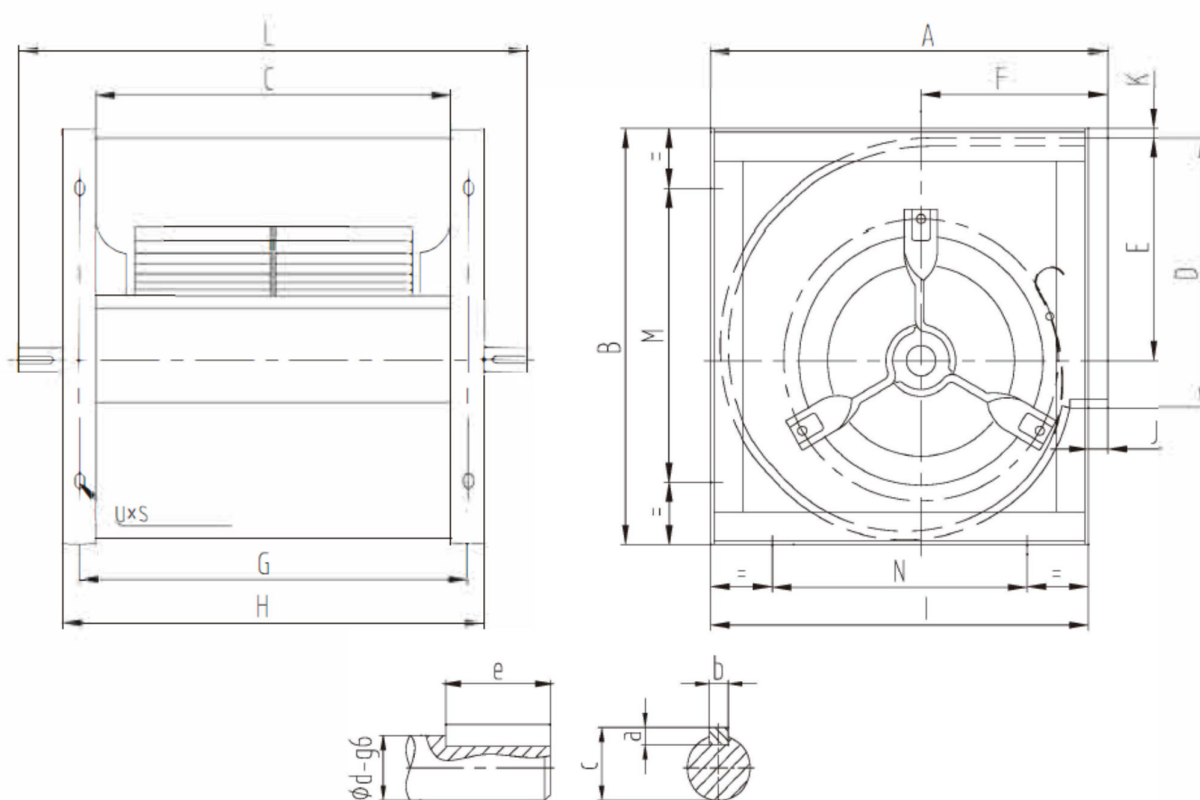

Model	A	B	C	D	E	F	G	H	I	J	K	L	M	N	a	b	c	d	e	U*S
DFT 7-7R	323	336	259	228	188	155	281	299	294	30	4	430	180	180	6	6	22.5	20	30	9*12
DFT 9-9R	384	396	298	262	217	185	320	338	350	34	4	465	324	274	6	6	22.5	20	30	9*12
DFT 10-10R	429	452	331	288	251	203	353	371	399	30	4	490	383	330	6	6	22.5	20	55	9*12
DFT 12-12R	497	534	395	343	296	230	425	455	467	30	5	600	443	371	7	8	28	25	50	11*16
DFT 15-15R	574	620	471	404	341	264	501	531	539	35	5	685	530	449	7	8	28	25	60	11*16
DFT 18-18R	690	751	557	478	413	314	597	637	655	35	5	800	641	545	7	8	33	30	75	11*16
DFT 20-20R	796	868	640	590	488	361	680	720	750	46	5	880	750	628	9	10	38	35	75	11*16

All dimensions in mm

DIMENSIONS DFT-L2

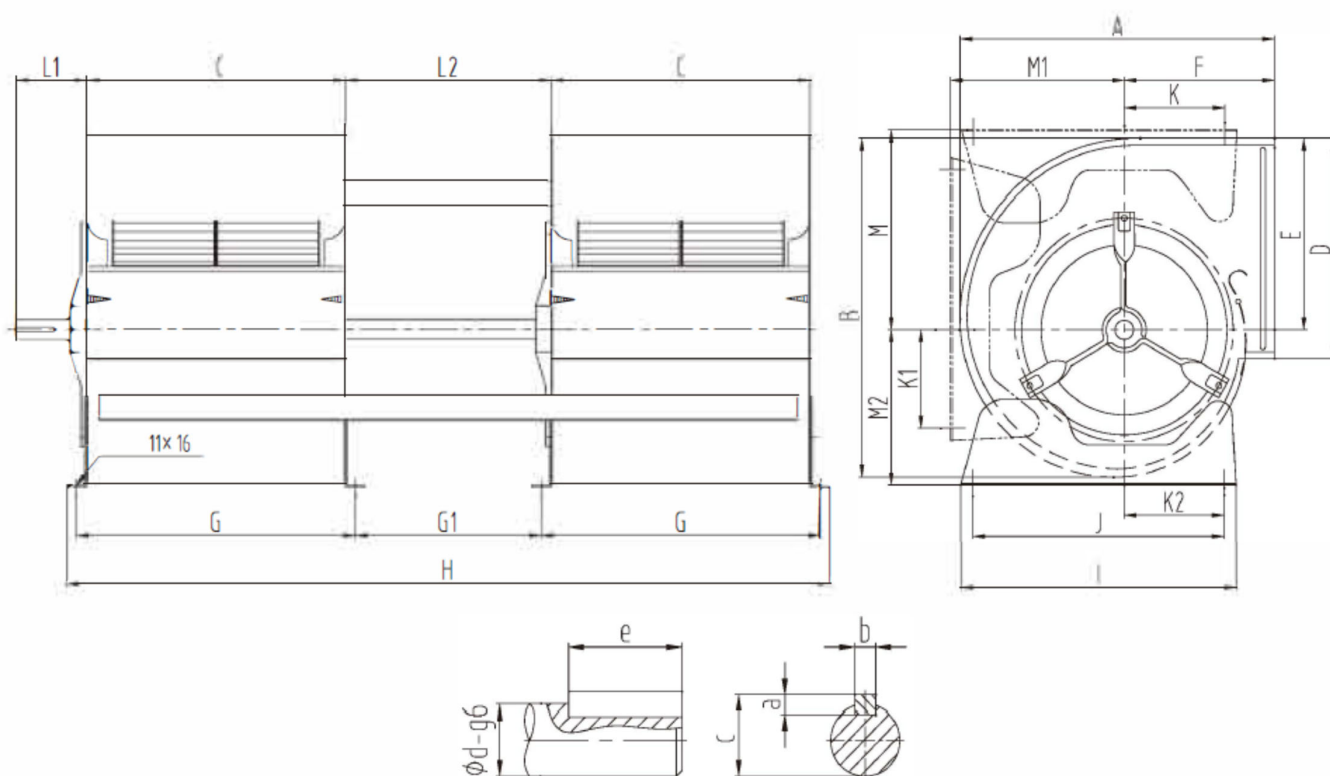

Model	A	B	C	D	E	F	G	G1	H	I	J	L1	L2	K	K1	K2	M	M1	M2	a	b	c	d	e
DFT 7-7L2	319	328	259	228	188	155	285	158	752	240	200	80	184	110	90	90	220	167	143	6	6	22.5	20	60
DFT 9-9L2	380	388	298	262	217	185	324	218	890	332	300	90	244	119	122	123	255	199	176	6	6	22.5	20	60
DFT 10-10L2	425	444	331	289	251	203	357	238	976	372	340	90	264	136	130	135	289	227	197	7	8	28	25	60
DFT 12-12L2	492	524	395	343	296	230	421	298	1164	440	408	110	324	161	151	161	334	266	229	7	8	28	25	70
DFT 15-15L2	569	610	471	404	341	264	497	358	1376	527	495	130	384	197	210	201	379	309	271	7	8	33	30	90
DFT 18-18L2	685	740	557	478	413	314	583	432	1622	638	606	130	458	262	285	278	455	376	341	8	10	38	35	90

All dimensions in mm

DIMENSIONS DFT-R2

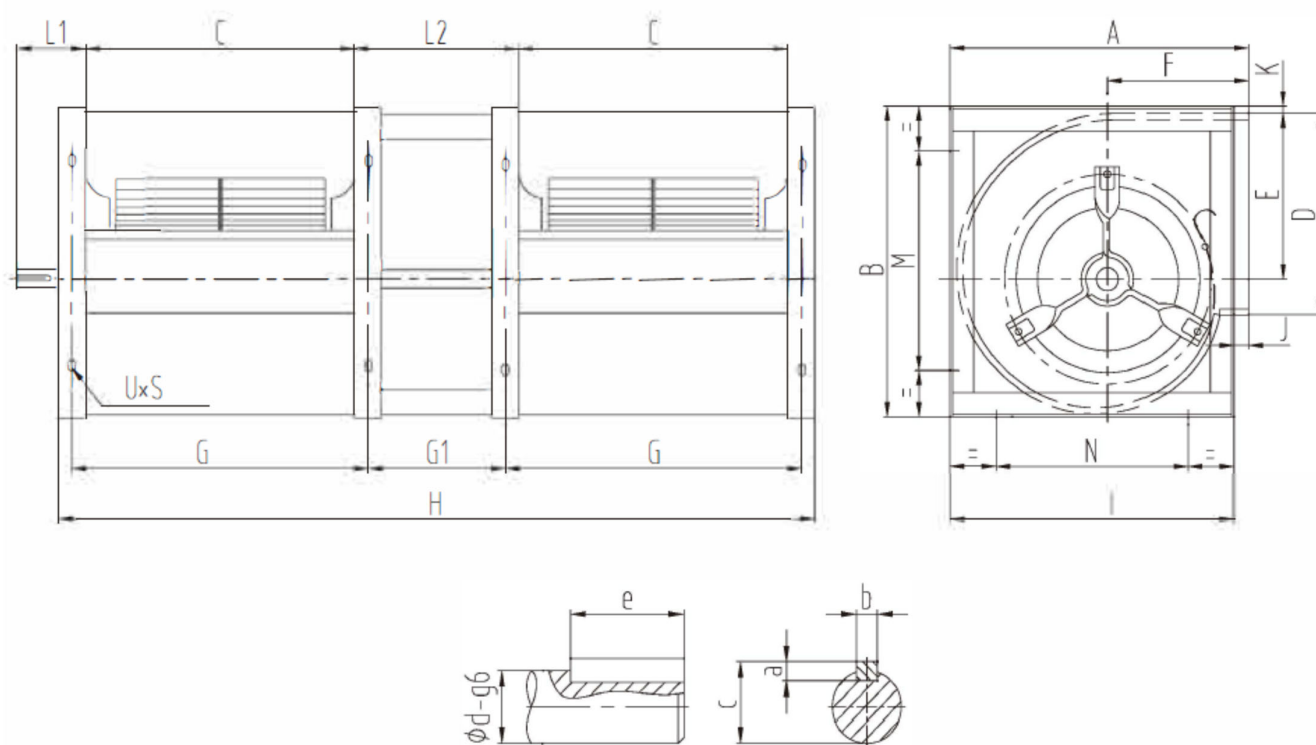

Model	A	B	C	D	E	F	G	G1	H	I	J	K	L1	L2	M	N	a	b	c	d	E	U*S
DFT 7-7R2	323	336	259	228	188	155	281	162	742	294	30	4	80	184	180	180	6	6	22.5	20	60	9*12
DFT 9-9R2	384	396	298	262	217	185	320	222	880	350	34	4	80	244	324	274	6	6	22.5	20	60	9*12
DFT 10-10R2	429	452	331	288	251	203	353	242	966	399	30	4	90	264	383	330	7	8	28	25	60	9*12
DFT 12-12R2	497	534	395	343	296	230	425	294	1174	467	30	5	110	324	443	371	7	8	28	25	70	11*16
DFT 15-15R2	574	620	471	404	341	264	501	354	1386	539	35	5	130	384	530	449	7	8	33	30	90	11*16
DFT 18-18R2	690	751	557	478	413	314	597	418	1652	655	35	5	130	458	641	545	8	10	38	35	90	11*16
DFT 20-20R2	796	868	640	590	488	361	680	470	1870	750	46	5	150	510	750	628	8	12	43	40	90	11*16

All dimensions in mm

DFT7-7

FEG 75



L-R

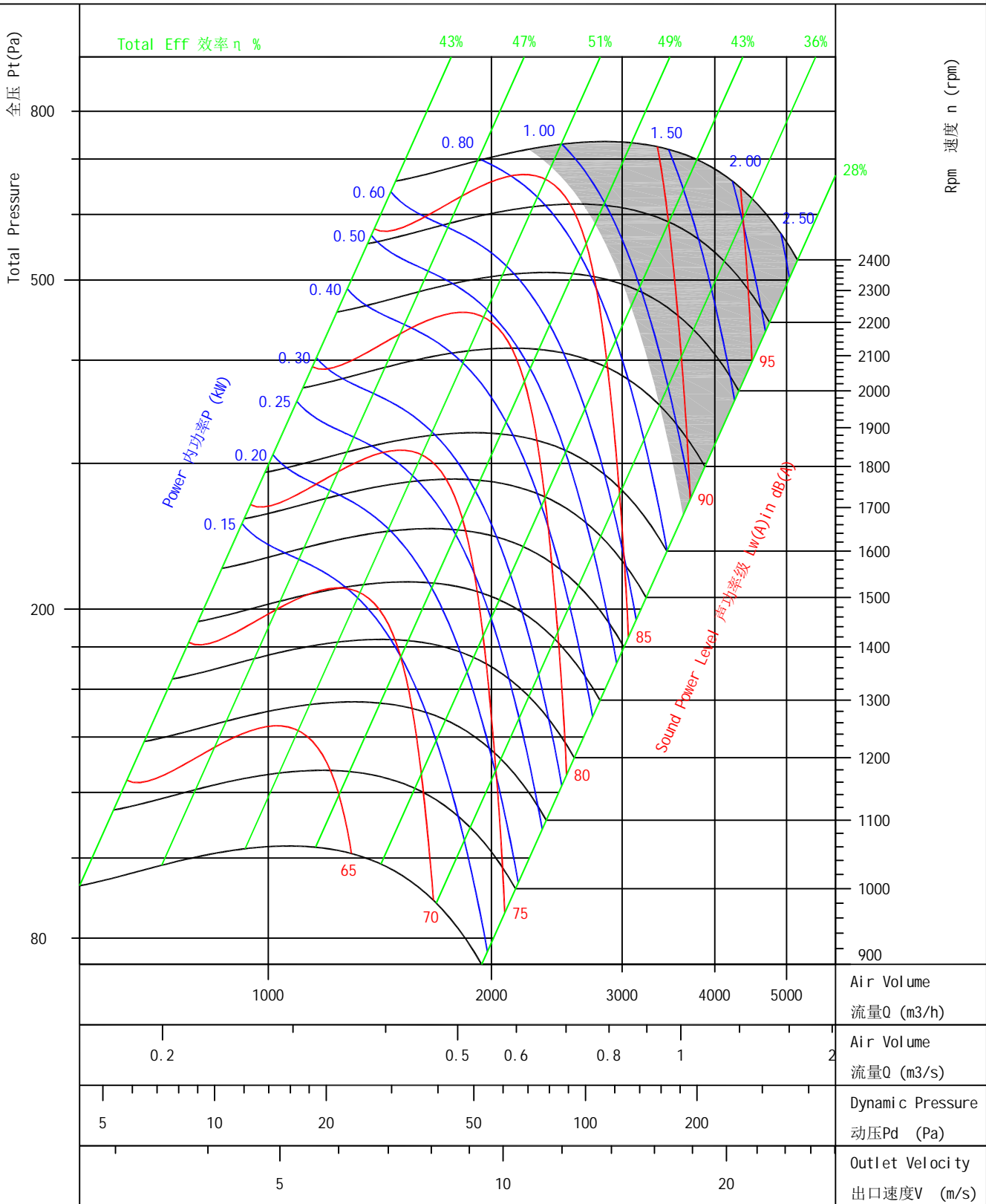

1. Performance certified is for installation type B-Free inlet, Ducted outlet. Power rating(kW) does not include transmission losses. Performance ratings do not include the effects of appurtenances(accessories).
 2. The A-weighted sound ratings shown have been calculated per AMCA International Standard
 3. Values shown are for inlet LwiA sound power levels for installation type B-free inlet, ducted outlet.

DFT9-9

FEG 75



L-R

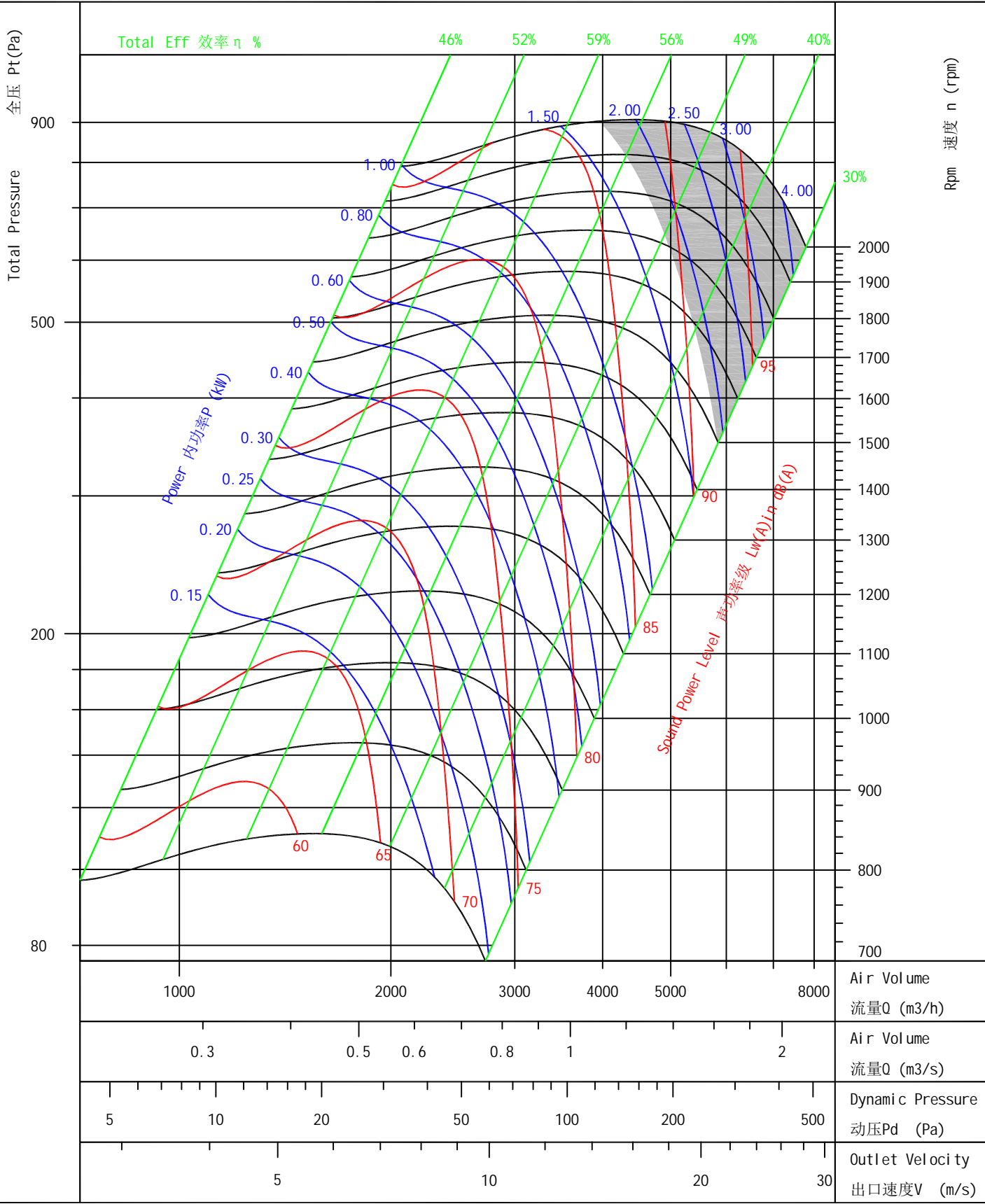

1. Performance certified is for installation type B-Free inlet, Ducted outlet. Power rating(kW) does not include transmission losses. Performance ratings do not include the effects of appurtenances(accessories).
 2. The A-weighted sound ratings shown have been calculated per AMCA International Standard
 3. Values shown are for inlet Lw(A) sound power levels for installation type B-free inlet, ducted outlet.



L-R

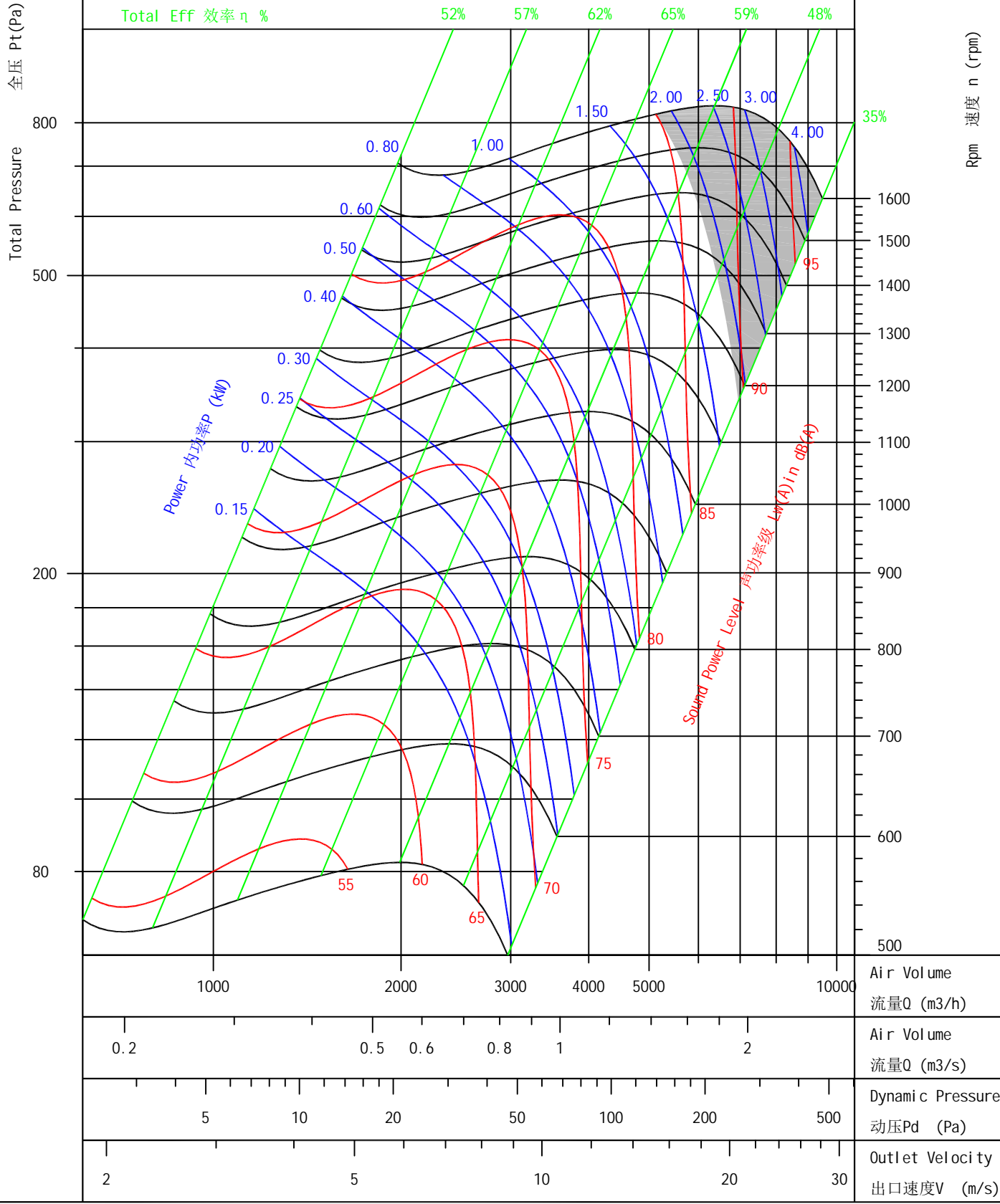

1. Performance certified is for installation type B-Free inlet, Ducted outlet. Power rating (kW) does not include transmission losses. Performance ratings do not include the effects of appurtenances (accessories).
 2. The A-weighted sound ratings shown have been calculated per AMCA International Standard 3. Values shown are for inlet L_wA sound power levels for installation type B-free inlet, ducted outlet.

L R

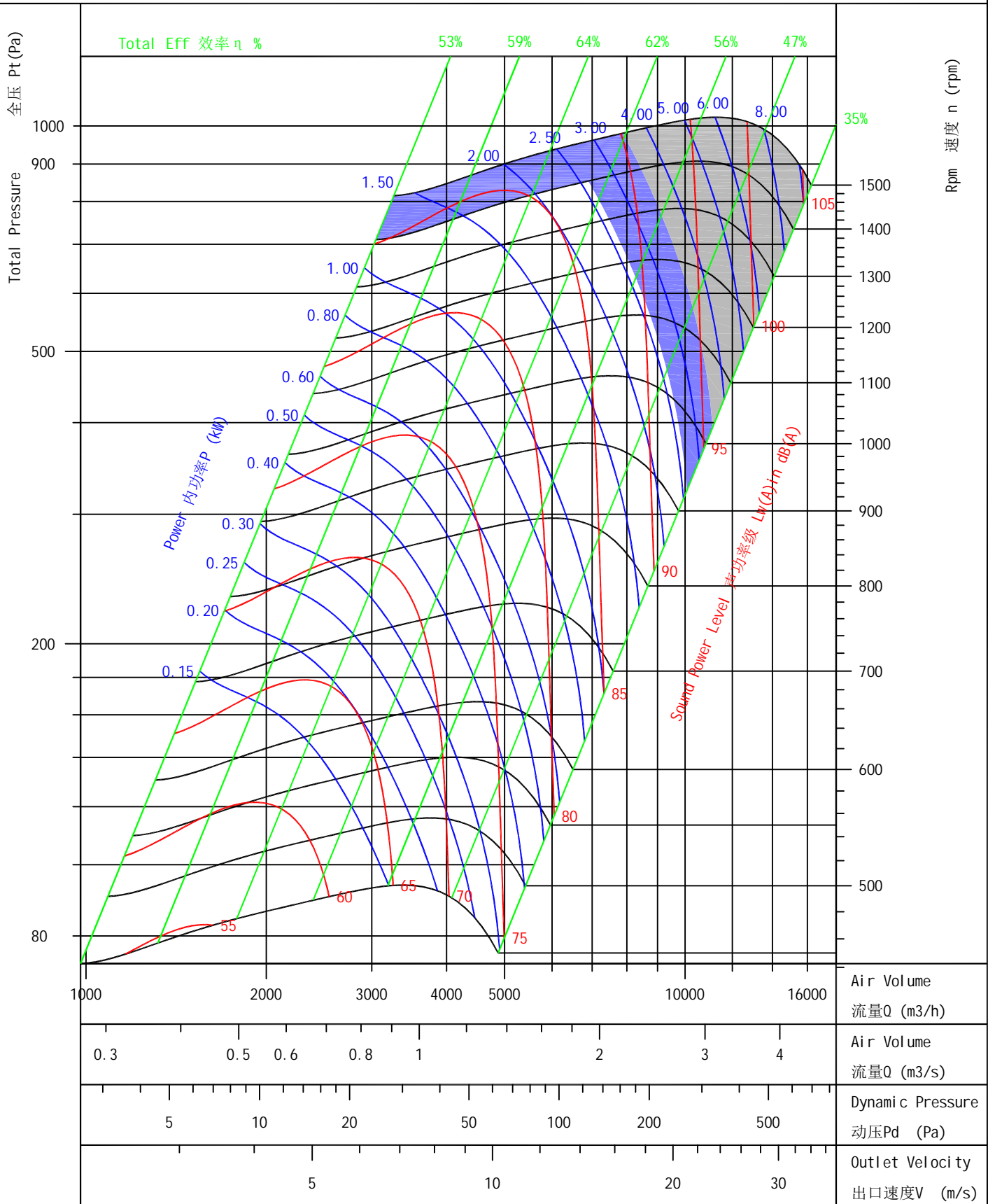

1. Performance certified for installation type B-Free inlet, Ducted outlet. Power rating (kW) does not include transmission losses. Performance ratings do not include the effects of appurtenances (accessories).

2. The A-weighted sound ratings shown have been calculated per AMCA International Standard

3. Values shown are for inlet L_{wi}A sound power levels for installation type B-free inlet, ducted outlet.

DFT15-15

FEG 80



L-R

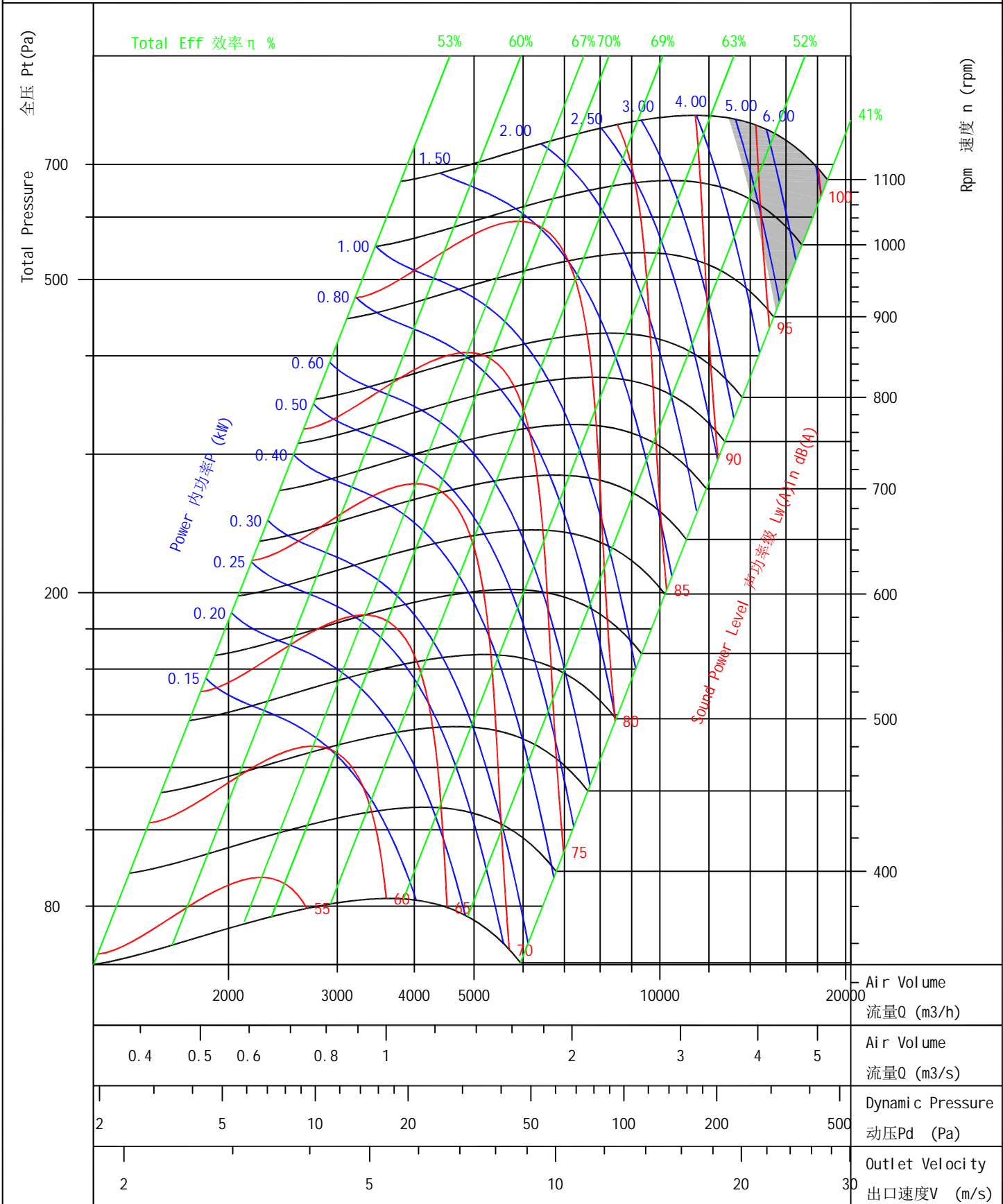

1. Performance certified for installation type B-Free inlet, Ducted outlet. Power rating (kW) does not include transmission losses. Performance ratings do not include the effects of appurtenances (accessories).
 2. The A-weighted sound ratings shown have been calculated per AMCA International Standard 3. Values shown are for inlet Lw(A) sound power levels for installation type B-free inlet, ducted outlet.

L R

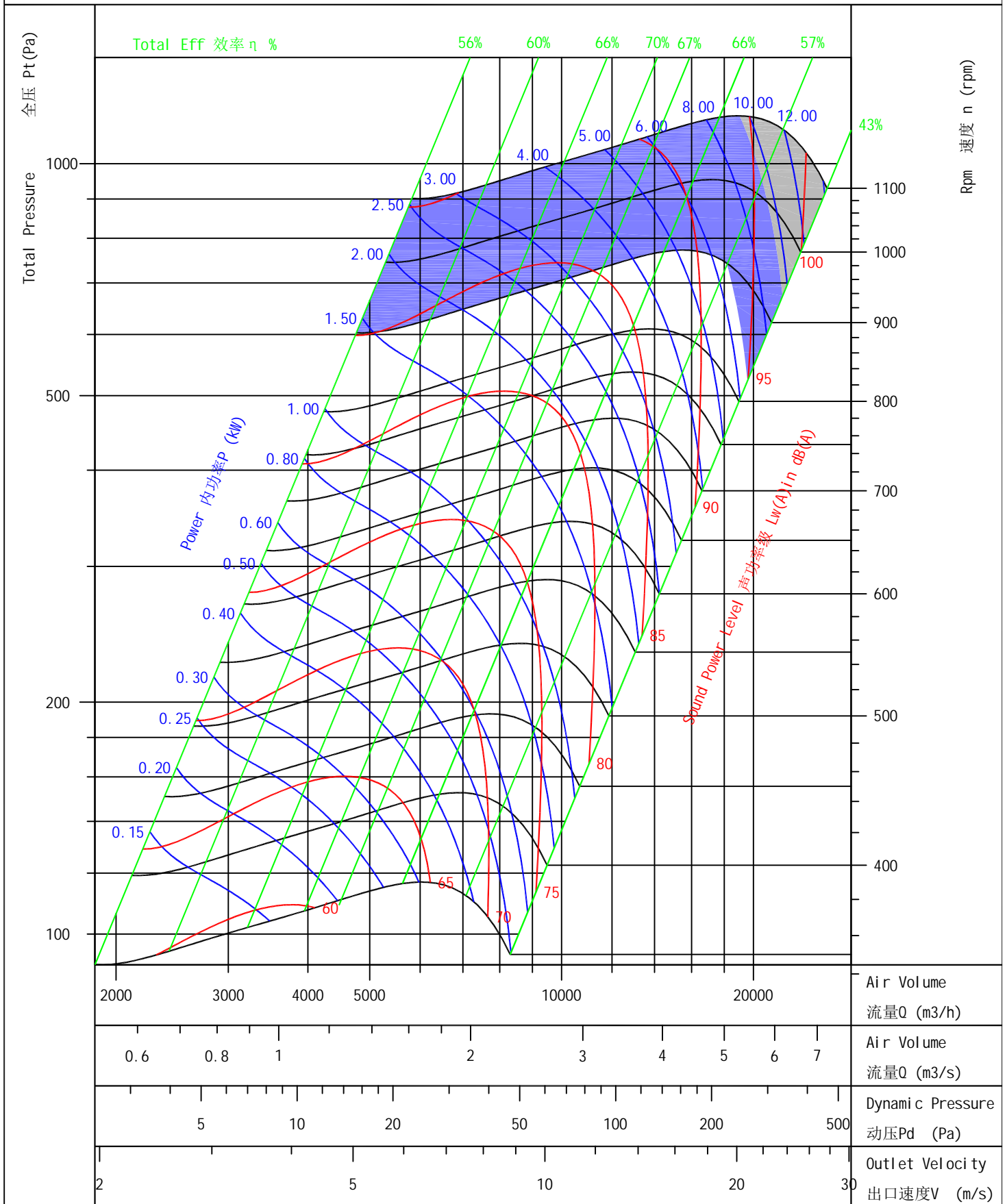

1. Performance certified is for installation type B-Free inlet, Ducted outlet. Power rating(kW) does not include transmission losses. Performance ratings do not include the effects of appurtenances(accessories).

2. The A-weighted sound ratings shown have been calculated per AMCA International Standard

3. Values shown are for inlet L_{wA} sound power levels for installation type B-free inlet, ducted outlet.



R

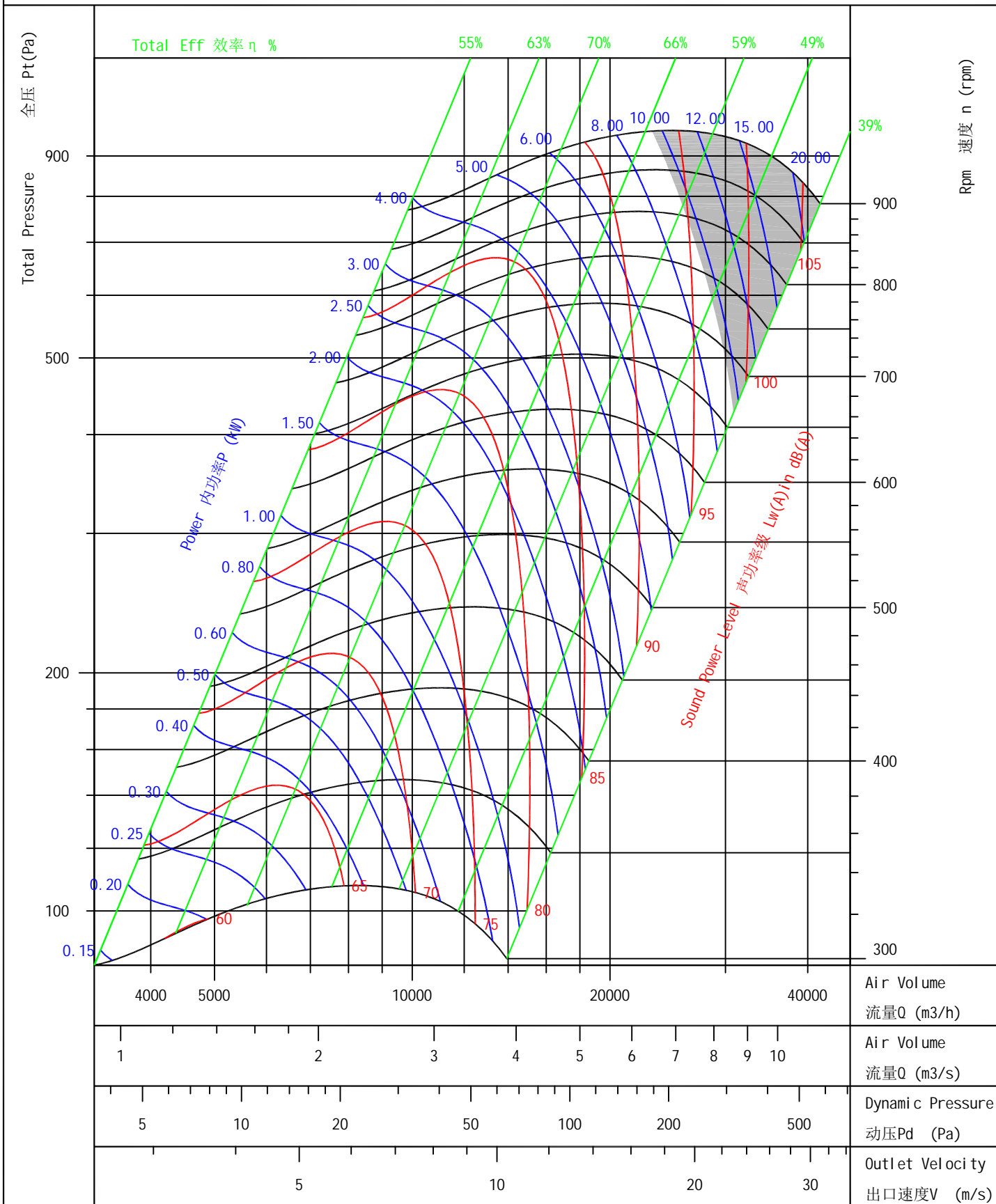

1. Performance certified is for installation type B-Free inlet, Ducted outlet. Power rating (kW) does not include transmission losses. Performance ratings do not include the effects of appurtenances (accessories).
 2. The A-weighted sound ratings shown have been calculated per AMCA International Standard
 3. Values shown are for inlet L_{WA} sound power levels for installation type B-free inlet, ducted outlet.



Germany Factory (HQ)

Germany Factory DLK Ventilatoren GmbH
Address Ziegeleistra e 18,
74214 Schontal, Germany
Phone +49 7943 91020
Email sales.asia@dlk.com

Malaysia Factory (Regional HQ)

Malaysia Factory DLK Ventilatoren Malaysia Sdn. Bhd.
Address 22, Jalan Mega 2/1, Kawasan
Perindustrian Mega 2, 43500 Semenyih,
Selangor, Malaysia
Phone (603) 8725 0845
Email sales@dlkasia.com

WWW.DLKASIA.COM

SALES NETWORK EUROPE

•Belgium• Poland• Switzerland• Turkey• Egypt• Great Britain
• Czech Republic • Kazakhstan

SALES NETWORK ASIA

• China • Malaysia • Vietnam • Singapore • Philippines • Taiwan
• Bangladesh • South Korea • Australia

Malaysia Distributor