

**Model RS-7705**  
**7" (177.8 mm) Storm Resistant Fixed Horizontal Louvre**

**Material:**

<b>Material:</b>	6063-T6 Alloy
<b>Nominal Thickness:</b>	Head: 0.063" (1.60 mm) Sills, Jamb & Mullions: 0.081" (2.05 mm)
<b>Nominal Blade Thickness:</b>	0.075" (1.91 mm)
<b>Furnished With:</b>	Birdscreen: ½" intercrimp aluminum mesh, 0.063" diameter wire removeable aluminum bird screen in an aluminum frame
<b>Additional Options (at additional cost):</b>	Insect screen (in lieu of bird screen), Continuous clip angles for attachment Sheet blank off, Insulated blank off Sill pans, Flange frames Integrated glazing frames

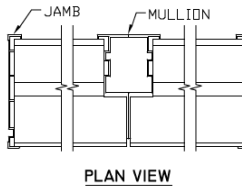
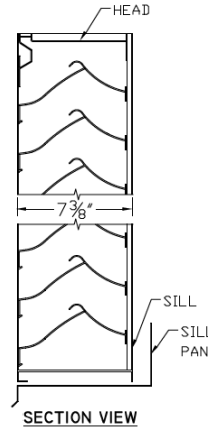

**Test Summary:**

**For a 4 Foot by 4 Foot Unit.**

*Tested with mill finish and no screen*

- Free area = 8.00 ft<sup>2</sup> (0.743 m<sup>2</sup>)
- Percent free area = 50.0%
- Free area velocity at the point of beginning water penetration (@ 0.01 oz. / ft<sup>2</sup> of free area based on a 15 minute interval test) = 1,240 FPM (6.30 m/s)
- Intake pressure drop at 0.01 oz. / ft<sup>2</sup> free area velocity = 0.43 in. H<sub>2</sub>O (105.8 Pa)
- To maintain a CLASS A (99%) effectiveness rating\* with:
  - a 29 mph wind speed and rainfall rate of 3 in/hr
    - Max. intake core velocity 2.5 m/s (483 FPM)
    - Max. intake free area velocity 4.4 m/s (871 FPM)

**Discharge Coefficient**

Intake Cd = 0.26 (Class 3)

AMCA certifies the coefficient class only



**Construction Specialties Australia Pty Ltd. certifies that the louvre model RS-7705 shown herein is licensed to bear the AMCA Seal.**

The ratings shown are based on tests and procedures performed in accordance with AMCA Publication 511 and comply with the requirements of the AMCA Certified ratings Program. The AMCA Certified Ratings Seal applies to Wind Driven Rain ratings, Water Penetration Ratings and Air Performance ratings.

**Wind Driven Rain Performance: Tested with 1m<sup>2</sup> core area, mill finish and no screen\***

29.1 mph (13 m/s) & 3" (75 mm) rain per hour

<b>Core Velocity Through Cal. Plate (m/s):</b>	0.0	0.5	1.0	1.5	2.0	2.5	3.0	3.5	4.0	4.5	5.0
<b>Core Velocity Through Louvre (ft/min):</b>	0	132	197	295	374	483	584	680	758	870	991
<b>Free Area Velocity (ft/min):</b>	0	238	355	532	675	871	1054	1227	1368	1570	1788
<b>Rating Effectiveness:</b>	A	A	A	A	A	A	B	B	B	B	C
<b>Effectiveness Ratio (%):</b>	100	100	100	100	99.9	99.6	98.8	98.0	98.1	95.6	93.2
<b>Effectiveness Rating:</b>	A = 1 to 0.99			B = 0.989 to 0.95			C = 0.949 to 0.80			D = Below 0.80	

**Model RS-7705**  
**7" (177.8 mm) Storm Resistant Fixed Horizontal Louvre**

**Water Penetration Statement**

AMCA defines the point of beginning water penetration as the free area velocity at which the AMCA water test has yielded 0.01 or less ounces of water per square foot of louvre free area during a 15-minute test period.

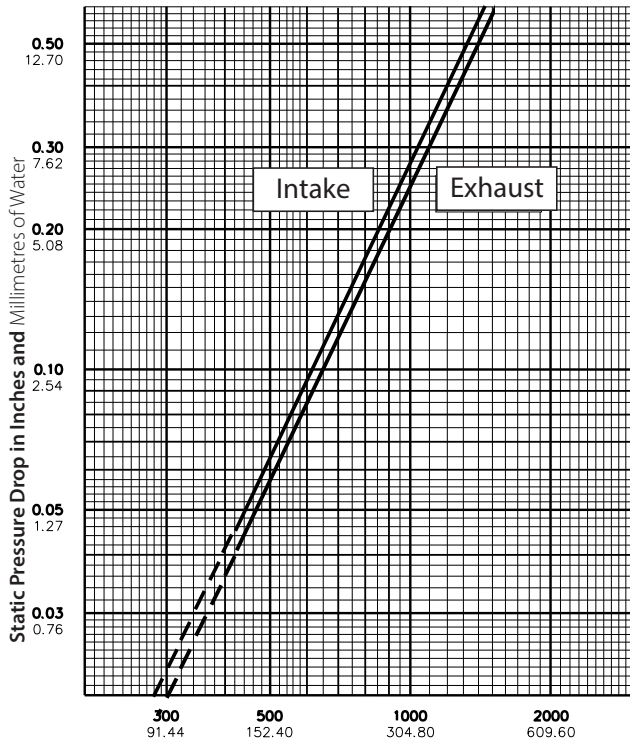

**Air Velocity in Feet and Metres per Minute Through Free Area**

Data corrected to standard air density.  
 48" x 48" louvre tested to figure 5.5.

**Free Area Table** (Free area in sq. feet and sq. metres)

For additional sizes, please visit:

<https://www.c-sgroup.com/architectural-louvers/louvers-airflow-tool>

**Width in Inches and Metres**

	18	24	30	36	42	48	54	60	66	72	78	84	90
	0.46	0.61	0.76	0.91	1.07	1.22	1.37	1.52	1.68	1.83	1.98	2.13	2.29
18	0.95	1.30	1.65	2.00	2.35	2.70	3.05	3.40	3.75	4.10	4.45	4.80	5.04
24	1.33	1.82	2.31	2.80	3.29	3.78	4.27	4.76	5.25	5.74	6.24	6.73	7.06
30	1.71	2.34	2.97	3.60	4.23	4.86	5.50	6.13	6.76	7.39	8.02	8.65	9.09
36	2.09	2.87	3.64	4.41	5.18	5.96	6.73	7.50	8.27	9.05	9.82	10.59	11.12
42	2.45	3.35	4.26	5.16	6.06	6.97	7.87	8.78	9.68	10.58	11.49	12.39	13.01
48	2.84	3.89	4.94	5.98	7.03	8.00	9.13	10.18	11.23	12.28	13.32	14.37	15.09
54	3.22	4.40	5.59	6.78	7.97	9.15	10.34	11.53	12.72	13.90	15.09	16.28	17.10
60	3.59	4.92	6.25	7.57	8.90	10.23	11.55	12.88	14.21	15.53	16.86	18.19	19.10
66	3.97	5.44	6.90	8.37	9.83	11.30	12.77	14.23	15.70	17.16	18.63	20.10	21.10
72	4.35	5.95	7.56	9.16	10.77	12.37	13.98	15.58	17.19	18.79	20.40	22.00	23.11
78	4.72	6.47	8.21	9.96	11.70	13.45	15.19	16.93	18.68	20.42	22.17	23.91	25.11
84	5.10	6.98	8.87	10.75	12.63	14.52	16.40	18.28	20.17	22.05	23.94	25.82	27.11
90	5.48	7.50	9.52	11.55	13.57	15.59	17.61	19.64	21.66	23.68	25.70	27.73	29.12
96	6.00	8.22	10.43	12.65	14.86	17.08	19.29	21.51	23.73	25.94	28.16	30.37	31.90
102	6.38	8.74	11.09	13.45	15.80	18.16	20.52	22.87	25.23	27.58	29.94	32.29	33.91
108	6.76	9.26	11.76	14.25	16.75	19.25	21.74	24.24	26.74	29.23	31.73	34.23	35.94
114	7.15	9.79	12.43	15.07	17.70	20.34	22.98	25.62	28.26	30.90	33.54	36.18	37.99
120	7.51	10.29	13.06	15.83	18.61	21.38	24.16	26.93	29.70	32.48	35.25	38.02	39.93
126	7.89	10.80	13.72	16.63	19.54	22.45	25.37	28.28	31.19	34.11	37.02	39.93	41.94
132	8.27	11.32	14.37	17.42	20.47	23.53	26.58	29.63	32.68	35.74	38.79	41.84	43.94
138	8.64	11.83	15.03	18.22	21.41	24.60	27.79	30.98	34.17	37.37	40.56	43.75	45.94
144	9.02	12.35	15.68	19.01	22.34	25.67	29.00	32.33	35.66	38.99	42.33	45.66	47.95
150	9.40	12.87	16.34	19.81	23.28	26.75	30.22	33.68	37.15	40.62	44.09	47.56	49.95
156	9.77	13.38	16.99	20.60	24.21	27.82	31.43	35.04	38.64	42.25	45.86	49.47	51.95
162	10.15	13.90	17.65	21.39	25.14	28.89	32.64	36.39	40.13	43.88	47.63	51.38	53.96
168	10.67	14.61	18.55	22.49	26.43	30.37	34.31	38.25	42.20	46.14	50.08	54.02	56.73
174	11.05	15.13	19.21	23.29	27.37	31.45	35.54	39.62	43.70	47.78	51.86	55.94	58.74
180	11.43	15.65	19.87	24.10	28.32	32.54	36.76	40.98	45.20	49.42	53.64	57.86	60.77
186	11.82	16.18	20.54	24.90	29.27	33.63	37.99	42.35	46.72	51.08	55.44	59.80	62.80
192	12.17	16.67	21.16	25.65	30.15	34.64	39.14	43.63	48.12	52.62	57.11	61.61	64.70
198	12.56	17.20	21.84	26.48	31.12	35.75	40.39	45.03	49.67	54.31	58.95	63.58	66.77
	5.03	1.17	1.60	2.03	2.46	2.89	3.32	3.75	4.18	4.61	5.05	5.48	5.91

Upper Numerals English Units/Lower Numerals Metric Units