

SAFE LOUVER

GE-H80/70



PRODUCT CATALOG



今一鋁科技
科技與鋁窗的結合

GE-H80/70

Double structure of vertical and horizontal

- FRAME Extruded 6063-T5 Aluminum
- BLADE 6063-T5 of 1.5 ~ 2.0mm thickness

- Minimum size
(W) 12 in. , (H) 12 in.
- Maximum size
(W) 78 in. , (H) 78 in.

- ◆ OPTIONS
 - Bird and Insect screens (Stainless steel)
 - Duct flange (Steel)
 - Fire damper (Steel)
 - Other parts

Technical Advisor Companies : SANKI LOUVER CO., LTD. [JAPAN]

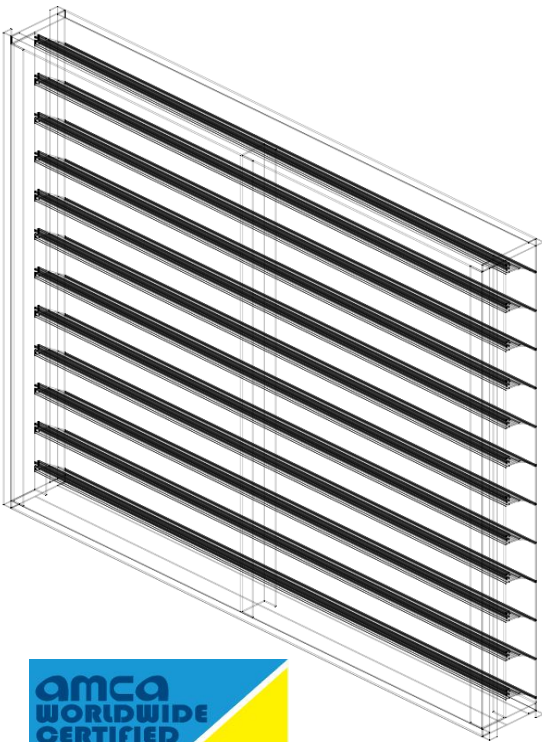

Proof of reliability

GE-H80/70 is suitable for using in prestige mega size project around the country.
With its low water penetration rate and high permissible ventilation performance.
We, G.E. louver, offer variety of Storm-proof/ Wind-driven louvers in different models and shape.

Minimize rain penetration under strong wind pressure.

With high percentage of Free Area.
(i.e.High free opening ratio)

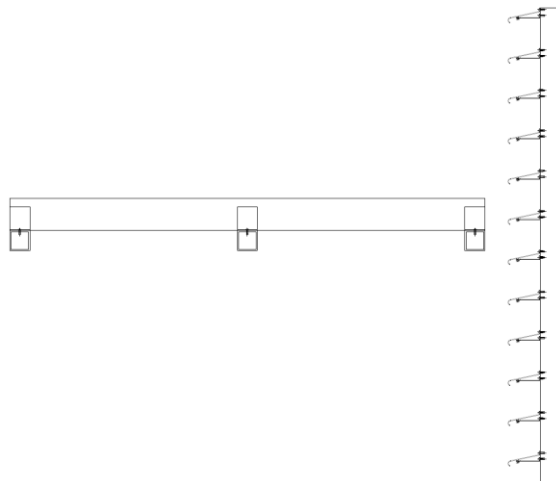
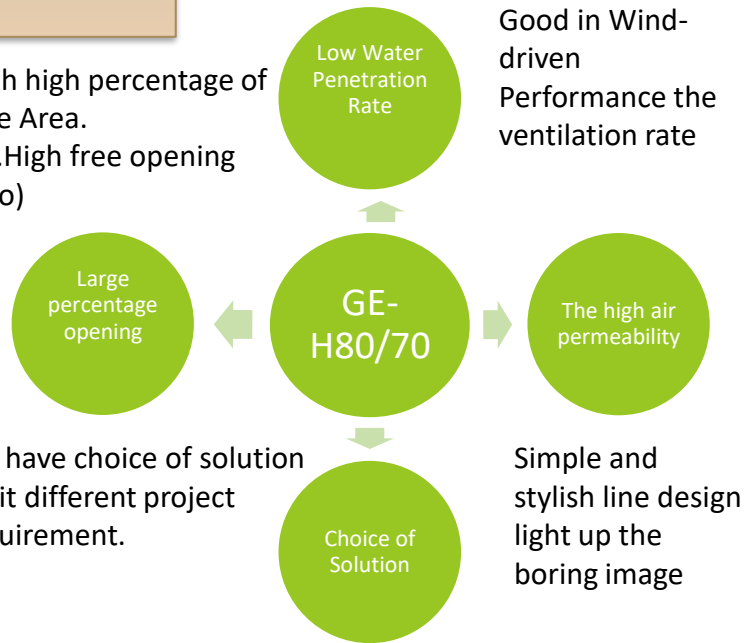

"G.E. Aluminum Technology Co., Ltd. certifies that the GE-H80/70 shown herein is licensed to bear the AMCA Seal. The ratings shown are based on tests and procedures performed in accordance with AMCA Publication 511 and comply with the requirements of the AMCA Certified Ratings Program.
The AMCA Certified Rating Seal applies to , air performance only.

GE-H80/70 Louver Free Area (Test Sample 48"x48")(SQ.FT.)
 Height-inches

	12	18	24	30	36	42	48	54	60	66	72	78
12	0.26	0.59	0.91	1.24	1.57	1.89	2.22	2.55	2.87	3.20	3.53	3.85
18	0.44	0.99	1.54	2.10	2.65	3.20	3.75	4.31	4.86	5.41	5.96	6.52
24	0.60	1.35	2.11	2.86	3.62	4.37	5.13	5.88	6.64	7.39	8.14	8.90
30	0.78	1.76	2.74	3.72	4.70	5.68	6.66	7.64	8.62	9.60	10.58	11.57
36	0.94	2.12	3.30	4.49	5.67	6.85	8.03	9.22	10.40	11.58	12.77	13.95
42	1.11	2.52	3.93	5.33	6.74	8.14	9.55	10.96	12.36	13.77	15.18	16.58
48	1.27	2.88	4.49	6.10	7.71	9.32	10.93	12.54	14.15	15.76	17.37	18.98
54	1.45	3.28	5.10	6.93	8.76	10.59	12.42	14.24	16.07	17.90	19.73	21.56
60	1.61	3.65	5.69	7.73	9.77	11.81	13.85	15.89	17.93	19.97	22.00	24.04
66	1.78	4.03	6.28	8.53	10.78	13.03	15.28	17.53	19.78	22.03	24.28	26.53
72	1.95	4.42	6.89	9.35	11.82	14.29	16.76	19.22	21.69	24.16	26.62	29.09
78	2.12	4.79	7.46	10.13	12.80	15.47	18.15	20.82	23.49	26.16	28.83	31.51

WIND DRIVEN RAIN TEST

*These data is the numerical value in the test sample for AMCA's test which Extra Frame was attached to.
 Tested product outside dimension is 1219mmx1219mm(48in.x48in.).

Free Area Velocity (fpm)	Pressure Drop (in.wg)
404	0.017
792	0.064
1194	0.146
1590	0.261
1987	0.407

404	0.017
792	0.064
1194	0.146
1590	0.261
1987	0.407

Air Performance

Unit test size(48"x48")

Airflow rate at standard air density and the AMCA figure 5.5

Contract Test

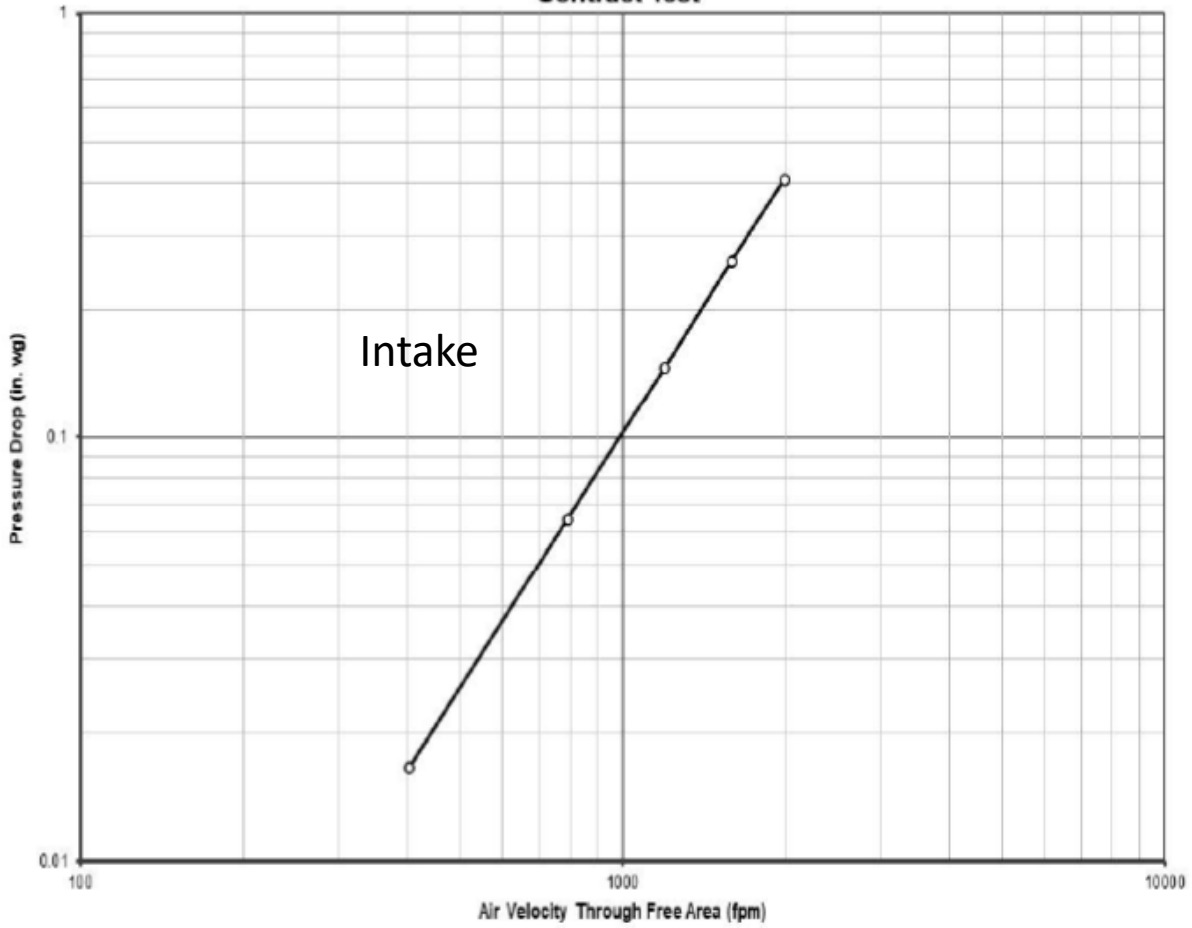

PRESSURE DROP TEST

Free Area Velocity (fpm)	Pressure Drop (in.wg)
401	0.020
794	0.078
1194	0.175
1590	0.314
1988	0.491

401	0.020
794	0.078
1194	0.175
1590	0.314
1988	0.491

Air Performance

Unit test size(48"x48")

Airflow rate at standard air density and the AMCA figure 5.5

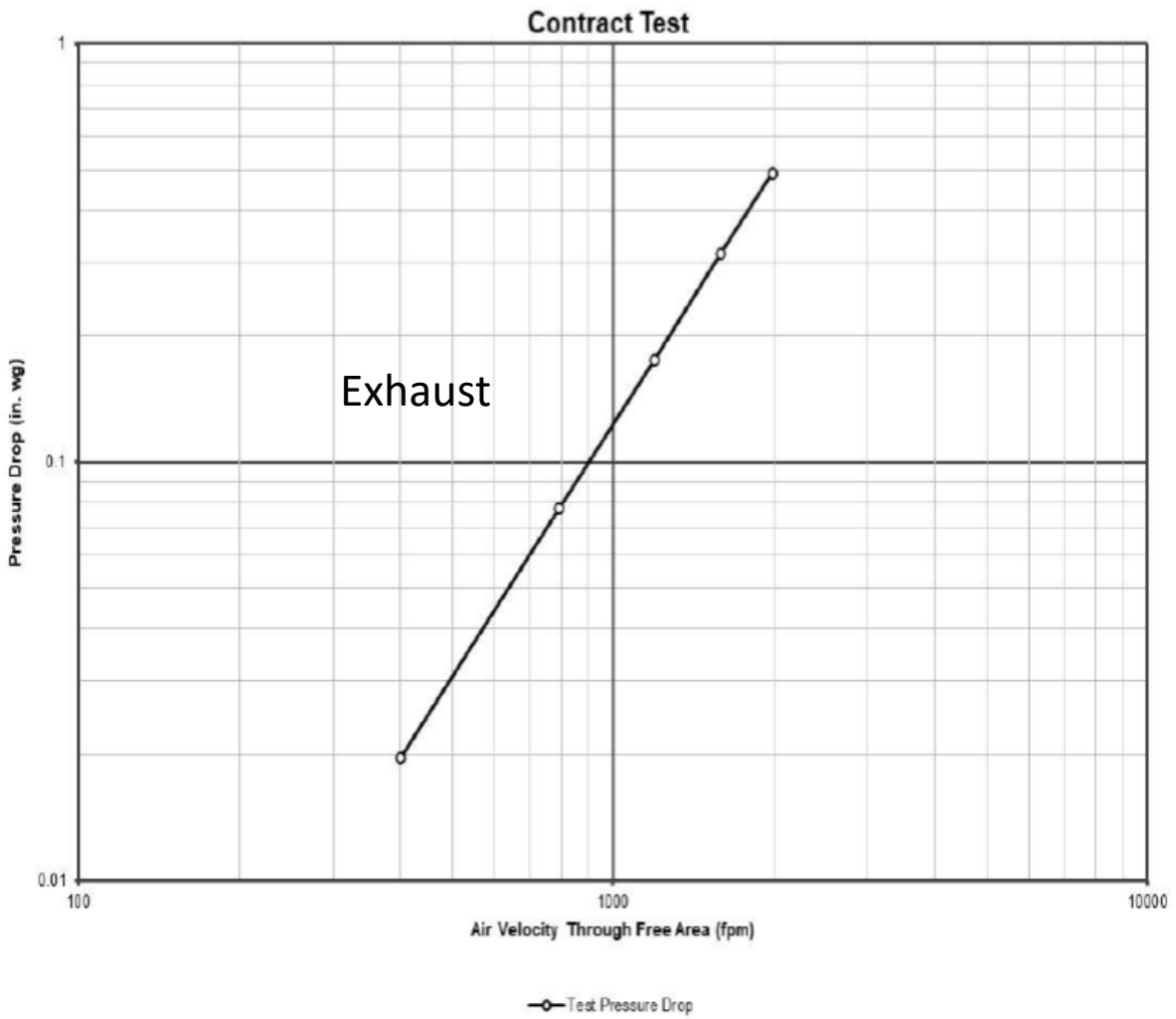

PRESSURE DROP TEST



今一鋁科技
科技與鋁窗的結合

G.E. Aluminum Technology Co., Ltd.

No. 37, Wuquan 7th Rd., Wugu District, New Taipei City, Taiwan 24890

TEL: +886-2-22999349 FAX: +886-2-22999149