

prioAir SERIES

VANE AXIAL INLINE DUCT FAN



fantech

Dimensional Diagram:

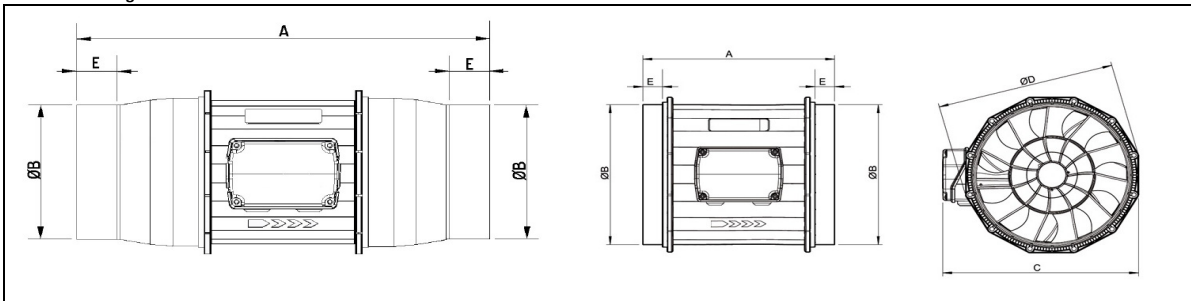

Dimensional Table:

Model	A	B	C	D	E
prioAir 6	16-3/16	5-7/8	8-1/4	7-3/8	1-5/8
prioAir 8	9-11/16	7-7/8	9-3/4	9	1
prioAir 10	12	9-13/16	11-15/16	11-1/4	1

Dimensions are in inches (mm)

Performance Data:

Certified Data

Model Name	Energy Star	Rated Power W	Voltage/p hase V/~	Max Amp A	RPM min ⁻¹		Static Pressure (inch W.C.)						Max Ps (Inch W.C.)
							0	0.2	0.4	0.6	0.8	1	
prioAir 6	YES	37	120/1	0.29	2800	CFM Sone dB(A)	295 - -	252 8.9 67	195 - -	38 - -	- - -	- - -	0.72
prioAir 6 EC	YES	66	120/1	1.05	4000	CFM Sone dB(A)	443 - -	418 11.3 74	387 - -	352 - -	313 - -	261 - -	88
prioAir 8	YES	93	120/1	0.81	3000	CFM Sone dB(A)	646 - -	602 15.3 76	553 - -	487 - -	351 - -	181 - -	54
prioAir 8 EC	YES	128	120/1	1.8	3600	CFM Sone dB(A)	791 - -	745 13.7 77	702 - -	656 - -	604 - -	534 - -	423
PrioAir 10	YES	304	120/1	2.63	3000	CFM Sone dB(A)	1380 - -	1324 17.7 81	1264 - -	1200 - -	1127 - -	1043 - -	937
prioAir 10 EC	YES	164	120/1	2.4	2700	CFM Sone dB(A)	1237 - -	1156 14 77	1079 - -	997 - -	900 - -	769 - -	560

Performance certified is for installation type D: Ducted inlet, Ducted outlet.

Speed (RPM) shown is nominal. Performance is based on actual speed of test.

Performance ratings do not include the effects of appurtenances (accessories).

The sound ratings shown are loudness values in hemispherical sones at 1.5 m (5 ft) in a hemispherical free field calculated per AMCA Standard 301.

Values shown are for Installation Type D: ducted inlet hemispherical sone levels. Ratings do not include the effects of duct end correction.

All sone values shown are calculated at 0.2" (static pressure in inches W.G.).

Certifications:



Fantech, Inc. certifies that all models shown are licensed to bear the AMCA Seal. The ratings are based on the tests and procedures performed in accordance with AMCA Publication 211 and publication 311 and comply with the requirements of the AMCA Certified Ratings Program. Performance certified is for installation type D- Ducted inlet, Ducted outlet. Performance ratings do not include the effects of appurtenances (accessories).



Revision Date:

April 2017

Article No.:

prioAir