

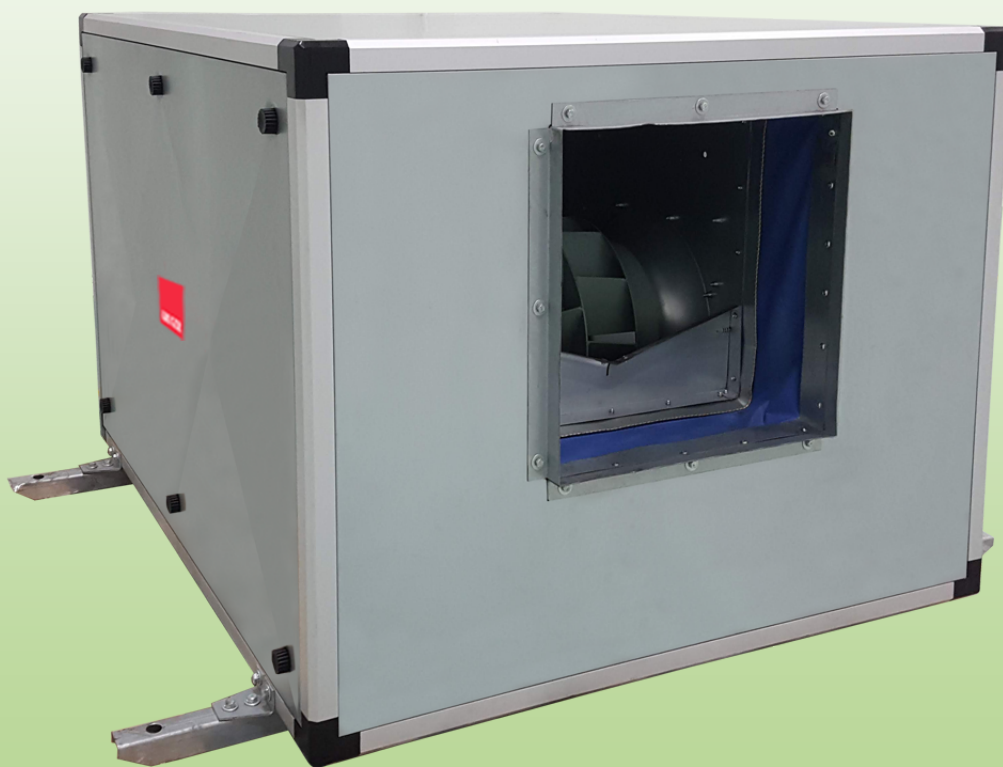

CFQ-B Series

CABINET FAN



Cabinet Fan - CFQ-B Series

KRUGER

- Cabinet is manufactured in galvanized sheet steel incorporated with a belt driven, high efficiency, double inlet, backward curved wheel.
- Complete with inlet & outlet flange as standard.
- Motor and drive assembly can be accessed through removal of two side panels.
- Internal vibration isolator to assure long life and quiet operation.
- Penta Post construction with ABS plastic corner piece, aluminum column and reinforced galvanized sheet panel.
- Acoustic lining is available upon request.
- Standard acoustic lining employs galvanized sheet facing
Perforated sheet facing is available upon request.
- Type of fan use: CFQ 200 to CFQ 710 ---- BDB 'C' type
CFQ 800 to CFQ 1000 ---- BDB 'T' type



Kruger Ventilation Industries Asia Co. Ltd certifies that the **CFQ-B** 315-1000 shown herein is licensed to bear the AMCA Seal. The ratings shown are based on tests and procedures performed in accordance with AMCA Publication 211 and AMCA Publication 311 and comply with the requirements of the AMCA Certified Ratings Program. Model CFQ-B 200-280 are not licensed by AMCA International.

Dimension

90° Orientation

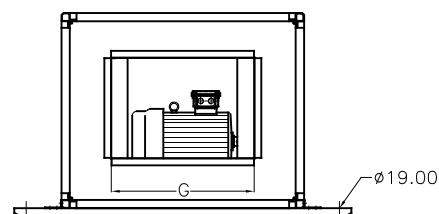
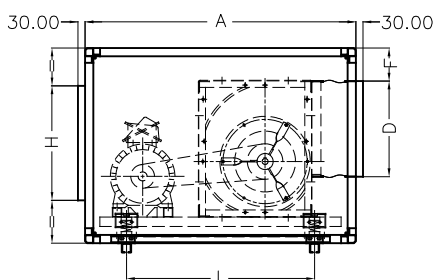
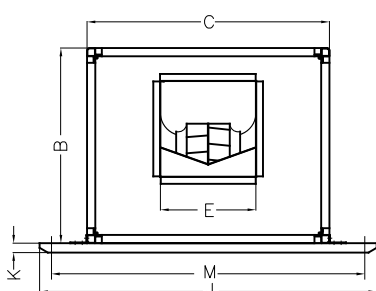

360° Orientation

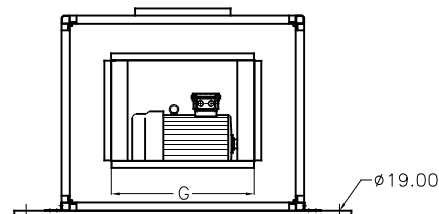
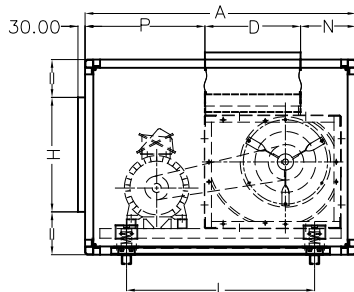
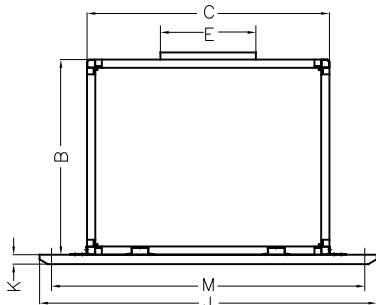

All Dimension in mm.

| Model | A | B | C | D | E | F | G | H | J | K | L | M | N | P | Weight* (kg) | Max. Motor** Frame Size |
|----------|------|------|------|------|------|-----|------|------|------|-----|------|------|-----|------|-----------------|----------------------------|
| CFQ 200 | 825 | 585 | 655 | 256 | 256 | 101 | 465 | 395 | 955 | 40 | 525 | 855 | 174 | 395 | 30 | 100 |
| CFQ 225 | 925 | 655 | 735 | 288 | 288 | 125 | 545 | 465 | 1035 | 40 | 625 | 935 | 174 | 463 | 44 | 112 |
| CFQ 250 | 1025 | 735 | 825 | 322 | 322 | 161 | 635 | 545 | 1225 | 40 | 725 | 1125 | 184 | 519 | 49 | 112 |
| CFQ 280 | 1145 | 735 | 925 | 360 | 360 | 104 | 735 | 545 | 1325 | 40 | 795 | 1225 | 232 | 553 | 55 | 132 |
| CFQ 315 | 1145 | 825 | 1025 | 404 | 404 | 140 | 835 | 635 | 1425 | 40 | 795 | 1325 | 230 | 511 | 63 | 132 |
| CFQ 355 | 1276 | 926 | 1146 | 452 | 452 | 160 | 956 | 736 | 1546 | 40 | 926 | 1446 | 280 | 544 | 78 | 132 |
| CFQ 400 | 1426 | 926 | 1276 | 506 | 506 | 77 | 1086 | 736 | 1676 | 40 | 1076 | 1576 | 309 | 611 | 90 | 160 |
| CFQ 450 | 1426 | 1026 | 1436 | 568 | 568 | 75 | 1246 | 836 | 1836 | 40 | 1026 | 1736 | 363 | 495 | 144 | 160 |
| CFQ 500 | 1662 | 1176 | 1656 | 638 | 638 | 125 | 1434 | 954 | 2056 | 50 | 1262 | 1956 | 373 | 651 | 154 | 160 |
| CFQ 560 | 1746 | 1306 | 1860 | 714 | 714 | 144 | 1640 | 1086 | 2260 | 50 | 1346 | 2160 | 396 | 636 | 181 | 160 |
| CFQ 630 | 1956 | 1456 | 2060 | 800 | 800 | 168 | 1840 | 1236 | 2460 | 50 | 1406 | 2360 | 468 | 688 | 212 | 180 |
| CFQ 710 | 2196 | 1656 | 2300 | 898 | 898 | 195 | 2080 | 1436 | 2800 | 100 | 1496 | 2700 | 534 | 764 | 272 | 180 |
| CFQ 800 | 2196 | 1860 | 2562 | 1006 | 1006 | 233 | 2342 | 1640 | 3062 | 100 | 1497 | 2962 | 542 | 649 | 320 | 200 |
| CFQ 900 | 2592 | 2060 | 2861 | 1130 | 1130 | 253 | 2641 | 1840 | 3361 | 125 | 1892 | 3261 | 667 | 795 | 407 | 225 |
| CFQ 1000 | 2912 | 2300 | 3261 | 1266 | 1266 | 332 | 3041 | 2080 | 3761 | 150 | 2112 | 3661 | 626 | 1020 | 552 | 225 |

* Weight without fan, motor and drive transmission.

** Please consult KRUGER for details when motor frame size is beyond this range.

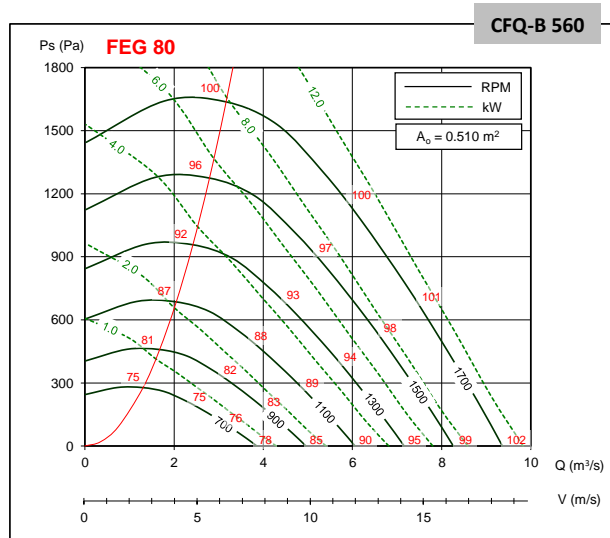
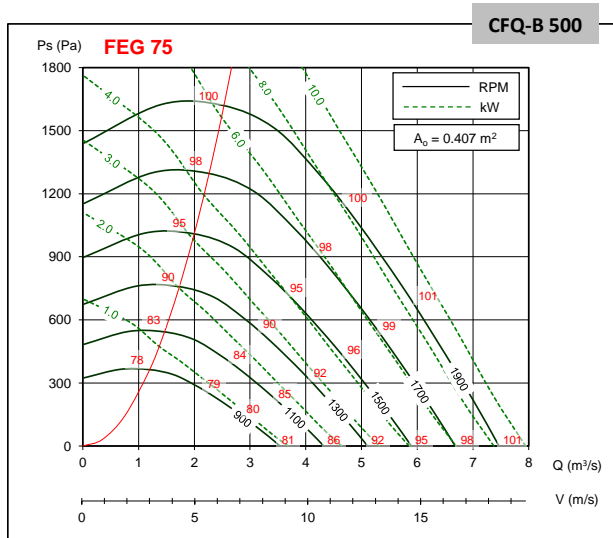
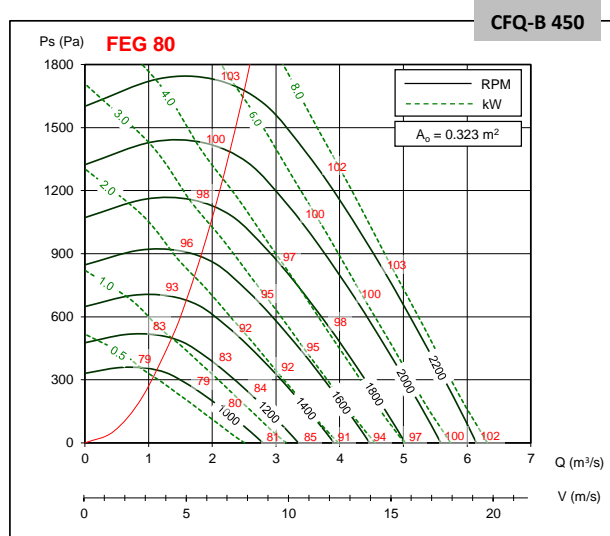
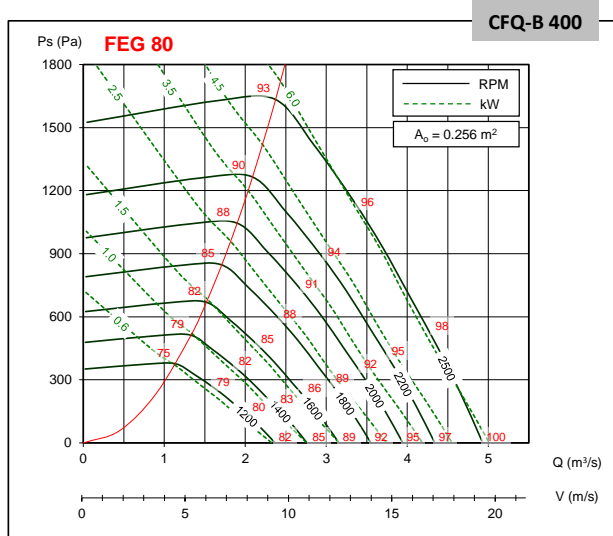
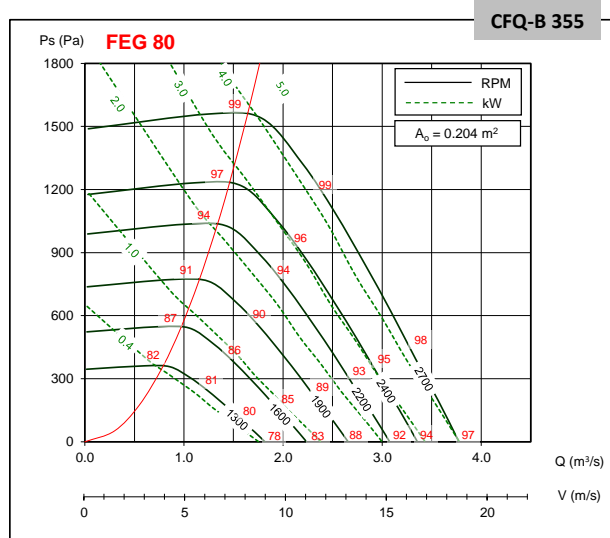
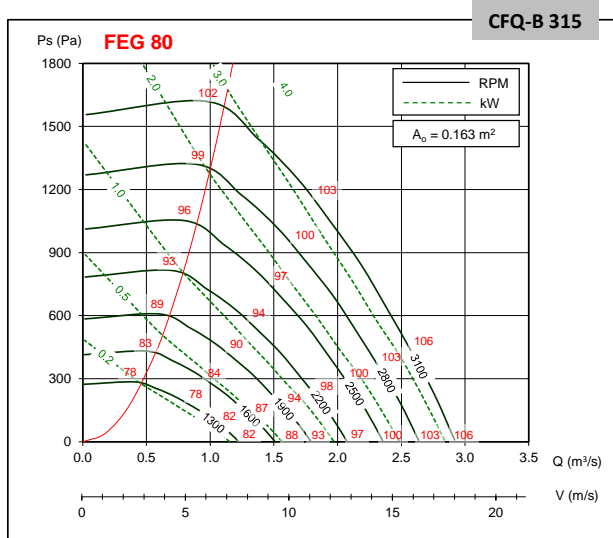

- Values shown are for inlet Lwi(A) sound power levels for installation type D: Ducted inlet, Ducted outlet. The A-weighted sound ratings shown have been calculated per AMCA International Standard 301. Ratings include the effects of duct end correction.
- Performance certified is for installation type D – Ducted inlet, Ducted outlet.
- Performance ratings do not include the effects of appurtenances (accessories).
- Power rating kW does not include transmission losses.

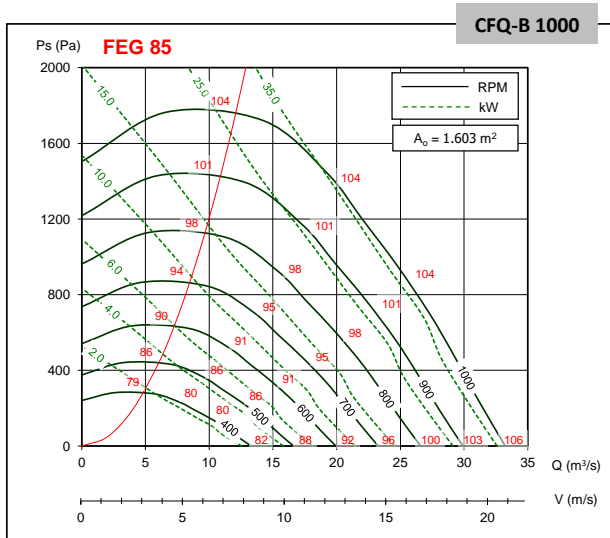
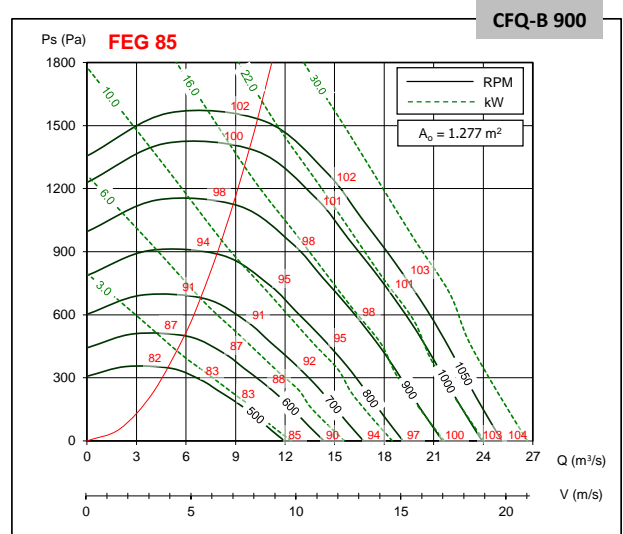
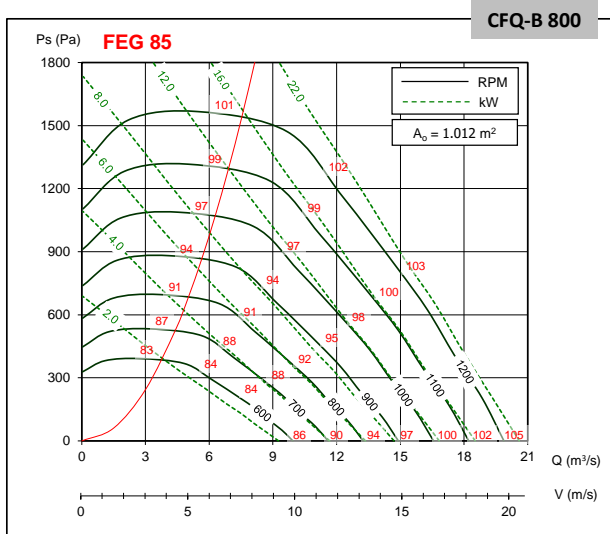
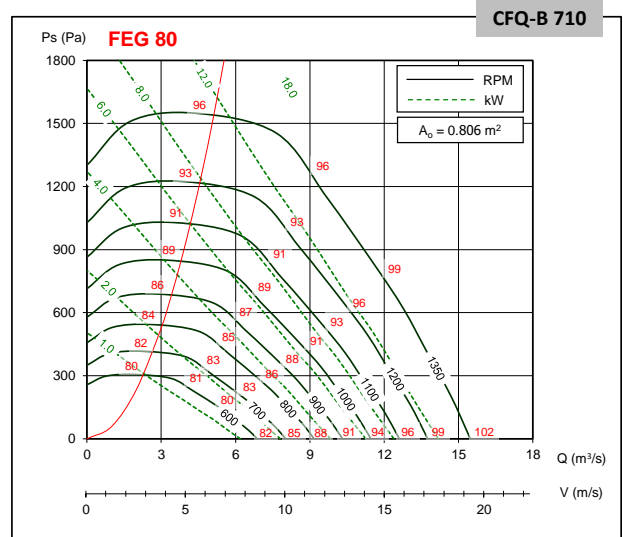
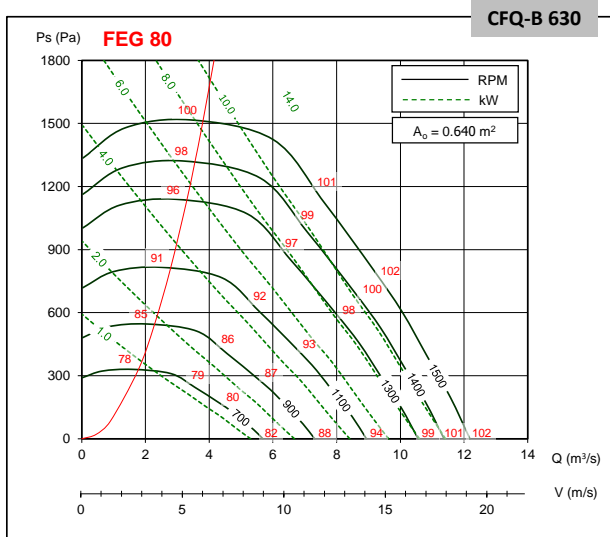

- Values shown are for inlet Lwi(A) sound power levels for installation type D: Ducted inlet, Ducted outlet. The A-weighted sound ratings shown have been calculated per AMCA International Standard 301. Ratings include the effects of duct end correction.
- Performance certified is for installation type D – Ducted inlet, Ducted outlet.
- Performance ratings do not include the effects of appurtenances (accessories).
- Power rating kW does not include transmission losses.

NOTES

This image shows a full page of blank graph paper. The grid consists of thin, light gray horizontal and vertical lines that intersect to form small squares across the entire surface. There are no margins, text, or other markings on the paper.

• THAILAND (Regional HQ)

KRUGER VENTILATION INDUSTRIES ASIA CO. LTD.

30/159 Moo 1, Sinsakorn Industrial Estate,
Chetsadawithi Road, Khok Kham Mueng, Samuthsakorn 74000, Thailand
Tel. +662 1054298 - Fax +662 0248256-9
Website: www.krugerfan.com

• CHINA (BEIJING)

BEIJING KRUGER VENTILATION CO. LTD

Level 7, A Block, Rising International Building, 29 JingHai San Road, BDA,
Beijing, P.R.China 100176
Tel. +86 10-67881366 - Fax +86 10-67880566
Email: krugertj@krugertj.com

• CHINA (SHANGHAI)

SHANGHAI KRUGER VENTILATION CO. LTD

No. 500 Yuanguo Road, Anting, Jiading,
Shanghai 201814 P.R. China
Tel. +86 21-69573266 - Fax +86 21-69573296
Email: shkruger@krugerchina.com

• CHINA (WUHAN)

WUHAN KRUGER VENTILATION CO. LTD

No. 805, Huian Ave, Dongxihu District, Wuhan, Hubei, P.R. China 430000
Tel. +86 27- 83248840/83060522/83097505
Fax +86 27- 83261886
Email: whkruger@krugerwh.com

• HONG KONG

KRUGER VENTILATION (HONG KONG) LIMITED

Flat C, 9/F, Yeung Yiu Chung (No.8) Industrial Building,
20 Wang Hoi Road, Kowloon Bay, Kowloon, Hong Kong
Tel. +852 22469182 - Fax +852 22469187
Email: info@kruger.com.hk

• INDIA (NORTH)

KRUGER VENTILATION INDUSTRIES (NORTH INDIA) PVT LTD

Plot No. - 191, Sector - 59, Ballabgarh, Faridabad - 121 004, Haryana, India
Tel. +91-9958991660/9717449696
Fax. +91-1294135820
Email: sales.kni@krugerindia.com

• KOREA

NEOMATE CO. LTD

2-1010, Ace High Tech City B/D, 775 Gyeongin-ro,
Yeongdeungpo-gu, Seoul, Korea. Postal Code 07299
Tel. +82-2-2679-2052 - Fax. +82-2-2679-2174
Email: y7890@neomate.co.kr

• MYANMAR

KRUGER VENTILATION (MYANMAR) CO.LTD

Room No. F21, Thiri Yadanar Whole Sale Market, (Htawunbe)
Toe Chae Ward, North Okkalapa Township, Yangon.
Tel. +959 763141081/2/3
Email: htoon@krugermm.com

• SINGAPORE

KRUGER ENGINEERING PTE LTD

No. 10 Buroh Street #06-06, West Connect Building,
Singapore 627564
Tel. +65 68631191 - Fax +65 68631151
Email: mktg@krugerasia.com

• THAILAND

KRUGER VENTILATION IND. (THAILAND) CO. LTD

30/105 Moo 1, Sinsakorn Industrial Estate,
Chetsadawithi Road, Khok Kham Mueng, Samuthsakorn 74000, Thailand
Tel. +662 1050399 - Fax + 662 1050370-2
Email: mktg@kruger.co.th

• AUSTRALIA

S&P-KRUGER AUSTRALIA PTY LTD

2 Cunningham St, Moorebank N.S.W. 2170
Tel. +61 2-98227747
Fax. +61 2-98227757
Email: info@sandpkruger.com.au

• CHINA (GUANGZHOU)

GUANGZHOU KRUGER VENTILATION CO. LTD

No. 9 Huahui Road, Huashan, Huadu,
Guangzhou, P.R. China 510880
Tel. +86 20-66356635 - Fax +86 20-86786001/86786500
Email: gzkruger@krugergz.com

• CHINA (TIANJIN)

TIANJIN KRUGER VENTILATION CO. LTD

No.168 Anyuan Road, Jingjin Science and Technology Park
Wuqing District, Tianjin, China
Tel. +86 22-22143480/3481 - Fax +86 22-22143482
Email: krugertj@krugertj.com

• DUBAI

KRUGER VENTILATION INDUSTRIES, GULF BRANCH

Jebel Ali Free Zone Area (JAFZA) P.O. Box No. 262949, Dubai, UAE
Tel. +971 4 8819188/8832017
Fax. +971 4 8832018
Email: johncs@krugerasia.com

• INDIA

KRUGER VENTILATION INDUSTRIES (INDIA) PVT LTD

Kruger Centre, Mumbai-Nasik Highway,
Kalamgaon, Shahapur, Thane 421601, Maharashtra, India
Tel. +91 9960558899/9975577211 - Fax +91 2527 240075
Email: sales@krugerindia.com

• INDONESIA

P.T. KRUGER VENTILATION INDONESIA

JL. Teuku Umar No.20,
Karawaci - Tangerang 15115, Indonesia
Tel. +62 21-5512288/5513557 - Fax +62 21-5513502
Email: mktg@krugerindo.co.id

• MALAYSIA

KRUVENT INDUSTRIES (M) SDN BHD

Lot 850, Jalan Subang 7, Taman Perindustrian Subang,
47500, Subang Jaya, Selangor D.E.
Tel. +603 80743399 - Fax +603 80743388
Email: mktg@kruger.com.my

• PHILIPPINES

KRUGER M&E INDUSTRIES CORPORATION

FAP Compound, E. Rodriguez Ave.
Tunasan, Muntinlupa City 1773, Philippines
Tel. +63 2-8622892/4/6/7, 5534059 - Fax +63 2-8622891
Email: mktg@krugerp.net

• TAIPEI

KRUGER VENTILATION (TAIWAN) CO. LTD

No. 157, Ping-an Rd, Hengfeng Village,
Dayuan Shiang Taoyuan County 337, Taiwan
Tel. +886 3-3859119 - Fax +886 3-3859118
Email: sales@krugertwn.com.tw

• VIETNAM

KRUGER VENTILATION INDUSTRIES (VIETNAM) CO. LTD

Lot A7. 2-4, C2 Road, Thanh Thanh Cong IZ,
Trang Bang Dist. Tay Ninh Province, Vietnam
Tel. +84-276 3585200/01/02 - Fax +84-276 3585199
Email: mktg@krugervn.com

The company is always improving and developing its products, therefore the company reserves the right of making changes to the illustrated products.
Certified dimension can be provided upon request.