



CCE Series (SP) Cabinet Fan

Inline Centrifugal Cabinet Fan



✖ Compact ⚙ Easy to Maintenance 🔊 Low Noise

Why KRUGER?

KRUGER has been a leading innovator and manufacturer of residential, commercial and industrial fan application solutions across Asia since 1985. Today with a direct presence in over 18 regions throughout Asia; world class R&D and manufacturing facilities; KRUGER are able to offer their customers unparalleled service and support at a local level. Our customers place their trust in KRUGER.



What is a KRUGER CCE Inline Centrifugal Cabinet Fan?

The CCE series is a double inlet centrifugal inline fan designed for supply, exhaust and pressurization in general clean air application with CL-F insulation motor. It is compact, generates high flow rate and low noise.

Why use a KRUGER CCE Cabinet Fan?



Compact size

Smaller footprint/space >>>> **More usable area for occupants**

CCE series compact size cabinet require smaller for installation and it could be installed above ceiling.

Low noise

Installation near occupant >>>> **Flexible installation location**

KRUGER CCE Series offer one of the lowest noise /CMH in the industry.



Easy to maintenance

Direct without the belt, bearing and sheaves >>>> **Lower maintenance cost**

CCE fan impeller is directly mouted to motor shaft, eliminate the loss due to drive transmission, require less fan parts and no maintenance needed.

High air volume

Ventilation for larger space >>>> **Suitable for many applications**

CCE paired with DIDW forward curved wheel, which could generate high airflow rate at a small footprint.



Summary of Key Standard CCE Series Specifications

A Airflow and static pressure up to 18,000 CMH and 1000 Pa.

B Airstream Operating Temperatures
Clean air standard ventilation application
-20°C to +40°C.

C Certifications



Kruger Ventilation Industries Asia Co., Ltd certifies that the CCE series shown herein is licensed to bear the AMCA Seal. The ratings shown are based on tests and procedures performed in accordance with AMCA Publication 211 and AMCA Publication 311 and comply with the requirements of the AMCA Certified Ratings Program.

D Cabinet

With high gloss surface finished manufactured from ZERO spangle galvanized steel.

E Double Width Forward Curved Wheel

Wheel manufactured in high gloss surface finished manufactured from ZERO spangle galvanized steel. All wheels are statically and dynamically balanced to G2.5 in accordance with ISO 21940.

F Modularized Cabinet Design

INSTALL & SERVICE-FRIENDLY, removable access panel on both sides for easy access to fan and motor.

G Duct Collars/L-Inlet and Outlet Fan

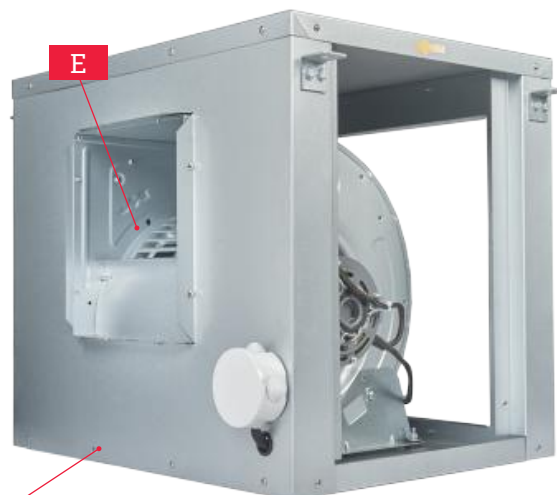

D



Options and Accessories

H : Inlet and Outlet Protection Nets

J : Flexible Duct

K : “Double Skin” Cabinet with Acoustic and Thermal Insulation

Nomenclature : -1S (Single skin)

-2S (Double skin)

L : Isolators

Typical Applications



Office



Toilet

Technical Data

IP21 Motor Models

Model	Max Q (m3/h)	Max Ps (Pa)	Maximum Motor Input Power (W)	Motor Protection	Phase	Hz	Maximum Current (A)	Voltage (V)	Capacitor (μF/V)	Insulation Class	Lp (A) at 3m free discharge (dB (A))*	Speed (RPM)	Motor model number
CCE 140 4P-1 1SP	623	135	140	IP21	1	50	0.7	230	5.0/450	F	56	1470	MP110B
CCE 160 4P-1 1SP	941	169	173	IP21	1	50	0.8	230	5.0/450	F	54	1410	MP110B
CCE 7-7 4P-1 1SP	1584	254	391	IP21	1	50	1.7	230	12.5/450	F	53	1390	MP150B
CCE 8-8 4P-1 1SP	1901	300	401	IP21	1	50	1.7	230	10.0/450	F	51	1230	MP150B
CCE 9-7T 4P-1 3SP	2116	435	712/562/448	IP21	1	50	3.1/2.5/2.0	230	10.0/450	F	55	1210/1130/1050	MP180B
CCE 9-7 4P-1 3SP	2273	501	769/568/437	IP21	1	50	3.5/2.6/2.0	230	10.0/450	F	52	1140/1050/990	MP180B
CCE 9-9T 4P-1 3SP	2813	517	917/752/552	IP21	1	50	3.9/3.4/2.6	230	12.5/450	F	60	1370/1220/1080	MP220B
CCE 9-9 4P-1 3SP	2835	486	951/734/568	IP21	1	50	4.2/3.3/2.8	230	12.5/450	F	58	1350/1190/1050	MP220B
CCE 10-8 4P-1 3SP	3776	640	1553/1142/905	IP21	1	50	6.8/5.1/4.1	230	16.0/450	F	57	1170/1080/1020	MP230B
CCE 10-10 4P-1 3SP	4160	677	1518/1273/933	IP21	1	50	6.6/5.8/4.2	230	16.0/450	F	57	1160/1060/1010	MP230B
CCE 12-9 6P-1 3SP	4990	387	1249/918/647	IP21	1	50	5.6/4.4/3.3	230	20.0/450	F	58	880/790/710	MP230C
CCE 12-12 6P-1 3SP	5427	385	1257/907/635	IP21	1	50	5.7/4.4/3.2	230	20.0/450	F	58	880/790/710	MP230C

IP55 Motor Models

Model	Max Q (m3/h)	Max Ps (Pa)	Maximum Motor Input Power (W)	Motor Protection	Phase	Hz	Maximum Current (A)	Voltage (V)	Capacitor (μF/V)	Insulation Class	Lp (A) at 3m free discharge (dB (A))*	Speed (RPM)	Motor model number
CCE 15-11 6P-3 1S	9770	570	3563	IP55	3	50	6.7	380	-	F	65	950	MK280C
CCE 15-11 6P-3 1S6	9177	842	4426	IP55	3	60	7.7	380	-	F	68	1100	MK280C
CCE 15-15 6P-3 1S	11490	577	3987	IP55	3	50	8.2	380	-	F	68	950	MK300C
CCE 15-15 6P-3 1S6	11056	862	5333	IP55	3	60	11.2	380	-	F	73	1120	MK300C
CCE 18-13 6P-3 1S	16463	710	7953	IP55	3	50	14.8	380	-	F	71	960	MK320C
CCE 18-13 6P-3 1S6	15152	1061	9521	IP55	3	60	16.3	380	-	F	73	1150	MK320C
CCE 18-18 6P-3 1S	18645	745	8511	IP55	3	50	16.0	380	-	F	71	960	MK330C
CCE 18-18 6P-3 1S6	17255	1037	10024	IP55	3	60	17.8	380	-	F	73	1150	MK330C

- Performance certified is for installation type D – Ducted inlet, Ducted outlet.
- Performance ratings do not include the effects of appurtenances (accessories).
- Speed (RPM) shown is nominal. Performance is based on actual speed of test.
- Lp(A) at 3m free discharge dB(A) levels are not licensed by AMCA International.

Dimension

90° Orientation

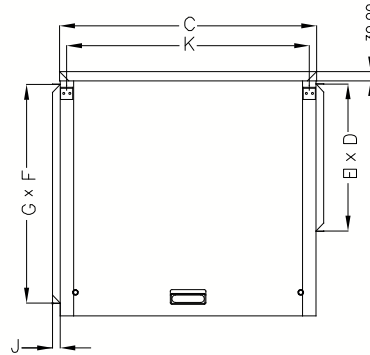
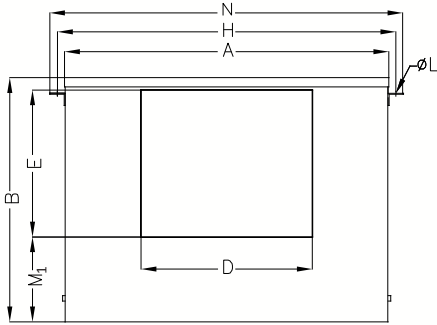

270° Orientation

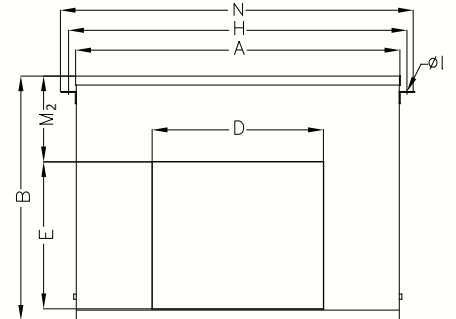

Model	A	B	C	D	E	F	G	H	J	K	L	M ₁	M ₂	N	Wt.(kg)
CCE 140	403	316	268	198	111	210	160	441	25	233	9	113	140	481	8.5
CCE 160	453	356	308	204	204	230	270	490	25	265	9	125	105	530	12
CCE 7-7	442	401	392	263	232	240	344	491	25	340	9	139	132	541	15
CCE 8-8	502	451	442	291	260	291	384	549	25	379	9	150	143	600	18
CCE 9-7T	572	401	393	236	266	348	322	621	25	340	9	83	117	671	20
CCE 9-7	573	451	442	236	266	348	382	619	25	378	9	143	159	670	22
CCE 9-9T	572	401	393	302	266	348	322	621	25	340	9	83	117	671	22
CCE 9-9	573	451	442	302	266	348	382	619	25	378	9	143	159	670	24
CCE 10-8	652	561	502	269	293	410	462	699	25	431	9	171	217	749	30
CCE 10-10	652	561	502	335	293	410	462	699	25	431	9	171	217	749	32
CCE 12-9	743	631	573	313	345	510	547	790	25	526	9	185	254	840	38
CCE 12-12	743	631	573	399	345	510	547	790	25	526	9	185	254	840	40

All dimension in mm.

90° Orientation

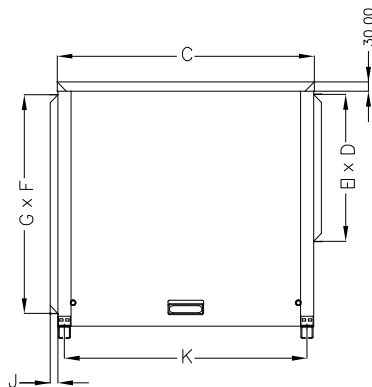
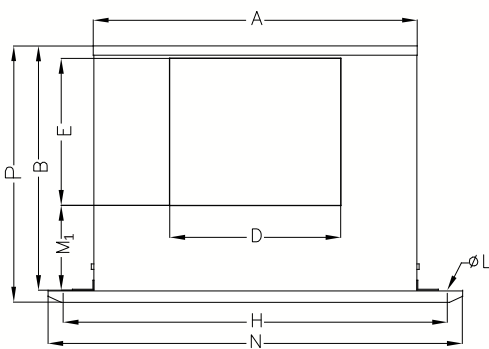

270° Orientation

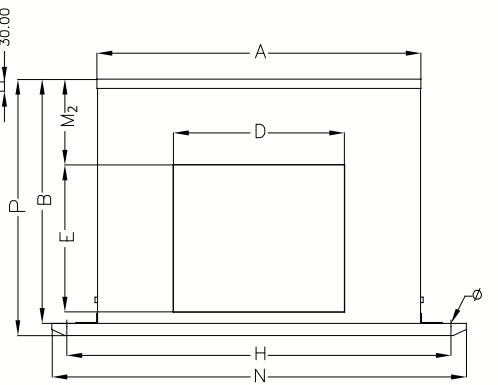

Model	A	B	C	D	E	F	G	H	J	K	L	M ₁	M ₂	N	P	Wt.(kg)
CCE 15-11	843	711	743	377	408	620	626	1040	25	699	19	223	286	1140	751	74
CCE 15-15	843	711	743	475	408	620	626	1040	25	699	19	223	286	1140	751	84
CCE 18-13	1063	801	843	434	482	717	760	1260	25	796	19	279	302	1360	841	121
CCE 18-18	1063	801	843	561	482	717	760	1260	25	796	19	279	302	1360	841	127

All dimension in mm.

Performance Data

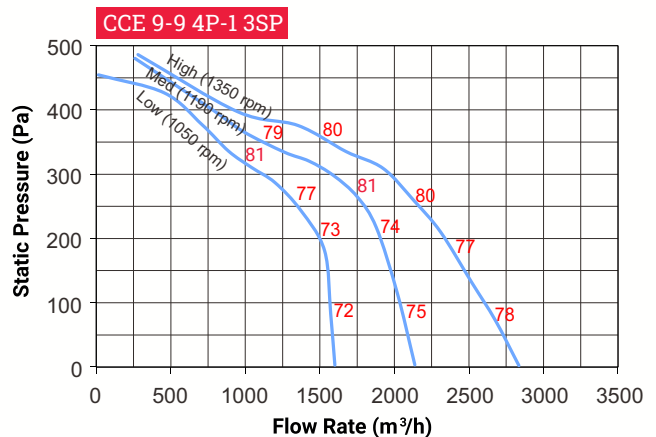
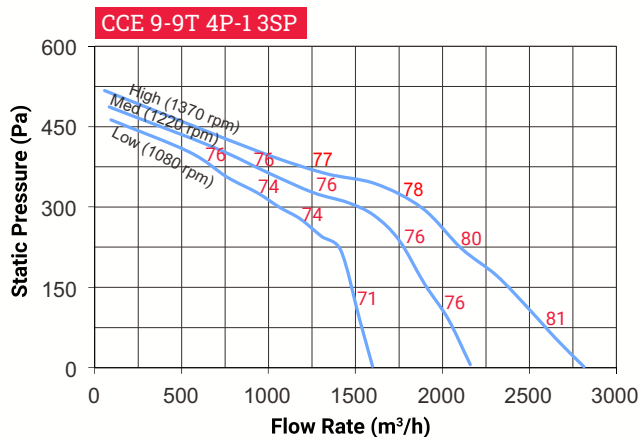
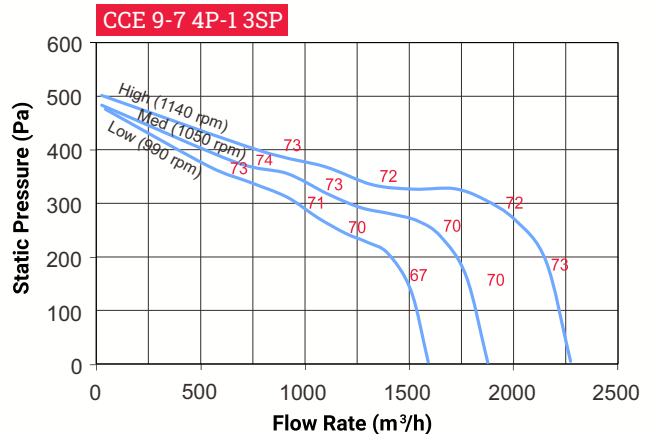
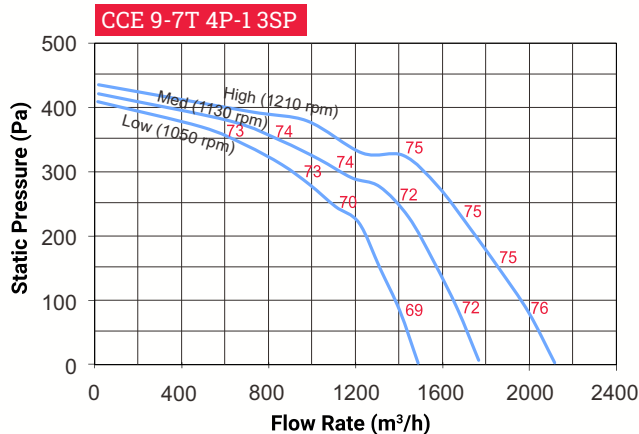
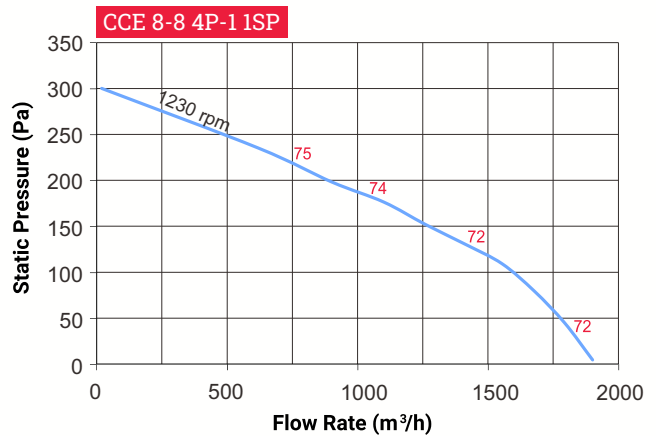
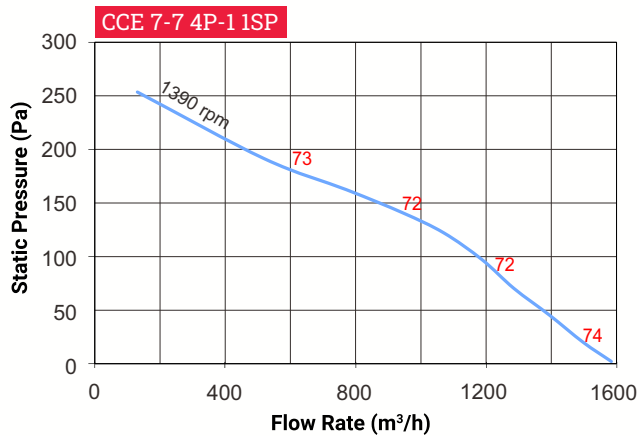
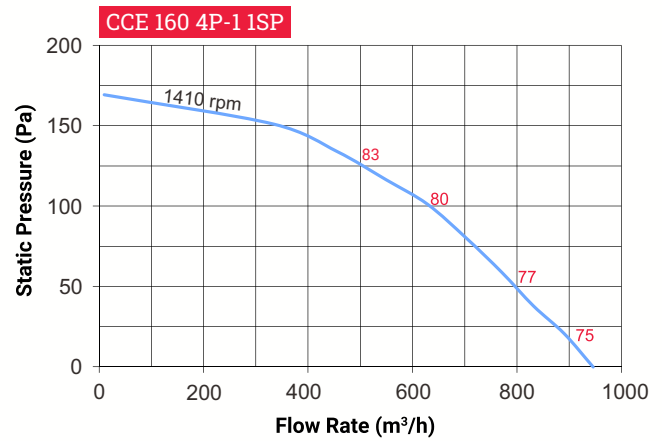
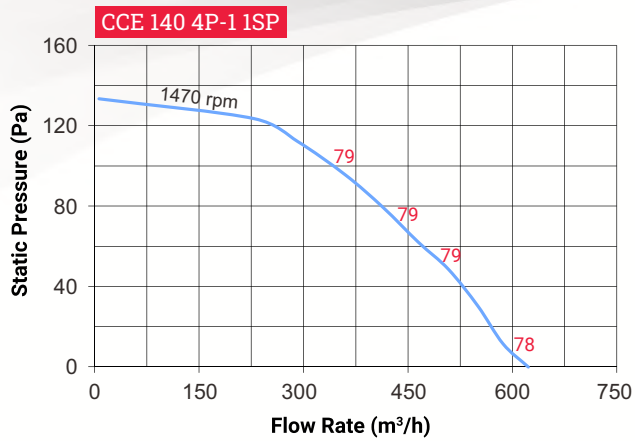

- Values shown are for inlet Lwi(A) sound power levels for installation type D – Ducted inlet, Ducted outlet. The A-weighted sound ratings shown have been calculated per AMCA International Standard 301. Ratings include the effects of duct end correction.
- Performance certified is for installation type D – Ducted inlet, Ducted outlet.
- Performance ratings do not include the effects of appurtenances (accessories).
- Speed (RPM) shown is nominal. Performance is based on actual speed of test.

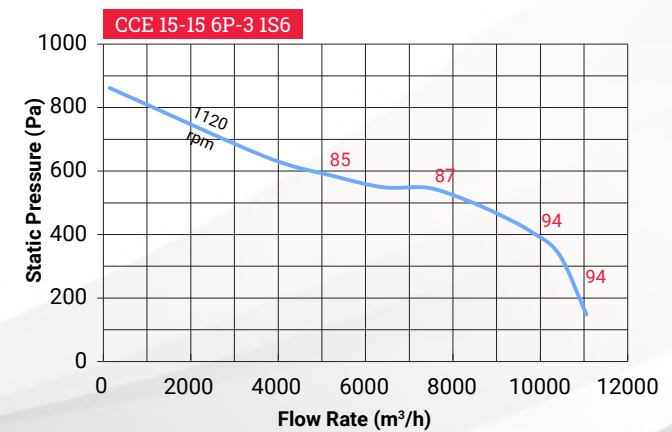
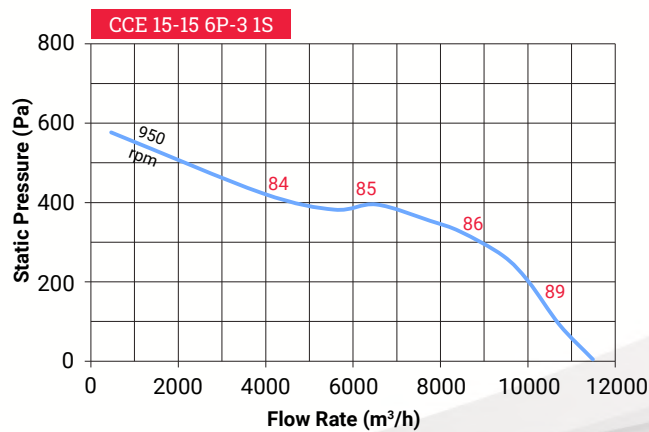
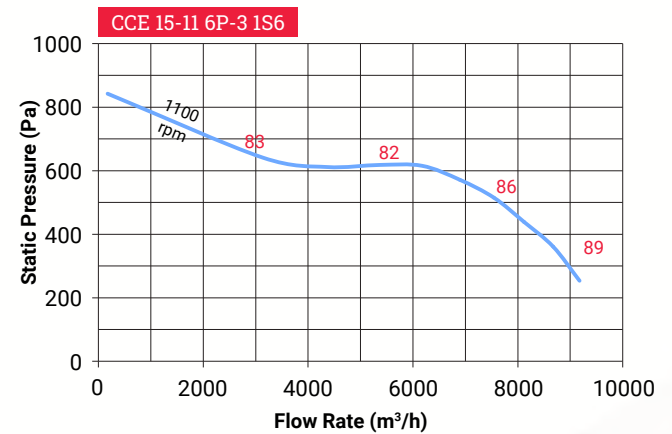
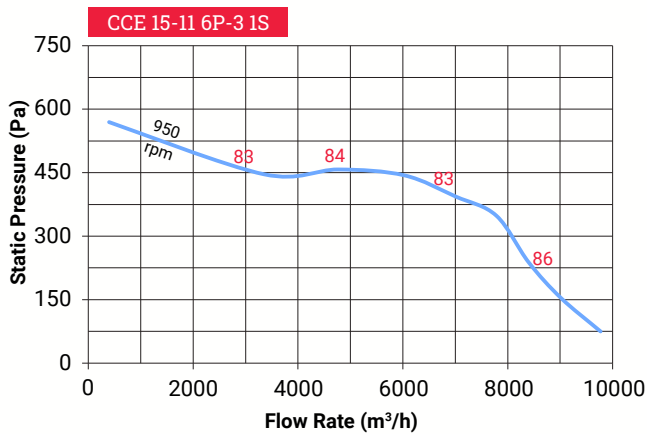
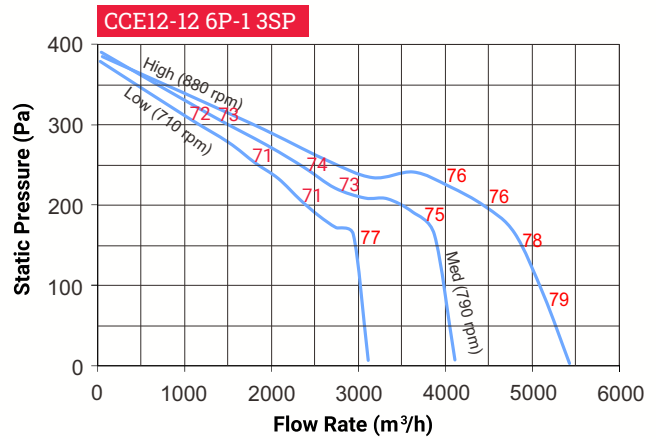
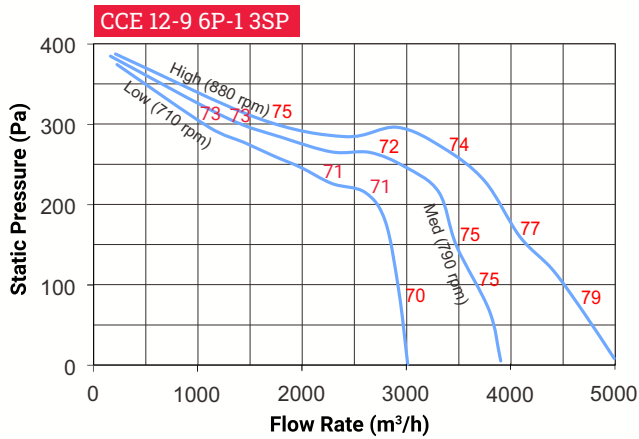
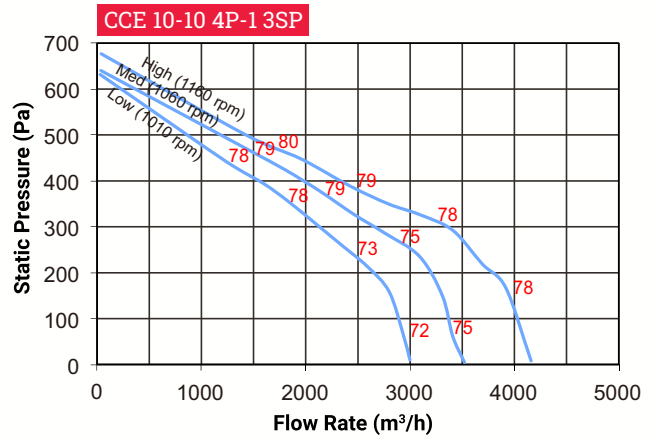
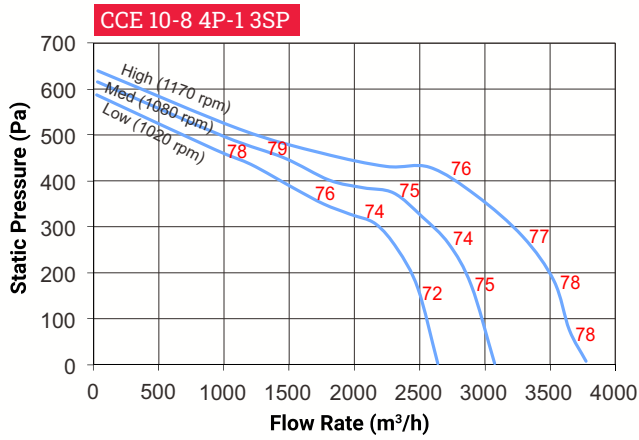

- Values shown are for inlet L_{wi}(A) sound power levels for installation type D – Ducted inlet, Ducted outlet. The A-weighted sound ratings shown have been calculated per AMCA International Standard 301. Ratings include the effects of duct end correction.
- Performance certified is for installation type D – Ducted inlet, Ducted outlet.
- Performance ratings do not include the effects of appurtenances (accessories).
- Speed (RPM) shown is nominal. Performance is based on actual speed of test.

Performance Data

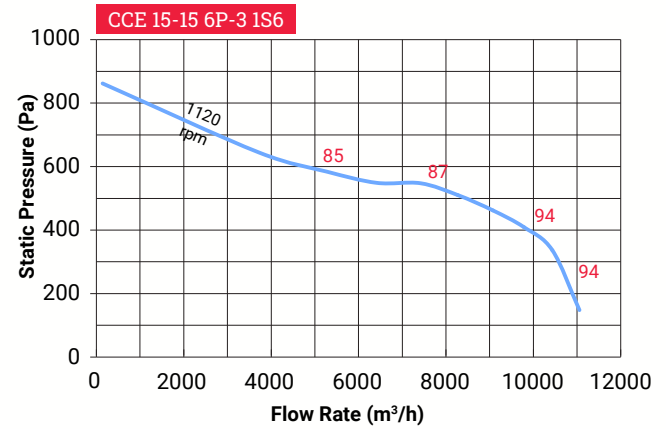
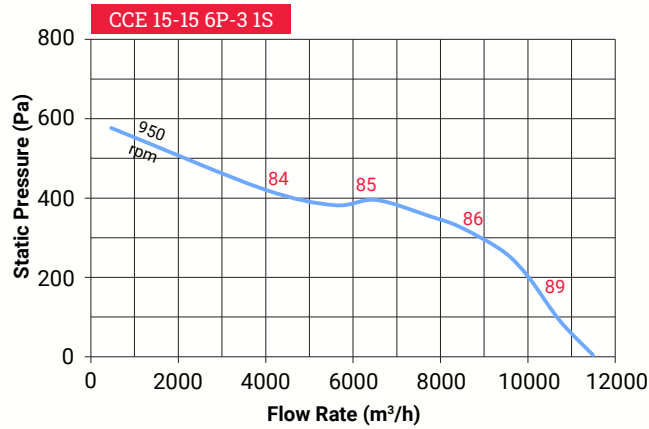
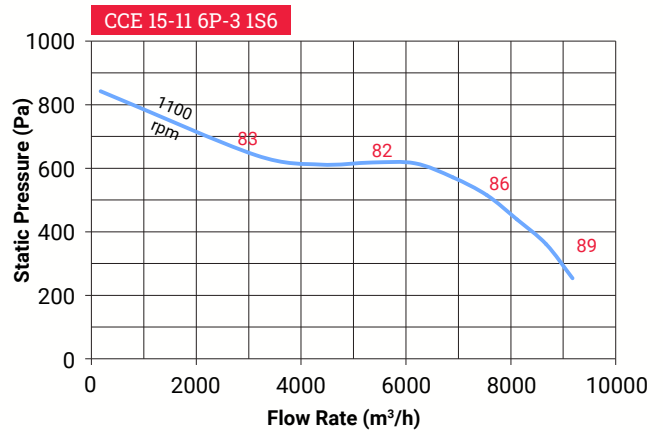
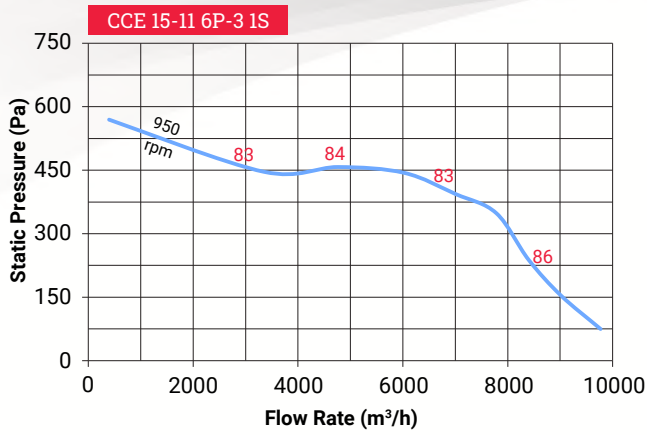

- Values shown are for inlet Lwi(A) sound power levels for installation type D – Ducted inlet, Ducted outlet. The A-weighted sound ratings shown have been calculated per AMCA International Standard 301. Ratings include the effects of duct end correction.
- Performance certified is for installation type D – Ducted inlet, Ducted outlet.
- Performance ratings do not include the effects of appurtenances (accessories).
- Speed (RPM) shown is nominal. Performance is based on actual speed of test.

KRUGER Ventilation Group

THAILAND (Regional HQ)

KRUGER VENTILATION INDUSTRIES ASIA CO. LTD.
30/159 Moo 1, Sinsakorn Industrial Estate,
Chetsadawithi Road, Khok Kham Mueng, Samuthsakorn 74000, Thailand
Tel: +662 1054298 Fax: +662 0248256-9
Website: www.krugerfan.com

THAILAND

KRUGER VENTILATION IND. (THAILAND) CO. LTD.
30/105 Moo 1, Sinsakorn Industrial Estate,
Chetsadawithi Road, Khok Kham Mueng, Samuthsakorn 74000, Thailand
Tel: +662 1050399 Fax: +662 1050370-2
Email: mktg@kruger.co.th

INDIA

KRUGER VENTILATION INDUSTRIES (INDIA) PVT. LTD.
Kruger Centre, Mumbai-Nasik Highway,
Kalamgaon, Shahapur, Thane 421601, Maharashtra, India
Tel: +91 996055899/9975577211
Email: sales@krugerindia.com

MIDDLE EAST

CONTACT: KRUGER VENTILATION INDUSTRIES (INDIA) PVT. LTD.
Tel: +91 9766323730 / +91 9975577211
Email: rahul@krugerindia.com

INDIA (NORTH)

KRUGER VENTILATION INDUSTRIES (NORTH INDIA) PVT LTD
Village Rohad, Tehsil Bahadurgarh, Hajar, Haryana-124507
Tel. +91-9958991652/9958991660/8586966303
Fax +91-1276-278096
Email: sales.kni@krugerindia.com , service@krugerindia.com

KOREA

NEOMATE CO. LTD.
2-1010, Ace High Tech City B/D, 775 Gyeongin-ro,
Yeongdeungpo-gu, Seoul, Korea. Postal Code 07299
Tel: +82-2-2679-2052 Fax: +82-2-2679-2174
Email: y7890@neomate.co.kr

MYANMAR

KRUGER VENTILATION (MYANMAR) CO. LTD.
Room No. F21, Thiri Yadanar Whole Sale Market, (Htawunbe)
Toe Chae Ward, North Okkalapa Township, Yangon.
Tel: +959 763141081/2/3
Email: htoon@krugermm.com

SINGAPORE

KRUGER ENGINEERING PTE. LTD.
2 Venture Drive #20-23, Vision Exchange,
Singapore 608526.
Tel: +65 68631191 Fax: +65 68631151
Email: mktg@krugerfan.com

AUSTRALIA

S&P KRUGER AUSTRALIA PTY. LTD.
2 Cunningham St, Moorebank N.S.W. 2170
Tel: +61 2-98227747
Fax: +61 2-98227757
Email: info@sandpkruger.com.au

INDONESIA

P.T. KRUGER VENTILATION INDONESIA.
JL. Teuku Umar No.20,
Karawaci - Tangerang 15115, Indonesia
Tel: +62 21-5512288/5513557 Fax: +62 21-5513502
Email: mktg@krugerindo.co.id

CHINA (GUANGZHOU)

GUANGZHOU KRUGER VENTILATION CO. LTD.
No. 9 Huahui Road, Huashan, Huadu,
Guangzhou, P.R. China 510880
Tel: +86 20-66356635 Fax: +86 20-86786001/86786500
Email: gzkruger@krugergz.com

CHINA (TIANJIN)

TIANJIN KRUGER VENTILATION CO. LTD.
Jingjin Science and Technology Park
Wuqing District, Tianjin, China
Tel: +86 22-22143480/3481 Fax: +86 22-22143482
Email: krugertj@krugertj.com

CHINA (SHANGHAI)

Shanghai Kruger Ventilation Co.,Ltd.
No.500 Yuanguo Road, Anting, Jiading District,
Shanghai 201814, P.R. China
Tel: +86 21-69573266 Fax: +86 21-69573296
Email: shkruiger@krugerchina.com

CHINA (WUHAN)

WUHAN KRUGER VENTILATION CO. LTD.
No. 805, Huian Ave, Dongxihu District, Wuhan, Hubei, P.R. China 430040
Tel: +86 27- 83248840/83060522/83097505
Fax: +86 27- 83261886
Email: whkruger@krugerwh.com

HONG KONG

KRUGER VENTILATION (HONG KONG) LIMITED.
Flat C, 9/F, Yeung Yiu Chung (No.8) Industrial Building,
20 Wang Hoi Road, Kowloon Bay, Kowloon, Hong Kong
Tel: +852 22469182 Fax: +852 22469187
Email: info@kruger.com.hk

TAIPEI

KRUGER VENTILATION (TAIWAN) CO. LTD.
No. 157, Ping-an Rd, Hengfeng Village,
Dayuan Shiang Taoyuan County 337, Taiwan
Tel: +886 3-3859119 Fax: +886 3-3859118
Email: sales@krugertwn.com.tw

MALAYSIA

KRUVENT INDUSTRIES (M) SDN. BHD.
Lot 850, Jalan Subang 7, Taman Perindustrian Subang,
47500, Subang Jaya, Selangor D.E.
Tel: +603 80743399 Fax: +603 80743388
Email: mktg@kruger.com.my

PHILIPPINES

KRUGER M & E INDUSTRIES CORP.
B3 Welborne Industrial Park
Banca Carmona Cavite 4116, Philippines
Tel: +63-917-561-9088 / +63-917-596-7288
+63-917-712-8438 / +63-917-306-8288
Email: mktg@krugerph.net

VIETNAM

KRUGER VENTILATION INDUSTRIES (VIETNAM) CO. LTD.
Lot A7. 2-4, C2 Road, Thanh Thanh Cong IZ,
Trang Bang Dist. Tay Ninh Province, Vietnam
Tel: +84-276 3585200/01/02 Fax: +84-276 3585199
Email: mktg@krugervn.com



Kruger Ventilation Industries Asia Co., Ltd.

30/159 Moo 1, Sinsakorn Industrial Estate
Chetsadawithi Road, Khok Kham Mueng,
Samuthsakorn 74000, Thailand

Tel: +662 1054298 Fax: +662 0248256-9

Website: www.krugerfan.com

CAT055.E0 February 2023

A member of

