

Centrifugal Inline Fan

TECHNICAL SPECIFICATIONS



TABLE OF CONTENTS

INTRODUCTION	3-5
CERTIFICATIONS & LISTINGS	6
CI3 - CI12 CEILING FANS	7-8
CI8, CI10, CI12-GPE CEILING FANS	9
CI3 - CI12 (TDA) CEILING FANS	10-11
CI14 & CI15 LARGE CAPACITY CEILING FANS	12-13
CIT & CIJ1 LOW PROFILE CEILING FANS	14
TRANSFAN TRANSFER FAN	15
CL1, CIL1, & CIL2 CEILING FANS WITH LIGHT	16
CI2 LOW FLOW CEILING FAN	17
CIQ80(L)-GPE AND CIQ110(L)-GPE DIMENSIONS AND PERFORMANCE	18



BY JOHNSON CONTROLS

INTRODUCTION

Centrifugal Inline Fan CI & CI-TDA Models

The Centrifugal Inline Fan, model CI, are quiet ceiling exhaust fans. Some selections are available with sound ratings below 1 sone. There are 15 types of models that cover a wide range of performance. The units are easily field convertible to change the discharge orientation from right angle to top discharge. They are also easily field convertible from ceiling (model CI) to inline (model CI-TDA) installations. There are multiple sizes that utilize 2 speed motors that allow these units to cover an even greater range. All motors are equipped with thermal overload protection as standard. The units utilize quick access wiring to make them easy to install. Many of the units are offered with variable speed motor control which will allow for easy balancing. All models are AMCA Air and Sound rated and UL507 listed. Select models are UL705 listed. ENERGY STAR® is also available on select models.

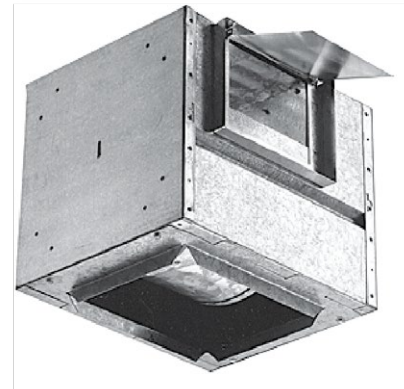

Centrifugal Inline Fan TDA

Model: CI2 - CI12 (TDA)

- Static pressure up to 1.76" wg.
- Flow capacity up to 1519 CFM.



Centrifugal Inline Fan

Large Capacity Centrifugal Inline Fan

York® Centrifugal Inline Fan models CI14 and CI15 are designed to produce high volumes of air at low noise levels. Fans can be used for general ventilation and exhaust applications. These larger capacity fans will accommodate single or multi-room ventilation and can be installed above the ceiling. The units are AMCA Air certified and UL705 listed. The CI14 is also UL507 listed.

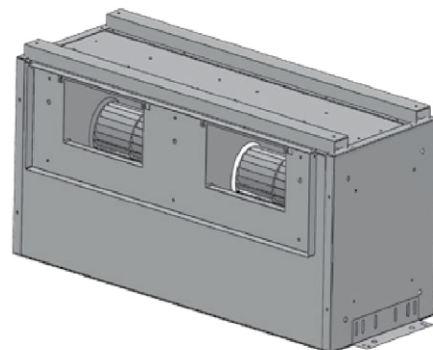

Model: CI2 - CI12

- Centrifugal Inline Fan models are ENERGY STAR approved.
- Static pressure up to 1.73" wg.
- Flow capacity up to 1566 CFM.



Model: CI14 & CI15

- Static pressure up to 1" wg.
- Flow capacity up to 3290 CFM.

INTRODUCTION

Centrifugal Inline T & Jr.

The CIT, and CIJ1, are quiet low profile Fan. They can be installed into very shallow ceilings where other units will not fit. A speed controller is available for both models for precise system balancing and energy conservation. The units come standard with thermally protected motors, AMCA Air rated and UL705, UL507, and CSA listed.



Model: CIT & CIJ1

- Static pressure up to 0.93" wg.
- Flow capacity up to 174 CFM.

Transfan

The Transfan is a room-to-room transfer fan. It has an adjustable wall sleeve for varying wall thicknesses and fits easily between wall studs or ceiling joists. It is supplied with a built-in variable speed motor control. It is UL705, UL507, and CSA listed.



Model: CIF

- Static pressure up to 0.28" wg.
- Flow capacity up to 255 CFM.

Centrifugal Low flow Ceiling Fan

The CL1, is for very low flow requirements. The unit comes with a white polymeric grille and utilizes a quiet centrifugal blower wheel. The housing is made from rugged steel and has built in mounting brackets. The exhaust connection is a 4" polymeric round duct connector that has a durable damper that eliminates backdrafts and produces no metallic clatter. The CL1 is UL507 listed for use over bathtubs and showers when connected to a GFCI protected branch circuit. The CL1 is AMCA licensed for Sound and Air performance.



Model: CL1

- Static pressure up to 0.5" wg.
- Flow capacity up to 56 CFM.

INTRODUCTION

Centrifugal Inline Ceiling Fans with Light

The Light models, CIL1 and CIL2, come with a maximum of 100 watt incandescent lighting (bulb not included). The units are supplied with an open drip proof motor that utilizes sealed bearings. The units come with a white polymeric grille that has an unbreakable light lens. They utilize quiet centrifugal blower wheels with plug-in receptacles for the fan and light. The housing is made from rugged steel and has built-in mounting brackets. The exhaust connection is a 4" polymeric round duct connector that has a durable damper that eliminates backdrafts and produces no metallic clatter. The models are UL507 listed for use over bathtubs and showers when connected to a GFCI protected branch circuit. The units are AMCA licensed for Sound and Air performance.

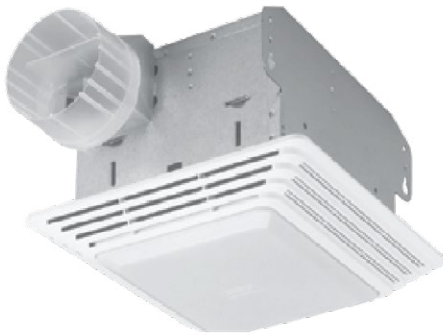

Model: CIL1 & CIL2

- Static pressure up to 0.5" wg.
- Flow capacity up to 97 CFM.

Centrifugal Inline Quiet Ceiling Fan

The Quiet line (CIQ) achieves a <0.3 Sone level which provides a nearly silent operation for minimal disruption of your environment. Suitable for intermittent or continuous ventilation needs, the unit comes with a white polymeric grille and utilizes a quiet centrifugal blower wheel. The housing is made from rugged steel and has built-in mounting brackets. The exhaust connection is a 6" polymeric round duct connector that has a durable damper that eliminates backdrafts and produces no metallic clatter. The Centrifugal Inline Fan Quiet Light (L) models comes with a bright, energy efficient 36-watt fluorescent lighting. The CIQ line is UL507 listed for use over bathtubs and showers when connected to a GFCI protected branch circuit. The CIQ line is AMCA licensed for Sound and Air performance and ENERGY STAR® certified.



Models: CIQ80(L)-GPE & CIQ110(L)-GPE

- Static pressure up to 0.625" wg.
- Flow capacity up to 110 CFM.

CERTIFICATIONS & LISTINGS



AMCA Certification

York® certifies that the Centrifugal Inline Fan models shown on this catalog (excludes Transfan) are licensed to bear the AMCA Seal. The ratings shown are based on tests and procedures performed in accordance with AMCA Publication 211 and AMCA Publication 311 and comply with the requirements of the AMCA Certified Ratings Program.



Fans that are ENERGY STAR® qualified include: CI2-E, CI8-GPE, CI10-GPE, CI12-GPE, CIQ80(L)-GPE and CIQ110(L)-GPE



UL and cULus(®) Certification

Centrifugal Inline Fan carry the UL label, UL705, (CIACT/CIACT7), file #E477250 and UL507, (GPWX), file #E477251. Centrifugal Inline Fan radiation dampers carry the UL label UL555C, (CABS), file #R8039.

Models CI1, CIL1, CIL2, CI8-GP, CI10-GP, CI12-GP, CIQ80(L)-GPE, CIQ110(L)-GPE, CI8-GPE, CI10-GPE, CI12-GPE are not UL705 certified. Model CI15 is not UL507 certified.

CI3 - CI12 | CEILING FANS

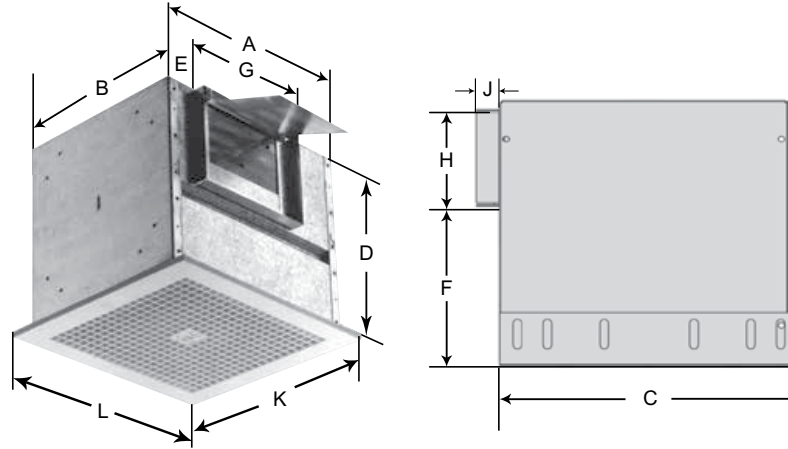

Model	Housing							Outlet Duct			Grille	
	A	B	C	D	E	E1	F	G	H	J	K	L
CI3, 5, 6	12 1/2"	9 1/8"	16"	9 1/8"	1 1/4"	1 1/4"	5 3/8"	10"	3 1/4"	3/4"	11"	13 3/4"
CI8, 81, 8-GP, 8-GPE	13 7/8"	11 3/8"	17 3/8"	11 3/8"	1 7/8"	4"	5 1/4"	8"	6"	3/4"	13 1/4"	14 7/8"
CI10, 10-GP, 10-GPE	18"	14 1/8"	21 1/2"	14 1/8"	3 5/8"	6 3/8"	8"	8"	6"	3/4"	15 1/2"	19 3/8"
12, 101, 102, 121, 12-GP, and 12-GPE	24"	14 1/8"	27 1/2"	14 1/8"	1"	1"	8"	22"	6"	3/4"	15 1/2"	25"

Model	Max. Watts	Amps	RPM	SP	0.000"	0.125"	0.250"	0.375"	0.500"	0.625"	0.750"
CI3H	39	0.5	1550	CFM	109	83	-	-	-	-	-
				HEMISPHERICAL SONES ³	1.7	2.3	-	-	-	-	-
				SPHERICAL SONES ⁴	0.8	1.4	-	-	-	-	-
CI5H	79	1	1550	CFM	192	163	128	93	-	-	-
				HEMISPHERICAL SONES ³	3.4	3.3	3.3	3.4	-	-	-
				SPHERICAL SONES ⁴	1.5	1.6	1.6	1.7	-	-	-
CI6S5	47	0.6	1050	CFM	123	101	82	-	-	-	-
				HEMISPHERICAL SONES ³	0.9	1.4	1.8	-	-	-	-
				SPHERICAL SONES ⁴	0.2	0.5	0.9	-	-	-	-
CI6H5	108	1.4	1550	CFM	230	196	166	122	-	-	-
				HEMISPHERICAL SONES ³	3.3	3	3	3.1	-	-	-
				SPHERICAL SONES ⁴	2.3	2.0	1.9	2.0	-	-	-
CI8S6	77	1	1050	CFM	272	247	231	217	199	-	-
				HEMISPHERICAL SONES ³	2.1	2.4	2.9	3.3	3.6	-	-
				SPHERICAL SONES ⁴	1.0	1.4	1.9	2.4	2.8	-	-
CI81S	77	0.9	1050	CFM	310	273	239	213	182	136	73
				HEMISPHERICAL SONES ³	2.5	2.7	2.9	3.3	3.7	4.2	4.3
				SPHERICAL SONES ⁴	1.5	1.7	1.9	2.3	2.8	3.1	3.2
CI8H6	130	1.6	1550	CFM	426	401	377	357	341	328	304
				HEMISPHERICAL SONES ³	4.5	4.7	4.7	5.1	5.6	5.8	5.8
				SPHERICAL SONES ⁴	3.4	3.7	3.6	4.1	4.6	4.7	4.8
CI10S7	243	2.5	1050	CFM	469	441	423	403	387	367	347
				HEMISPHERICAL SONES ³	4.5	4.8	5.1	5.4	5.6	5.8	6
				SPHERICAL SONES ⁴	3.4	3.8	4.0	4.4	4.6	4.7	4.9



CI3 - CI12 | CEILING FANS

Model	Max. Watts	Amps	RPM	SP	0.000"	0.125"	0.250"	0.375"	0.500"	0.625"	0.750"
CI101S	153	1.6	1050	CFM	612	537	467	405	222	116	-
				HEMISPHERICAL SONES ³	3.9	3.6	3.9	4.6	5.5	6	-
				SPHERICAL SONES ⁴	2.9	2.5	2.9	3.6	4.3	5.2	-
CI10H7	390	3.6	1550	CFM	728	694	664	638	613	591	565
				HEMISPHERICAL SONES ³	8.6	8.6	8.6	8.7	8.6	8.8	8.8
				SPHERICAL SONES ⁴	7.3	7.4	7.5	7.4	7.4	7.8	7.7
CI102S	269	4.5	1050	CFM	816	747	691	602	335	-	-
				HEMISPHERICAL SONES ³	5.8	5.8	5.4	5	4.9	-	-
				SPHERICAL SONES ⁴	4.6	4.6	4.1	3.7	3.8	-	-
CI12S	260	2.9	1050	CFM	901	855	812	755	683	552	-
				HEMISPHERICAL SONES ³	5.8	5.9	6.3	6.5	6.5	6	-
				SPHERICAL SONES ⁴	4.6	4.8	5.2	5.2	5.3	5.0	-
CI121S	370	3.6	1050	CFM	1083	1062	1024	949	838	686	270
				HEMISPHERICAL SONES ³	7	6.9	6.6	6.1	5.7	5.3	4.6
				SPHERICAL SONES ⁴	5.9	6.0	5.6	5.1	4.8	4.2	3.6
CI102H	812 (BHP 0.53)	7.5	1550	CFM	1435	1385	1338	1294	1247	1203	1163
				HEMISPHERICAL SONES ³	11.8	11.7	11.9	11.9	11.7	11.3	11
				SPHERICAL SONES ⁴	10.4	10.1	10.3	10.3	10.0	9.8	9.6
CI12H	851 (BHP 0.65)	7.9	1550	CFM	1566	1511	1464	1417	1364	1307	1251
				HEMISPHERICAL SONES ³	13.5	13.3	12.9	12.7	12.3	12	11.7
				SPHERICAL SONES ⁴	11.6	11.4	11.0	11.0	10.7	10.4	10.1

- (1) Speed (RPM) shown is nominal. Performance is based on actual speed of test.
- (2) Performance shown is for installation type B - Free Inlet, Ducted Outlet. Performance ratings include the effects of an inlet grille and backdraft damper in the airstream.
- (3) The sound ratings shown are loudness values in fan sones at 5ft. (1.5m) in a hemispherical free field calculated per AMCA Standard 301.
- (4) The spherical sones values are calculated to represent sound in a spherical free field at 5 ft. (1.5m) per Annex B of AMCA 311.
- (5) Specify discharge configuration. Standard types are RA, TD, TDA and TDA-RA.
- (6) CI6S and CI6H is the same unit shipped with EASYTAP dual speed motor. Wired on S (low) speed.
- (7) CI8S and CI8H is the same unit shipped with EASYTAP dual speed motor. Wired on S (low) speed.
- (8) CI10S and CI10H is the same unit shipped with EASYTAP dual speed motor. Wired on S (low) speed.

CI8, CI10, CI12-GPE | CEILING FANS

Centrifugal Inline Fan Electronically Commuted (EC)

Model	EN-ERGY STAR®	RPM	CFM / Watt at 0.1 SP	0.000		0.100		0.125		0.250		0.375		0.500		0.625		0.750		0.875		1.000		1.125	
				CFM	Sones	CFM	Sones	CFM	Sones	CFM	Sones	CFM	Sones	CFM	Sones	CFM	Sones	CFM	Sones	CFM	Sones	CFM	Sones	CFM	Sones
CI8-GPE		755	11.2	248	2.0	188	1.8	169	1.7																
CI8-GP		1380	4.1	470	5.9	453	5.8	449	5.8	421	5.7	373	5.5	331	5.4	261	5.3								
CI10-GPE		740	10.8	285	2.0	200	1.5	170	1.4																
CI10-GP		1580	3.3	691	8.2	649	7.9	607	7.9	558	7.6	500	7.4	432	7.1	362	6.9								
CI12-GPE		530	10.8	547	3.0	278	2.8	166	2.7																
CI12-GP		1355	3.2	1545	10.6	1496	10.6	1484	10.6	1418	10.1	1321	9.8	1222	9.7	1123	9.5	1009	9.4	817	9.0	502	8.9	222	8.5

- (1) Speed (RPM) shown is nominal. Performance is based on actual speed of test.
- (2) Performance shown is for installation type B - Free Inlet, Ducted Outlet. Performance ratings include the effects of an inlet grille and backdraft damper in the airstream.
- (3) The spherical sones values are calculated to represent sound in a spherical free field at 5 ft. (1.5m) per Annex B of AMCA 311.

CI3 - CI12 (TDA) | CEILING FANS

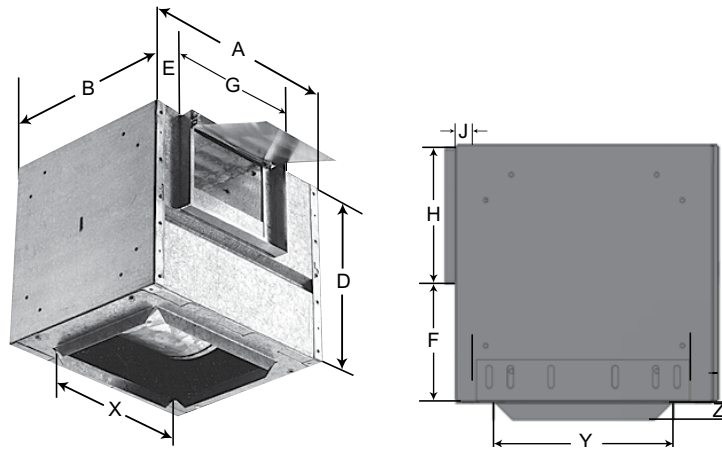

Model	Housing							Outlet Duct			TDA Panel		
	A	B	C	D	E	E1	F	G	H	J	X	Y	Z
CI3, 5, 6	12 1/2"	9 1/8"	16"	9 1/8"	1 1/4"	1 1/4"	5 3/8"	10"	3 1/4"	3/4"	10"	6"	1 5/8"
CI8, 81, 8-GP, 8-GPE	13 7/8"	11 3/8"	17 3/8"	11 3/8"	1 7/8"	4"	5 1/4"	8"	6"	3/4"	10"	8"	1 9/16"
CI10, 10-GP, 10-GPE	18"	14 1/8"	21 1/2"	14 1/8"	3 5/8"	6 3/8"	8"	8"	6"	3/4"	14"	10"	2"
12, 12-GP, 12-GPE	24"	14 1/8"	27 1/2"	14 1/8"	1"	1"	8"	22"	6"	3/4"	20"	10"	2"
CI101	24"	14 1/8"	27 1/2"	14 1/8"	1"	1"	8"	22"	6"	3/4"	20"	10"	2"
CI102	24"	14 1/8"	27 1/2"	14 1/8"	1"	1"	8"	22"	6"	3/4"	20"	10"	2"
CI121	24"	14 1/8"	27 1/2"	14 1/8"	1"	1"	8"	22"	6"	3/4"	20"	10"	2"

Model	Max. Watts	Amps	RPM	SP	0.000"	0.125"	0.250"	0.375"	0.500"	0.625"	0.750"	1.000"	1.250"	1.500"
CI3H (TDA)	42	0.5	1550	CFM	107	81	-	-	-	-	-	-	-	-
				HEMISPHERICAL SONES ³	1.7	1.9	-	-	-	-	-	-	-	-
				SPHERICAL SONES ⁴	0.8	0.9	-	-	-	-	-	-	-	-
CI5H (TDA)	83	1	1550	CFM	199	171	143	104	-	-	-	-	-	-
				HEMISPHERICAL SONES ³	1.9	2	2.1	2.1	-	-	-	-	-	-
				SPHERICAL SONES ⁴	0.9	1.0	1.2	1.3	-	-	-	-	-	-
CI6S (TDA) ⁵	46	0.6	1050	CFM	127	93	66	-	-	-	-	-	-	-
				HEMISPHERICAL SONES ³	0.9	1.2	1.6	-	-	-	-	-	-	-
				SPHERICAL SONES ⁴	0.3	0.5	0.8	-	-	-	-	-	-	-
CI6H (TDA) ⁵	108	1.4	1550	CFM	227	192	157	113	-	-	-	-	-	-
				HEMISPHERICAL SONES ³	2.7	2.7	2.8	2.9	-	-	-	-	-	-
				SPHERICAL SONES ⁴	1.8	1.7	1.8	2.0	-	-	-	-	-	-
CI8S (TDA) ⁶	75	1	1050	CFM	255	228	208	190	165	139	110	-	-	-
				HEMISPHERICAL SONES ³	1.8	1.9	2.4	2.8	3.3	3.6	3.7	-	-	-
				SPHERICAL SONES ⁴	0.8	1.0	1.4	1.9	2.3	2.6	2.8	-	-	-
CI81S (TDA)	84	0.9	1050	CFM	307	274	252	228	198	152	95	-	-	-
				HEMISPHERICAL SONES ³	2.2	2.2	2.5	2.9	3.1	3.3	3.5	-	-	-
				SPHERICAL SONES ⁴	1.2	1.1	1.4	1.8	2.1	2.3	2.6	-	-	-
CI8H (TDA) ⁶	132	1.6	1550	CFM	402	376	350	335	318	301	277	-	-	-
				HEMISPHERICAL SONES ³	4.1	3.9	3.9	4.2	4.4	4.6	4.9	-	-	-
				SPHERICAL SONES ⁴	3.1	2.9	2.9	3.2	3.5	3.8	4.1	-	-	-

CIB - CI12 (TDA) | CEILING FANS

Model	Max. Watts	Amps	RPM	SP	0.000"	0.125"	0.250"	0.375"	0.500"	0.625"	0.750"	1.000"	1.250"	1.500"
CI10S (TDA)7	234	2.5	1050	CFM	456	423	391	367	350	337	320	268	128	-
				HEMISPHERICAL SONES ³	4.1	4.5	4.7	4.9	5.2	5.4	5.7	6.2	6.4	-
				SPHERICAL SONES ⁴	3.0	3.4	3.7	3.9	4.2	4.5	4.8	5.2	5.4	-
CI101S (TDA)	152	1.6	1050	CFM	609	521	438	373	272	130	-	-	-	-
				HEMISPHERICAL SONES ³	3.2	3.4	4.3	4.6	5.2	5.6	-	-	-	-
				SPHERICAL SONES ⁴	2.2	2.3	3.2	3.5	4.0	4.4	-	-	-	-
CI10H (TDA)7	372	3.6	1550	CFM	700	661	626	593	558	528	504	455	368	-
				HEMISPHERICAL SONES ³	8	8	7.9	7.9	8	8.2	8.1	8	7.8	-
				SPHERICAL SONES ⁴	7.0	6.8	6.8	6.8	6.9	7.0	6.9	6.6	6.3	-
CI102S (TDA)	273	4.5	1050	CFM	780	720	660	592	336	-	-	-	-	-
				HEMISPHERICAL SONES ³	4.6	5.7	5.6	4.8	4.7	-	-	-	-	-
				SPHERICAL SONES ⁴	3.5	4.5	4.6	3.8	3.7	-	-	-	-	-
CI12S (TDA)	263	2.9	1050	CFM	886	829	786	735	660	526	180	-	-	-
				HEMISPHERICAL SONES ³	5.5	5.7	5.6	5.8	5.7	5.3	4.7	-	-	-
				SPHERICAL SONES ⁴	4.4	4.5	4.5	4.7	4.5	4.2	3.7	-	-	-
CI121S (TDA)	344	3.6	1050	CFM	1089	1043	981	899	802	672	404	-	-	-
				HEMISPHERICAL SONES ³	6.5	6.5	6.3	6	5.7	5.3	4.4	-	-	-
				SPHERICAL SONES ⁴	5.2	5.3	5.1	4.9	4.6	4.1	3.3	-	-	-
CI102H (TDA)	810 (BHP 0.53)	7.5	1550	CFM	1397	1348	1301	1253	1206	1162	1121	1034	916	611
				HEMISPHERICAL SONES ³	10.7	10.5	10.7	10.6	10.4	10.1	9.9	9.6	9.4	9
				SPHERICAL SONES ⁴	9.3	9.1	9.3	9.1	9.0	8.7	8.4	8.2	7.9	7.5
CI12H (TDA)	810 (BHP 0.53)	7.9	1550	CFM	1519	1475	1430	1386	1343	1300	1254	1146	1017	697
				HEMISPHERICAL SONES ³	12.7	12.4	12.2	11.7	11.5	11.2	10.9	10.5	10.2	9.6
				SPHERICAL SONES ⁴	10.9	10.7	10.5	10.1	9.9	9.6	9.3	9.0	8.5	8.1

- (1) Speed (RPM) shown is nominal. Performance is based on actual speed of test.
- (2) Performance shown is for installation type B - Free Inlet, Ducted Outlet. Performance ratings include the effects of an inlet grille and backdraft damper in the airstream.
- (3) The sound ratings shown are loudness values in fan sones at 5ft. (1.5m) in a hemispherical free field calculated per AMCA Standard 301.
- (4) The spherical sones values are calculated to represent sound in a spherical free field at 5 ft. (1.5m) per Annex B of AMCA 311.
- (5) Specify discharge configuration. Standard types are RA, TD, TDA and TDA-RA.
- (6) CI6S and CI6H is the same unit shipped with EASYTAP dual speed motor. Wired on S (low) speed.
- (7) CI8S and CI8H is the same unit shipped with EASYTAP dual speed motor. Wired on S (low) speed.
- (8) CI10S and CI10H is the same unit shipped with EASYTAP dual speed motor. Wired on S (low) speed.

CI14 & CI15 | LARGE CAPACITY CEILING FANS

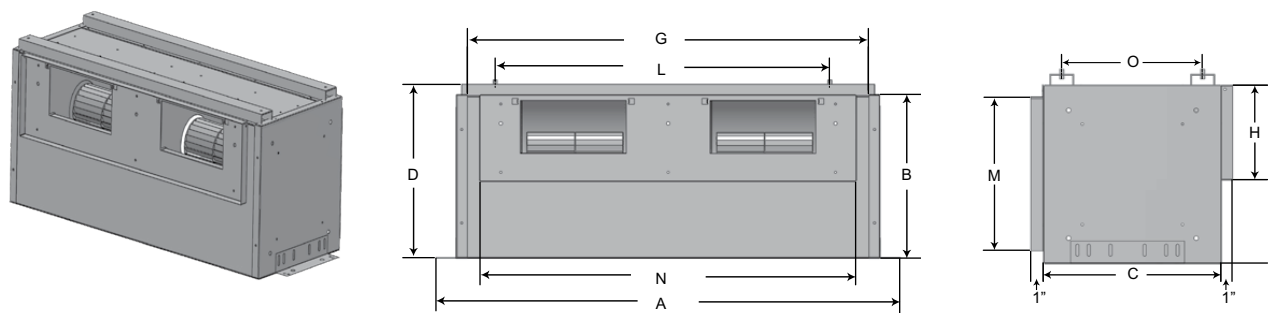

Model	A	B	C	D	L	O	Outlet		Inlet		Wheel Dia	Wheel Circ.
							G	H	M	N		
CI14	38"	14 1/2"	14 1/2"	15 1/2"	26 1/2"	7 5/8"	33 3/4"	7 3/4"	12 1/2"	36"	8"	2.09'
CI15	45 1/2"	16 1/2"	16 1/2"	17 1/2"	31 3/4"	10"	41 1/4"	9 3/4"	14 1/2"	43 1/2"	9"	2.36'

Model	RPM	SP	0.100"	0.125"	0.250"	0.375"	0.500"	0.625"	0.750"	0.875"	1.00"
CI14 115/1/60 1/2 HP	1150	CFM	2200	2195	2050	1870	1685	1425	880	285	-
		HEMISPHERICAL SONES³	7.9	7.9	7.6	7.1	6.8	6.7	6.6	6.4	-
		SPHERICAL SONES⁴	6.8	6.7	6.3	6.0	5.6	5.4	5.2	5.0	-
		BHP	0.56	0.56	0.54	0.49	0.45	0.39	0.26	0.15	-
	1060	CFM	2025	2015	1835	1645	1400	880	-	-	-
		HEMISPHERICAL SONES³	7.2	7.2	6.9	6.4	6.3	6	-	-	-
		SPHERICAL SONES⁴	6.0	6.0	5.6	5.3	5.0	4.8	-	-	-
		BHP	0.44	0.43	0.4	0.36	0.33	0.22	-	-	-
	980	CFM	1865	1845	1630	1410	1015	280	-	-	-
		HEMISPHERICAL SONES³	6.6	6.6	6.2	5.8	5.7	5.3	-	-	-
		SPHERICAL SONES⁴	5.4	5.3	5.0	4.7	4.4	4.2	-	-	-
		BHP	0.34	0.34	0.31	0.28	0.2	0.1	-	-	-
	880	CFM	1660	1605	1375	1055	255	-	-	-	-
		HEMISPHERICAL SONES³	5.8	5.8	5.4	4.8	4.6	-	-	-	-
		SPHERICAL SONES⁴	4.6	4.5	4.3	4.0	3.7	-	-	-	-
		BHP	0.25	0.24	0.21	0.17	0.07	-	-	-	-

CI14 & CI15 | LARGE CAPACITY CEILING FANS

Model	RPM	SP	0.100"	0.125"	0.250"	0.375"	0.500"	0.625"	0.750"	0.875"	1.00"
CI15 230/1/60 1 HP	1030	CFM	3290	3260	3100	2920	2720	2510	2260	1930	1140
		HEMISPHERICAL SONES ³	9.5	9.5	9.4	9	8.7	8.6	8.3	8.2	8.1
		SPHERICAL SONES ⁴	8.3	8.2	7.8	7.4	7.0	6.6	6.5	6.4	6.2
		BHP	1.1	1.1	1.05	1	0.96	0.91	0.85	0.75	0.52
	1000	CFM	3185	3155	2990	2800	2590	2365	2085	1625	-
		HEMISPHERICAL SONES ³	9.4	9.4	9.2	8.7	8.4	8.3	8	7.7	-
		SPHERICAL SONES ⁴	7.7	7.7	7.3	6.9	6.5	6.1	6.0	5.9	-
		BHP	1	1	0.95	0.91	0.86	0.81	0.73	0.61	-
	950	CFM	3015	2980	2805	2600	2375	2115	1755	-	-
		HEMISPHERICAL SONES ³	8.8	8.8	8.6	8.2	7.8	7.6	7.4	-	-
		SPHERICAL SONES ⁴	6.8	6.8	6.4	6.1	5.7	5.4	5.2	-	-
		BHP	0.86	0.85	0.81	0.77	0.72	0.66	0.56	-	-
	880	CFM	2775	2735	2535	2305	2045	1715	-	-	-
		HEMISPHERICAL SONES ³	8	7.9	7.8	7.4	7.1	6.9	-	-	-
		SPHERICAL SONES ⁴	5.6	5.5	5.2	4.9	4.6	4.3	-	-	-
		BHP	0.68	4.6	0.63	0.59	0.54	0.46	-	-	-

- (1) Speed (RPM) shown is nominal. Performance is based on actual speed of test.
- (2) Other speeds listed are obtainable by using Lek-Trol™ model LT40 for fan units CI14 and Lek-Trol™ LT35 for fan unit CI15.
- (3) The sound ratings shown are loudness values in fan sones at 5ft. (1.5m) in a hemispherical free field calculated per AMCA Standard 301.
- (4) The spherical sones values are calculated to represent sound in a spherical free field at 5 ft. (1.5m) per Annex B of AMCA 311.
- (5) Performances shown is for installation type B - Free inlet, Ducted outlet.
- (6) The AMCA Certified Ratings Seal applies to air capacities only. Performance ratings do not include the effects of appurtenances in the airstream.

CIT & CIJ1 | LOW PROFILE CEILING FANS

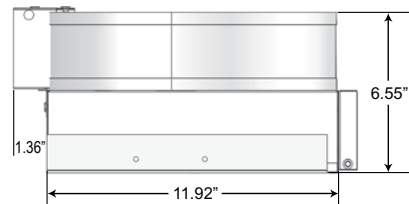
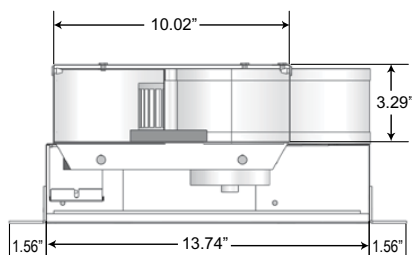

Model	Max. Watts	Motor 60Hz AC	Motor RPM	SP	0.0"	.10"	.125"	.250"	.375"	.500"	.625"	0.750
CIT	48	115/1	1200	CFM	91	88	88	85	75	49	—	—
				HEMISPHERICAL SONES ⁴	1.8	2.2	2.3	2.8	3.0	3.2	—	—
				SPHERICAL SONES ⁵	1.3	1.5	1.5	1.8	2.0	2.3	—	—
				RPM	840	930	970	1110	1280	1460	—	—
CIJ1	125	115/1	1200	CFM	149	156	157	158	160	153	138	117
				HEMISPHERICAL SONES ⁴	2.0	2.3	2.4	3.0	3.4	3.4	3.6	3.5
				SPHERICAL SONES ⁵	1.2	1.5	1.6	1.9	2.2	2.5	2.8	3.1
				RPM	760	1000	1020	1150	1240	1360	1450	1520

- (1) Performance shown is for installation type A - Free inlet, Free outlet.
- (2) Performance ratings include the effects of inlet grille and backdraft damper in the airstream.
- (3) Speed (RPM) shown is nominal. Performance is based on actual speed of test.
- (4) The sound ratings shown are loudness values in fan sones at 5ft. (1.5m) in a hemispherical free field calculated per AMCA Standard 301.
- (5) The spherical sones values are calculated to represent sound in a spherical free field at 5 ft. (1.5m) per Annex B of AMCA 311.
- (6) Values shown are for installation Type A: free inlet fan sone levels. The AMCA Certified Ratings Seal applies to air performance ratings only.

TRANSFAN | TRANSFER FAN

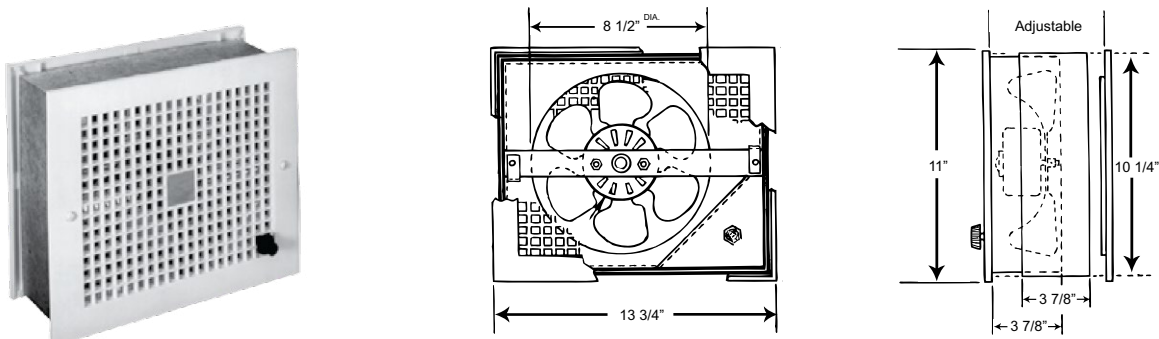

Model	Max Watts	Motor 50/60 Hz AC	Motor RPM	Fan Capacity - CFM				
				SP	0.000	0.050	0.100	0.200
TF8	60	115/1	1250	CFM	255	231	178	132
				HEMISPHERICAL SONES ¹	2.3	2.2	1.9	1.8
				SPHERICAL SONES ²	1.0	1.0	0.9	0.8

- (1) The sound ratings shown are loudness values in fan sones at 5ft. (1.5m) in a hemispherical free field calculated per AMCA Standard 301.
- (2) The spherical sones values are calculated to represent sound in a spherical free field at 5 ft. (1.5m) per Annex B of AMCA 311.
- (3) Performance shown is for installation type A - free inlet, free outlet.
- (4) Performance ratings include the effects of inlet and outlet grilles installed.
- (5) Speed (RPM) shown is nominal. Performance is based on actual speed of test. AMCA certified for Air Performance only.

CL1, CIL1, & CIL2 | CEILING FANS WITH LIGHT

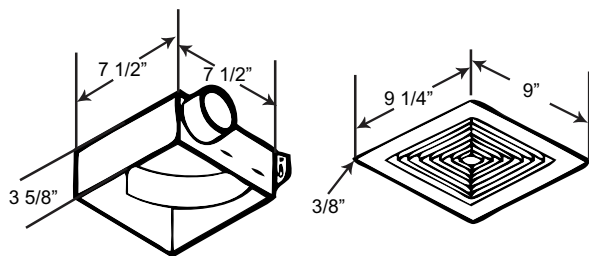

Centrifugal Inline Fan | CL1

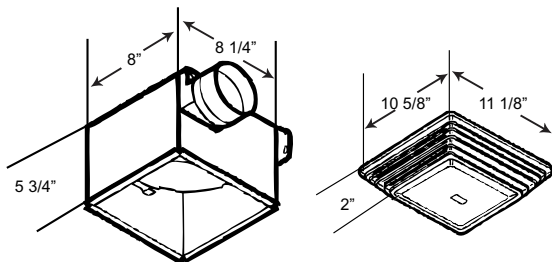

Centrifugal Inline Fan Light | CIL1, CIL2

Model	SONES at 0.0" Ps	Spherical SONES at 0.0" Ps	CFM at Static Pressure (Ps - Inches of H2O)						Volts	Watts	Nominal RPM
			0.000	0.100	0.125	0.250	0.375	0.500			
CL1	3.4	2.3	56	51	50	46	41	32	120	55	1700
CIL1	1.9	1.8	62	51	49	32	9	-	120	30	1070
CIL2	4.0	3.4	97	87	84	69	50	19	120	50	1380

- (1) Performance shown is for installation type B - Free inlet, ducted outlet.
- (2) Performance ratings include the effects of inlet grille and backdraft damper in the airstream.
- (3) Speed (RPM) shown is nominal. Performance is based on actual speed of test.
- (4) The sound ratings shown are loudness values in fan sones at 5ft. (1.5m) in a hemispherical free field calculated per AMCA Standard 301
- (5) The spherical sones values are calculated to represent sound in a spherical free field at 5 ft. (1.5m) per Annex B of AMCA 311.
- (6) Values shown are for installation Type B: free inlet fan sone levels.

CI2 | LOW FLOW CEILING FAN

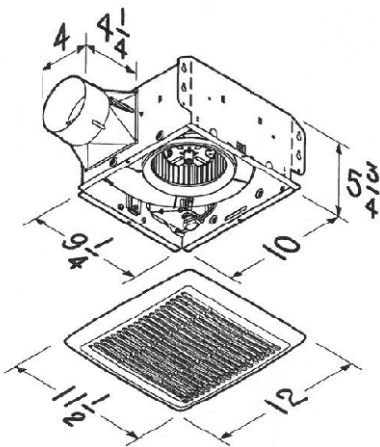

Model	Performance @ Static Pressure (SP) - Inches Water Gauge											Volts	Hz.	Nominal RPM
	0.000" SP		0.100" PS			0.125" SP		0.250" SP		0.375" SP				
	CFM	Sones	CFM	Sones	Watts	CFM	Sones	CFM	Sones	CFM	Sones			
CI2-E	87	1.0	76	1.5	26	72	1.5	56	2.5	38	3.0	120	60	840

- (1) Performance ratings include the effects of inlet grille and backdraft damper.
- (2) Speed (RPM) shown is nominal. Performance is based on actual speed of test.
- (3) The sound ratings are loudness values in fan sones at 5' (1.5m) in a hemispherical free field calculated per AMCA Std. 301.
- (4) Values shown are for Installation Type B: free inlet hemispherical sone levels.
- (5) Performance certified is for Installation Type B: Free Inlet, Ducted outlet.

CIQ80(L)-GPE AND CIQ110(L)-GPE DIMENSIONS AND PERFORMANCE

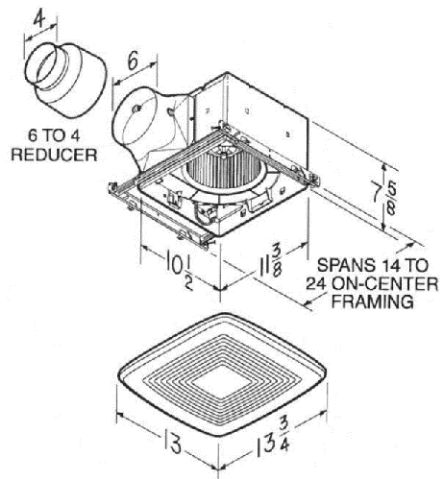

Centrifugal Inline Fan Quiet |
CIQ80, CIQ110

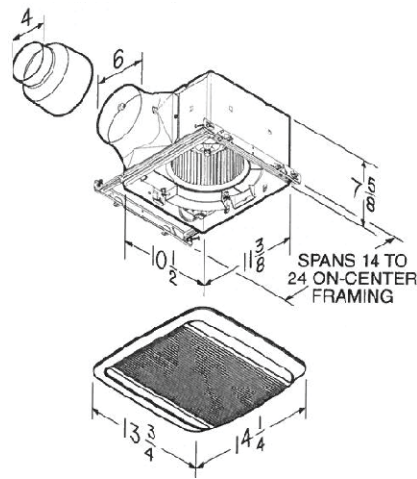

Centrifugal Inline Fan Quiet Light |
CIQ80L, CIQ110L

Model	Duct Size	Performance @ Static Pressure(Ps) - Inches Water Gage														Volts	Hz.	Nominal RPM
		0.100" Ps			0.125" Ps		0.250" Ps		0.375" Ps		0.500" Ps		0.625" Ps					
		CFM	Sones	Watts	CFM	Sones	CFM	Sones	CFM	Sones	CFM	Sones	CFM	Sones				
CIQ80-GPE	4" Round	80	< 0.3	7.8	80	0.3	80	1.0	78	1.8	64	2.4	37	3.0	120	60	985	
	6" Round	80	< 0.3	6.1	80	<0.3	80	0.6	78	1.4	66	2.2	38	3.0	120	60	935	
CIQ110-GPE	6" Round	110	< 0.3	8.4	110	<0.3	109	1.4	100	2.3	62	3.0	28	3.6	120	60	940	
CIQ80L-GPE	4" Round	80	<0.3	8.3	80	0.3	79	0.9	79	1.6	62	2.1	34	2.6	120	60	1020	
	6" Round	80	<0.3	6.7	80	<0.3	79	0.6	79	1.3	70	2.1	37	2.6	120	60	980	
CIQ110L-GPE	6" Round	110	0.3	9.3	110	0.4	110	1.1	93	1.9	57	2.6	22	3.4	120	60	980	

- (1) Performance ratings include the effects of inlet grille and backdraft damper.
- (2) Speed (RPM) shown is nominal. Performance is based on actual speed of test.
- (3) The sound ratings are loudness values in fan sones at 5' (1.5m) in a hemispherical free field calculated per AMCA Std. 301.
- (4) Values shown are for Installation Type B: free inlet hemispherical sone levels.
- (5) Performance certified is for Installation Type B: Free Inlet, Ducted outlet.



Printed on recycled paper.

Johnson Controls, the Johnson Controls logo, YORK® and Heresite® are trademarks of Johnson Controls, Inc., or its affiliates, in the United States of American and/or other countries.

©2018 Johnson Controls, Inc., P.O. Box 423, Milwaukee, WI 53201 Printed in USA PUBL-7617 Centrifugal Inline Fan September 2018
www.johnsoncontrols.com

