

EFJ-937

(standard)

*Louver dimensions furnished approximately 1/2" (13) undersize.

Ratings

Free Area: [48" × 48" (1219 × 1219) unit]: 8.6 ft² (0.80m²)
53.9%

Performance @ Beginning Point of Water Penetration

Free Area Velocity: Above 1,250 fpm (6.35 m/s)

Air Volume Delivered: 10,755 cfm (5.09 m³/s)

Pressure Loss: 0.48 in.wg. (121 Pa)

Velocity @ 0.15 in.wg. Pressure Loss: 705 fpm (3.58 m/s)

AMCA 540 (impact resistant) listed

AMCA 550 (high velocity rain resistant) listed

Design Load: 130 psf

The EFJ-937 dual-module louver is engineered and tested to withstand extreme loads, debris impact, and cyclic fatigue associated with the severe weather effects of hurricanes. The front (exterior) side of the louver features horizontal J-style blades for a pleasing architectural appearance. The interior side features vertical chevron blades which provide superior resistance to wind-driven rain. Both installation options for the EFJ-937 feature minimal required hardware. The EFJ-937 is AMCA 540 and 550 listed, making it ideally suited for use in hurricane-prone and wind-borne debris regions per the International Building Code.

Standard Construction

Material: Mill finish extruded aluminum

Frame: 9" deep x 0.125" thick (232 x 3) channel

Blades: Front: 37° × 0.081" (2.1) thick horizontal J style
Rear: 0.060" (1.5) thick vertical chevron

Screen: 1/2" × 0.063" (12.7 × 1.6) expanded and flattened aluminum

Mullion: Visible

Minimum Size: 12" × 12" (305 × 305)

Maximum Size:

Single section: 60" × 120" (1524 × 3048)

Multiple section: Unlimited width × 120" (3048)

Installation Hardware: Standard continuous angles and associated fasteners (anchors to substrate by others - refer to installation instructions)

Options

■ Factory finish:

- High Performance Fluoropolymer ■ Prime Coat
- Baked Enamel ■ Clear Anodize ■ Integral Color Anodize

■ Frame Options:

- 1-1/2" (38) flange frame

■ Alternate bird or insect screens

■ Insulated or non-insulated blank-off panels

■ Filter racks

■ Head and/or sill flashing

■ Burglar Bars

■ Full sleeve and retaining angles (eliminates need for anchors to substrate; 1-1/2" (38) flange frame required)

■ Net OD (actual size)



NOTE: Dimensions in parentheses () are millimeters.
Information is subject to change without notice or obligation.

PERFORMANCE

EFJ-937

Extruded Aluminum Louver
9" deep • 37° J-blade with Vertical Blade rear section

Free Area (ft²)

| | | Width (Inches) | | | | | | | | |
|-----------------|-----|----------------|-----|------|------|------|------|------|------|------|
| | | 12 | 18 | 24 | 30 | 36 | 42 | 48 | 54 | 60 |
| Height (Inches) | 12 | 0.2 | 0.3 | 0.5 | 0.6 | 0.8 | 0.9 | 1.1 | 1.2 | 1.4 |
| | 18 | 0.4 | 0.7 | 1.1 | 1.4 | 1.7 | 2.0 | 2.3 | 2.6 | 3.0 |
| | 24 | 0.7 | 1.1 | 1.6 | 2.1 | 2.6 | 3.1 | 3.6 | 4.1 | 4.6 |
| | 30 | 0.9 | 1.6 | 2.2 | 2.9 | 3.5 | 4.2 | 4.8 | 5.5 | 6.2 |
| | 36 | 1.1 | 2.0 | 2.8 | 3.6 | 4.4 | 5.3 | 6.1 | 6.9 | 7.8 |
| | 42 | 1.4 | 2.4 | 3.4 | 4.4 | 5.4 | 6.4 | 7.4 | 8.4 | 9.4 |
| | 48 | 1.6 | 2.8 | 3.9 | 5.1 | 6.3 | 7.4 | 8.6 | 9.8 | 11.0 |
| | 54 | 1.8 | 3.2 | 4.5 | 5.8 | 7.2 | 8.5 | 9.9 | 11.2 | 12.6 |
| | 60 | 2.1 | 3.6 | 5.1 | 6.6 | 8.1 | 9.6 | 11.1 | 12.6 | 14.2 |
| | 66 | 2.3 | 4.0 | 5.7 | 7.3 | 9.0 | 10.7 | 12.4 | 14.1 | 15.8 |
| | 72 | 2.5 | 4.4 | 6.2 | 8.1 | 9.9 | 11.8 | 13.7 | 15.5 | 17.4 |
| | 78 | 2.7 | 4.8 | 6.8 | 8.8 | 10.9 | 12.9 | 14.9 | 16.9 | 19.0 |
| | 84 | 3.0 | 5.2 | 7.4 | 9.6 | 11.8 | 14.0 | 16.2 | 18.4 | 20.6 |
| | 90 | 3.2 | 5.6 | 8.0 | 10.3 | 12.7 | 15.1 | 17.4 | 19.8 | 22.2 |
| | 96 | 3.4 | 6.0 | 8.5 | 11.1 | 13.6 | 16.1 | 18.7 | 21.2 | 23.7 |
| | 102 | 3.7 | 6.4 | 9.1 | 11.8 | 14.5 | 17.2 | 19.9 | 22.6 | 25.4 |
| | 108 | 3.9 | 6.8 | 9.7 | 12.6 | 15.4 | 18.3 | 21.2 | 24.1 | 26.9 |
| | 114 | 4.1 | 7.2 | 10.2 | 13.3 | 16.3 | 19.4 | 22.5 | 25.5 | 28.6 |
| | 120 | 4.4 | 7.6 | 10.8 | 14.0 | 17.3 | 20.5 | 23.7 | 26.9 | 30.1 |



Certified Ratings:

All-Lite certifies that the model EFJ-937 shown herein is licensed to bear the AMCA seal. The ratings shown are based on tests and procedures performed in accordance with AMCA Publication 511 and comply with the requirements of the AMCA Certified Ratings Program. The AMCA Certified Ratings seal applies to air performance, water penetration and wind-driven rain ratings.



HIGH VELOCITY RAIN RESISTANT AND IMPACT RESISTANT LOUVER

Enhanced Protection

See www.AMCA.org for all certified or listed products

This label does not signify
AMCA airflow performance
certification.

Certified Ratings:

All-Lite certifies that the model EFJ-937 shown herein is approved to bear the AMCA listing label. The ratings shown are based on tests and procedures performed in accordance with AMCA publications and comply with the requirements of the AMCA listing label program. The AMCA listing label applies to impact resistant louvers and high velocity rain resistant louvers.

Water Penetration

AMCA defines the beginning point of water penetration as the free area velocity at the intersection of a simple linear regression of test data and the line of 0.01 ounces of water per square foot of free area measured through a 48" x 48" louver during a 15 minute period. The AMCA water penetration test provides a method for comparing louver models and designs as to their efficiency in resisting the penetration of rainfall under specific lab conditions. We recommend that intake louvers are selected with a reasonable margin of safety below the beginning point of water penetration in order to avoid unwanted penetration during severe storm conditions.

Beginning Point of Water Penetration = 1,250 fpm

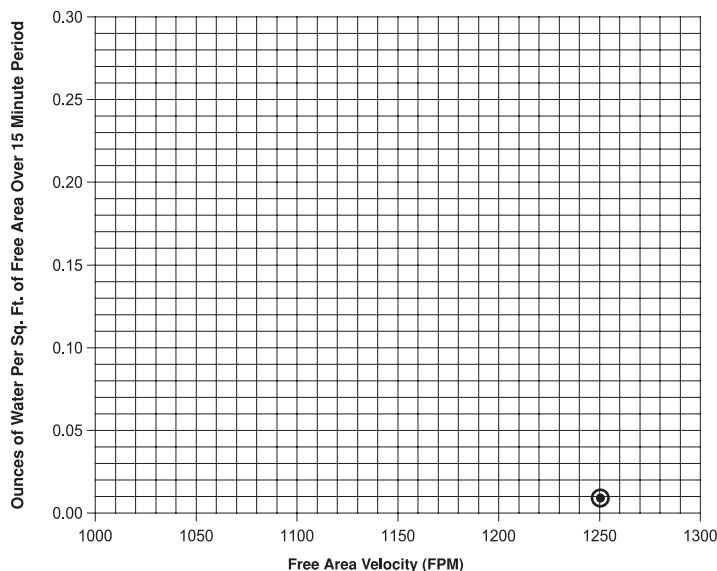

Pressure Loss

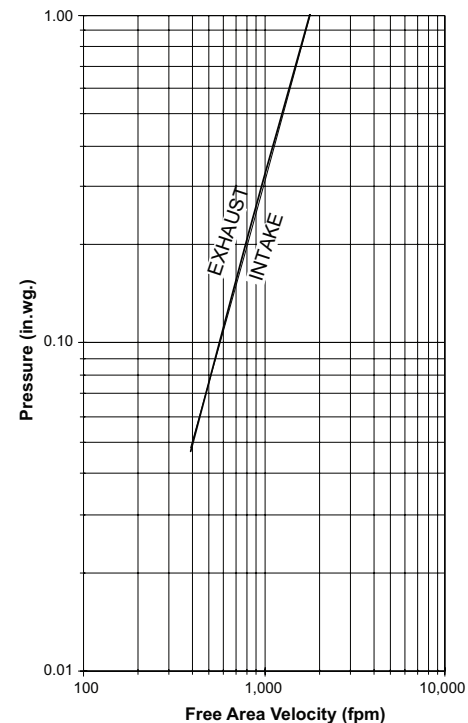

Louver Test Size = 48" x 48" (1219 x 1219)

Pressure loss tested in accordance with Figure 5.5 of AMCA Standard 500-L. Data corrected to standard air density.

PERFORMANCE

EFJ-937

Extruded Aluminum Louver

9" deep • 37° J-blade with Vertical Blade rear section

Wind Driven Rain Performance - AMCA 500L Wind-Driven Rain Test

| Wind Velocity | Rainfall | Airflow | Core Velocity ¹ | Effectiveness Ratio | Wind-Driven Rain Penetration Class | Discharge Loss Class ² |
|---------------|----------|------------|----------------------------|---------------------|------------------------------------|-----------------------------------|
| 29 mph | 3 in/hr | 10,640 cfm | 988 fpm | 100% | A | 3 |
| 50 mph | 8 in/hr | 9,599 cfm | 892 fpm | 99.0% | A | |

NOTE:

1. Core area is the open area of the louver face (face area less louver frame). Core velocity is the airflow divided by core area. Test louver core area is 10.77 ft² (1 m²).

2. Discharge Loss Coefficient is calculated by dividing the louver's actual airflow rate by the theoretical airflow rate for an unobstructed opening. The higher the coefficient, the lower the resistance to airflow.

Wind Driven Rain

| Class | Effectiveness |
|-------|---------------|
| A | 99% and above |
| B | 95% to 98.9% |
| C | 80% to 94.9% |
| D | below 80% |

Discharge Loss

| Class | Coefficient |
|-------|-----------------|
| 1 | 0.4 and above |
| 2 | 0.3 to 0.399 |
| 3 | 0.2 to 0.299 |
| 4 | 0.199 and below |

Attributes

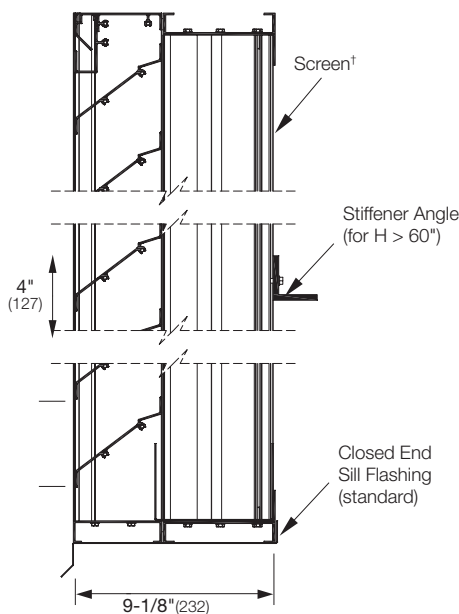

Vertical Section

†Screen adds approximately 3/16" (5) to louver depth

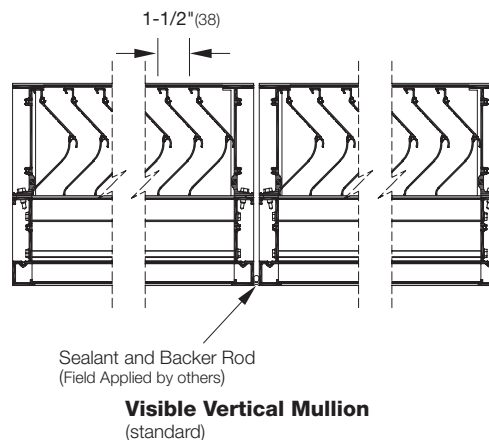
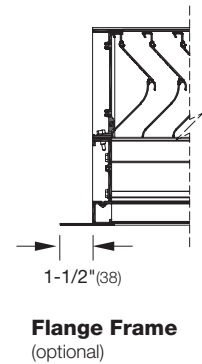
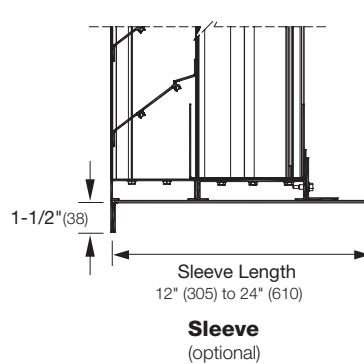

Supplemental Options

EFJ-937

Extruded Aluminum Louver
9" deep • 37° J-blade with Vertical Blade rear section

Insulation Thickness

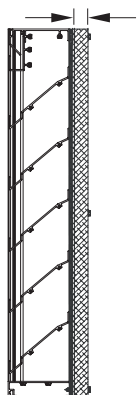

Blank-Off Options

Non-Insulated and Gasketed
1" Insulated (4.25 R-value)
2" Insulated (8.75 R-value)

Filter Rack
Filter
(by others)

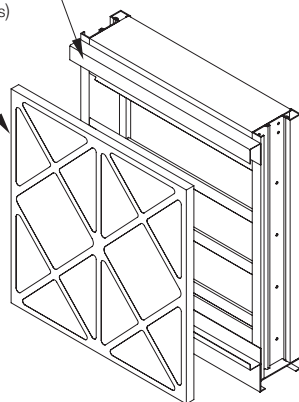

Filter Rack

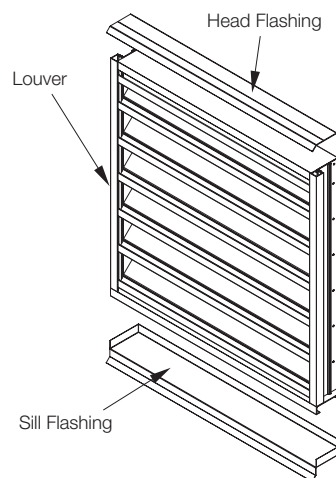

Flashing Options

Head and Sill Available