

prioAir SERIES
VANE AXIAL INLINE DUCT FAN

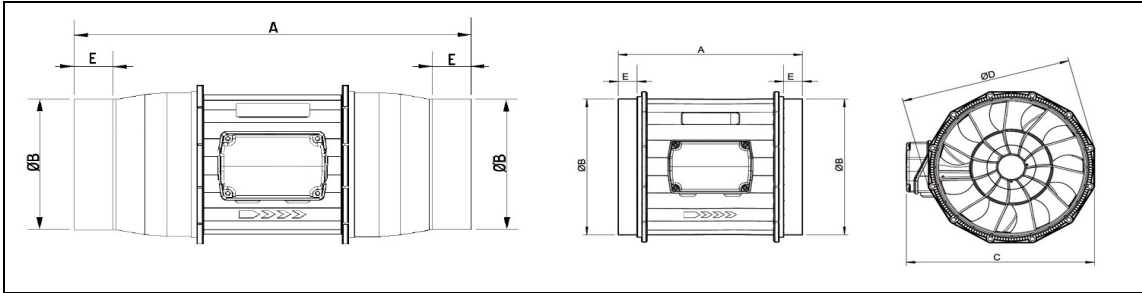

Dimensional Diagram:



Dimensional Table:

Model	A	B	C	D	E
prio 150E2 / prio 150EC	16-3/16	5-7/8	8-1/4	7-3/8	1-5/8
prio 200E2 / prio 200EC	9-11/16	7-7/8	9-3/4	9	1
prio 250 / prio 250EC	12	9-13/16	11-15/16	11-1/4	1

Dimensions are in inches (mm)

Performance Data:

Certified Data

Model Name	Energy Star	Rated Power W	Voltage/p hase V/~	Max Amp A	RPM min ⁻¹		Static Pressure (inch W.C.)							Max Ps (Inch W.C.)	Item #
							0	0.2	0.4	0.6	0.8	1	1.2		
prio 150E2	YES	37	120/1	0.29	2800	CFM Sone dB(A)	295 - -	252 8.9 67	195 - -	38 - -	- - -	- - -	0.72		
prio 150EC	YES	66	120/1	1.05	4000	CFM Sone dB(A)	443 - -	418 11.3 74	387 - -	352 - -	313 - -	261 - -	88	1.54	37330
prio 200E2	YES	93	120/1	0.81	3000	CFM Sone dB(A)	646 - -	602 15.3 76	553 - -	487 - -	351 - -	181 - -	54	1.28	
prio 200EC	YES	128	120/1	1.8	3600	CFM Sone dB(A)	791 - -	745 13.7 77	702 - -	656 - -	604 - -	534 - -	423	1.84	37329
Prio 250E2	YES	304	120/1	2.63	3000	CFM Sone dB(A)	1380 - -	1324 17.7 81	1264 - -	1200 - -	1127 - -	1043 - -	937	2.09	
prio 250EC	YES	164	120/1	2.4	2700	CFM Sone dB(A)	1237 - -	1156 14 77	1079 - -	997 - -	900 - -	769 - -	560	1.66	56071

Performance certified is for installation type D: Ducted inlet, Ducted outlet
 Speed (RPM) shown is nominal. Performance is based on actual speed of test
 Performance ratings do not include the effects of appurtenances (accessories)
 The sound ratings shown are loudness values in hemispherical sones at 1.5 m (5 ft) in a hemispherical free field calculated per ANSI/AMCA Standard 301
 Values shown are for Installation Type D: ducted inlet hemispherical sone levels. Ratings do not include the effects of duct end corrector
 All sone values shown are calculated at 0.2" (static pressure in inches W.G.)

Certifications:



Systemair Mfg. Inc. certifies that the prioAir series shown herein is licensed to bear the AMCA seal. The ratings shown are based on tests and procedures performed in accordance with AMCA Publication 211 and AMCA Publication 311 and comply with the requirements of the AMCA Certified Ratings Program. Performance certified is for installation type D- Ducted inlet, Ducted outlet
 Performance ratings do not include the effects of appurtenances (accessories).

Catalog Series: prioAir Series
 Revision Date: October 2019