

# VENTEX

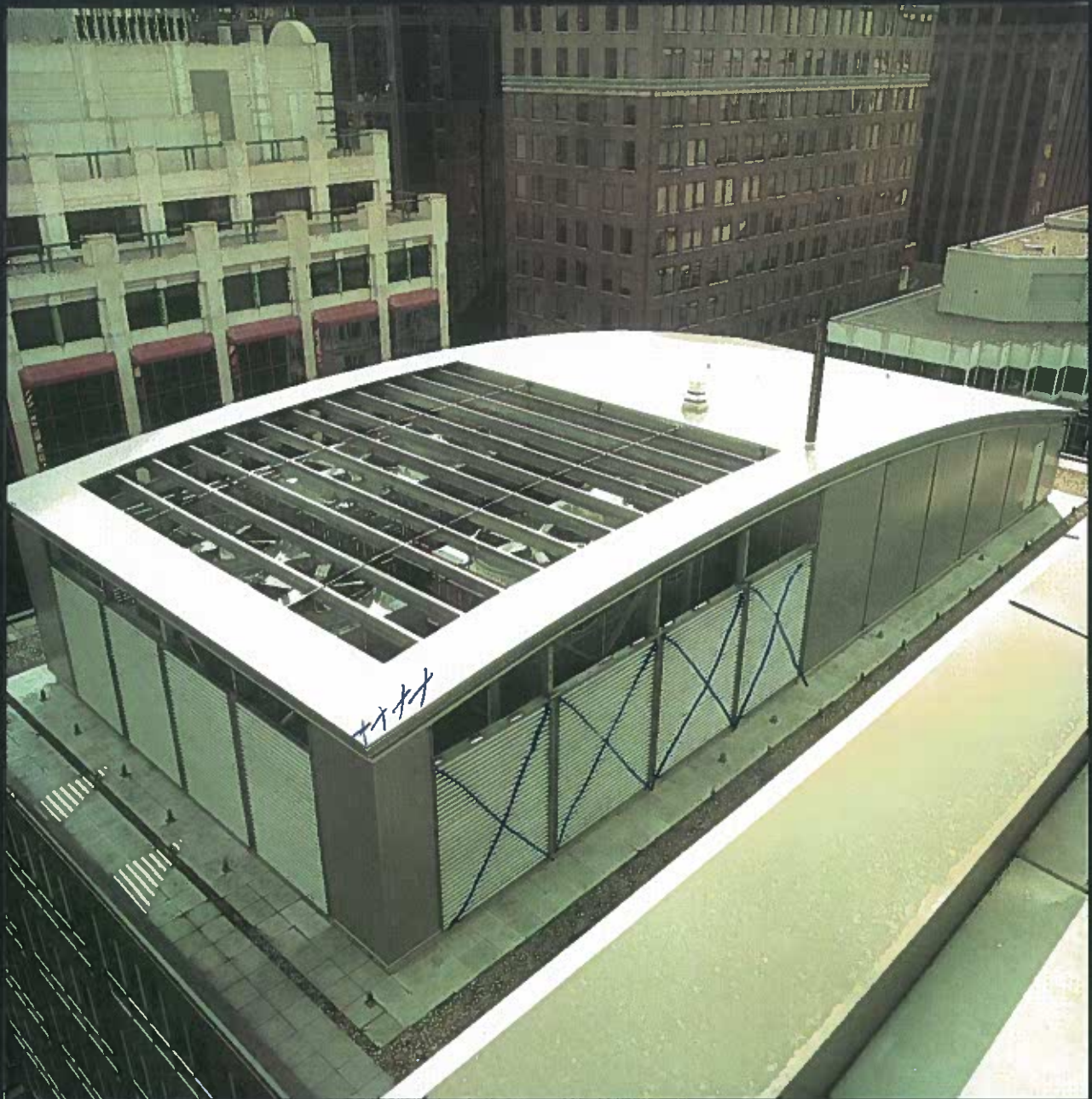

QUALITY VENTEX LOUVERS AND DAMPERS  
ARE USED THROUGHOUT NORTH AMERICA

Specifications Catalogue • Volume 6 • January 2003  
1 • 800 • 668 - 7214 Fax: 1 • 888 • 891 • 6504

# PRESIDENT'S MESSAGE

Ventex has risen to a position of leadership in the North American louver manufacturing industry by operating on our simple philosophy of supplying excellent, top quality products.

We manufacture every product to exact specifications, executing strict quality control procedures. We have implemented a new computerized order management system. Integral to this system are new state of the art automated cutting equipment and computerized workstations featuring bar code readers. This enables us to track each order through the manufacturing process, from order entry to shipping. Orders are now scheduled more efficiently and lead times have been reduced.

You can rest assured that your project is in capable hands when you choose Ventex products. If you have a special requirement, we also manufacture an extensive range of custom designs just for you. Every louver is designed to meet your specific needs, manufactured of durable aluminum and thoroughly tested to give you years of dependable service.

Our comprehensive product line is clearly laid out in this catalogue. The well-illustrated designs and detailed specifications allow for easy selection. You will find our catalogue to be a complete and valuable resource.

On behalf of the employees of Ventex, I thank you for your business. We look forward to serving you for many years to come.

Sincerely,

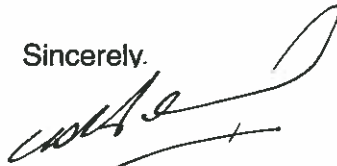

William (Bill) Haley,  
President

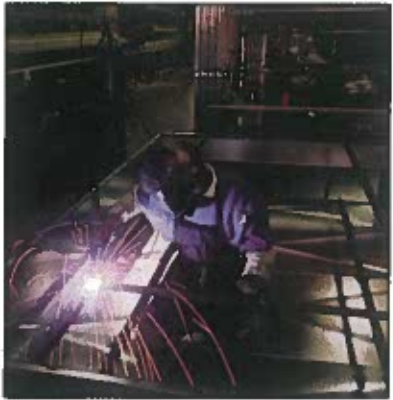



LOUVER SELECTION CHART ..... 4

SPECIALTY GEOMETRIC SHAPES ..... 5

MOUNTING OPTIONS ..... 5

LOUVER SELECTION GUIDELINES ..... 6

PAINTING AND ANODIZING ..... 7

MODEL 2210 & 2215 EXHAUST LOUVERS ..... 8

MODEL 2220 & 2225 STORMPROOF LOUVERS ..... 10

MODEL HI PRO 2410 & 2415 EXHAUST LOUVERS ..... 12

MODEL HI PRO 2420 & 2425 STORMPROOF LOUVERS ..... 14

MODEL HI PRO 2430 & 2435 DRAINABLE LOUVERS ..... 16

MODEL 2440 & 2445 TRANSFORMER VAULT LOUVERS ..... 18

MODEL HI PRO 2450 & 2455 HIGH PERFORMANCE LOUVERS ..... 20

MODEL HI PRO 2460 & 2465 HIGH PERFORMANCE STORMPROOF LOUVERS ..... 22

MODEL 2590 WIND DRIVEN LOUVER ..... **NEW** 24

MODEL 2620 & 2625 STORMPROOF LOUVERS ..... 26

MODEL 2630 & 2635 DOUBLE DRAINABLE LOUVERS ..... 28

MITRE CORNER PENTHOUSE ..... 30

MULLION CORNER PENTHOUSE ..... 31

GRAVITY VENTILATOR ..... **NEW** 32

MODEL BV – BRICK VENT ..... 33

MODEL ACL ACOUSTIC LOUVER ..... 34

COMBINATION HI-PRO 2670/2675-CLD DRAINABLE LOUVER ..... **NEW** 36

MODELS 2420-OP/2425-OP STORMPROOF OPERABLE LOUVER ..... 37

BACK DRAFT DAMPER MODEL BDD ..... 38

RFD ROLL FORM DAMPER ..... **NEW** 40

MODEL MBD MOTORIZED DAMPER ..... 41

MODEL DG – DOOR GRILLE ..... 42

COLOR CHART ..... Back Cover

**NOTE:**  
 Although great care has been taken in the production of this catalogue, illustrative or copy errors may occur. Ventex assumes no liability for any errors contained herein. This publication supercedes all prior technical, policy, and print data. Specifications subject to change without notice.  
 Copyright © January 2003 Ventex. ALL RIGHTS RESERVED. Printed in Canada.



# LOUVER SELECTION CHART

## VENTEX LOUVER SELECTION CHART

### EXTRUDED ALUMINUM LOUVERS

Depth	Model Number	Material	Blade Thickness	Blade Type	Blade Angle	Blade Centre	Min. Height	Max. Panel Width	Max. Panel Size	Free Area Unit Size 48" x 48"
2"	2220/2225	Extr. Alum.	0.062"	Stormproof	45°	3"	6"	72"	48 sq. ft.	7.22 sq. ft.
2"	2210/2215	Extr. Alum.	0.062"	Straight	30°	2"	6"	72"	48 sq. ft.	8.71 sq. ft.
4"	2420/2425	Extr. Alum.	0.081"	Stormproof	45°	4 7/8"	12"	120"	60 sq. ft.	8.49 sq. ft.
4"	2430/2435	Extr. Alum.	0.081"	Drainable	35°	3 1/2"	12"	120"	60 sq. ft.	9.06 sq. ft.
4"	2410/2415	Extr. Alum.	0.081"	Straight	35°	3 1/2"	12"	120"	60 sq. ft.	9.39 sq. ft.
4"	2440/2445	Extr. Alum.	0.062"	Chevron	45°	3"	12"	72"	48 sq. ft.	7.37 sq. ft.
4"	2420-OP 2425-OP	Extr. Alum.	0.081"	Operable	45°	6 1/8"	16"	60"	24 sq. ft.	6.96 sq. ft.
4"	2450/2455	Extr. Alum.	0.081"	Straight	35°	3 1/2"	12"	120"	60 sq. ft.	9.26 sq. ft.
4"	2460/2465	Extr. Alum.	0.08"	Stormproof	45°	4 7/8"	12"	120"	60 sq. ft.	7.97 sq. ft.
5"	2590	Extr. Alum.	0.07	Wind/Rain	40°	2.75"	12"	60"	60 sq. ft.	7.43 sq. ft.
6"	2620/2625	Extr. Alum.	0.081"	Stormproof	45°	7 1/4"	16"	72"	72 sq. ft.	8.06 sq. ft.
6"	2630/2635	Extr. Alum.	0.09"	Drainable	40°	4 5/8"	16"	72"	72 sq. ft.	8.30 sq. ft.
6"	ACL600	Extr. Alum.	1"	Acoustic Stormproof	39°	5 7/8"	16"	72"	72 sq. ft.	4.80 sq. ft.
6"	2670-CLD	Extr. Alum.	0.081	Combination	40°	3.75"	12"	60"	30 sq. ft.	8.00 sq. ft.

### FORMED STEEL OR ALUMINUM LOUVERS

8"	ACL800	Formed Alum.	14 Gauge 0.063"	Acoustic Straight	45°	8"	16"	72"	48 sq. ft.	4.52 sq. ft.
8"	ACL800S	Formed Steel	20 Gauge 0.039"	Acoustic Straight	45°	8"	16"	72"	48 sq. ft.	4.52 sq. ft.
12"	ACL1200	Formed Alum.	14 Gauge 0.063"	Acoustic Straight	45°	12"	24"	72"	48 sq. ft.	4.07 sq. ft.
12"	ACL1200S	Formed Steel	20 Gauge 0.039"	Acoustic Straight	45°	12"	24"	72"	48 sq. ft.	4.07 sq. ft.

### DAMPERS

Model	Material	Thickness	Blade Type	Blade Centre	Min. Height	Maximum Single Panel Width	Maximum Double Panel Width
BDD	Extr. Alum.	0.062"	Gravity Blades	3 3/4"	9"	40"	60"
MBD	Extr. Alum.	0.062"	Motor Control	3 3/4"	8"	40"	60"
RFD	Rolled Alum.	0.062" & 0.032"	Gravity Blades	3 3/4"	9"	35"	60"

## SPECIALTY GEOMETRIC SHAPES



These are some specialty shapes that are available and can be manufactured from selected models. Contact your representative for your special requirements.



Arc

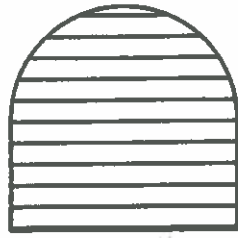

Arched

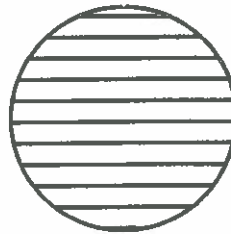

Circle

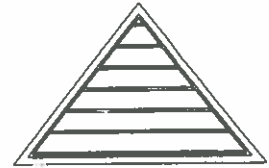

Triangle

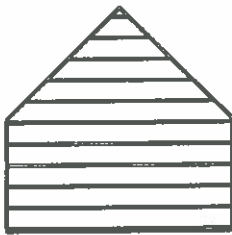

Peaked Top

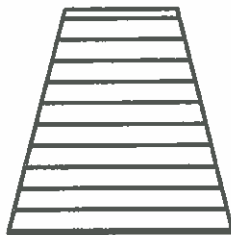

Trapezoid

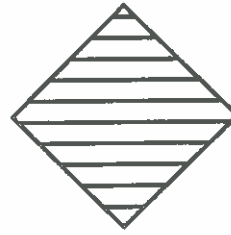

Diamond

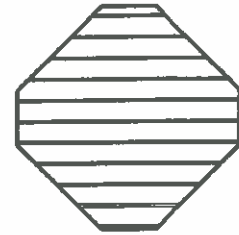

Octagon

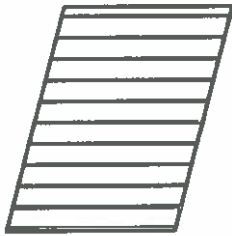

Parallelogram

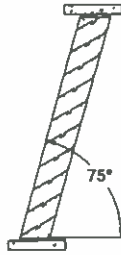

Sloping Jambs



Double Deflection

## MOUNTING OPTIONS

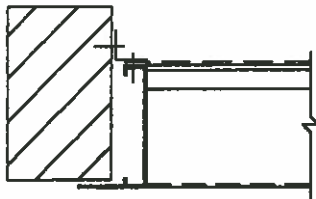

Flange Frame

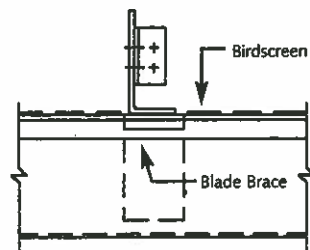

Hidden Mullion

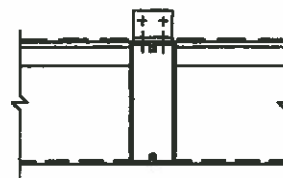

Exposed Mullion

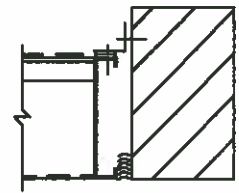

Channel Frame

## FREE AREA

Free area is the unobstructed area of a louver through which air can pass freely. The free area of a louver is one of the most important considerations when sizing a louver. The free area and total volume of air will determine the velocity of air through the louver. The free area velocity determines the size of the louver based on design constraints such as static pressure drop and water penetration.

The free area of a louver is calculated by the following formula:

$$\text{Free Area (In sq. ft.)} = \text{MD} [A+B+(N \times C)] / 144$$

Where:

MD = Minimum distance between the louver jambs.

A = Distance between the head and the top louver blade.

B = Distance between the sill and the bottom louver blade.

N = Number of openings between the louver blades.

C = Minimum space between the louver blades.

Percentage Free Area:

$$\text{MD} [A+B+(N \times C)] / W \times H$$

Where:

W = Actual louver width.

H = Actual louver height.

## SIZING LOUVERS

To choose the correct size louver, please use the following steps:

- Determine which louver would be best suited for the application.
- Determine the total volume of air (Cubic Feet per Minute or CFM) that will pass through the louver.
- Determine the most important design criteria, by choosing from a, b or c:
  - a) Not to allow water to penetrate through the louver. If water penetration is the most important design criteria, then use a velocity less than that shown on the water penetration chart.

b) Not to exceed a certain static pressure drop. If static pressure drop is the most important design criteria, then use a velocity equal to that shown on the pressure drop chart.

c) If both are equally important, use the lower of the two velocities.

- To determine the total free area required, divide the volume of air (CFM) by the velocity through the free area (FPM).
- Match the free area required to the free area chart of the chosen louver. This will determine the overall dimensions of the louver required.

For example: A louver must allow 9300 CFM to pass through it without any water penetration and the plan calls for a 4" stormproof louver. From the water penetration chart of the 2420, the velocity should be 600 FPM. As a result, the free area required is 15.5 sq. ft. and the louver size can be found using the free area chart as 64" x 64".

## DRAINABLE LOUVERS

Drainable louvers are designed to collect the water that flows down over the louver's face and disperse the water through spouts in the jambs of the louver. Drainable louvers are effective only when the blades and drainage spouts are free of debris. They should be checked regularly and cleaned when necessary, to ensure they continue to perform well. Drainable louvers should **NOT** be specified as continuous line louvers. The design of the louver system requires that the collected waste be dispersed away from the face of the louver. By eliminating the visible mullions on a large span of drainable louvers, the water could possibly overflow the gutters and cascade down the face of the louver and fail. Ventex recommends using drainable louvers only in applications where the louver size is restricted, or there is a large volume of air passing through the louver.

## AVAILABLE ACCESSORIES

- 1/2" x 1/2" inter-crimped 14 gauge (.063") aluminum bird screen.
- 1/4" x 1/4" inter-crimped 14 gauge (.063") aluminum bird-screen.
- Insect screen 16" x 18" aluminum mesh.
- 1/2" x 1/2" galvanized birdscreen in a removable frame.
- Continuous blade construction with hidden mullions to give an uninterrupted appearance. Continuous line construction is available for the stormproof and straight blade (exhaust) louvers. It is not recommended for use on drainable louvers.

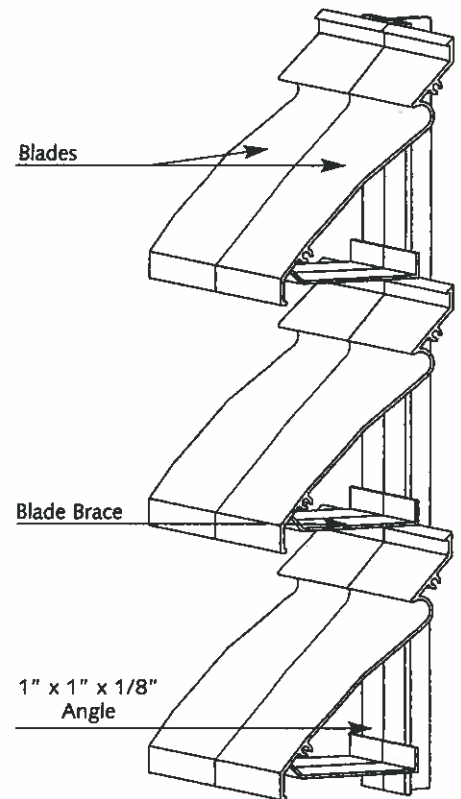

Typical Continuous Line Construction

- Blank-off single sheet panels are available in both aluminum 16 gauge (.05") or steel 20 gauge (0.039").
- 1" or 2" insulated blank-off panels are available in both aluminum 16 gauge (.05") or steel 20 gauge (0.039") with styrofoam insulation.

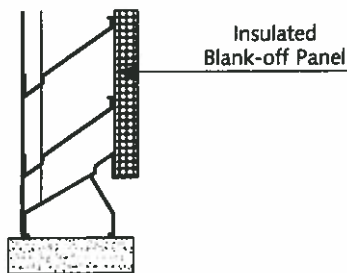

The louver door may be built into the louver so that the door is hidden from view.

- Ventex manufactures louvers in many custom geometric shapes. Please refer to the specialty geometric shapes section (p. 3) for a sample of available shapes.
- 1/2" diameter steel bars mounted on 6" centres are available painted or primed for painting by others. The steel frames are 2" deep by 1/4" thick.
- Custom sill lengths and shapes are available. Depth of sill will vary by louver selection.

- Extended sleeves are available for all of our louvers, dampers and brick vents.
- Filter racks, disposable filters and washable and replaceable media filters are available in 1" and 2" deep filters.

If you require an item or filter not shown here, please contact your Ventex representative. We will assist you in designing a louver or a feature that meets the requirements of your design.

- All welded construction is available when required.
- Hinged louver access doors are available for applications that require access to the room or equipment behind the louver.

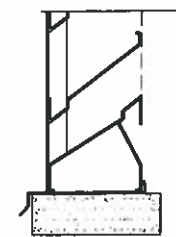
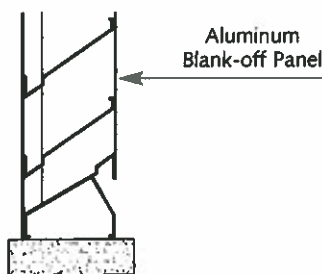

Typical Extended Sill

## PAINTING AND ANODIZING

### BAKED ENAMEL FINISH

"Den Hi-Tech" is a baking polyester especially developed to coat products requiring high resistance and exceptional durability for exterior as well as interior. This polyester enamel is ideal for coating aluminum extrusion and meets with the C.G.S.B. 1GP300 norm as well as the A.A.M.A. performance for aluminum extrusion. To ensure the quality of the finish, all products will be cleaned free of dust, oil, grease, rust, etc, using zinc phosphate in an automated two-stage washing process. The product is then coated with a two-part zinc vinyl wash primer to provide a greater adhesive bond for the baked enamel finish. Once painted, the product is baked at a temperature of 350°F (177°C) to harden the paint. See back cover for standard color selection.

### PRIME COAT FINISH

Ventex offers a prime coat finish as an alternative to the factory-applied finish for projects that require field painting. Louvers shall be cleaned using two-step washing process. To ensure the quality of the finish, all products will be cleaned free of dust, oil, grease, rust etc., using zinc phosphate in an automated two-stage washing process. Then the two-part zinc vinyl wash is applied for finishing in the field.

### ANODIZED FINISH / CLEAR ANODIZED FINISH

Clear anodized finish is a controlled electrochemical process which rapidly increases the thickness and density of aluminum's oxide coating. The process makes the external clear coat of the aluminum extremely hard and scratch resistant. The clear anodized finish requires very little, if any, maintenance.

### COLOR ANODIZED FINISH

Color anodized finishes are produced by immersing clear anodized material into a colored, metallic compound and electrolyte solution. The color penetrates the pores of the oxide coating, giving the material its color.

Colors available: Light Bronze, Medium Bronze, Dark Bronze, Black.



## 2210 AND 2215 EXHAUST LOUVERS

The Ventex 2210/2215 louver is a two inch (50 mm) deep, straight blade exhaust louver, with a high free area. The 2210 is normally used as an exhaust louver for applications where the total CFM is relatively low or the louver height is restricted.

### STANDARD CONSTRUCTION

Depth	2" (50 mm)
Material	Extruded 6063-T5 Aluminum
Frame Thickness	0.062" (1.57 mm)
Frame Styles	Model 2210 Channel Frame Model 2215 Flange Frame 2" Flange Frame
Blade Thickness	0.062" (1.57 mm)
Blade Angle	30°
Blade Centres	2" (50 mm) blade centres
Standard Birdscreen	1/2" x 1/2", re-galvanized, 19 gauge
Minimum Height	6" (152 mm)
Maximum Panel Height	72" (1800 mm)
Maximum Panel Width	72" (1800 mm)
Available Finishes	Mill Finish, Polyester Baking Enamel, Clear or Colored Anodized Finish
Free Area (48" x 48" Unit)	8.71 sq. ft. (0.809 m <sup>2</sup> )

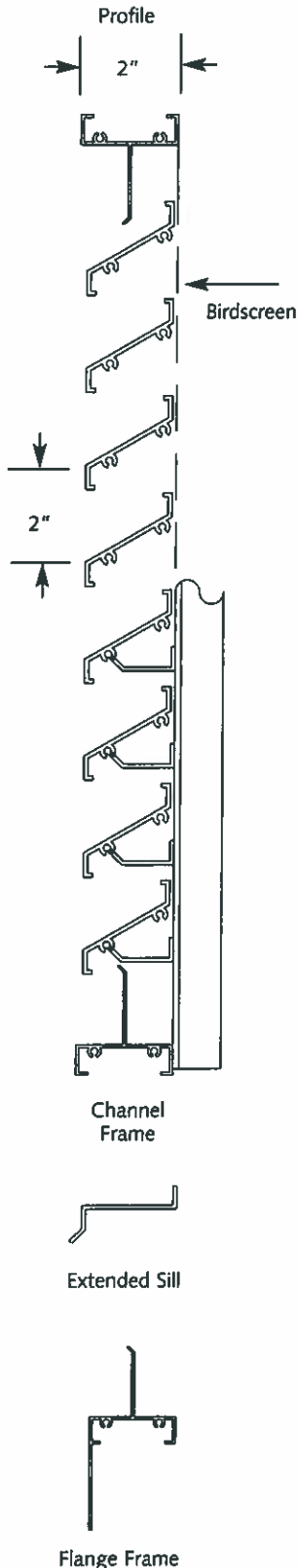

### ACCESSORIES

- 1/2" x 1/2" or 1/4" x 1/4" inter-crimped aluminum birdscreen
- Insect screen
- Continuous blade construction with hidden mullions to give an uninterrupted appearance
- Non-insulated blank-off panels
- 1" or 2" insulated blank-off panels
- All welded construction
- Hinged access doors
- Custom geometric shapes
- Security bars
- Extended sills
- Extended sleeves
- Filter racks







## PERFORMANCE DATA

### FREE AREA IN SQUARE FEET

		WIDTH IN INCHES															
		12	16	20	24	28	32	36	40	44	48	52	56	60	64	68	72
H E I G H T  I N C H E S	12	0.35	0.48	0.61	0.75	0.88	1.01	1.14	1.27	1.40	1.53	1.66	1.79	1.93	2.06	2.19	2.32
	16	0.54	0.74	0.93	1.13	1.33	1.53	1.73	1.93	2.13	2.33	2.53	2.73	2.93	3.13	3.33	3.53
	20	0.72	0.99	1.25	1.52	1.79	2.06	2.33	2.59	2.86	3.13	3.40	3.66	3.93	4.20	4.47	4.73
	24	0.90	1.24	1.57	1.91	2.25	2.58	2.92	3.25	3.59	3.93	4.26	4.60	4.93	5.27	5.61	5.94
	28	1.09	1.49	1.89	2.30	2.70	3.11	3.51	3.92	4.32	4.72	5.13	5.53	5.94	6.34	6.75	7.15
	32	1.27	1.74	2.21	2.69	3.16	3.63	4.11	4.58	5.05	5.52	6.00	6.47	6.94	7.41	7.89	8.36
	36	1.45	1.99	2.54	3.08	3.62	4.16	4.70	5.24	5.78	6.32	6.86	7.40	7.94	8.48	9.02	9.57
	40	1.64	2.25	2.86	3.46	4.07	4.68	5.29	5.90	6.51	7.12	7.73	8.34	8.95	9.55	10.16	10.77
	44	1.82	2.50	3.18	3.85	4.53	5.21	5.88	6.56	7.24	7.92	8.59	9.27	9.95	10.63	11.30	11.98
	48	2.00	2.75	3.50	4.24	4.99	5.73	6.48	7.22	7.97	8.71	9.46	10.21	10.95	11.70	12.44	13.19
	52	2.19	3.00	3.82	4.63	5.44	6.26	7.07	7.88	8.70	9.51	10.33	11.14	11.95	12.77	13.58	14.40
	56	2.37	3.25	4.14	5.02	5.90	6.78	7.66	8.55	9.43	10.31	11.19	12.08	12.96	13.84	14.72	15.60
	60	2.55	3.50	4.46	5.41	6.36	7.31	8.26	9.21	10.16	11.11	12.06	13.01	13.96	14.91	15.86	16.81
	64	2.74	3.76	4.78	5.79	6.81	7.83	8.85	9.87	10.89	11.91	12.93	13.94	14.96	15.98	17.00	18.02
68	2.92	4.01	5.10	6.18	7.27	8.36	9.44	10.53	11.62	12.70	13.79	14.88	15.97	17.05	18.14	19.23	
72	3.10	4.26	5.42	6.57	7.73	8.88	10.04	11.19	12.35	13.50	14.66	15.81	16.97	18.12	19.28	20.43	

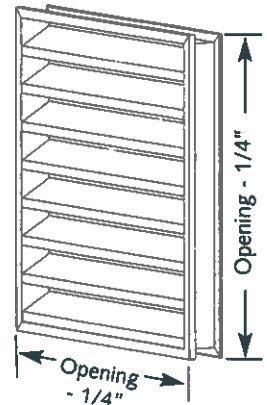

### RECOMMENDED SPECIFICATION 2210 and 2215

### PERCENTAGE OF FREE AREA

		WIDTH IN INCHES															
		12	16	20	24	28	32	36	40	44	48	52	56	60	64	68	72
H E I G H T  I N C H E S	12	35.2%	36.3	36.9	37.3	37.6	37.8	38.0	38.1	38.2	38.3	38.4	38.5	38.5	38.6	38.6	38.7
	16	40.2	41.4	42.1	42.5	42.9	43.1	43.3	43.5	43.6	43.7	43.8	43.9	43.9	44.0	44.0	44.1
	20	43.2	44.4	45.2	45.7	46.0	46.3	46.5	46.7	46.8	46.9	47.0	47.1	47.2	47.2	47.3	47.3
	24	45.1	46.5	47.2	47.8	48.1	48.4	48.6	48.8	49.0	49.1	49.2	49.3	49.3	49.4	49.5	49.5
	28	46.6	47.9	48.7	49.3	49.7	49.9	50.2	50.4	50.5	50.6	50.7	50.8	50.9	51.0	51.0	51.1
	32	47.6	49.0	49.8	50.4	50.8	51.1	51.3	51.5	51.6	51.8	51.9	52.0	52.1	52.1	52.2	52.2
	36	48.4	49.9	50.7	51.3	51.7	52.0	52.2	52.4	52.5	52.7	52.8	52.9	53.0	53.0	53.1	53.1
	40	49.1	50.5	51.4	52.0	52.4	52.7	52.9	53.1	53.3	53.4	53.5	53.6	53.7	53.7	53.8	53.9
	44	49.6	51.1	52.0	52.5	52.9	53.3	53.5	53.7	53.8	54.0	54.1	54.2	54.3	54.3	54.4	54.5
	48	50.1	51.6	52.4	53.0	53.4	53.7	54.0	54.2	54.3	54.5	54.6	54.7	54.8	54.8	54.9	55.0
	52	50.5	51.9	52.8	53.4	53.8	54.1	54.4	54.6	54.7	54.9	55.0	55.1	55.2	55.2	55.3	55.4
	56	50.8	52.3	53.2	53.8	54.2	54.5	54.7	54.9	55.1	55.2	55.3	55.4	55.5	55.6	55.7	55.7
	60	51.1	52.6	53.5	54.1	54.5	54.8	55.0	55.2	55.4	55.5	55.7	55.8	55.8	55.9	56.0	56.0
	64	51.3	52.8	53.7	54.3	54.7	55.1	55.3	55.5	55.7	55.8	55.9	56.0	56.1	56.2	56.3	56.3
68	51.6	53.1	54.0	54.6	55.0	55.3	55.6	55.8	55.9	56.0	56.2	56.3	56.3	56.4	56.5	56.5	
72	51.7	53.3	54.2	54.8	55.2	55.5	55.8	56.0	56.1	56.3	56.4	56.5	56.6	56.6	56.7	56.8	

Furnish and install stationary louver models 2210 / 2215 as manufactured by Ventex Inc, Bolton Ontario or Ventex of America, Kissimmee Florida. Louvers shall be 2 inches (50.8 mm) deep. Blades shall be 0.062 Inches (1.57 mm), frame shall be 0.062 (1.57 mm) extruded aluminum, alloy 6063-T5. Louvers shall have a 19 gauge galvanized 1/2 x 1/2 birdscreen. All materials shall be factory finished after assembly with Polyester Baking Enamel in a color selected from the Ventex Color Chart.



## 2220 AND 2225 STORMPROOF LOUVERS

The Ventex 2220/2225 louver is a two inch (50 mm) deep stormproof louver. Its design provides protection from water penetration. The 2220/2225 should be used when a four inch louver is impractical, such as when reduced louver height or depth is necessary.

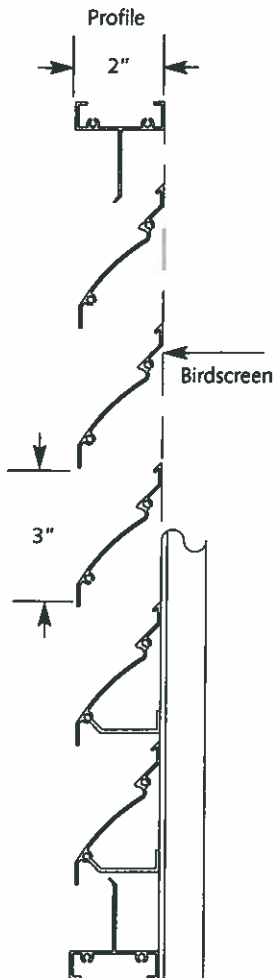

Channel Frame



Extended Sill



Flange Frame

### STANDARD CONSTRUCTION

Depth	2" (50 mm)
Material	Extruded 6063-T5 Aluminum
Frame Thickness	0.062" (1.57 mm)
Frame Styles	Model 2220 Channel Frame Model 2225 Flange Frame, 1 1/2" Flange Frame
Blade Thickness	0.062" (1.57 mm)
Blade Angle	45°
Blade Centres	3" (76 mm)
Standard Birdscreen	1/2" x 1/2", re-galvanized, 19 gauge
Minimum Height	6" (152 mm)
Maximum Panel Height	72" (1800 mm)
Maximum Panel Width	72" (1800 mm)
Available Finishes	Mill Finish, Polyester Baking Enamel, Clear or Colored Anodized Finish
Free Area (48" x 48" Unit)	7.22 sq. ft. (0.671 m <sup>2</sup> )

### ACCESSORIES

- 1/2" x 1/2" or 1/4" x 1/4" inter-crimped aluminum birdscreen
- Insect screen
- Continuous blade construction with hidden mullions to give an uninterrupted appearance
- Non-insulated blank-off panels
- 1" or 2" insulated blank-off panels
- All welded construction
- Hinged access doors
- Custom geometric shapes
- Security bars
- Extended sills
- Extended sleeves
- Filter racks



# 2220 AND 2225 STORMPROOF LOUVERS



## PERFORMANCE DATA

### FREE AREA IN SQUARE FEET

		WIDTH IN INCHES															
		12	16	20	24	28	32	36	40	44	48	52	56	60	64	68	72
HEIGHT IN INCHES	12	0.29	0.40	0.50	0.61	0.72	0.82	0.93	1.04	1.15	1.25	1.36	1.47	1.57	1.68	1.79	1.90
	16	0.43	0.59	0.75	0.91	1.07	1.23	1.39	1.55	1.71	1.87	2.03	2.20	2.36	2.52	2.68	2.84
	20	0.61	0.84	1.07	1.30	1.53	1.76	1.99	2.21	2.44	2.67	2.90	3.13	3.36	3.59	3.81	4.04
	24	0.75	1.03	1.31	1.58	1.86	2.14	2.42	2.70	2.98	3.25	3.53	3.81	4.09	4.37	4.65	4.93
	28	0.90	1.23	1.56	1.90	2.23	2.56	2.90	3.23	3.56	3.90	4.23	4.56	4.90	5.23	5.56	5.90
	32	1.05	1.45	1.84	2.23	2.63	3.02	3.41	3.80	4.20	4.59	4.98	5.37	5.77	6.16	6.55	6.94
	36	1.21	1.66	2.11	2.56	3.01	3.46	3.91	4.36	4.81	5.26	5.71	6.16	6.61	7.06	7.51	7.96
	40	1.35	1.86	2.36	2.87	3.37	3.88	4.38	4.88	5.39	5.89	6.40	6.90	7.40	7.91	8.41	8.92
	44	1.52	2.08	2.64	3.21	3.77	4.33	4.90	5.46	6.02	6.59	7.15	7.72	8.28	8.84	9.41	9.97
	48	1.66	2.28	2.90	3.51	4.13	4.75	5.37	5.98	6.60	7.22	7.84	8.45	9.07	9.69	10.31	10.93
	52	1.82	2.49	3.17	3.84	4.52	5.19	5.87	6.54	7.22	7.89	8.57	9.24	9.92	10.59	11.27	11.95
	56	1.98	2.71	3.45	4.18	4.92	5.66	6.39	7.13	7.86	8.60	9.34	10.07	10.81	11.54	12.28	13.01
	60	2.13	2.92	3.72	4.51	5.30	6.09	6.89	7.68	8.47	9.26	10.06	10.85	11.64	12.43	13.23	14.02
	64	2.28	3.12	3.97	4.81	5.66	6.51	7.35	8.20	9.05	9.89	10.74	11.59	12.43	13.28	14.13	14.97
	68	2.44	3.34	4.25	5.15	6.06	6.97	7.87	8.78	9.68	10.59	11.50	12.40	13.31	14.22	15.12	16.03
	72	2.59	3.55	4.52	5.48	6.44	7.41	8.37	9.33	10.30	11.26	12.22	13.19	14.15	15.11	16.08	17.04

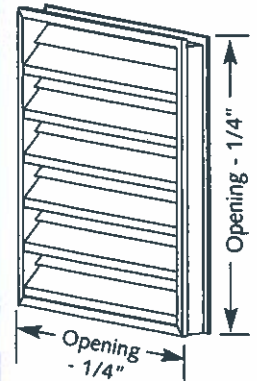

### RECOMMENDED SPECIFICATION 2220 and 2225

Furnish and install stationary louver models 2220 / 2225 as manufactured by Ventex Inc, Bolton Ontario or Ventex of America, Kissimmee Florida. Louvers shall be 2 inches (50.8 mm) deep. Blades shall be 0.062 Inches (1.57 mm), frame shall be 0.062 (1.57 mm) extruded aluminum, alloy 6063-T5. Louvers shall have a 19 gauge galvanized 1/2 x 1/2 birdscreen. All materials shall be factory finished after assembly with Polyester Baking Enamel in a color selected from the Ventex Color Chart.

### PERCENTAGE OF FREE AREA

		WIDTH IN INCHES															
		12	16	20	24	28	32	36	40	44	48	52	56	60	64	68	72
HEIGHT IN INCHES	12	28.8%	29.6	30.1	30.5	30.7	30.9	31.0	31.2	31.2	31.3	31.4	31.4	31.5	31.5	31.6	31.6
	16	32.3	33.3	33.8	34.2	34.5	34.7	34.8	35.0	35.1	35.1	35.2	35.3	35.3	35.4	35.4	35.5
	20	36.9	37.9	38.6	39.0	39.3	39.5	39.7	39.8	40.0	40.1	40.1	40.2	40.3	40.3	40.4	40.4
	24	37.4	38.5	39.2	39.6	39.9	40.1	40.3	40.5	40.6	40.7	40.8	40.8	40.9	41.0	41.0	41.0
	28	38.4	39.5	40.2	40.6	40.9	41.2	41.4	41.5	41.6	41.7	41.8	41.9	42.0	42.0	42.1	42.1
	32	39.6	40.7	41.4	41.9	42.2	42.4	42.6	42.8	42.9	43.0	43.1	43.2	43.2	43.3	43.4	43.4
	36	40.3	41.5	42.2	42.6	43.0	43.2	43.4	43.6	43.7	43.8	43.9	44.0	44.0	44.1	44.2	44.2
	40	40.6	41.8	42.5	43.0	43.3	43.6	43.8	44.0	44.1	44.2	44.3	44.4	44.4	44.5	44.5	44.6
	44	41.3	42.5	43.2	43.7	44.1	44.3	44.5	44.7	44.8	44.9	45.0	45.1	45.2	45.2	45.3	45.3
	48	41.5	42.7	43.4	43.9	44.3	44.5	44.7	44.9	45.0	45.1	45.2	45.3	45.4	45.4	45.5	45.5
	52	41.9	43.1	43.8	44.3	44.7	44.9	45.1	45.3	45.4	45.5	45.6	45.7	45.8	45.8	45.9	45.9
	56	42.4	43.6	44.3	44.8	45.2	45.5	45.7	45.8	46.0	46.1	46.2	46.2	46.3	46.4	46.4	46.5
	60	42.6	43.8	44.6	45.1	45.4	45.7	45.9	46.1	46.2	46.3	46.4	46.5	46.6	46.6	46.7	46.7
	64	42.7	43.9	44.6	45.1	45.5	45.8	46.0	46.1	46.3	46.4	46.5	46.6	46.6	46.7	46.7	46.8
	68	43.0	44.2	45.0	45.5	45.8	46.1	46.3	46.5	46.6	46.7	46.8	46.9	47.0	47.0	47.1	47.1
	72	43.2	44.4	45.2	45.7	46.0	46.3	46.5	46.7	46.8	46.9	47.0	47.1	47.2	47.2	47.3	47.3



## HI PRO 2410 AND 2415 EXHAUST LOUVERS

The Ventex 2410/2415 louver is a four inch (100 mm) deep extruded aluminum, stationary exhaust louver. The 2410 design provides an extremely high free area. The benefit of this is that the louver can exhaust a high volume of air with little static pressure. Model 2410's clean design, continuous line construction and available blank-off panels make it ideal for architectural applications.

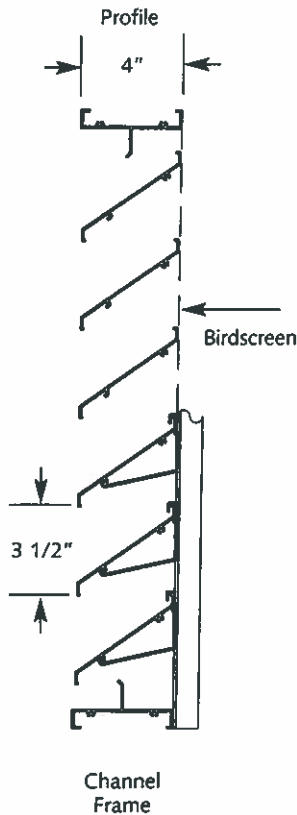

Flange Frame



Extended Sill

### STANDARD CONSTRUCTION

Depth	4" (100 mm)
Material	Extruded 6063-T5 Aluminum
Frame Thickness	0.081" (2.06 mm)
Frame Styles	Model 2410 Channel Frame Model 2415 Flange Frame, 1 1/2" Flange Frame
Blade Thickness	0.081" (2.06 mm)
Blade Angle	35°
Blade Centres	3 1/2" (89 mm)
Standard Birdscreen	1/2" x 1/2", re-galvanized, 19 gauge
Minimum Height	12" (300 mm)
Maximum Panel Height	120" (3048 mm)
Maximum Panel Width	120" (3048 mm)
Maximum Panel Size	60 sq. ft. (5.58 m <sup>2</sup> )
Available Finishes	Mill Finish, Polyester Baking Enamel, Clear or Colored Anodized Finish
Free Area (48" x 48" Unit)	9.39 sq. ft. (0.87 m <sup>2</sup> )

### ACCESSORIES

- 1/2" x 1/2" or 1/4" x 1/4" inter-crimped aluminum birdscreen
- Insect screen
- Continuous blade construction with hidden mullions to give an uninterrupted appearance
- Non-insulated blank-off panels
- 1" or 2" insulated blank-off panels
- All welded construction
- Hinged access doors
- Custom geometric shapes
- Security bars
- Extended sills
- Extended sleeves
- Filter racks

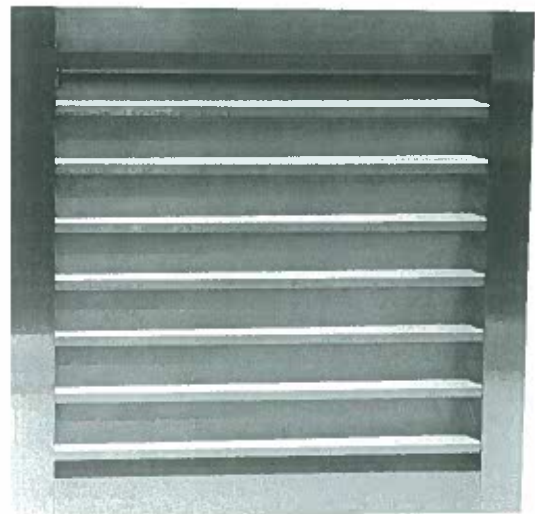

# HI PRO 2410 AND 2415 EXHAUST LOUVERS



## PERFORMANCE DATA

### FREE AREA IN SQUARE FEET

		WIDTH IN INCHES															
		12	16	20	24	28	32	36	40	44	48	52	56	60	64	68	72
H E I G H T  I N C H E S	12	0.31	0.43	0.56	0.68	0.80	0.92	1.04	1.16	1.29	1.41	1.53	1.65	1.77	1.89	2.02	2.14
	16	0.53	0.73	0.94	1.15	1.35	1.56	1.76	1.97	2.17	2.38	2.59	2.79	3.00	3.20	3.41	3.62
	20	0.72	0.99	1.27	1.55	1.83	2.11	2.39	2.67	2.95	3.23	3.51	3.78	4.06	4.34	4.62	4.90
	24	0.92	1.28	1.63	1.99	2.35	2.71	3.07	3.43	3.78	4.14	4.50	4.86	5.22	5.57	5.93	6.29
	28	1.12	1.56	2.00	2.43	2.87	3.31	3.75	4.18	4.62	5.06	5.49	5.93	6.37	6.81	7.24	7.68
	32	1.32	1.84	2.36	2.87	3.39	3.91	4.42	4.94	5.46	5.97	6.49	7.01	7.52	8.04	8.56	9.07
	36	1.53	2.13	2.73	3.32	3.92	4.52	5.12	5.71	6.31	6.91	7.51	8.10	8.70	9.30	9.90	10.49
	40	1.60	2.22	2.85	3.47	4.10	4.72	5.34	5.97	6.59	7.22	7.84	8.47	9.09	9.71	10.34	10.96
	44	1.87	2.59	3.32	4.05	4.78	5.51	6.23	6.96	7.69	8.42	9.15	9.87	10.60	11.33	12.06	12.79
	48	2.08	2.89	3.70	4.52	5.33	6.14	6.95	7.76	8.58	9.39	10.20	11.01	11.82	12.64	13.45	14.26
	52	2.27	3.15	4.03	4.92	5.80	6.68	7.57	8.45	9.34	10.22	11.10	11.99	12.87	13.76	14.64	15.52
	56	2.42	3.37	4.31	5.26	6.21	7.15	8.10	9.04	9.99	10.93	11.88	12.83	13.77	14.72	15.66	16.61
	60	2.64	3.66	4.69	5.72	6.75	7.78	8.81	9.83	10.86	11.89	12.92	13.95	14.98	16.00	17.03	18.06
	64	2.78	3.87	4.96	6.04	7.13	8.22	9.30	10.39	11.48	12.56	13.65	14.74	15.82	16.91	18.00	19.09
	68	2.98	4.14	5.30	6.46	7.62	8.78	9.94	11.11	12.27	13.43	14.59	15.75	16.91	18.07	19.24	20.40
	72	3.20	4.45	5.70	6.95	8.21	9.46	10.71	11.96	13.21	14.46	15.71	16.96	18.21	19.46	20.71	21.96
76	3.39	4.71	6.03	7.36	8.68	10.00	11.32	12.65	13.97	15.29	16.61	17.94	19.26	20.58	21.90	23.23	
80	3.59	5.00	6.40	7.80	9.21	10.61	12.01	13.41	14.82	16.22	17.62	19.02	20.43	21.83	23.23	24.63	
84	3.71	5.16	6.61	8.06	9.51	10.96	12.41	13.86	15.31	16.76	18.21	19.66	21.11	22.56	24.01	25.46	
88	3.82	5.31	6.81	8.30	9.79	11.28	12.77	14.27	15.76	17.25	18.74	20.23	21.73	23.22	24.71	26.20	
92	3.88	5.40	6.91	8.43	9.94	11.46	12.97	14.48	16.00	17.51	19.03	20.54	22.06	23.57	25.09	26.60	
96	4.37	6.08	7.79	9.50	11.20	12.91	14.62	16.33	18.03	19.74	21.45	23.15	24.86	26.57	28.28	29.98	

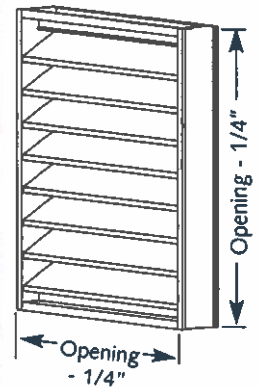

### RECOMMENDED SPECIFICATION 2410 and 2415

Furnish and install stationary louver models 2410 and 2415 as manufactured by Ventex Inc, Bolton Ontario or Ventex of America, Kissimmee Florida. Louvers shall be 4" (100 mm) deep. Blades shall be 0.081" (2.06 mm) and frame shall be 0.081" (2.06 mm) extruded aluminum, alloy 6063-T5. Louvers shall have a 19 gauge galvanized birdscreen.

All materials shall be factory finished after assembly with Polyester Baking Enamel in a color selected from the Ventex Color Chart.

### PERCENTAGE OF FREE AREA

		WIDTH IN INCHES															
		12	16	20	24	28	32	36	40	44	48	52	56	60	64	68	72
H E I G H T  I N C H E S	12	31.2%	32.5	33.3	33.8	34.2	34.5	34.7	34.9	35.1	35.2	35.3	35.4	35.4	35.5	35.6	35.6
	16	39.6	41.3	42.3	42.9	43.4	43.8	44.1	44.3	44.5	44.6	44.8	44.9	45.0	45.1	45.1	45.2
	20	42.9	44.7	45.8	46.6	47.1	47.5	47.8	48.0	48.2	48.4	48.5	48.7	48.8	48.9	48.9	49.0
	24	45.9	47.9	49.0	49.8	50.4	50.8	51.1	51.4	51.6	51.8	51.9	52.1	52.2	52.3	52.4	52.4
	28	48.0	50.1	51.3	52.1	52.7	53.2	53.5	53.8	54.0	54.2	54.3	54.5	54.6	54.7	54.8	54.9
	32	49.6	51.8	53.0	53.9	54.5	54.9	55.3	55.6	55.8	56.0	56.2	56.3	56.4	56.5	56.6	56.7
	36	51.0	53.2	54.5	55.4	56.0	56.5	56.8	57.1	57.4	57.6	57.7	57.9	58.0	58.1	58.2	58.3
	40	48.0	50.0	51.3	52.1	52.7	53.1	53.4	53.7	53.9	54.1	54.3	54.4	54.5	54.6	54.7	54.8
	44	50.9	53.1	54.4	55.2	55.8	56.3	56.7	57.0	57.2	57.4	57.6	57.7	57.8	57.9	58.0	58.1
	48	52.0	54.2	55.6	56.5	57.1	57.6	57.9	58.2	58.5	58.7	58.9	59.0	59.1	59.2	59.3	59.4
	52	52.3	54.5	55.8	56.7	57.4	57.8	58.2	58.5	58.8	59.0	59.1	59.3	59.4	59.5	59.6	59.7
	56	51.9	54.1	55.5	56.4	57.0	57.5	57.8	58.1	58.4	58.6	58.8	58.9	59.0	59.1	59.2	59.3
	60	52.7	55.0	56.3	57.2	57.8	58.3	58.7	59.0	59.2	59.5	59.6	59.8	59.9	60.0	60.1	60.2
	64	52.2	54.4	55.8	56.7	57.3	57.8	58.2	58.5	58.7	58.9	59.1	59.2	59.3	59.5	59.6	59.6
	68	52.5	54.8	56.1	57.0	57.6	58.1	58.5	58.8	59.0	59.2	59.4	59.6	59.7	59.8	59.9	60.0
	72	53.4	55.7	57.0	58.0	58.6	59.1	59.5	59.8	60.0	60.2	60.4	60.6	60.7	60.8	60.9	61.0
76	53.5	55.8	57.2	58.1	58.7	59.2	59.6	59.9	60.2	60.4	60.5	60.7	60.8	60.9	61.0	61.1	
80	53.9	56.2	57.6	58.5	59.2	59.7	60.1	60.4	60.6	60.8	61.0	61.1	61.3	61.4	61.5	61.6	
84	53.1	55.3	56.7	57.6	58.2	58.7	59.1	59.4	59.7	59.9	60.0	60.2	60.3	60.4	60.5	60.6	
88	52.1	54.4	55.7	56.6	57.2	57.7	58.1	58.4	58.6	58.8	59.0	59.1	59.3	59.4	59.5	59.5	
92	50.6	52.8	54.1	55.0	55.6	56.0	56.4	56.7	56.9	57.1	57.3	57.4	57.5	57.7	57.7	57.8	
96	54.7	57.0	58.4	59.4	60.0	60.5	60.9	61.2	61.5	61.7	61.9	62.0	62.2	62.3	62.4	62.5	



## HI PRO 2420 AND 2425 STORMPROOF LOUVERS

The Ventex 2420/2425 louver incorporates a newly engineered stormproof blade, designed to maximize the free area of the louver. The new design increases the free area of the four inch louver by nearly 30%. The 2420 is the most versatile louver Ventex manufactures. It is available in a large variety of custom geometric shapes. With its long list of accessories, the 2420 can be custom made to fit almost any application.

### STANDARD CONSTRUCTION

Depth	4" (100 mm)
Material	Extruded 6063-T5 Aluminum
Frame Thickness	0.081" (2.06 mm)
Frame Styles	Model 2420 Channel Frame Model 2425 Flange Frame, 1 1/2" Flange Frame
Blade Thickness	0.081" (2.06 mm)
Blade Angle	45°
Blade Centres	4 7/8" (124 mm)
Standard Birdscreen	1/2" x 1/2", re-galvanized, 19 gauge
Minimum Height	12" (300 mm)
Maximum Panel Height	120" (3048 mm)
Maximum Panel Width	120" (3048 mm)
Maximum Panel Size	60 sq. ft. (5.58 m <sup>2</sup> )
Available Finishes	Mill Finish, Polyester Baking Enamel, Clear or Colored Anodized Finish
Free Area (48" x 48" Unit)	8.49 sq. ft. (0.764 m <sup>2</sup> )

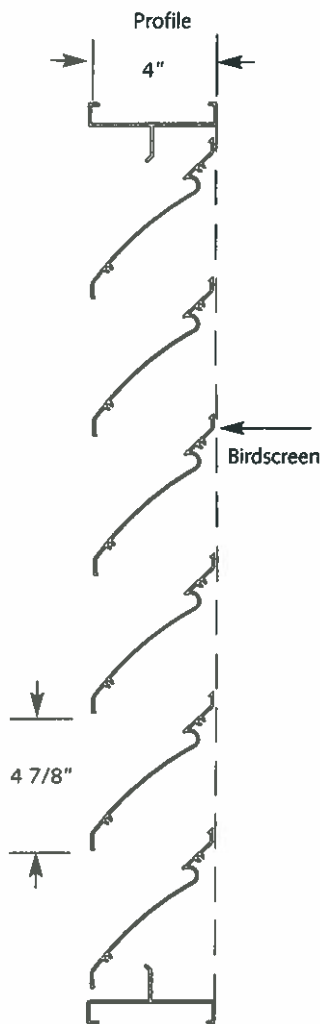

Channel  
Frame



Extended Sill



Flange Frame

### ACCESSORIES

- 1/2" x 1/2" or 1/4" x 1/4" inter-crimped aluminum birdscreen
- Insect screen
- Continuous blade construction with hidden mullions to give an uninterrupted appearance
- Non-insulated blank-off panels
- 1" or 2" insulated blank-off panels
- All welded construction
- Hinged access doors
- Custom geometric shapes
- Security bars
- Extended sills
- Extended sleeves
- Filter racks
- Monumental Construction Heavy Gauge Blades and Frame

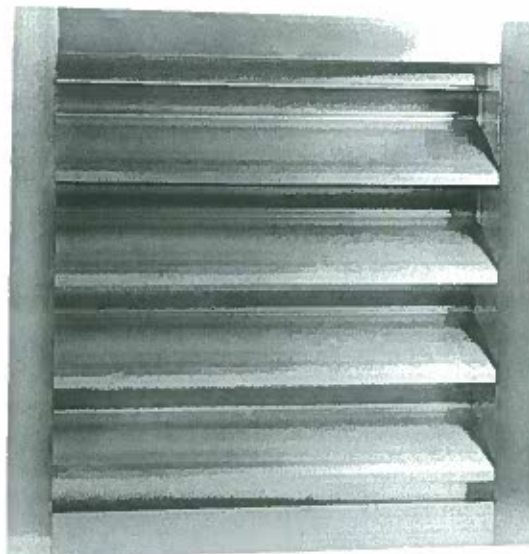

# HI PRO 2420 AND 2425 STORMPROOF LOUVERS



## PERFORMANCE DATA

HEIGHT IN INCHES	WIDTH IN INCHES															
	12	16	20	24	28	32	36	40	44	48	52	56	60	64	68	72
12	0.24	0.33	0.43	0.52	0.61	0.70	0.79	0.89	0.98	1.07	1.16	1.26	1.35	1.44	1.53	1.62
16	0.41	0.56	0.72	0.87	1.03	1.18	1.34	1.50	1.65	1.81	1.96	2.12	2.27	2.43	2.58	2.74
20	0.58	0.79	1.01	1.23	1.45	1.67	1.89	2.11	2.33	2.55	2.77	2.99	3.21	3.42	3.64	3.86
24	0.81	1.12	1.42	1.73	2.04	2.35	2.66	2.97	3.27	3.58	3.89	4.20	4.51	4.81	5.12	5.43
28	0.95	1.31	1.67	2.04	2.40	2.76	3.12	3.48	3.85	4.21	4.57	4.93	5.29	5.66	6.02	6.38
32	1.09	1.51	1.92	2.34	2.75	3.17	3.59	4.00	4.42	4.83	5.25	5.66	6.08	6.50	6.91	7.33
36	1.26	1.74	2.22	2.70	3.18	3.66	4.14	4.62	5.10	5.58	6.06	6.54	7.02	7.50	7.98	8.46
40	1.34	1.85	2.36	2.87	3.38	3.88	4.39	4.90	5.41	5.92	6.43	6.94	7.45	7.96	8.47	8.98
44	1.67	2.30	2.94	3.57	4.20	4.84	5.47	6.11	6.74	7.38	8.01	8.65	9.28	9.92	10.55	11.19
48	1.92	2.65	3.38	4.11	4.84	5.57	6.30	7.03	7.76	8.49	9.25	9.95	10.68	11.41	12.14	12.87
52	1.97	2.72	3.47	4.22	4.97	5.73	6.48	7.23	7.98	8.73	9.48	10.23	10.98	11.73	12.48	13.23
56	2.13	2.95	3.76	4.57	5.39	6.20	7.01	7.83	8.64	9.45	10.26	11.08	11.89	12.70	13.52	14.33
60	2.36	3.26	4.16	5.06	5.96	6.86	7.76	8.66	9.56	10.46	11.36	12.26	13.16	14.06	14.96	15.86
64	2.60	3.60	4.59	5.58	6.57	7.56	8.56	9.55	10.54	11.53	12.53	13.52	14.51	15.50	16.49	17.49
68	2.66	3.68	4.69	5.70	6.72	7.73	8.74	9.76	10.77	11.79	12.80	13.81	14.83	15.84	16.86	17.87
72	2.81	3.87	4.94	6.01	7.08	8.15	9.22	10.29	11.35	12.42	13.49	14.56	15.63	16.70	17.77	18.83
76	3.01	4.16	5.31	6.46	7.61	8.76	9.90	11.05	12.20	13.35	14.50	15.64	16.79	17.94	19.09	20.24
80	3.22	4.44	5.66	6.89	8.11	9.34	10.56	11.79	13.01	14.24	15.46	16.69	17.91	19.14	20.36	21.59
84	3.35	4.63	5.91	7.19	8.47	9.74	11.02	12.30	13.58	14.86	16.14	17.41	18.69	19.97	21.25	22.53
88	3.52	4.86	6.21	7.55	8.89	10.23	11.57	12.92	14.26	15.60	16.94	18.28	19.63	20.97	22.31	23.65
92	3.66	5.06	6.46	7.85	9.25	10.64	12.04	13.43	14.83	16.22	17.62	19.02	20.41	21.81	23.20	24.60
96	3.84	5.31	6.77	8.23	9.70	11.16	12.62	14.09	15.55	17.02	18.48	19.94	21.41	22.87	24.33	25.80
100	4.07	5.62	7.18	8.73	10.28	11.83	13.38	14.93	16.49	18.04	19.59	21.14	22.69	24.24	25.80	27.35
104	4.12	5.69	7.26	8.83	10.40	11.97	13.54	15.11	16.68	18.25	19.82	21.39	22.96	24.52	26.09	27.66
108	4.25	5.87	7.49	9.12	10.74	12.36	13.98	15.60	17.22	18.84	20.46	22.08	23.70	25.32	26.94	28.56
112	4.38	6.05	7.72	9.39	11.05	12.72	14.39	16.06	17.73	19.40	21.07	22.73	24.40	26.07	27.74	29.41
116	4.54	6.27	8.00	9.73	11.45	13.18	14.91	16.64	18.37	20.10	21.83	23.56	25.29	27.01	28.74	30.47
120	4.71	6.50	8.29	10.09	11.88	13.68	15.47	17.26	19.06	20.85	22.64	24.44	26.23	28.02	29.82	31.61

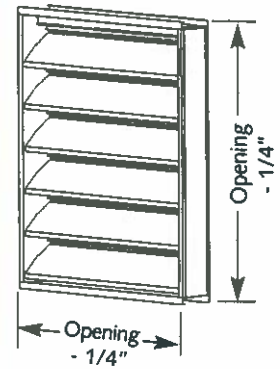

### RECOMMENDED SPECIFICATION 2420 and 2425

Furnish and install stationary louver models 2420/2425 as manufactured by Ventex Inc, Bolton Ontario or Ventex of America, Kissimmee Florida. Louvers must be licensed to bear the AMCA seal. Louvers shall be 4" (102 mm) deep. Blades shall be 0.085" (2.16 mm) and frame shall be 0.085" (2.16 mm) extruded aluminum, alloy 6063-T5. Louvers shall have a 19 gauge galvanized birdscreen.

All materials shall be factory finished after assembly with Polyester Baking Enamel in a color selected from the Ventex Color Chart. The louver manufacturer shall submit test data on a 48" x 48" unit showing that the louver conforms to the data on this page.

## CERTIFIED RATINGS

Ventex certifies that the 2420/2425 louver shown here is licensed to bear the AMCA seal. The ratings shown are based on tests and procedures performed in accordance with AMCA Publication 511 and comply with the requirements of the AMCA Certified Ratings Program. The Certified Ratings Seal applies to air performance and water penetration ratings.



### 2420 - 2425 Stormproof Water Penetration

15 Minute Duration, Test Size (48" x 48")

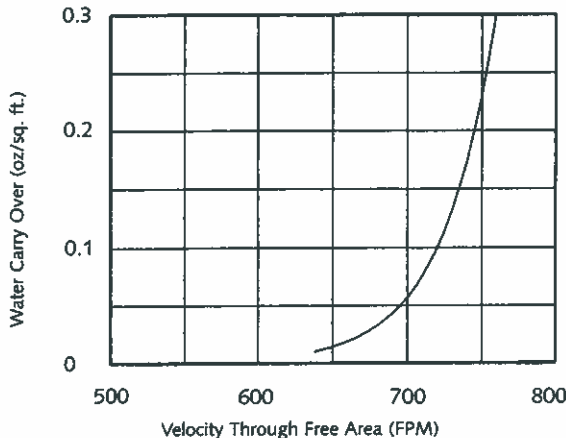

Beginning point of water penetration at 0.01 oz/sq. ft. is 638 FPM

### Pressure Drop - Intake

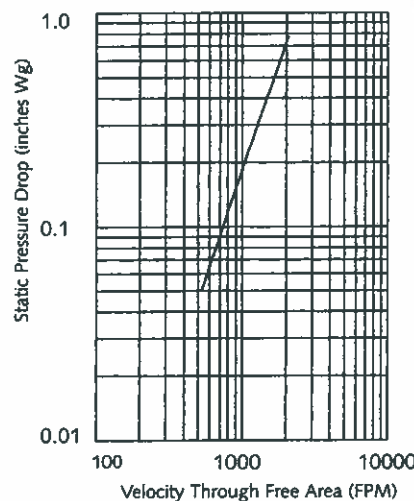

Test results do not include the effects of birdscreen.

HIGH FREE AREA



## HI PRO 2430 AND 2435 DRAINABLE LOUVERS

The Ventex 2430/2435 louver is the newly designed extruded aluminum, stationary, four inch (100 mm) deep drainable louver. The 2430 free area is one of the highest available for a four inch deep louver. The specially designed head and large drainage spouts in the jamb are highly effective at collecting water and dispersing it away from the face of the louver, thus eliminating potential water penetration. The 2430 is best suited for intake applications in which the louver size is very restricted or applications which handle a large volume of air.

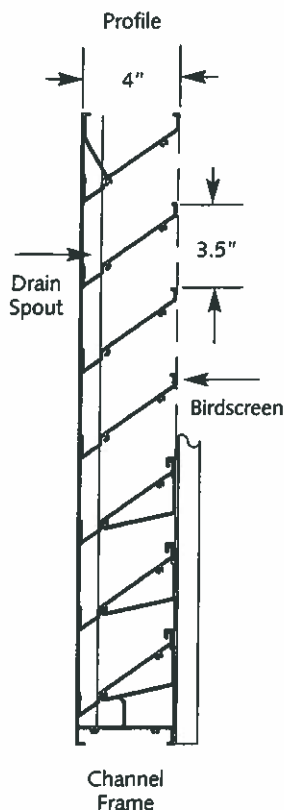

### STANDARD CONSTRUCTION

Depth	4" (100 mm)
Material	Extruded 6063-T5 Aluminum
Frame Thickness	0.081" (2.06 mm)
Frame Styles	Model 2430 Channel Frame Model 2435 Flange Frame, 1 1/2" Flange Frame
Blade Thickness	0.081" (2.06 mm)
Blade Angle	35°
Blade Centres	3 1/2" (89 mm)
Standard Birdscreen	1/2" x 1/2", re-galvanized, 19 gauge
Minimum Height	12" (300 mm)
Maximum Panel Height	120" (3048 mm)
Maximum Panel Width	120" (3048 mm)
Maximum Panel Size	60 sq. ft. (5.58 m <sup>2</sup> )
Available Finishes	Mill Finish, Polyester Baking Enamel, Clear or Colored Anodized Finish
Free Area (48" x 48" Unit)	9.06 sq. ft. (0.815 m <sup>2</sup> )



Extended Sill



Flange Frame

### ACCESSORIES

- 1/2" x 1/2" or 1/4" x 1/4" inter-crimped aluminum birdscreen
- Some geometric shapes available; consult your Ventex representative
- Insect screen
- Non-insulated blank-off panels
- 1" or 2" insulated blank-off panels
- All welded construction
- Hinged access doors
- Security bars
- Extended sills
- Extended sleeves
- Filter racks



See note on page 4 when sizing drainable louvers.



# HI PRO 2430 AND 2435 DRAINABLE LOUVERS



## PERFORMANCE DATA

HEIGHT IN INCHES	WIDTH IN INCHES															
	12	16	20	24	28	32	36	40	44	48	52	56	60	64	68	72
12	0.32	0.45	0.58	0.72	0.85	0.98	1.11	1.24	1.38	1.51	1.64	1.77	1.90	2.03	2.17	2.30
16	0.51	0.72	0.93	1.14	1.35	1.55	1.76	1.97	2.18	2.39	2.60	2.81	3.02	3.23	3.44	3.64
20	0.70	0.98	1.27	1.56	1.84	2.13	2.42	2.70	2.99	3.28	3.56	3.85	4.14	4.42	4.71	4.99
24	0.89	1.25	1.61	1.98	2.34	2.70	3.07	3.43	3.80	4.16	4.52	4.89	5.25	5.61	5.98	6.34
28	1.07	1.52	1.96	2.40	2.84	3.28	3.72	4.16	4.60	5.04	5.48	5.92	6.37	6.81	7.25	7.69
32	1.22	1.72	2.22	2.72	3.21	3.71	4.21	4.71	5.21	5.71	6.21	6.71	7.21	7.71	8.21	8.71
36	1.41	1.98	2.56	3.14	3.71	4.29	4.87	5.44	6.02	6.60	7.17	7.75	8.33	8.90	9.48	10.06
40	1.59	2.25	2.90	3.56	4.21	4.86	5.52	6.17	6.83	7.48	8.13	8.79	9.44	10.09	10.75	11.40
44	1.78	2.51	3.24	3.98	4.71	5.44	6.17	6.90	7.63	8.36	9.09	9.83	10.56	11.29	12.02	12.75
48	1.97	2.72	3.52	4.31	5.10	5.89	6.69	7.48	8.27	9.06	9.86	10.65	11.44	12.23	13.03	13.82
52	2.12	3.00	3.87	4.74	5.61	6.48	7.35	8.23	9.10	9.97	10.84	11.71	12.58	13.46	14.33	15.20
56	2.34	3.31	4.27	5.23	6.19	7.15	8.11	9.07	10.04	11.00	11.96	12.92	13.88	14.84	15.81	16.77
60	2.49	3.51	4.53	5.55	6.58	7.60	8.62	9.64	10.66	11.68	12.71	13.73	14.75	15.77	16.79	17.81
64	2.68	3.78	4.88	5.97	7.07	8.17	9.27	10.37	11.47	12.57	13.67	14.76	15.86	16.96	18.06	19.16
68	2.87	4.04	5.22	6.40	7.57	8.75	9.92	11.10	12.28	13.45	14.63	15.80	16.98	18.16	19.33	20.51
72	3.06	4.31	5.56	6.82	8.07	9.32	10.58	11.83	13.08	14.34	15.59	16.84	18.10	19.35	20.60	21.86
76	3.24	4.57	5.91	7.24	8.57	9.90	11.23	12.56	13.89	15.22	16.55	17.88	19.21	20.54	21.87	23.20
80	3.43	4.84	6.25	7.66	9.07	10.48	11.88	13.29	14.70	16.11	17.52	18.93	20.34	21.74	23.15	24.56
84	3.57	5.04	6.51	7.97	9.44	10.91	12.37	13.84	15.31	16.77	18.24	19.71	21.17	22.64	24.11	25.57
88	3.76	5.31	6.85	8.39	9.94	11.48	13.03	14.57	16.11	17.66	19.20	20.74	22.29	23.83	25.38	26.92
92	3.95	5.57	7.19	8.81	10.44	12.06	13.68	15.30	16.92	18.54	20.16	21.78	23.40	25.03	26.65	28.27
96	4.14	5.84	7.54	9.23	10.93	12.63	14.33	16.03	17.73	19.42	21.12	22.82	24.52	26.22	27.92	29.61
100	4.33	6.10	7.88	9.66	11.43	13.21	14.98	16.76	18.53	20.31	22.09	23.86	25.64	27.41	29.19	30.96
104	4.52	6.37	8.22	10.08	11.93	13.78	15.64	17.49	19.34	21.20	23.05	24.90	26.76	28.61	30.46	32.32
108	4.71	6.64	8.57	10.50	12.43	14.36	16.29	18.22	20.15	22.08	24.01	25.94	27.87	29.80	31.73	33.66
112	5.08	7.17	9.25	11.34	13.42	15.51	17.59	19.68	21.76	23.85	25.93	28.02	30.10	32.19	34.27	36.35
116	5.04	7.10	9.17	11.23	13.30	15.37	17.43	19.50	21.56	23.63	25.70	27.76	29.83	31.89	33.96	36.03
120	5.17	7.29	9.41	11.53	13.65	15.77	17.89	20.01	22.13	24.25	26.37	28.49	30.61	32.73	34.85	36.97

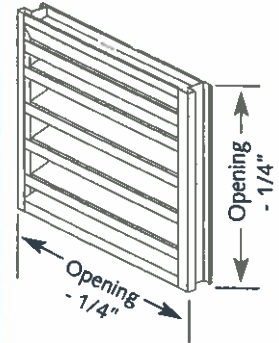

### RECOMMENDED SPECIFICATION 2430 and 2435

Furnish and install stationary louver models 2430/2435 as manufactured by Ventex Inc, Bolton Ontario or Ventex of America, Kissimmee Florida. Louvers must be licensed to bear the AMCA seal. Louvers shall be 4" (100 mm) deep. Blades shall be 0.081" (2.06 mm) and frame shall be 0.081" (2.06 mm) extruded aluminum, alloy 6063-T5. Louvers shall have a 19 gauge galvanized birdscreen.



### CERTIFIED RATINGS

Ventex certifies that the 2430/2435 louver shown here is licensed to bear the AMCA seal. The ratings shown are based on tests and procedures performed in accordance with AMCA Publication 511 and comply with the requirements of the AMCA Certified Ratings Program. The Certified Ratings Seal applies to air performance and water penetration ratings.

**2430 - 2435 Drainable Water Penetration**  
15 Minute Duration, Test Size (48" x 48")

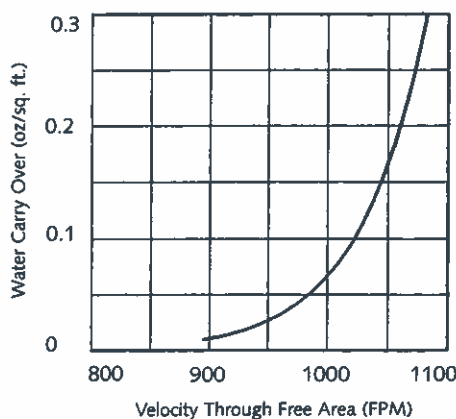

Beginning point of water penetration at 0.01 oz./sq. ft. is 896 FPM

**Pressure Drop - Intake**

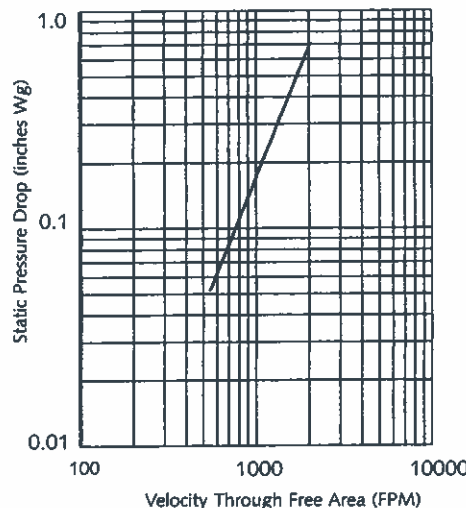

All materials shall be factory finished after assembly with Polyester Baking Enamel in a color selected from the Ventex Color Chart. The louver manufacturer shall submit test data on a 48" x 48" unit showing that the louver conforms to the data on this page.

Test results do not include the effects of birdscreen.

**HIGHEST FREE AREA**



## 2440 AND 2445 TRANSFORMER VAULT LOUVERS

The Ventex 2440/2445 is a four inch (100 mm) transformer vault louver. The chevron blade design provides the security necessary for a high-risk application. The principle application of the louver is to prevent damage to the equipment by hindering vandals from inserting objects into the transformer vault. The 2440 can also be used when a sight proof louver is required.

### STANDARD CONSTRUCTION

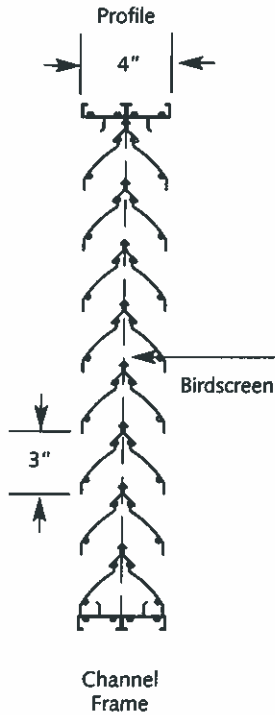

Depth	4" (100 mm)
Material	Extruded 6063-T5 Aluminum
Frame Thickness	0.062" (1.57 mm)
Frame Styles	Model 2440 Channel Frame Model 2445 Flange Frame, 1 1/2" Flange Frame
Blade Thickness	0.062" (1.57 mm)
Blade Angle	45°
Blade Centres	3" (76 mm)
Standard Birdscreen	1/2" x 1/2", re-galvanized, 19 gauge
Minimum Height	12" (300 mm)
Maximum Panel Height	96" (2438 mm)
Maximum Panel Width	72" (1800 mm)
Available Finishes	Mill Finish, Polyester Baking Enamel, Clear or Colored Anodized Finish
Free Area (48" x 48" Unit)	7.37 sq. ft. (0.685 m <sup>2</sup> )



Extended Sill



Flange Frame

### ACCESSORIES

- 1/2" x 1/2" or 1/4" x 1/4" inter-crimped aluminum birdscreen
- Insect screen
- Non-insulated blank-off panels
- 1" or 2" insulated blank-off panels
- All welded construction
- Security bars
- Extended sills
- Extended sleeves

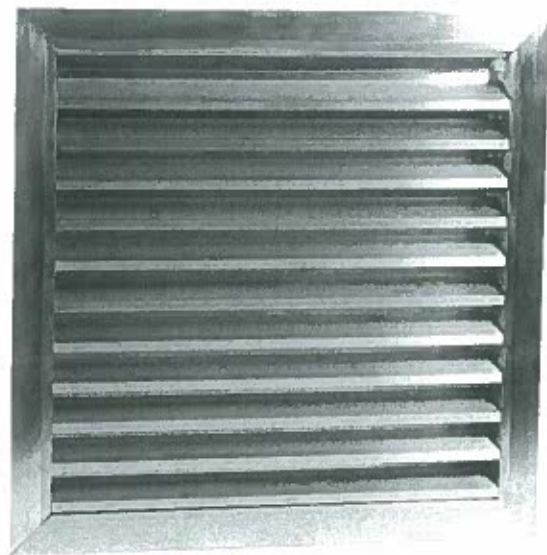



## PERFORMANCE DATA

### FREE AREA IN SQUARE FEET

		WIDTH IN INCHES															
		12	16	20	24	28	32	36	40	44	48	52	56	60	64	68	72
HEIGHT IN INCHES	12	0.31	0.42	0.54	0.65	0.76	0.88	0.99	1.11	1.22	1.34	1.45	1.56	1.68	1.79	1.91	2.02
	16	0.44	0.61	0.78	0.94	1.11	1.27	1.44	1.60	1.77	1.93	2.10	2.27	2.43	2.60	2.76	2.93
	20	0.62	0.86	1.09	1.32	1.55	1.78	2.02	2.25	2.48	2.71	2.95	3.18	3.41	3.64	3.87	4.11
	24	0.73	1.00	1.27	1.54	1.81	2.08	2.35	2.62	2.89	3.16	3.43	3.71	3.98	4.25	4.52	4.79
	28	0.91	1.25	1.59	1.93	2.27	2.61	2.94	3.28	3.62	3.96	4.30	4.64	4.98	5.32	5.66	5.99
	32	1.16	1.59	2.02	2.45	2.88	3.32	3.75	4.18	4.61	5.04	5.47	5.90	6.33	6.77	7.20	7.63
	36	1.18	1.63	2.07	2.51	2.95	3.39	3.83	4.27	4.71	5.15	5.59	6.03	6.47	6.92	7.36	7.80
	40	1.33	1.83	2.33	2.82	3.32	3.81	4.31	4.81	5.30	5.80	6.29	6.79	7.29	7.78	8.28	8.77
	44	1.67	2.30	2.92	3.54	4.16	4.79	5.41	6.03	6.65	7.28	7.90	8.52	9.14	9.77	10.39	11.01
	48	1.70	2.33	2.96	3.59	4.22	4.85	5.48	6.11	6.74	7.37	8.00	8.63	9.26	9.90	10.53	11.16
	52	1.81	2.49	3.16	3.84	4.51	5.19	5.86	6.54	7.21	7.89	8.56	9.24	9.91	10.59	11.26	11.94
	56	1.99	2.73	3.47	4.21	4.95	5.69	6.43	7.17	7.92	8.66	9.40	10.14	10.88	11.62	12.36	13.10
	60	2.07	2.85	3.62	4.39	5.16	5.93	6.71	7.48	8.25	9.02	9.79	10.57	11.34	12.11	12.88	13.65
	64	2.22	3.05	3.88	4.70	5.53	6.36	7.18	8.01	8.84	9.67	10.49	11.32	12.15	12.97	13.80	14.63
	68	2.36	3.24	4.11	4.99	5.87	6.75	7.62	8.50	9.38	10.26	11.13	12.01	12.89	13.77	14.64	15.52
	72	2.94	4.03	5.13	6.22	7.31	8.41	9.50	10.59	11.69	12.78	13.87	14.97	16.06	17.15	18.25	19.34

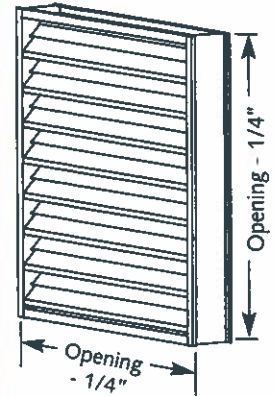

### RECOMMENDED SPECIFICATION 2440 and 2445

Furnish and install stationary louver models 2440/2445 as manufactured by Ventex Inc, Bolton Ontario or Ventex of America, Kissimmee Florida. Louvers shall be 4" (100 mm) deep. Blades shall be 0.062" (2.16 mm) and frame shall be 0.062" (1.57 mm) extruded aluminum, alloy 6063-T5. Louvers shall have a 19 gauge galvanized bird-screen.

All materials shall be factory finished after assembly with Polyester Baking Enamel in a color selected from the Ventex Color Chart.

### PERCENTAGE OF FREE AREA

		WIDTH IN INCHES															
		12	16	20	24	28	32	36	40	44	48	52	56	60	64	68	72
HEIGHT IN INCHES	12	30.7%	31.6	32.1	32.5	32.7	32.9	33.1	33.2	33.3	33.4	33.5	33.5	33.6	33.6	33.6	33.7
	16	33.4	34.3	34.9	35.3	35.6	35.8	36.0	36.1	36.2	36.3	36.4	36.4	36.5	36.5	36.6	36.6
	20	37.4	38.5	39.2	39.6	39.9	40.2	40.3	40.5	40.6	40.7	40.8	40.9	40.9	41.0	41.0	41.1
	24	36.4	37.4	38.1	38.5	38.8	39.0	39.2	39.3	39.5	39.6	39.6	39.7	39.8	39.8	39.9	39.9
	28	39.0	40.2	40.9	41.3	41.6	41.9	42.1	42.2	42.3	42.4	42.5	42.6	42.7	42.7	42.8	42.8
	32	43.5	44.7	45.5	46.0	46.3	46.6	46.8	47.0	47.1	47.3	47.3	47.4	47.5	47.6	47.6	47.7
	36	39.5	40.6	41.3	41.8	42.1	42.4	42.6	42.7	42.8	42.9	43.0	43.1	43.2	43.2	43.3	43.3
	40	40.0	41.2	41.9	42.3	42.6	42.9	43.1	43.2	43.4	43.5	43.6	43.6	43.7	43.8	43.8	43.9
	44	45.6	47.0	47.7	48.3	48.7	48.9	49.2	49.3	49.5	49.6	49.7	49.8	49.9	49.9	50.0	50.0
	48	42.4	43.6	44.4	44.8	45.2	45.5	45.7	45.8	46.0	46.1	46.2	46.3	46.3	46.4	46.4	46.5
	52	41.9	43.1	43.8	44.3	44.6	44.9	45.1	45.3	45.4	45.5	45.6	45.7	45.7	45.8	45.9	45.9
	56	42.7	43.9	44.6	45.1	45.5	45.8	46.0	46.1	46.3	46.4	46.5	46.5	46.6	46.7	46.7	46.8
	60	41.5	42.7	43.4	43.9	44.2	44.5	44.7	44.9	45.0	45.1	45.2	45.3	45.4	45.4	45.5	45.5
	64	41.7	42.9	43.6	44.1	44.4	44.7	44.9	45.1	45.2	45.3	45.4	45.5	45.6	45.6	45.7	45.7
	68	41.6	42.8	43.6	44.0	44.4	44.6	44.8	45.0	45.1	45.2	45.3	45.4	45.5	45.5	45.6	45.7
	72	49.0	50.4	51.3	51.8	52.2	52.5	52.8	53.0	53.1	53.2	53.4	53.4	53.5	53.6	53.7	53.7



## HI PRO 2450 AND 2455 HIGH PERFORMANCE LOUVERS

The Ventex 2450/2455 louver is the newly designed extruded aluminum, stationary, four inch (100 mm) deep high performance louver. The 2450 is a hybrid louver, combining the protection of a drainable louver system with the clean lines of an architectural style louver. This combination gives the 2450 superior performance over architectural type louvers.

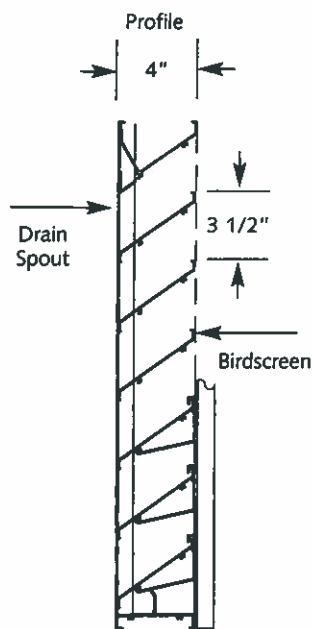

Channel Frame



Extended Sill



Flange Frame

### STANDARD CONSTRUCTION

Depth	4" (100 mm)
Material	Extruded 6063-T5 Aluminum
Frame Thickness	0.081" (2.06 mm)
Frame Styles	Model 2450 Channel Frame Model 2455 Flange Frame, 1 1/2" Flange Frame
Blade Thickness	0.081" (2.06 mm)
Blade Angle	35°
Blade Centres	3 1/2" (76.2 mm)
Standard Birdscreen	1/2" x 1/2", re-galvanized, 19 gauge
Minimum Height	12" (300 mm)
Maximum Panel Height	120" (3048 mm)
Maximum Panel Width	120" (3048 mm)
Maximum Panel Size	60 sq. ft. (5.58m)
Available Finishes	Mill Finish or Polyester Baking Enamel, Clear or Colored Anodized Finish
Free Area (48" x 48" Unit)	9.26 sq. ft. (0.833 m <sup>2</sup> )

### ACCESSORIES

- 1/2" x 1/2" or 1/4" x 1/4" inter-crimped aluminum birdscreen
- Some geometric shapes available; consult your Ventex representative
- Non-insulated blank-off panels
- 1" or 2" insulated blank-off panels
- All welded construction
- Hinged access doors
- Security bars
- Extended sills
- Extended sleeves
- Filter racks



# HI PRO 2450 AND 2455 HIGH PERFORMANCE LOUVERS



## PERFORMANCE DATA

### FREE AREA IN SQUARE FEET

HEIGHT IN INCHES	WIDTH IN INCHES															
	12	16	20	24	28	32	36	40	44	48	52	56	60	64	68	72
12	0.32	0.46	0.60	0.73	0.87	1.01	1.15	1.28	1.42	1.56	1.69	1.83	1.97	2.10	2.24	2.38
16	0.51	0.73	0.94	1.16	1.38	1.59	1.81	2.02	2.24	2.46	2.67	2.89	3.10	3.32	3.54	3.75
20	0.70	0.99	1.29	1.58	1.88	2.17	2.47	2.76	3.06	3.35	3.65	3.94	4.24	4.53	4.83	5.12
24	0.82	1.17	1.52	1.86	2.21	2.56	2.91	3.25	3.60	3.95	4.29	4.64	4.99	5.34	5.68	6.03
28	1.01	1.44	1.87	2.29	2.72	3.15	3.58	4.00	4.43	4.86	5.29	5.71	6.14	6.57	7.00	7.42
32	1.19	1.69	2.19	2.69	3.19	3.69	4.20	4.70	5.20	5.70	6.20	6.70	7.20	7.70	8.21	8.71
36	1.38	1.96	2.54	3.12	3.70	4.28	4.86	5.45	6.03	6.61	7.19	7.77	8.35	8.93	9.51	10.09
40	1.57	2.23	2.89	3.55	4.21	4.87	5.53	6.19	6.85	7.52	8.18	8.84	9.50	10.16	10.82	11.48
44	1.75	2.49	3.22	3.96	4.70	5.44	6.18	6.91	7.65	8.39	9.13	9.87	10.60	11.34	12.08	12.82
48	1.93	2.74	3.56	4.37	5.19	6.00	6.82	7.63	8.45	9.26	10.07	10.89	11.70	12.52	13.33	14.15
52	2.01	2.86	3.71	4.56	5.40	6.25	7.10	7.95	8.80	9.65	10.49	11.34	12.19	13.04	13.89	14.74
56	2.24	3.19	4.14	5.09	6.03	6.98	7.93	8.88	9.82	10.77	11.72	12.66	13.61	14.56	15.51	16.45
60	2.43	3.45	4.47	5.50	6.52	7.54	8.57	9.59	10.61	11.64	12.66	13.68	14.71	15.73	16.75	17.78
64	2.61	3.71	4.82	5.92	7.02	8.12	9.23	10.33	11.43	12.53	13.63	14.74	15.84	16.94	18.04	19.15
68	2.80	3.98	5.16	6.34	7.52	8.70	9.89	11.07	12.25	13.43	14.61	15.79	16.97	18.15	19.34	20.52
72	2.99	4.25	5.51	6.77	8.03	9.29	10.55	11.81	13.07	14.33	15.59	16.85	18.11	19.37	20.63	21.89
76	3.17	4.51	5.85	7.19	8.53	9.87	11.21	12.55	13.89	15.23	16.57	17.91	19.25	20.59	21.93	23.27
80	3.19	4.53	5.88	7.22	8.57	9.92	11.26	12.61	13.95	15.30	16.64	17.99	19.33	20.68	22.02	23.37
84	3.38	4.80	6.23	7.65	9.08	10.51	11.93	13.36	14.78	16.21	17.63	19.06	20.48	21.91	23.33	24.76
88	3.66	5.21	6.75	8.30	9.85	11.39	12.94	14.48	16.03	17.57	19.12	20.66	22.21	23.75	25.30	26.85
92	3.85	5.48	7.10	8.72	10.35	11.97	13.60	15.22	16.85	18.47	20.10	21.72	23.35	24.97	26.60	28.22
96	4.04	5.74	7.44	9.15	10.85	12.55	14.26	15.96	17.66	19.37	21.07	22.77	24.48	26.18	27.88	29.59

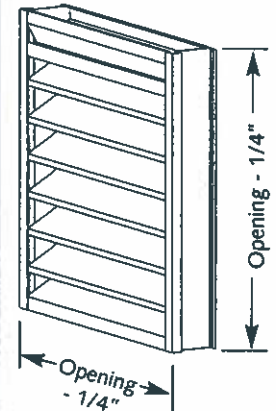

### RECOMMENDED SPECIFICATION 2450 and 2455

Furnish and install stationary louver models 2450/2455 as manufactured by Ventex Inc, Bolton Ontario or Ventex of America, Kissimmee Florida. Louvers shall be 4" (100 mm) deep. Blades shall be 0.081" (2.06 mm) and frame shall be 0.081" (2.06 mm) extruded aluminum, alloy 6063-T5. Louvers shall have a 19 gauge galvanized bird-screen.

All materials shall be factory finished after assembly with Polyester Baking Enamel in a color selected from the Ventex Color Chart.

### PERCENTAGE OF FREE AREA

HEIGHT IN INCHES	WIDTH IN INCHES															
	12	16	20	24	28	32	36	40	44	48	52	56	60	64	68	72
12	32.4%	34.6	35.9	36.7	37.4	37.8	38.2	38.5	38.7	38.9	39.1	39.2	39.3	39.4	39.5	39.6
16	38.4	40.9	42.5	43.5	44.2	44.8	45.2	45.5	45.8	46.0	46.2	46.4	46.6	46.7	46.8	46.9
20	41.9	44.7	46.4	47.5	48.3	48.9	49.4	49.8	50.1	50.3	50.5	50.7	50.9	51.0	51.1	51.2
24	41.1	43.9	45.5	46.6	47.4	48.0	48.4	48.8	49.1	49.3	49.6	49.7	49.9	50.0	50.1	50.3
28	43.4	46.3	48.0	49.2	50.0	50.6	51.1	51.5	51.8	52.1	52.3	52.5	52.6	52.8	52.9	53.0
32	44.5	47.5	49.3	50.5	51.3	51.9	52.4	52.8	53.2	53.4	53.7	53.9	54.0	54.2	54.3	54.4
36	45.9	49.0	50.8	52.0	52.9	53.5	54.0	54.5	54.8	55.1	55.3	55.5	55.7	55.8	56.0	56.1
40	47.0	50.1	52.0	53.2	54.1	54.8	55.3	55.7	56.1	56.4	56.6	56.8	57.0	57.1	57.3	57.4
44	47.7	50.9	52.8	54.0	54.9	55.6	56.2	56.6	56.9	57.2	57.5	57.7	57.8	58.0	58.1	58.3
48	48.3	51.5	53.4	54.7	55.6	56.3	56.8	57.2	57.6	57.9	58.1	58.3	58.5	58.7	58.8	58.9
52	46.4	49.5	51.3	52.6	53.4	54.1	54.6	55.0	55.4	55.6	55.9	56.1	56.3	56.4	56.6	56.7
56	48.1	51.3	53.2	54.5	55.4	56.1	56.6	57.1	57.4	57.7	57.9	58.2	58.3	58.5	58.6	58.8
60	48.5	51.7	53.7	55.0	55.9	56.6	57.1	57.5	57.9	58.2	58.4	58.6	58.8	59.0	59.1	59.3
64	49.0	52.2	54.2	55.5	56.4	57.1	57.7	58.1	58.4	58.7	59.0	59.2	59.4	59.6	59.7	59.8
68	49.4	52.7	54.7	56.0	56.9	57.6	58.2	58.6	58.9	59.2	59.5	59.7	59.9	60.1	60.2	60.3
72	49.8	53.1	55.1	56.4	57.3	58.1	58.6	59.0	59.4	59.7	60.0	60.2	60.4	60.5	60.7	60.8
76	50.1	53.5	55.5	56.8	57.7	58.4	59.0	59.4	59.8	60.1	60.4	60.6	60.8	60.9	61.1	61.2
80	47.8	51.0	52.9	54.2	55.1	55.8	56.3	56.7	57.1	57.4	57.6	57.8	58.0	58.2	58.3	58.4
84	48.3	51.5	53.4	54.7	55.6	56.3	56.8	57.2	57.6	57.9	58.1	58.3	58.5	58.7	58.8	59.0
88	49.9	53.3	55.3	56.6	57.5	58.2	58.8	59.2	59.6	59.9	60.2	60.4	60.6	60.7	60.9	61.0
92	50.2	53.6	55.6	56.9	57.9	58.6	59.1	59.6	59.9	60.2	60.5	60.7	60.9	61.1	61.2	61.3
96	50.5	53.8	55.8	57.2	58.1	58.8	59.4	59.8	60.2	60.5	60.8	61.0	61.2	61.4	61.5	61.6



# HI PRO 2460 AND 2465 HIGH PERFORMANCE STORMPROOF LOUVERS

The Ventex 2460/2465 louver is the newly designed extruded aluminum, stationary, four inch (100 mm) deep high performance louver. The 2460 is a hybrid louver combining the water collecting abilities of a drainable louver system with the blade profile of a stormproof louver. This makes the 2460 superior to other stormproof louvers.

## STANDARD CONSTRUCTION

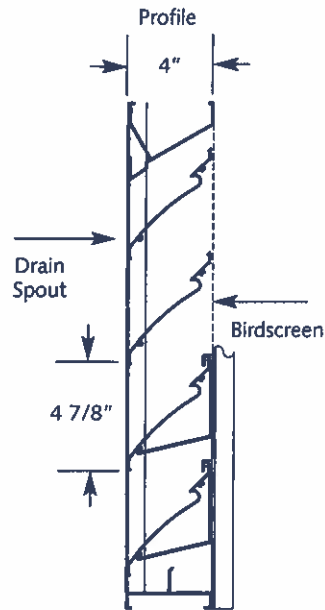

Channel Frame



Extended Sill



Flange Frame

Depth	4" (100 mm)
Material	Extruded 6063-T5 Aluminum
Frame Thickness	0.081" (2.06 mm)
Frame Styles	Model 2460 Channel Frame Model 2465 Flange Frame, 1 1/2" Flange Frame
Blade Thickness	0.081" (2.06 mm)
Blade Angle	45°
Blade Centres	4 7/8" (124 mm)
Standard Birdscreen	1/2" x 1/2", re-galvanized, 19 gauge
Minimum Height	12" (300 mm)
Maximum Panel Height	120" (3048 mm)
Maximum Panel Width	120" (3048 mm)
Maximum Panel Size	60 Sq Ft. (5.58m)
Available Finishes	Mill Finish, Polyester Baking Enamel, Clear or Colored Anodized Finish
Free Area (48" x 48" Unit)	7.97 sq. ft. (0.719 m <sup>2</sup> )

## ACCESSORIES

- 1/2" x 1/2" or 1/4" x 1/4" inter-crimped aluminum birdscreen
- Some geometric shapes available; consult your Ventex representative
- Non-insulated blank-off panels
- 1" or 2" insulated blank-off panels
- All welded construction
- Hinged access doors
- Security bars
- Extended sills
- Extended sleeves
- Filter racks



# HI PRO 2460 AND 2465 HIGH PERFORMANCE STORMPROOF LOUVERS



## PERFORMANCE DATA

### FREE AREA IN SQUARE FEET

HEIGHT IN INCHES	WIDTH IN INCHES															
	12	16	20	24	28	32	36	40	44	48	52	56	60	64	68	72
12	0.20	0.28	0.37	0.45	0.53	0.62	0.70	0.78	0.87	0.95	1.03	1.12	1.20	1.28	1.37	1.45
16	0.34	0.49	0.63	0.77	0.92	1.06	1.21	1.35	1.49	1.64	1.78	1.93	2.07	2.21	2.36	2.50
20	0.55	0.79	1.02	1.25	1.49	1.72	1.95	2.19	2.42	2.65	2.89	3.12	3.35	3.59	3.82	4.05
24	0.68	0.97	1.26	1.55	1.84	2.13	2.42	2.71	2.99	3.28	3.57	3.86	4.15	4.44	4.73	5.02
28	0.82	1.17	1.51	1.86	2.21	2.55	2.90	3.24	3.59	3.94	4.28	4.63	4.98	5.32	5.67	6.01
32	0.96	1.36	1.77	2.17	2.57	2.98	3.38	3.78	4.19	4.59	5.00	5.40	5.80	6.21	6.61	7.02
36	1.09	1.55	2.01	2.47	2.93	3.40	3.86	4.32	4.78	5.24	5.70	6.16	6.62	7.08	7.54	8.00
40	1.33	1.90	2.46	3.02	3.59	4.15	4.71	5.28	5.84	6.40	6.97	7.53	8.09	8.66	9.22	9.78
44	1.46	2.08	2.70	3.32	3.94	4.55	5.17	5.79	6.41	7.03	7.65	8.26	8.88	9.50	10.12	10.74
48	1.60	2.27	2.95	3.62	4.29	4.97	5.64	6.31	6.99	7.67	8.34	9.01	9.68	10.36	11.03	11.71
52	1.74	2.47	3.20	3.94	4.67	5.40	6.14	6.87	7.60	8.33	9.07	9.80	10.53	11.27	12.00	12.73
56	1.88	2.67	3.47	4.26	5.06	5.85	6.64	7.44	8.23	9.02	9.82	10.61	11.41	12.20	12.99	13.79
60	2.01	2.86	3.71	4.56	5.41	6.26	7.11	7.96	8.81	9.66	10.51	11.36	12.21	13.06	13.91	14.76
64	2.25	3.19	4.14	5.09	6.04	6.98	7.93	8.88	9.83	10.78	11.72	12.67	13.62	14.57	15.51	16.46
68	2.38	3.38	4.38	5.39	6.39	7.39	8.40	9.40	10.40	11.41	12.41	13.41	14.41	15.42	16.42	17.42
72	2.51	3.57	4.63	5.69	6.75	7.81	8.87	9.93	10.99	12.05	13.11	14.17	15.23	16.29	17.35	18.41
76	2.55	3.63	4.70	5.78	6.86	7.93	9.01	10.09	11.16	12.24	13.32	14.39	15.47	16.55	17.62	18.70
80	2.69	3.83	4.97	6.10	7.24	8.38	9.51	10.65	11.79	12.92	14.06	15.20	16.33	17.47	18.60	19.74
84	3.03	4.30	5.58	6.86	8.14	9.41	10.69	11.97	13.25	14.52	15.80	17.08	18.36	19.63	20.91	22.19
88	3.16	4.49	5.82	7.15	8.49	9.82	11.15	12.48	13.81	15.15	16.48	17.81	19.14	20.48	21.81	23.14
92	3.29	4.68	6.07	7.45	8.84	10.23	11.62	13.00	14.39	15.78	17.17	18.56	19.94	21.33	22.72	24.11
96	3.43	4.87	6.32	7.77	9.21	10.66	12.10	13.55	15.00	16.44	17.89	19.33	20.78	22.23	23.67	25.12

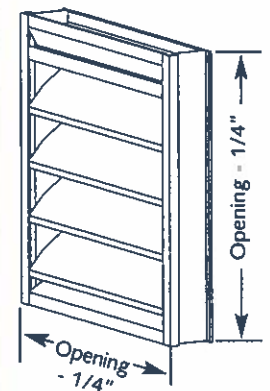

### RECOMMENDED SPECIFICATION 2460 and 2465

Furnish and install stationary louver models 2460/2465 as manufactured by Ventex Inc, Bolton Ontario or Ventex of America, Kissimmee Florida. Louvers shall be 4" (100 mm) deep. Blades shall be 0.081" (2.06 mm) and frame shall be 0.081" (2.06 mm) extruded aluminum, alloy 6063-T5. Louvers shall have a 19 gauge galvanized birdscreen.

All materials shall be factory finished after assembly with Polyester Baking Enamel in a color selected from the Ventex Color Chart.

### PERCENTAGE OF FREE AREA

HEIGHT IN INCHES	WIDTH IN INCHES															
	12	16	20	24	28	32	36	40	44	48	52	56	60	64	68	72
12	19.8%	21.1	21.9	22.4	22.8	23.1	23.3	23.5	23.6	23.8	23.9	23.9	24.0	24.1	24.1	24.2
16	25.6	27.3	28.3	29.0	29.5	29.9	30.1	30.4	30.6	30.7	30.8	31.0	31.1	31.1	31.2	31.3
20	33.2	35.4	36.7	37.6	38.2	38.7	39.1	39.4	39.6	39.8	40.0	40.1	40.2	40.4	40.4	40.5
24	34.2	36.5	37.9	38.8	39.4	39.9	40.3	40.6	40.8	41.0	41.2	41.4	41.5	41.6	41.7	41.8
28	35.2	37.5	38.9	39.8	40.5	41.0	41.4	41.7	42.0	42.2	42.4	42.5	42.7	42.8	42.9	43.0
32	35.9	38.3	39.7	40.7	41.4	41.9	42.3	42.6	42.8	43.1	43.2	43.4	43.5	43.7	43.8	43.9
36	36.4	38.8	40.3	41.2	41.9	42.4	42.8	43.2	43.4	43.6	43.8	44.0	44.1	44.3	44.4	44.5
40	40.0	42.7	44.3	45.4	46.1	46.7	47.1	47.5	47.8	48.0	48.2	48.4	48.6	48.7	48.8	48.9
44	39.9	42.6	44.2	45.3	46.0	46.6	47.0	47.4	47.7	47.9	48.1	48.3	48.4	48.6	48.7	48.8
48	39.9	42.6	44.2	45.2	46.0	46.6	47.0	47.4	47.7	49.8	48.1	48.3	48.4	48.6	48.7	48.8
52	40.1	42.8	44.4	45.4	46.2	46.8	47.2	47.6	47.8	48.1	48.3	48.5	48.6	48.8	48.9	49.0
56	40.3	43.0	44.6	45.7	46.4	47.0	47.5	47.8	48.1	48.3	48.6	48.7	48.9	49.0	49.1	49.2
60	40.3	43.0	44.6	45.6	46.4	47.0	47.4	47.8	48.1	48.3	48.5	48.7	48.8	49.0	49.1	49.2
64	42.1	44.9	46.6	47.7	48.5	49.1	49.6	50.0	50.3	50.5	50.7	50.9	51.1	51.2	51.3	51.4
68	42.0	44.7	46.4	47.5	48.3	48.9	49.4	49.8	50.1	50.3	50.5	50.7	50.9	51.0	51.1	51.2
72	41.9	44.7	46.3	47.4	48.2	48.8	49.3	49.7	50.0	50.2	50.4	50.6	50.8	50.9	51.0	51.1
76	40.3	43.0	44.6	45.6	46.4	47.0	47.4	47.8	48.1	48.3	48.5	48.7	48.9	49.0	49.1	49.2
80	40.4	43.1	44.7	45.8	46.5	47.1	47.6	47.9	48.2	48.5	48.7	48.8	49.0	49.1	49.2	49.4
84	43.2	46.1	47.8	49.0	49.8	50.4	50.9	51.3	51.6	51.9	52.1	52.3	52.4	52.6	52.7	52.8
88	43.1	45.9	47.6	48.8	49.6	50.2	50.7	51.1	51.4	51.6	51.9	52.0	52.2	52.4	52.5	52.6
92	42.9	45.8	47.5	48.6	49.4	50.0	50.5	50.9	51.2	51.5	51.7	51.9	52.0	52.2	52.3	52.4
96	42.8	45.7	47.4	48.5	49.3	50.0	50.4	50.8	51.1	51.4	51.6	51.8	52.0	52.1	52.2	52.3



## MODEL 2590 WIND DRIVEN RAIN LOUVER

Introducing the next generation of rain resistant louvers, the new 2590 wind driven rain louver. This advanced design utilizes centrifugal forces to capture water droplets as the air passes over the sight proof, drainable blades.

The design will improve the weather tightness of the building envelope, while maintaining effective air flow performance required by the ventilation system.

Please contact Ventex for more information on this new design.

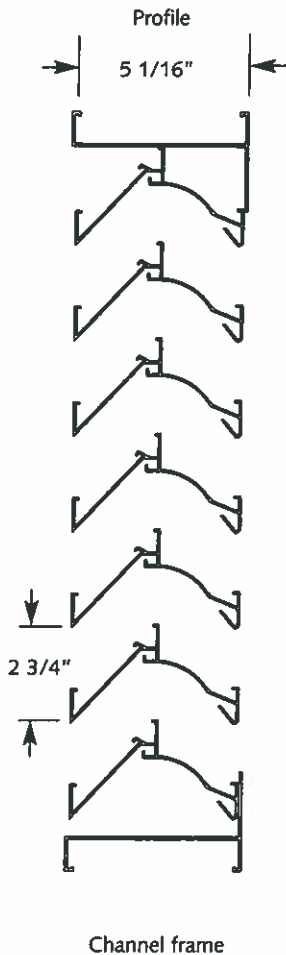

### STANDARD CONSTRUCTION

Depth	5 1/16" (129 mm)
Material	Extruded 6063-T5 Aluminum
Frame Thickness	0.081" (2.06 mm)
Frame Styles	Channel Frame Only
Blade Thickness	0.063 (1.6 mm)
Blade Angle	35°
Blade Centres	2 3/4" (70 mm)
Minimum Height	12" (300 mm)
Maximum Panel Height	120" (3048 mm)
Maximum Panel Width	60" (1524 mm)
Available Finishes	Mill Standard, Baked Enamel, Clear Anodized, Colour
Free Area (48" x 48")	7.43 Sq. Ft. (0.69 sq.m.)

### ADDITIONAL ACCESSORIES

- 1/2" x 1/2" inter-crimped aluminum birdscreen
- Insect screen
- Insulated and Non-insulated blank off panels
- All welded construction
- Hinged access doors
- Security bars
- Extended sills
- Extended Sleeves
- Filter Racks







## PERFORMANCE DATA

### FREE AREA IN SQUARE FEET

HEIGHT IN INCHES	WIDTH IN INCHES									
	12	18	24	30	36	42	48	54	60	
12	0.19	0.33	0.46	0.60	0.74	0.88	1.01	1.15	1.29	
18	0.39	0.67	0.95	1.23	1.51	1.79	2.07	2.35	2.63	
24	0.60	1.03	1.46	1.90	2.33	2.76	3.20	3.63	4.06	
30	0.81	1.40	1.98	2.57	3.16	3.75	4.33	4.92	5.51	
36	1.02	1.76	2.50	3.24	3.98	4.71	5.45	6.19	6.93	
42	1.20	2.07	2.95	3.82	4.69	5.57	6.44	7.31	8.19	
48	1.39	2.39	3.40	4.41	5.42	6.43	7.43	8.44	9.45	
54	1.59	2.75	3.91	5.07	6.23	7.39	8.55	9.71	10.87	
60	1.81	3.12	4.43	5.75	7.06	8.37	9.69	11.00	12.31	
66	2.02	3.49	4.95	6.42	7.89	9.36	10.82	12.29	13.76	
72	2.21	3.82	5.43	7.04	8.65	10.26	11.86	13.47	15.08	
78	2.40	4.14	5.88	7.62	9.37	11.11	12.85	14.59	16.34	
84	2.59	4.48	6.36	8.25	10.13	12.02	13.90	15.79	17.67	
90	2.80	4.84	6.88	8.92	10.96	13.00	15.03	17.07	19.11	
96	3.02	5.21	7.40	9.59	11.79	13.98	16.17	18.36	20.56	
102	3.22	5.57	7.91	10.26	12.60	14.94	17.29	19.63	21.98	
108	3.41	5.89	8.36	10.84	13.32	15.80	18.28	20.75	23.23	
114	3.59	6.21	8.82	11.43	14.05	16.66	19.27	21.88	24.50	
120	3.80	6.57	9.33	12.09	14.86	17.62	20.39	23.15	25.92	

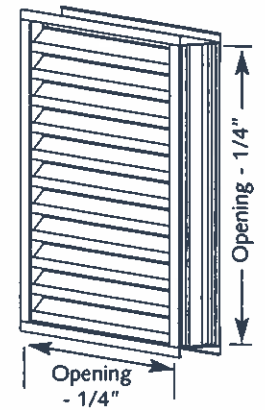

### RECOMMENDED SPECIFICATION 2590

Furnish and install stationary louver model 2590 as manufactured by Ventex Inc, Bolton Ontario or Ventex of America, Kissimmee Florida. Louvers shall be 5 1/16" (129 mm) deep. Blades shall be .063 (1.6 mm) and frame shall be .081 (2.06 mm) extruded aluminum alloy 6063-T5. Louvers shall have a 19 gauge galvanized birdscreen.

All materials shall be factory finished after assembly with polyester baking enamel in color selected from the Ventex Colour Chart.

### PERCENTAGE OF FREE AREA

HEIGHT IN INCHES	WIDTH IN INCHES									
	12	18	24	30	36	42	48	54	60	
12	18.9%	21.8	23.2	24.0	24.6	25.0	25.3	25.6	25.8	
18	25.7	29.6	31.5	32.7	33.5	34.0	34.4	34.8	35.0	
24	29.8	34.3	36.6	37.9	38.8	39.5	40.0	40.3	40.6	
30	32.3	37.2	39.7	41.1	42.1	42.8	43.3	43.8	44.1	
36	33.9	39.0	41.6	43.1	44.2	44.9	45.5	45.9	46.2	
42	34.3	39.5	42.1	43.7	44.7	45.4	46.0	46.4	46.8	
48	34.7	39.9	42.5	44.1	45.2	45.9	46.5	46.9	47.3	
54	35.4	40.8	43.5	45.1	46.2	46.9	47.5	47.9	48.3	
60	36.1	41.6	44.3	46.0	47.1	47.8	48.4	48.9	49.3	
66	36.7	42.2	45.0	46.7	47.8	48.6	49.2	49.7	50.0	
72	36.9	42.5	45.2	46.9	48.0	48.8	49.4	49.9	50.3	
78	36.9	42.4	45.2	46.9	48.0	48.8	49.4	49.9	50.3	
84	37.0	42.6	45.4	47.1	48.3	49.1	49.7	50.1	50.5	
90	37.4	43.0	45.9	47.6	48.7	49.5	50.1	50.6	51.0	
96	37.7	43.4	46.3	48.0	49.1	49.9	50.5	51.0	51.4	
102	37.9	43.7	46.5	48.3	49.4	50.2	50.9	51.3	51.7	
108	37.9	43.6	46.5	48.2	49.3	50.2	50.8	51.2	51.6	
114	37.8	43.6	46.4	48.1	49.3	50.1	50.7	51.2	51.6	
120	38.0	43.8	46.6	48.4	49.5	50.3	51.0	51.4	51.8	



## 2620 AND 2625 STORMPROOF LOUVERS

The Ventex 2620/2625 louver is the extruded aluminum, stationary, six-inch (150 mm) deep stormproof louver. The 2620 design provides protection from water penetration while retaining a relatively high free area. Its sturdy construction makes it ideal for large projects where the louver covers a large span.

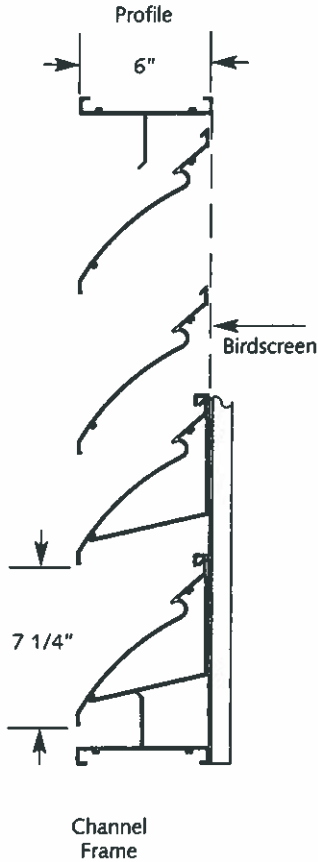

### STANDARD CONSTRUCTION

Depth	6" (150 mm)
Material	Extruded 6063-T5 Aluminum
Frame Thickness	0.085" (2.16 mm)
Frame Styles	Model 2620 Channel Frame Model 2625 Flange Frame, 1 1/2" Flange Frame
Blade Thickness	0.081" (2.06 mm)
Blade Angle	45°
Blade Centres	7 1/4" (76.2 mm)
Standard Birdscreen	1/2" x 1/2", re-galvanized, 19 gauge
Minimum Height	16" (400 mm)
Maximum Panel Height	120" (3048 mm)
Maximum Panel Width	72" (1830 mm)
Available Finishes	Mill Finish or Polyester Baking Enamel, Clear or Colored Anodized Finish
Free Area (48" x 48" Unit)	8.06 sq. ft. (0.743 m <sup>2</sup> )

### ACCESSORIES

- 1/2" x 1/2" or 1/4" x 1/4" inter-crimped aluminum birdscreen
- Insect screen
- Continuous blade construction with hidden mullions to give an uninterrupted appearance
- Non-insulated blank-off panels
- 1" or 2" insulated blank-off panels
- All welded construction
- Hinged access doors
- Custom geometric shapes
- Security bars
- Extended sills
- Extended sleeves
- Filter racks



Extended Sill



Flange Frame



# 2620 AND 2625 STORMPROOF LOUVERS



## PERFORMANCE DATA

HEIGHT IN INCHES	WIDTH IN INCHES														
	16	20	24	28	32	36	40	44	48	52	56	60	64	68	72
16	0.50	0.65	0.79	0.93	1.07	1.21	1.36	1.50	1.64	1.78	1.92	2.06	2.21	2.35	2.49
20	0.79	1.02	1.24	1.46	1.69	1.91	2.13	2.36	2.58	2.80	3.03	3.25	3.47	3.69	3.92
24	1.03	1.31	1.60	1.89	2.18	2.46	2.75	3.04	3.33	3.62	3.90	4.19	4.48	4.77	5.05
28	1.31	1.68	2.05	2.42	2.79	3.16	3.53	3.90	4.27	4.63	5.00	5.37	5.74	6.11	6.48
32	1.44	1.85	2.25	2.66	3.07	3.47	3.88	4.28	4.69	5.09	5.50	5.90	6.31	6.71	7.12
36	1.60	2.04	2.49	2.94	3.39	3.84	4.28	4.73	5.18	5.63	6.07	6.52	6.97	7.42	7.87
40	1.96	2.51	3.06	3.61	4.16	4.70	5.25	5.80	6.35	6.90	7.45	8.00	8.55	9.10	9.65
44	2.12	2.72	3.32	3.91	4.51	5.10	5.70	6.30	6.89	7.49	8.08	8.68	9.28	9.87	10.47
48	2.48	3.18	3.88	4.57	5.27	5.97	6.67	7.36	8.06	8.76	9.45	10.15	10.85	11.54	12.24
52	2.70	3.46	4.21	4.97	5.73	6.49	7.24	8.00	8.76	9.52	10.27	11.03	11.79	12.55	13.30
56	3.00	3.84	4.68	5.52	6.36	7.20	8.04	8.88	9.73	10.57	11.41	12.25	13.09	13.93	14.77
60	3.23	4.14	5.05	5.96	6.87	7.77	8.68	9.59	10.50	11.41	12.31	13.22	14.13	15.04	15.95
64	3.52	4.50	5.49	6.48	7.46	8.45	9.44	10.42	11.41	12.40	13.39	14.37	15.36	16.35	17.33
68	3.77	4.83	5.89	6.95	8.00	9.06	10.12	11.18	12.24	13.30	14.35	15.41	16.47	17.53	18.59
72	3.91	5.01	6.11	7.20	8.30	9.40	10.50	11.59	12.69	13.79	14.89	15.98	17.08	18.18	19.28
76	4.17	5.33	6.50	7.67	8.84	10.01	11.18	12.35	13.52	14.69	15.86	17.03	18.20	19.37	20.53
80	4.45	5.69	6.94	8.19	9.44	10.69	11.93	13.18	14.43	15.68	16.93	18.17	19.42	20.67	21.92
84	4.68	5.99	7.31	8.62	9.93	11.25	12.56	13.87	15.19	16.50	17.81	19.13	20.44	21.75	23.07
88	4.98	6.38	7.78	9.18	10.58	11.97	13.37	14.77	16.17	17.57	18.97	20.37	21.76	23.16	24.56
92	5.20	6.66	8.12	9.58	11.03	12.49	13.95	15.41	16.87	18.33	19.79	21.25	22.71	24.17	25.63
96	5.52	7.07	8.62	10.16	11.71	13.26	14.81	16.36	17.91	19.46	21.01	22.56	24.10	25.65	27.20
100	5.72	7.32	8.93	10.53	12.14	13.74	15.35	16.95	18.56	20.16	21.77	23.37	24.98	26.58	28.19
104	5.84	7.48	9.12	10.76	12.39	14.03	15.67	17.31	18.95	20.59	22.23	23.87	25.51	27.14	28.78
108	6.24	7.99	9.74	11.49	13.24	14.99	16.74	18.49	20.24	21.99	23.75	25.50	27.25	29.00	30.75
112	6.36	8.15	9.93	11.72	13.50	15.29	17.07	18.86	20.65	22.43	24.22	26.00	27.79	29.57	31.36
116	6.73	8.62	10.51	12.40	14.29	16.17	18.06	19.95	21.84	23.73	25.62	27.51	29.40	31.29	33.18
120	6.88	8.81	10.74	12.67	14.61	16.54	18.47	20.40	22.33	24.26	26.19	28.13	30.06	31.99	33.92

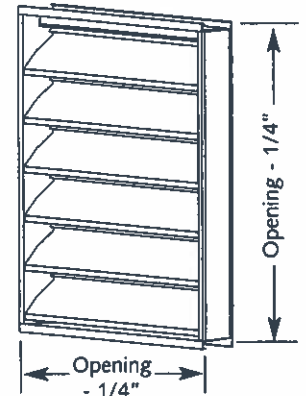

### RECOMMENDED SPECIFICATION 2620 and 2625

Furnish and install stationary louver models 2620/2625 as manufactured by Ventex Inc, Bolton Ontario or Ventex of America, Kissimmee Florida. Louvers must be licensed to bear the AMCA seal. Louvers shall be 6" (150 mm) deep. Blades shall be 0.081" (2.06 mm) and frame shall be 0.085" (2.16 mm) extruded aluminum, alloy 6063-T5. Louvers shall have a 19 gauge galvanized birdscreen.



## CERTIFIED RATINGS

Ventex certifies that the 2620/2625 louver shown here is licensed to bear the AMCA seal. The ratings shown are based on tests and procedures performed in accordance with AMCA Publication 511 and comply with the requirements of the AMCA Certified Ratings Program. The Certified Ratings Seal applies to air performance and water penetration ratings.

**2620 Stormproof Water Penetration**  
15 Minute Duration, Test Size (48" x 48")

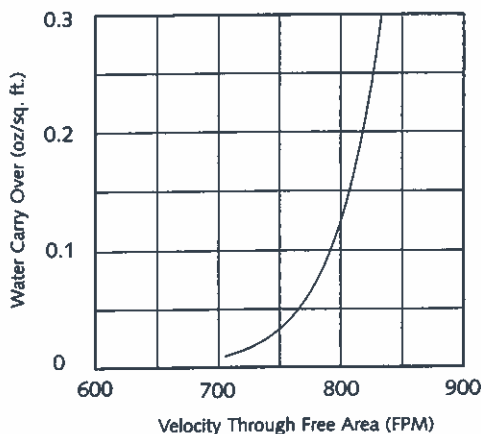

Beginning point of water penetration at 0.01 oz/sq. ft. is 705 FPM

**Pressure Drop - Intake**

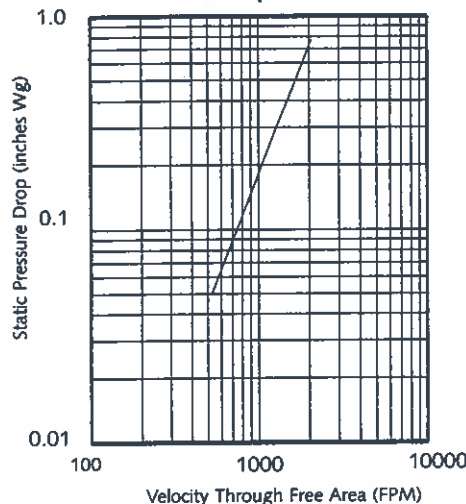

All materials shall be factory finished after assembly with Polyester Baking Enamel in a color selected from the Ventex Color Chart. The louver manufacturer shall submit test data on a 48" x 48" unit showing that the louver conforms to the data on this page.



## 2630 AND 2635 DRAINABLE LOUVERS

The Ventex 2630/2635 has been completely redesigned. The new extruded aluminum, stationary, six inch (150 mm) deep drainable louver has been greatly improved. The free area has been increased over 15% and still provides optimal protection from water penetration.

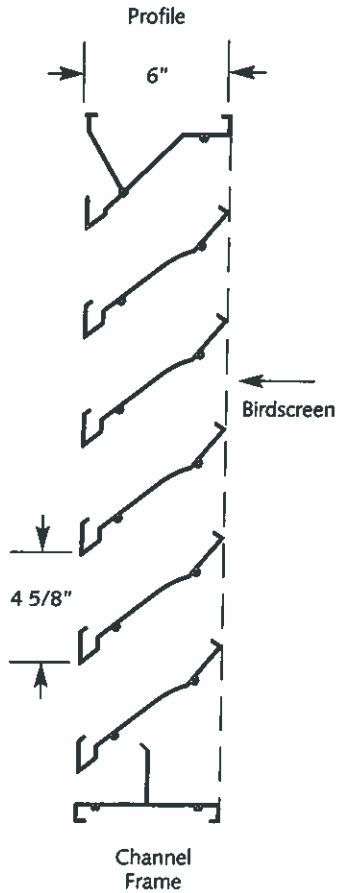

### STANDARD CONSTRUCTION

Depth	6" (150 mm)
Material	Extruded 6063-T5 Aluminum
Frame Thickness	0.095" (2.41 mm)
Frame Styles	Model 2630 Channel Frame Model 2635 Flange Frame, 1 1/2" Flange Frame
Blade Thickness	0.09" (2.29 mm)
Blade Angle	40°
Blade Centres	4 5/8" (117 mm)
Standard Birdscreen	1/2" x 1/2", re-galvanized, 19 gauge
Minimum Height	16" (406 mm)
Maximum Panel Height	120" (3048 mm)
Maximum Panel Width	72" (1800 mm)
Available Finishes	Mill Finish or Polyester Baking Enamel, Clear or Colored Anodized Finish
Free Area (48" x 48" Unit)	8.30 sq. ft. (0.77 m <sup>2</sup> )

### ACCESSORIES

- 1/2" x 1/2" or 1/4" x 1/4" aluminum birdscreen
- 18" x 14" Insect screen
- Non-insulated blank-off panels
- Insulated blank-off panels
- All welded construction
- Hinged access doors
- Custom geometric shapes
- Extended sleeves
- Filter racks
- Security bars
- Extended sills

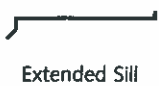

# 2630 AND 2635 DRAINABLE LOUVERS



## PERFORMANCE DATA

		WIDTH IN INCHES															
		16	20	24	28	32	36	40	44	48	52	56	60	64	68	72	
HEIGHT IN INCHES	16	0.61	0.79	0.96	1.14	1.32	1.50	1.68	1.85	2.03	2.21	2.39	2.57	2.74	2.92	3.10	
	20	0.83	1.08	1.32	1.56	1.81	2.05	2.29	2.54	2.78	3.02	3.27	3.51	3.75	4.00	4.24	
	24	1.15	1.48	1.82	2.15	2.49	2.82	3.15	3.49	3.82	4.16	4.49	4.83	5.16	5.50	5.83	
	28	1.41	1.82	2.23	2.64	3.05	3.46	3.87	4.28	4.69	5.10	5.51	5.92	6.33	6.74	7.15	
	32	1.59	2.05	2.51	2.98	3.44	3.90	4.36	4.83	5.29	5.75	6.22	6.68	7.14	7.60	8.07	
	36	1.78	2.31	2.83	3.35	3.87	4.39	4.91	5.43	5.95	6.47	6.99	7.51	8.03	8.55	9.08	
	40	2.02	2.60	3.19	3.78	4.37	4.96	5.54	6.13	6.72	7.31	7.90	8.49	9.07	9.66	10.25	
	44	2.26	2.91	3.57	4.23	4.89	5.54	6.20	6.86	7.52	8.17	8.83	9.49	10.15	10.80	11.46	
	48	2.49	3.21	3.94	4.66	5.39	6.12	6.84	7.57	8.29	9.02	9.74	10.47	11.19	11.92	12.64	
	52	2.80	3.62	4.43	5.25	6.06	6.88	7.70	8.51	9.33	10.15	10.96	11.78	12.59	13.41	14.23	
	56	3.04	3.93	4.82	5.70	6.59	7.47	8.36	9.25	10.13	11.02	11.91	12.79	13.68	14.57	15.45	
	60	3.28	4.24	5.19	6.15	7.10	8.06	9.02	9.97	10.93	11.88	12.84	13.79	14.75	15.71	16.66	
	64	3.66	4.72	5.79	6.85	7.92	8.98	10.05	11.11	12.18	13.24	14.31	15.37	16.44	17.51	18.57	
	68	3.66	4.72	5.79	6.85	7.92	8.99	10.05	11.12	12.18	13.25	14.31	15.38	16.44	17.51	18.58	
	72	3.90	5.03	6.16	7.30	8.43	9.57	10.70	11.84	12.97	14.11	15.24	16.38	17.51	18.65	19.78	
	76	4.13	5.33	6.53	7.74	8.94	10.14	11.34	12.55	13.75	14.95	16.15	17.36	18.56	19.76	20.96	
80	4.35	5.62	6.89	8.16	9.42	10.69	11.96	13.23	14.49	15.76	17.03	18.30	19.56	20.83	22.10		
84	4.73	6.10	7.48	8.86	10.23	11.61	12.99	14.36	15.74	17.12	18.49	19.87	21.25	22.62	24.00		
88	4.93	6.37	7.80	9.24	10.68	12.11	13.55	14.98	16.42	17.86	19.29	20.73	22.16	23.60	25.04		
92	5.23	6.75	8.27	9.79	11.31	12.84	14.36	15.88	17.40	18.92	20.45	21.97	23.49	25.01	26.53		
96	5.31	6.85	8.39	9.94	11.48	13.03	14.57	16.12	17.66	19.21	20.75	22.30	23.84	25.39	26.93		
100	5.54	7.15	8.76	10.37	11.98	13.60	15.21	16.82	18.43	20.04	21.66	23.27	24.88	26.49	28.10		
104	5.78	7.46	9.14	10.82	12.50	14.19	15.87	17.55	19.23	20.91	22.60	24.28	25.96	27.64	29.32		
108	6.00	7.75	9.50	11.24	12.99	14.74	16.48	18.23	19.98	21.73	23.47	25.22	26.97	28.71	30.46		
112	6.27	8.10	9.92	11.75	13.58	15.40	17.23	19.06	20.88	22.71	24.53	26.36	28.19	30.01	31.84		
116	6.54	8.45	10.35	12.26	14.16	16.07	17.97	19.88	21.79	23.69	25.60	27.50	29.41	31.31	33.22		
120	6.82	8.80	10.78	12.77	14.75	16.74	18.72	20.71	22.69	24.67	26.66	28.64	30.63	32.61	34.60		

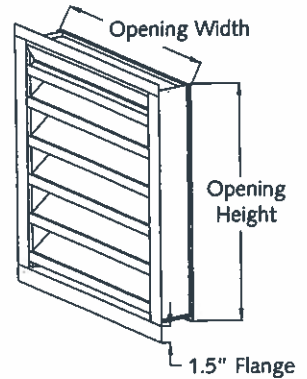

### RECOMMENDED SPECIFICATION 2630 and 2635

Furnish and install stationary louver models 2630/2635 as manufactured by Ventex Inc, Bolton Ontario or Ventex of America, Kissimmee Florida. Louvers must be licensed to bear the AMCA seal. Louvers shall be 6" (150 mm) deep. Blades shall be 0.090" (2.28 mm) and frame shall be 0.085" (2.16 mm) extruded aluminum, alloy 6063-T5. Louvers shall have a 19 gauge galvanized bird-screen.

## CERTIFIED RATINGS

Ventex certifies that the model 2630/2635 louver shown herein is licensed to bear the AMCA seal. The ratings shown are based on tests and procedures performed in accordance with AMCA Publication 511 and comply with the requirements of the AMCA Certified Ratings Program. The Certified Ratings Seal applies to air performance and water penetration ratings.



### 2630 - 2635 Drainable Water Penetration

15 Minute Duration, Test Size (48" x 48")

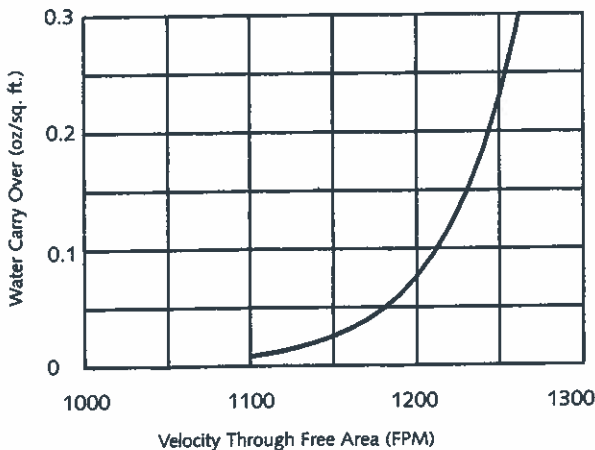

Beginning point of water penetration at 0.01 oz./sq. ft. is 1100 FPM

### Pressure Drop - Intake

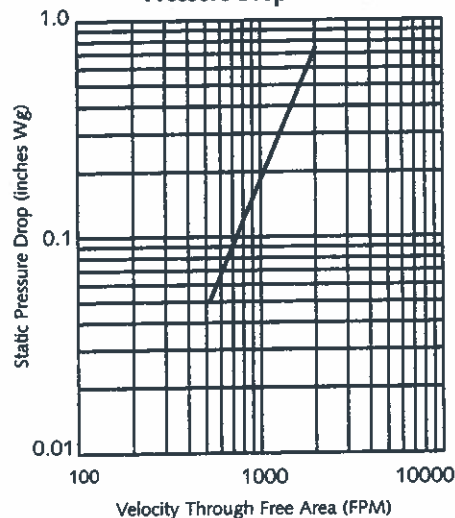

All materials shall be factory finished after assembly with Polyester Baking Enamel in a color selected from the Ventex Color Chart. The louver manufacturer shall submit test data on a 48" x 48" unit showing that the louver conforms to the data on this page.

Test results do not include the effects of birdscreen.



## MITRE CORNER PENTHOUSE

### RECOMMENDED SPECIFICATION MITRE CORNER PENTHOUSE

Furnish and install stationary mitre corner penthouse as manufactured by Ventex Inc, Bolton Ontario or Ventex of America, Kissimmee Florida. The penthouse blades shall be 2420/2425. Blades shall be 0.081" (2.06 mm) and frame shall be 0.081" (2.06 mm) extruded aluminum, alloy 6063-T5. Louvers shall have a 19 gauge galvanized birdscreen.

All materials shall be factory finished after assembly with Polyester Baking Enamel in a color selected from the Ventex Color Chart.

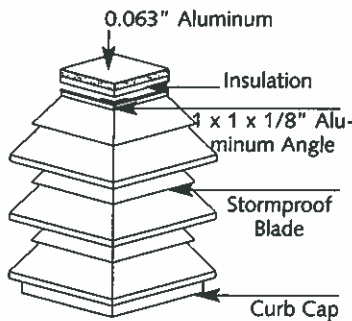

Mitre Corner Detail

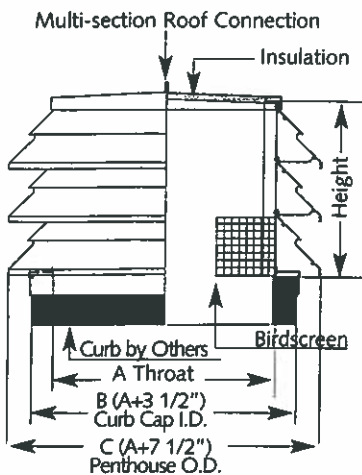

The Ventex mitre corner penthouse is our high performance intake louver configuration for fans and air systems. The mitre corner design yields the maximum possible free area, while providing protection from water. The mitre corner penthouse's clean lines are an attractive way to conceal roof top equipment.

### STANDARD CONSTRUCTION

Blade Style	Stormproof
Material	Extruded 6063-T5 Aluminum
Frame Thickness	0.081" (2.06 mm)
Corners	Mitre Corner
Blade Thickness	0.081" (2.06 mm)
Blade Angle	45°
Blade Centres	Determined by the height of the penthouse. Min: 4" (100 mm) Max: 5" (127 mm)
Standard Birdscreen	1/2" x 1/2", re-galvanized, 19 gauge
Minimum Height	12" (300 mm)
Maximum Panel Height	Consult Ventex
Maximum Panel Width	Consult Ventex
Available Finishes	Mill Finish, Primer, Polyester Baking Enamel
Standard Roof Construction	Factory applied anti-condensation coating

### ACCESSORIES

- Filter racks
- Hinged roof
- Concealed access door
- Extended weather guard around throat
- Insect screen
- 1/2" x 1/2" or 1/4" x 1/4" inter-crimped aluminum birdscreen
- Continuous blade construction with hidden mullions to give an uninterrupted appearance
- Motorized or Manual Dampers for throat
- Blade styles available - 2220, 2210, 2420, 2410 and 2620. Drainable blades are not recommended for a mitre corner penthouse



# MULLION CORNER PENTHOUSE



The Ventex mullion corner penthouse is an economical alternative to the mitre corner penthouse. The mullion corner penthouse is available in all blade styles and can be used in many custom applications.

## STANDARD CONSTRUCTION

Blade Style	Stormproof
Material	Extruded 6063-T5 Aluminum
Frame Thickness	0.081" (2.06 mm)
Corners	Mullion Corner
Blade Thickness	0.081" (2.06 mm)
Blade Angle	45°
Blade Centres	4 7/8" (124 mm)
Standard Birdscreen	1/2" x 1/2", re-galvanized, 19 gauge
Minimum Height	12" (300 mm)
Maximum Panel Height	Consult Ventex
Maximum Panel Width	Consult Ventex
Available Finishes	Mill Finish, Primer, Polyester Baking Enamel & Anodized Finish
Standard Roof Construction	Factory applied anti-condensation coating

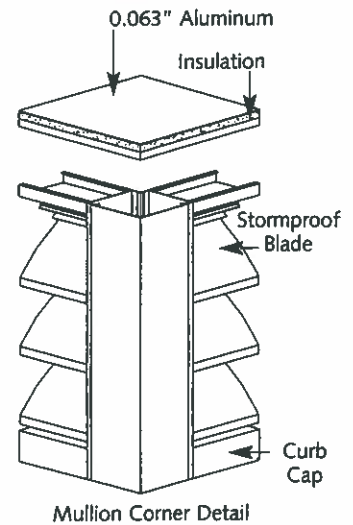

## RECOMMENDED SPECIFICATION MULLION CORNER PENTHOUSE

Furnish and install stationary mullion corner penthouse as manufactured by Ventex Inc, Bolton Ontario or Ventex of America, Kissimmee Florida. The penthouse blades shall be 2420/2425 stormproof (Or other specified blade). Blades shall be 0.081" (2.06 mm) and frame shall be 0.081" (2.06 mm) extruded aluminum, alloy 6063-T5. The penthouse shall have a 19 gauge galvanized bird screen.

All materials shall be factory finished after assembly with Polyester Baking Enamel in a color selected from the Ventex Color Chart.

## ACCESSORIES

- Filter racks
- Hinged roof
- Concealed access door
- Insect screen
- 1/2" x 1/2" or 1/4" x 1/4" inter-crimped aluminum birdscreen
- Continuous blade construction with hidden mullions to give an uninterrupted appearance
- Motorized or Manual Dampers for throat
- Blade styles available - 2220, 2210, 2430, 2420, 2410, 2630 and 2620

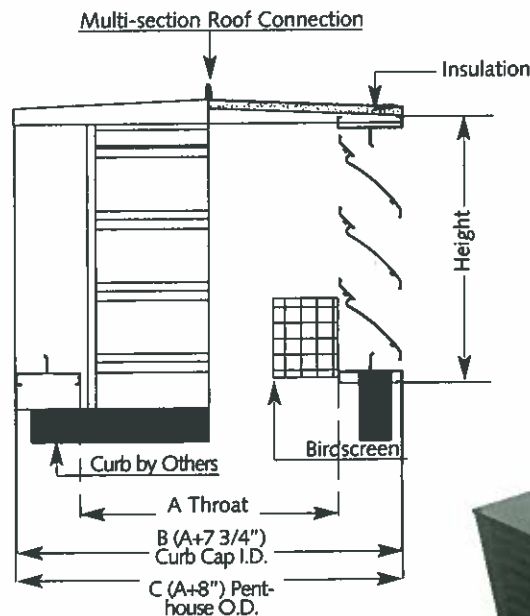



The introduction of the Ventex intake and exhaust hoods completes our line of roof top ventilators. The Ventex hood is a cost efficient alternative to penthouses. The hood offers the ability to move a greater volume of air at low static pressures. The 360 degree opening around the throat gives a reliable and balanced air flow from any direction as well as providing effective protection from weather. The low profile design of the hood minimizes the probability of being visible from the ground.

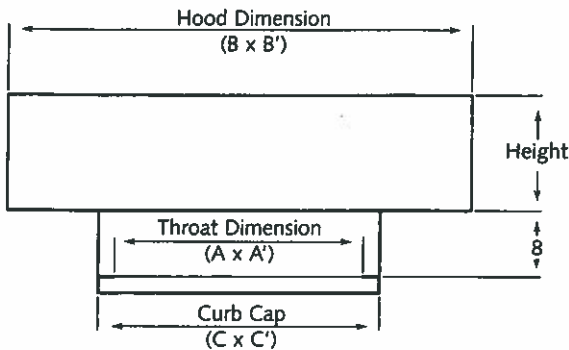

The hood is constructed from Heavy Gauge 0.063 Aluminum using standing seams and snap lock seams and assembled using self-sealing fasteners. Incorporated in the hood design are integral internal structural supports and braces to provide rigidity to withstand significant wind and snow loads.

The base is a single piece. It is fabricated from 0.063 aluminum using continuous welds along all vertical corners and seams. This provides exceptional strength and water tightness.

**STANDARD CONSTRUCTION**

Material	0.063 Aluminum
Throat Opening	360°
Hood Seams	Standing seams and Snap-Lock seams assembled with Self-Sealing Fasteners
Base	0.063 Aluminum with continuous welds along all vertical corners and seams
Screen	0.051" Flattened Aluminum Expanded Metal
Exhaust Ventilator Ratio	1:1 Open Hood Area to Throat Area
Intake Ventilator Ratio	2:1 Open Hood Area to Throat Area

**OPTIONAL ACCESSORIES**

- Steel Construction
- Back Draft Dampers
- Filter Racks
- Aluminum Birdscreen
- Anti Condensate Coating
- 1" Roof Insulation
- Hinged Top
- Baked Enamel Finish

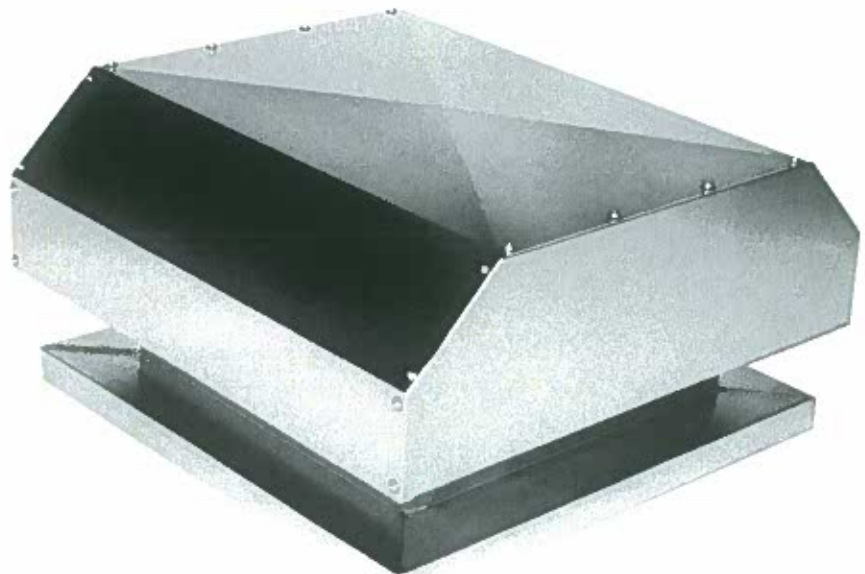



## MODEL BV — BRICK VENT



The Ventex BV is a heavy-duty extruded aluminum brick vent. The aluminum construction makes it resistant to the corrosive environment of foundation walls and chimneys. The brick vent comes with both birdscreen and insect screen. The brick vent features both extended head and extended sill to provide a drip edge for water to travel around the opening. There is also a raised water stop at the back to prevent any water flowing into the duct. It also has structural ribs in the head and sill to provide a good masonry bond. The Ventex brick vent is made from extruded aluminum, is available in custom sizes and is more versatile than a cast aluminum vent.

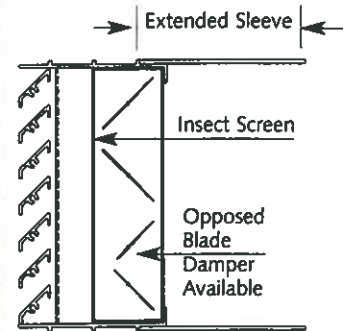
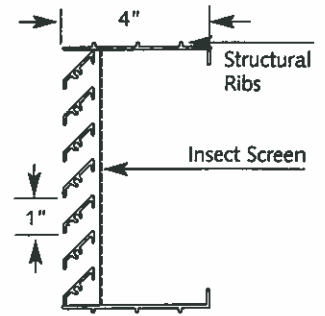

### RECOMMENDED SPECIFICATION BRICK VENT

Furnish and install extruded aluminum stationary brick vent as manufactured by Ventex Inc, Bolton Ontario or Ventex of America, Kissimmee Florida. Brick vents shall be 4" in depth with extended head and sill integral to the brick vent. Blades shall be 0.109" (2.54 mm) and frame shall be 0.109" (2.54 mm) extruded aluminum, alloy 6063-T5. Brick vents will come complete with aluminum #14 standard insect screen.

All materials shall be factory finished after assembly with Polyester Baking Enamel in a color selected from the Ventex Color Chart.

## STANDARD CONSTRUCTION

Depth	4" (101 mm)
Material	Extruded 6063-T5 Aluminum
Frame Thickness	0.109" (2.54 mm)
Frame Styles	Channel Frame
Blade Thickness	0.109" (2.54 mm)
Blade Angle	45°
Blade Centres	1 (25.4 mm)
Minimum Height	3 3/4" (95 mm)
Maximum Panel Height	36" (914 mm)
Maximum Panel Width	36" (914 mm)
Available Finishes	Mill Finish, Baked Enamel Finish, Primer Finish (for painting by others), Clear & Color Anodizing

## ACCESSORIES

- Extended sleeves
- Back draft damper in an extended sleeve
- Opposed blade damper that can be opened through the face

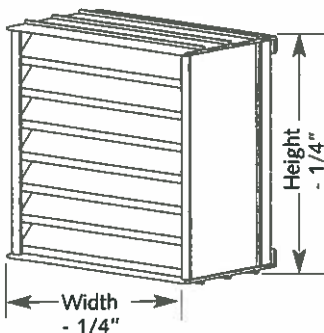
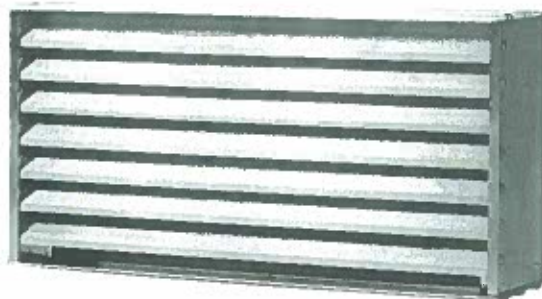

Note: Opposed Blade Dampers are (W)- 1.25 x (H) -3/4 Face Operated



## ACL ACOUSTIC LOUVER

Ventex has three acoustic louvers. The ACL800 and the ACL1200 are formed acoustic louvers. The ACL800 is eight inches (203 mm) deep and the ACL1200 is twelve inches (305 mm) deep. The standard construction is aluminum; galvanized steel construction is available as an alternative. The ACL600 acoustic louver is an extruded aluminum, six inch (152 mm) deep louver. These louvers are designed for applications that require noise reduction, as well as ventilation for equipment or machinery. They are commonly used in pumping stations and portable generators.

### STANDARD CONSTRUCTION

Model	ACL600	ACL800	ACL1200
Depth	6" (152 mm)	8" (203 mm)	12" (305 mm)
Material	6063-T5 Extruded Aluminum	.063" Aluminum Sheet Formed	.063" Aluminum Sheet Formed
Frame Thickness	5/8" (16 mm)	1" (25.4 mm)	1" (25.4 mm)
Frame Styles	Model ACL600 Channel Frame Model ACL605 Flange Frame	Model ACL800 Channel Frame Model ACL805 Flange Frame	Model ACL1200 Channel Frame Model ACL1205 Flange Frame
Blade Thickness	1" (25.4 mm)	4" (100 mm)	6" (150 mm)
Blade Angle	39°	45°	45°
Blade Centres	5 7/8" (149 mm)	8" (203 mm)	12" (305 mm)
Standard Birdscreen	1/2" x 1/2", re-galvanized, 19 gauge	1/2" x 1/2", re-galvanized, 19 gauge	1/2" x 1/2", re-galvanized, 19 gauge
Minimum Height	16" (406 mm)	16" (406 mm)	24" (610 mm)
Maximum Panel Height	72" (1829 mm)	72" (1829 mm)	72" (1829 mm)
Maximum Panel Width	72" (1829 mm)	60" (1524 mm)	60" (1524 mm)
Available Finishes	Mill Finish & Baked Enamel Finish	Mill Finish & Baked Enamel Finish	Mill & Baked Enamel Finish
Free Area (48" x 48" Unit)	4.80 sq. ft. (0.43 m <sup>2</sup> )	4.52 sq. ft. (0.41 m <sup>2</sup> )	4.07 sq. ft. (0.37 m <sup>2</sup> )

### ACCESSORIES

- Galvanized steel construction
- Additional gauges of aluminum construction available
- 1/2" x 1/2" or 1/4" x 1/4" inter-crimped aluminum birdscreen
- Insect screen
- Aluminum blank-off panels
- 1" or 2" insulated blank-off panels
- All welded construction
- Security bars
- Extended sleeves



Octave Band Frequency	ACL600 Noise Reduction (dB)	ACL800 Noise Reduction (dB)	ACL1200 Noise Reduction (dB)
2/125	7	8	8
3/250	9	12	15
4/500	11	15	17
5/1000	14	20	23
6/2000	22	24	25
7/4000	23	24	21
8/8000	26	23	20

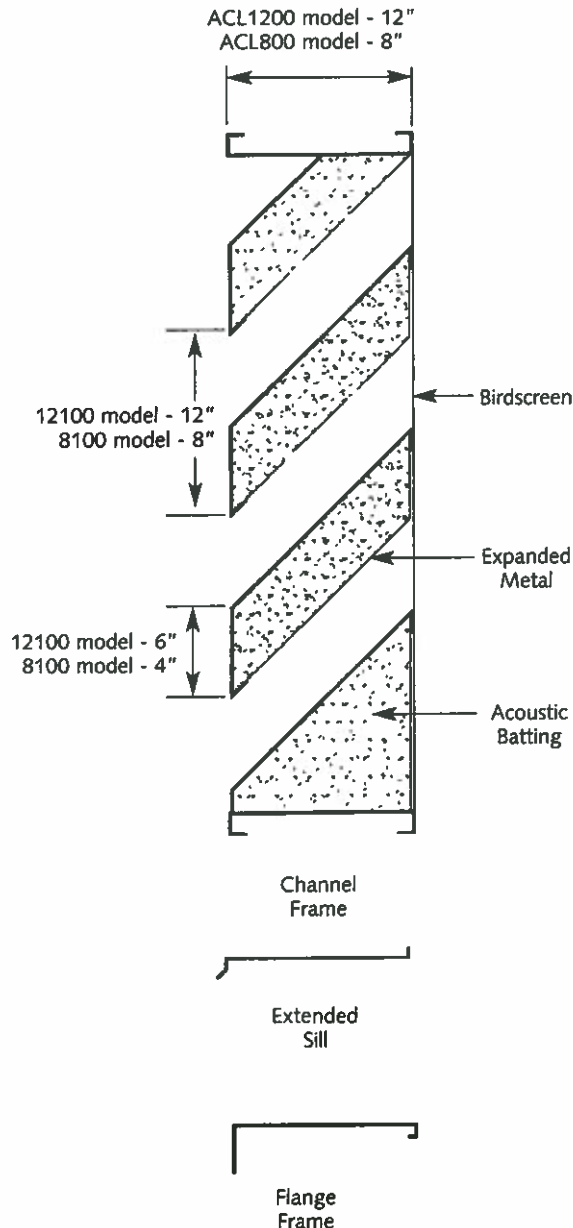
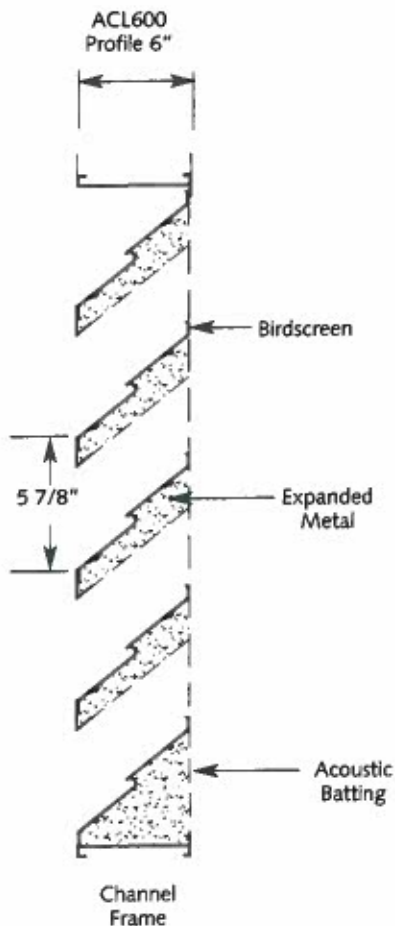
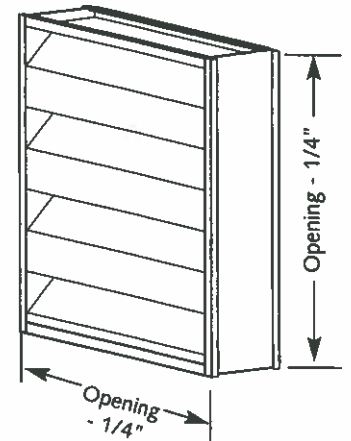

**RECOMMENDED SPECIFICATION  
ACL600/ACL605,  
ACL800/ACL805  
AND  
ACL1200/ACL1205**

Furnish and install stationary louvers Model ACL600/ACL605, Model ACL800/ACL805 or Model ACL1200/ACL1205 as manufactured by Ventex Inc, Bolton Ontario or Ventex of America, Kissimmee Florida. Louvers shall be 12" (305 mm) deep, 8" (203 mm) deep or 6" (152 mm) deep. Blades shall be 0.063" (1.6 mm) and frame shall be 0.063" (1.6 mm) formed aluminum or 6063-T5 extruded aluminum (ACL600/ACL605 only). Louvers shall have a 19 gauge galvanized birdscreen.

All materials shall be factory finished after assembly with Polyester Baking Enamel in a color selected from the Ventex Color Chart.



## COMBINATION HI PRO 2670/2675-CLD DRAINABLE LOUVER

The Ventex model 2670/2675-CLD provides a front fixed drainable blade, with a rear operating blade. This design maintains a uniform external appearance, while allowing for air flow control. Furthermore, the drainable front blade helps in reducing water entry.

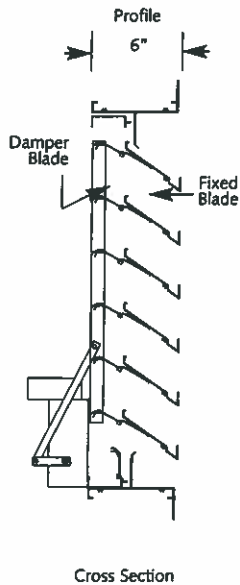

### STANDARD CONSTRUCTION

Depth	6" (152 mm)
Material	Extruded 6063-T5 Aluminum
Frame Thickness	0.081" (2.06 mm)
Frame Styles	Model 2670-CLD Channel Frame, Model 2675-CLD Flange Frame 1 1/2" Flange
Blade Thickness	0.081" (2.06 mm)
Blade Angle	35°
Blade Center	3 3/4"
Blade Type	Combination
Standard Birdscreen	1/2" x 1/2", re-galvanized, 19 gauge
Minimum Height	12" (305 mm)
Maximum Panel Width	60" (1500 mm)
Free Area 48" x 48" Unit	8.00 sq. ft.(0.743 m <sup>2</sup> )
Percentage Free Area	50%

### RECOMMENDED SPECIFICATION

Supply and install combination drainable fixed/operable blade louver, Ventex Model 2670/2675-CLD as manufactured by Ventex Inc, Bolton Ontario or Ventex of America, Kissimmee Florida. Louvers shall be 6" (152 mm) deep. Fixed blades shall be .081" (2.06 mm) and frame shall be .081" (2.06 mm) extruded aluminum, alloy 6063-T5. Louver shall have a 19 gauge galvanized birdscreen.

All materials shall be factory finished after assembly with Polyester Baking Enamel in a color selected from the Ventex Color Chart.

### ACCESSORIES

- Extended sill
- Multi-products motor packs (115 volt, 230 volt (single phase), 460 volt (single phase), and 24 volt AC)
- Belimo Motors available upon request
- End switch
- Continuous Line construction is NOT AVAILABLE





The Ventex 2420-OP/2425-OP is a four inch (100 mm) deep operable stormproof louver. The 2420-OP is ideal for an application in which the available space does not allow for a stationary louver and backdraft damper. Its design provides protection from water penetration while retaining a high free area with minimal static pressure drop.

**STANDARD CONSTRUCTION**

Depth	4" (100 mm)
Material	Extruded 6063-T5 Aluminum
Frame Thickness	0.081" (2.06 mm)
Frame Styles	Model 2420-OP Channel Frame Model 2425-OP Flange Frame, 1 1/2" Flange Frame
Blade Thickness	0.081" (2.06 mm)
Blade Angle	Adjustable to 45°
Blade Centres	6 1/8" (156 mm)
Blade Seals	Vinyl blade edge seals Stainless steel jambs seals
Standard Birdscreen	1/2" x 1/2", re-galvanized, 19 gauge
Minimum Height	16" (406 mm)
Maximum Panel Height	72" (1829 mm)
Maximum Panel Width	60" (1524 mm)
Maximum Panel Size	24 sq. ft.
Available Finishes	Mill Finish, Primer, Polyester Baking Enamel, Clear or Colored Anodized Finish
Standard Method of Operation	Chain operated

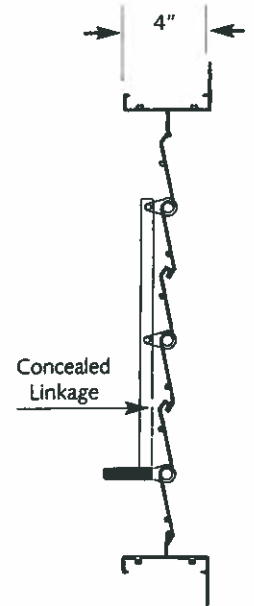

Blades Closed

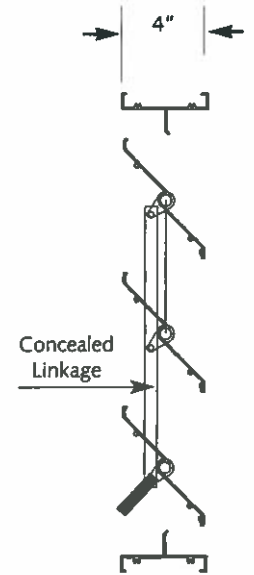

Blades Open



Channel Frame

**ACCESSORIES**

- Motorized 115 volt, 24 volt, 230 volt (single phase) and 460 volt (single phase) motors available
- Belimo motors available upon request. Consult Ventex for details
- 1/2" x 1/2" or 1/4" x 1/4" inter-crimped aluminum birdscreen
- Insect screen
- Non-insulated blank-off panels
- 1" or 2" insulated blank-off panels
- Extended sills
- Filter racks
- Hand crank operation
- Jack shafting for operating multiple sections with one motor
- Side shaft for remote operation or for motors by other

**RECOMMENDED SPECIFICATION 2420-OP/2425-OP**

Furnish and install operable louver models 2420-OP/2425-OP as manufactured by Ventex Inc, Bolton Ontario or Ventex of America, Kissimmee Florida. Louvers shall be 4" (100 mm) deep. Blades shall be 0.081" (2.06 mm) and frame shall be 0.081" (2.06 mm) extruded aluminum, alloy 6063-T5. Louvers shall have a 19 gauge galvanized birdscreen.

All materials shall be factory finished after assembly with Polyester Baking Enamel in a color selected from the Ventex Color Chart.



## BACK DRAFT DAMPER MODEL BDD

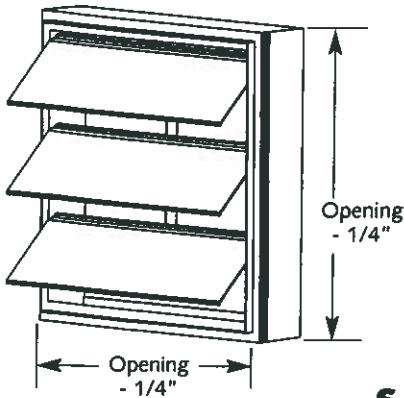

The Ventex BDD is a superior concept in back draft dampers. This unique all aluminum product eliminates the shortcomings of previous designs on the market. Pivot pins that quickly wear or rust out, or rivets that shake loose and pull through the blade are no longer a problem. The extruded blades are cleverly engineered to combine strength and durability with smooth operation by virtue of their aerodynamic design.

### RECOMMENDED SPECIFICATION BACK DRAFT DAMPER

Furnish and install BDD back draft damper as manufactured by Ventex Inc, Bolton Ontario or Ventex of America, Kissimmee Florida. The damper must be licensed to bear the AMCA seal. Dampers shall be 2 3/4" (70 mm) deep when the blades are closed and 5 5/8" deep when the blades are open. Blades shall be 0.062" (1.57 mm) and frame shall be 0.062" (1.57 mm) extruded aluminum, alloy 6063-T5.

The blades must have vinyl edge seals integral to each blade. Linkage is to be concealed from the front view of the damper and cannot be mechanically fastened to the damper blades. The damper manufacturer shall submit test data on the damper showing that it conforms to the data on the following page.

### STANDARD CONSTRUCTION

Depth: Blades Closed	2 3/4" (70 mm) "DM" & "FM"
Depth: Blades Open	5 5/8" (143 mm) "DM" & "FM"
Material	Extruded 6063-T5 Aluminum
Frame Thickness	0.062" (1.57 mm)
Frame Styles	Flange Mount 1 1/2" flange, specify "FM". Front Flange Mount 1 1/2" flange, specify "FFM". Duct Mount, specify "DM". All styles have mitred corners
Blade Thickness	0.062" (1.57 mm)
Blade Centres	3 3/4" (95 mm)
Blade Seals	Integral Vinyl Blade Seals on each blade
Minimum Height	9" (229 mm)
Maximum Panel Height	60" (1524 mm)
Maximum Panel Width	Single panel 40" (1016 mm) Double panel within a single frame 60" (1524 mm) Overall Size

### ACCESSORIES

- Counter balancing without springs
- Conduit hole
- Galvanized birdscreen
- Aluminum birdscreen
- Insect screen
- Manual locking device to keep blades open
- Manual operation complete with 6 feet of chain
- Roll formed damper blade 0.032.



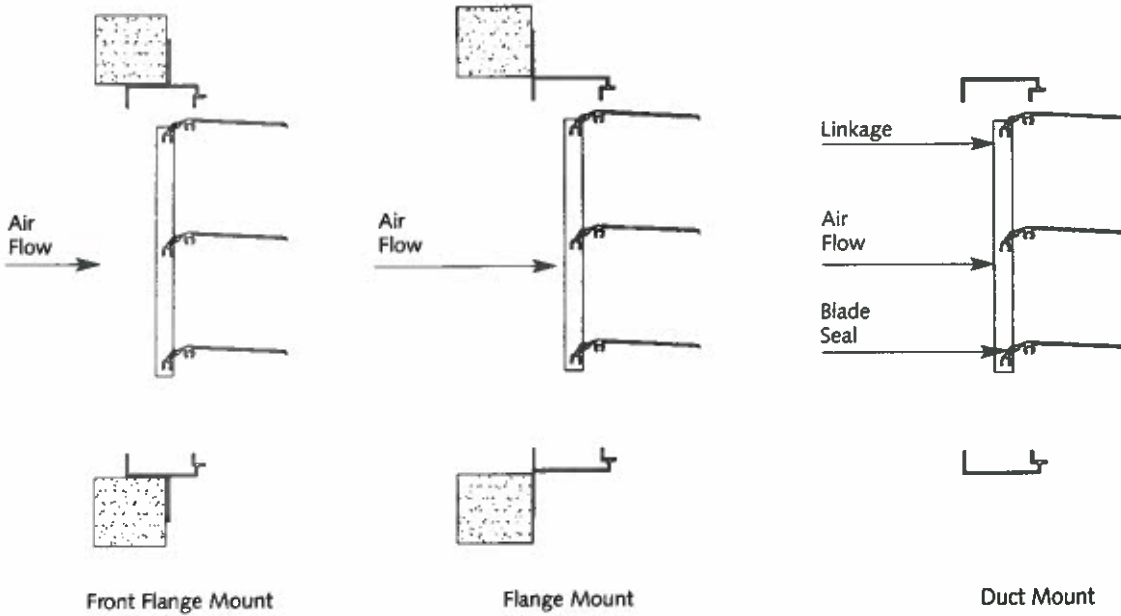

## CERTIFIED RATINGS

Ventex certifies that the BDD Back Draft Damper shown here is licensed to bear the AMCA seal. The ratings shown are based on tests and procedures performed in accordance with AMCA Standard 511 and comply with the requirements of the AMCA Certified Ratings Program. The Certified Ratings Seal applies to air performance and air leakage ratings.

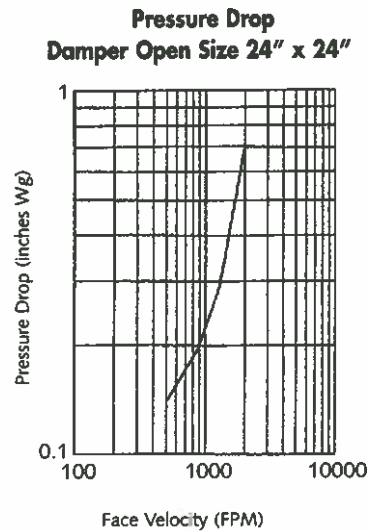
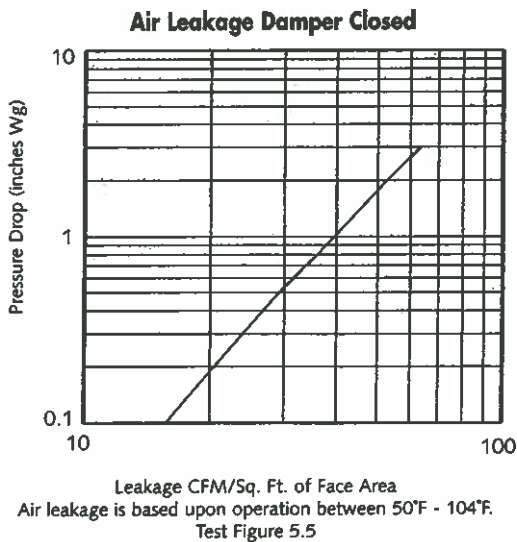



## RFD ROLL FORM ALUMINUM BACK DRAFT DAMPER

The RFD Roll Formed Back Draft Damper is the newest product available. It utilizes the same frame and reliable blade pivoting system as the BDD damper. The RFD uses a lighter roll formed blade design. It is ideal for roof top dome fans applications where the volume of air is low. The RFD is a value engineered alternative to the BDD systems.

### RECOMMENDED SPECIFICATION

Furnish and install RFD Roll Form damper as manufactured by Ventex Inc, Bolton Ontario or Ventex of America, Kissimmee Florida. Dampers shall be 2 3/4" (70 mm) deep when the blades are closed and 5 5/8" deep when the blades are open. Blades shall be 0.032" Roll Form Blades and frame shall be 0.062" (1.57 mm) extruded aluminum, alloy 6063-T5.

The blades must have vinyl edge seals integral to each blade. Linkage is to be concealed from the front view of the damper and cannot be mechanically fastened to the damper blades.

### STANDARD CONSTRUCTION

Depth: Blades Closed	2 3/4" (70 mm)
Depth: Blades Open	5 5/8" (143 mm)
Material	Extruded 6063-T5 Extruded Aluminum
Frame Thickness	0.062" (2.06 mm)
Frame Styles	Front Flange Frame specify "FFM", Flange Frame specify "FM", Duct Mount specify "DM"
Blade Thickness	0.032" Roll Form Blades
Blade Centres	3 3/4" (95 mm)
Seals	Vinyl Blade Seal
Minimum Height	9" (229 mm)
Maximum Panel Width	60" (1524 mm)
Standard Operation Method	Gravity

### ACCESSORIES

- Galvanized Birdscreen
- Conduit hole
- Mill finish only
- Insect screen 18 x 14 mesh

\*Note the roll formed damper is not available with a motor.





The Ventex MBD is our specially engineered motorized damper. Its design allows it to be used in either an exhaust or intake system. The damper blade pivots in the middle, which makes it easier to open, by balancing the positive and negative pressures on both sides of the blade. Traditional motorized dampers that have blades that pivot from the top, force the motor to work harder, because they have to overcome the negative pressure of an intake application. The advantage to the center pivot blade is the increased life expectancy of the motor. The design also gives the damper a high free area.



## STANDARD CONSTRUCTION

Depth: Blades Closed	6 3/4" (171 mm)
Depth: Blades Open	8 3/4" (222 mm)
Material	Extruded 6063-T5 Aluminum
Frame Thickness	0.062" (1.57 mm)
Frame Styles	Flange Mount 1 1/2" flange, specify "FM". Front Flange Mount 1 1/2" flange, specify "FFM". Duct Mount, specify "DM". All styles have mitred corners
Blade Thickness	0.062" (1.57 mm)
Blade Centres	3 3/4" (95 mm)
Minimum Height	8" (300 mm)
Maximum Panel Height	48" (1219 mm)
Maximum Panel Width	Single panel 40" (1016 mm) Double panel 60" (1524 mm) Double panel dampers require 2 motors
Standard Motor	Multi-Products Motor Series 2813 2 Position, External Spring Return UL & CSA Approved
Maximum Panel Size Per Motor	11.5 sq. ft.

## RECOMMENDED SPECIFICATION MOTORIZED DAMPER

Furnish and install MBD motorized damper as manufactured by Ventex Inc, Bolton Ontario or Ventex of America, Kissimmee Florida. Dampers shall be 6 3/4" (171 mm) deep when the blades are closed and 8 3/4" (222 mm) deep when the blades are open. Blades shall be 0.062" (1.57 mm) and frame shall be 0.062" (1.57 mm) extruded aluminum, alloy 6063-T5.

The blades must have vinyl edge seals integral to each blade. Linkage is to be concealed from the front view of the damper and cannot be mechanically fastened to the damper blades.

## ACCESSORIES

- Multi products motor packs (115 volt, 230 volt (single phase), 460 volt (single phase), & 24 volt AC)
- Belimo Motors available upon request. Consult Ventex for details
- Jack shafts to operate multiple sections with a single motor
- Conduit hole
- End switch
- Insect screen
- Galvanized birdscreen

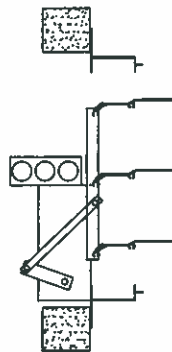

Flange Mount  
Rear Mount  
Motor Open

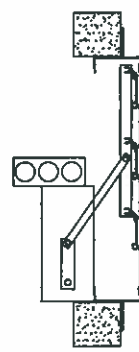

Front Flange Mount  
Rear Mount Motor  
Closed

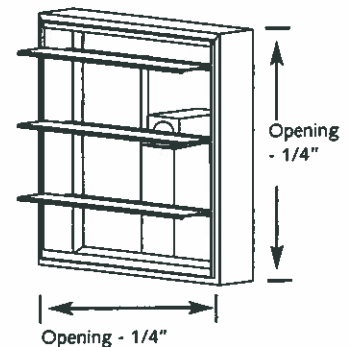

Channel Frame  
Rear Mount  
Motor Open



## MODEL DG – DOOR GRILLE

The Ventex door grille incorporates an inverted, rounded "Y" blade. The use of this blade provides 3 main benefits. The first is that the rounded shape of the blade keeps the closest points between the blades symmetrical and this maximizes available free area. The inverted "Y" shape also has a sight proof design and provides exceptional strength and protection against vandalism.

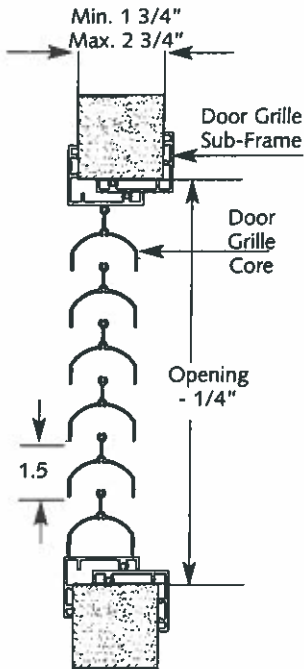

### STANDARD CONSTRUCTION

Depth Adjustable	Minimum 1 3/4" (44.5 mm) Maximum 2 3/4" (70.0 mm)
Material	Extruded 6063-T5 Aluminum
Frame Thickness	0.060" (1.52 mm)
Frame Styles	Double Side Flange Single Side Flange
Blade Thickness	0.060" (1.52 mm)
Blade Shape	Inverted "Y"
Blade Centres	1 1/2" (38.1 mm)
Minimum Height	8 1/4" (102 mm)
Maximum Panel Height	36" (914 mm)
Maximum Panel Width	36" (914 mm)
Standard Finish	Clear Anodized Finish

Number of Blades	Available Heights
3	8.25
4	9.75
5	11.25
6	12.75
7	14.25
8	15.75
9	17.25
10	18.75
11	20.25
12	21.75
13	23.25

### RECOMMENDED SPECIFICATION DOOR GRILLE

Furnish and install stationary door grille model DG as manufactured by Ventex Inc, Bolton Ontario or Ventex of America, Kissimmee Florida. The door grille shall be adjustable in depth from a minimum of 1 3/4" (45 mm) to a maximum depth of 2 3/4" (70 mm). Blades shall be 0.060" (1.52 mm) and frame shall be 0.060" (1.52 mm) extruded aluminum, alloy 6063-T5. The door grille shall have a standard clear anodized finish.





# VENTEX COLOR CHART

**Baked Enamel Finish For Louvers, Grilles & Vents**



The colors presented in this chart, were selected as a cross section of our most requested colors. They're representative of the colors used by major siding manufacturers and the most popular brick colors.

**NOTE:** (Color shown may vary slightly from the actual painted product.)

In addition to the colors shown, our standard colors include (samples available upon request).

#26 Light Bronze (simulated bronze)  
#28 Medium Bronze  
cost.

#40 Medium Dark Bronze  
#42 Dark Bronze

K70632 White  
Custom colors available at an extra

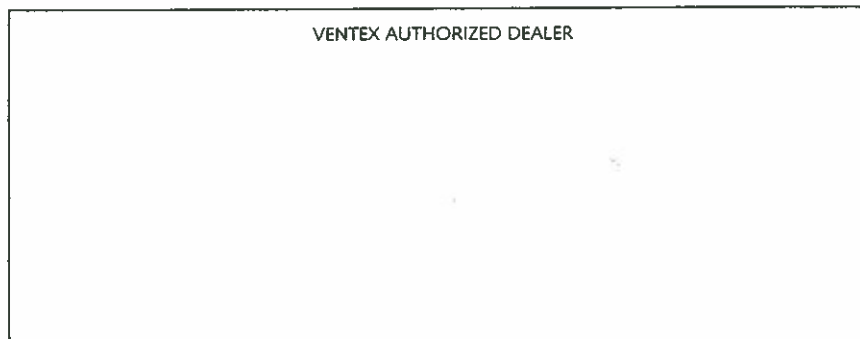

**Head Office**  
195 Healey Rd.  
Bolton, Ontario  
L7E 5B2



**USA Manufacturing Facility**  
2450 Smith St.  
Kissimmee, Florida  
34744

TEL: (905) 857-4700 FAX: (905) 857-4730  
NORTH AMERICA TOLL FREE: 1-800-668-7214 FAX: 1-888-891-6504  
www.ventexinc.com