

DTF系列地铁隧道轴流风机

DTF

系列地铁隧道轴流风机

60Hz

地址 (Add) : 浙江省绍兴市上虞区章镇工业园区
内销热线 (Tel) : 0575-82719999 82718888
82034999

传真 (Fax) : 0575-82719706 82034555
网址 (Http) : //www.jindunfan.com
邮箱 (E-mail) : jindun@zjfd.com.cn

海外代表办事处:

Overseas Representative Office
SSF国际商贸私人有限公司
SSF International Trade Pte.Ltd.
Tel: (65) 6754 5123 / 6754 0200
Fax: (65) 6754 6263
E-mail:ssfengrg@singnet.com.sg

DTF系列地铁隧道轴流风机 (60Hz) 2019年1月印刷
DTF Axial (60Hz). January 2019



目录

CATALOGUE

浙江金盾风机装备有限公司特此证明，此处所示 DTF (R) 和 DTF 轴流风机型号获得了加盖 AMCA 印章的授权。所示额定值系根据 AMCA 出版物 211 和 AMCA 出版物 3 1 1 所进行测试和程序确定，并符合 AMCA 认证额定值计划的要求。



Zhejiang Jindun Fans Equipment Co., Ltd. certifies that the DTF(R) and DTF vane axial fan shown herein are licensed to bear the AMCA seal. The ratings shown are based on tests and procedures performed in accordance with AMCA Publication 211 and AMCA Publication 311 and comply with the requirements of AMCA Certified Ratings Program.

一、DTF系列轴流风机类别、型式说明.....1	Classes and Type Description for DTF(R)-(H/S/V) Series Vane Axial Fan
二、DTF系列风机特点.....2	Characteristics of DTF Vane Axial Fan
三、DTF系列风机的形式.....3	Structure and Arrangement
四、DTF系列风机外形结构选择示意图.....4	Installation Sketch of DTF Series Fan
五、DTF系列风机外形图和外形尺寸.....7	Overall Drawing and Overall Dimension of DTF Series Fan
六、DTF系列轴流通风机性能曲线图、参数表.....10	Performance Curves and Data of DTF Vane Axial Fan



DTF 系列地铁隧道轴流式通风机

DTF SERIES VANE AXIAL FAN FOR METRO AND TUNNEL



DTF 系列轴流风机类别、形式说明

Classes and Type Description for DTF(R)-(H/S/V)Series Vane Axial Fan

(一) DTF 系列轴流风机分类

- DTF(R)-(H)型：排热风机（地铁称UPE/OTE风机）
- DTF(R)-(S)型：消防排烟风机（地铁称排烟风机）
- DTF(R)-(V)型：通风排风机（地铁称全新风机）

注：(R) = 反转风机

(二) DTF 系列轴流风机基本形式

名称	DTF(R)-(H)型	DTF(R)-(S)型	DTF(R)-(V)型
机号	10 ~ 22#	8 ~ 20#	8 ~ 22#
叶片角度	固定叶角 静态可调叶角	固定叶角 静态可调叶角	固定叶角 动态可调叶角
最高气体输送温度及连续运行时间	300℃60分钟 180℃大于2小时	300℃60分钟 180℃大于2小时	≤45℃
系统管道连接	风机与管道连接处可配橡胶软接管，也可根据用户要求提供扩压管。		
安装形式	分立式、卧式、吊挂式、侧壁式等形式。其中吊挂式安装风机限16#或配套电机75kW以下，侧壁式安装风机配套电机限22kW以下。		
电机转速	根据通风系统要求，风机配套电机分单速、双速二种，也可配变频调速。		
说明	1、DTF系列风机较大规格或较高线速度配有不同承重量的减振器； 2、DTF系列风机三种类型可在同一性能参数表或性能曲线图中选择。		

DTF(R)-(H/S/V) Series Vane Axial Fan Classes

- DTF(R)-(H) heat exhaust fan(UPE/OTE fan in the metro)
- DTF(R)-(S) fire smoke discharge fan (smoke fan in the metro)
- DTF(R)-(V) ventilation fan (fresh air fan in the metro)

NOTE: (R) = Reversible Fan

DTF(R)-(H/S/V) Series Vane Axial Fan Type

Name of type	DTF(R)-(H)	DTF(R)-(S)	DTF(R)-(V)
Fan size	10~22#	8~20#	8~22#
Blade angle	Fixed blade angle Stationary blade adjustable	Fixed blade angle Stationary blade adjustable	Fixed blade angle Rotary blade adjustable
Max. air temperature and continuous operating time	300℃ within 60 minutes 180℃ over 2 hour	300℃ within 60 minutes 180℃ over 2 hour	≤45℃
Connecting duct	Rubber flexible duct is available for connecting the fan to the duct, or diffuser is applied on the client's demands.		
Arrangement style	There are four arrangement style, i.g. Vertical, horizontal, hanging and wall arrangement according to the requirement of ventilation system. For hanging arrangement, size 16# or lower is available or the power of motor shall be lower than 75kW. For the motor power of the wall arrangement fan shall be lower than 22kW.		
Motor speed	According to the requirement of ventilation system, single speed or dual speed motor is applied, as well as frequency conversion device.		
Remarks	<ul style="list-style-type: none"> ● The vibration absorber with the different load is available for DTF series vane axial fan with large size or higher speed; ● Three types of DTF series fan can selected from the same performance parameters sheet and performance curve. 		

DTF 系列风机特点

Characteristics of DTF Vane Axial Fan

- **效率高**：风机运用国际最新航空航天气动设计技，通过多次反复试验验证和用户使用证明，具有效率高并高效区宽的显著特点；
- **噪声低**：从降低风机气动噪声入手，最大限度地减小风机叶片顶尖和根部的涡流损失，经权威专家鉴定，具有低噪声的显著特点；
- **用途广**：采用高防护等级、高绝缘等级、湿热型、耐高温电机，使该风机能可靠地应用于地铁、隧道、电力、水利大坝、建筑工程等通风系统的通（排）风，DTF(R)-(H)型，DTF(R)-(S)型风机还可以应用于紧急状态下的消防排烟系统和非消防排烟系统；
- **强度高**：风机叶轮引进国际先进压铸工艺技术，铝合金叶片、轮毂经金相分析，其组织结构良好，通过X光射线探伤检验，风机叶轮已考虑300℃条件下的热膨胀系数。使其保证足够的叶轮强度，符合高速运行的要求；
- **结构紧凑**：风机静叶和导流装置的设计以尽可能缩短风机外壳的长度为目标，机壳和固定支架通过有限元强度计算，以保证地铁、电力等特定条件的使用要求；
- **防喘振**：风机设有防喘振装置，避免风机在非设计工况下运行或多台风机并联安装单台使用时可能产生失速运行出现的喘振现象，无须再装喘振报警装置；
- **抗腐蚀性强**：风机外壳经热浸镀锌处理，电机采用湿热型，风机叶片、轮毂采用铝合金材料，成形后再经阳极化处理，具有很强的抗腐蚀性；
- **运行可靠**：风机叶轮经静平衡样验后再经动平衡机精确样验，其平衡精度达到ISO-2.8级（高于国家5.6级的标准），整机出厂前，经叶轮超速试验和整机振动测试、气动全性能试验，使其达到高速运行平稳、可靠的要求。

● **High efficiency**: To apply the newest aviation aerodynamic design technology, repeat test and inspection and prove the characteristics of high efficiency, wide high_efficiency range.

● **Low noise**: To reduce the aerodynamic noise of fan and minimize the whirlpool loss in the tip of blade and blade root.

● **Wide application**: DTF(R)-(H/S/V) vane axial fan is equipped with high protection glasses, high insulation degree, hot and humid type and high temperature resistant motor. So the fan is used for ventilation (exhaust) air in the ventilation system of metro, tunnel, electric power, large dam and construction engineering, as well as in the fire smoke discharge system or not fire smoke system under the emergency conditions.

● **Good strength**: Blades are cast in aluminum alloy. There is good radial structure for the aluminum alloy blades and hub. The thermal expansion factor of the fan impeller and casing detected by X laser is considered under the temperature of 300℃ to ensure the strength of impeller and high speed operation.

● **Compact structure**: To make the fan as compact as possible, the static blade of the fan and guide vane device is designed to minimize the length of the fan casing. The casing and support are made the finite element calculation to ensure the specific conditions in the metro and electric power station.

● **Anti-surge**: The fan is equipped with the anti-surge system, which prevent the surge caused by the possible over-speed operation of the fan under the non-design work conditions or only one fan is operating when the fan group is parallel connection. So the surge alarm is not necessary.

● **Good corrosion resistant**: Fan casing is hot dip galvanized. Motor is hot and humid type. Fan blades and hub is made of aluminum alloy.

● **Stable operation**: Fan impeller is balanced, balance precision up to ISO-2.8 (higher than national class 5.6). Over-speed test of the impeller, complete vibration test and aerodynamic performance test to reach the requirements of high speed stable operation prior to the factory.

风机由叶轮、电机、机壳、集（导）流器、固定支架、减振器等部件组成，分卧式安装和立式安装二种规格，又分单边连接和二边连接管道二种形式，如图一。

- **风机叶轮:** 由轮毂、叶片组成，其中风机叶片分固定、动调、静调三种方式，静调或动调叶片可在 -7.5° 至 7.5° 范围调节，动调风机又分气压式和电动式二种，可在运行状态下自动和电动调节叶片角度。
- **风机配套电机:** 根据使用要求配常规电机，特殊要求也可以配IP55（IP54）防护等级、H(F)级绝缘，耐高温，湿热型电机，接线盒置于风机外壳。
- **风机外壳的叶轮装配段:** 内壁经金属切削加工以保证控制叶片的径向间隙，长度和重量以降低到最低（小）值为目标进行设计。
- **风机导叶、集流器和导流器:** 分别为静态安装，以尽可能考虑最大的效能和最小的体积。
- **风机安装支架:** 确保风机整机强度的前提下，使其达到重量轻和安装方便。
- **风机固定叶角，静、动态可调叶角:** 固定叶角是指根据使用工况要求固定角度；静态可调是指设计工况与使用工况改变的情况下，停机后拧松叶柄螺栓，人工调节叶片角度；动态可调是指风机在运行状态下根据使用工况要求在允许范围内任意调节叶片角度。
- **防喘振装置:** 可以防止风机失速发生喘振的现象，保证风机长期在稳定状态下运行，如管道堵塞，消声器堵塞或紧急状态下，保证风机运行安全、可靠。
- **风机减振器:** 根据风机重量、线速度、固定叶角、静态可调叶角、动态可调叶角的动载荷进行专门设计计算，配置不同的减振器。
- **风机拆装维修:** 单边接管道的风机拆掉单边软接管，拧松底脚螺栓；双边接管道的风机应先拆掉二端软接管，拧松固定底脚螺栓和某端的空间段（或防喘振装置），即可任意移动风机位置。

The fans supplied as a complete unit consisting of impeller, motor, casing, guide vane unit, support, vi-bration absorber and so on. There are two arrangements of horizontal and vertical and two groups of sin-gle connection duct and dual connection ducts, referring to the figure 1.

- The impeller composes of hub and blades which has fixed blade, rotary blade adjustable and stationary blade adjustable ranging from -7.5° to $+7.5^{\circ}$. Rotary blade adjustable is made by pneumatic control and electric control to adjust the blade angle when operating, which supplies a gap in the home field.
- For motor, insulation class F or H will be applied, and protection classes IP54 and 55 are avail-able. The motors are high temperature resistant and hot/moisture type. The terminal box is mounted on the casing.
- For the design of the impeller section of the casing, to be sure the radial clearance of the blades and minimize the lenth and weight.
- To make the fan as compact as possible and maximize the efficiency, the guide vane, bell mouth and guide vane unit are the static parts.
- To ensure the strength of the complete fan unit, support shall be light and easy to installation.
- The fixed blade: blade angle shall be fixed to the impeller on the demands of work conditions. Rotary blade adjustable: the blade angle is adjusted manually after stopping the fan and loosening the bolts on the blade root. Stationary blade adjustable: the blade angle is adjustable for the operating fan according to the actual work conditions.
- Anti- surge system mounted is to prevent the surge caused by the over_speed operation of the fan to ensure the stable operation during long_term period time, especially safety and reliable operation under the conditions of the blocked duct or silencer is or the emergency.
- Vibration absorber is designed and calculated according to the fan weight, linear velocity and dy-namic load of the fixed blade angle, stationary blade angle and rotary blade angle.
- Dismounting and repair of fan: Remove the flexible duct connecting to the one end of the fan, and the foundation bolts, or remove the flexible ducts connecting to the both ends of the fan, the foun-dation bolts and space section (or anti_surge system), and then move the fan as to repair it.

(图一)DTF 系列风机卧式安装示意图 Horizontal arrangement for DTF series fan (refers to Fig.1)

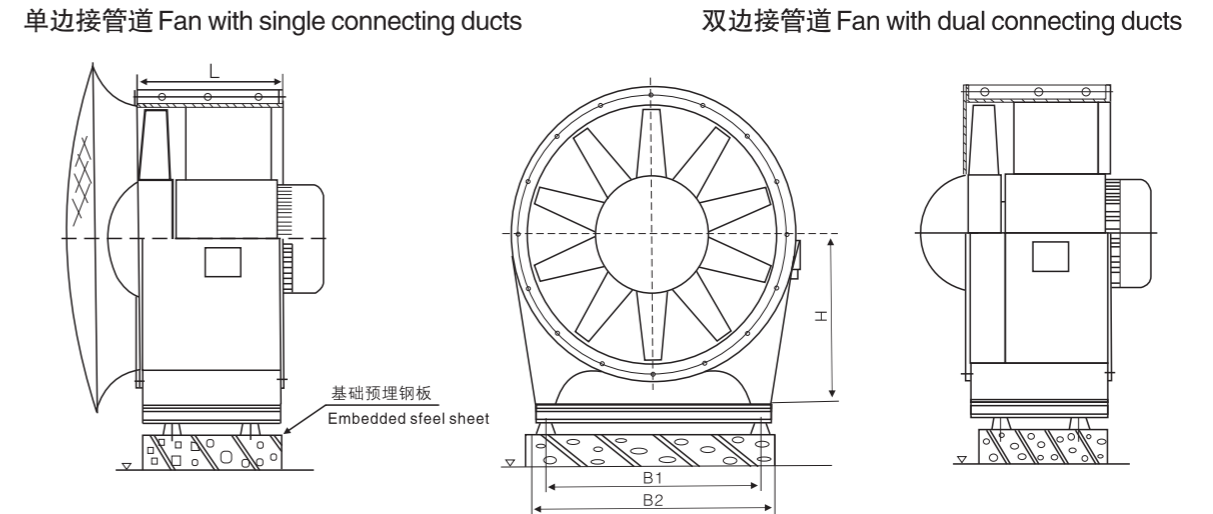

- 1、基础预埋钢板长度 $\geq L+100$ ，宽度 $\geq (B2-B1)/2+20$
- 2、风机重量请参照《风机性能参数表》，风机各支承点静（动）载荷请参照本公司提供的安装图。
- 3、风机外形尺寸参照外形尺寸图（表）。

- The length of the foundation embedded steel sheet is L plus 100 or more, width is $(B2-B1)/2+20$ or more . - For the fan weight, please refers to the Performance Data Sheet of the Fan. For the static dynamic load on the support point, refers to the installation drawing.

- Overall dimension of the fan, please refers to the overall dimension drawing.

(图二)DTF 系列风机立式安装示意图 Vertical arrangement for DTF series fan (refers to Fig.2)

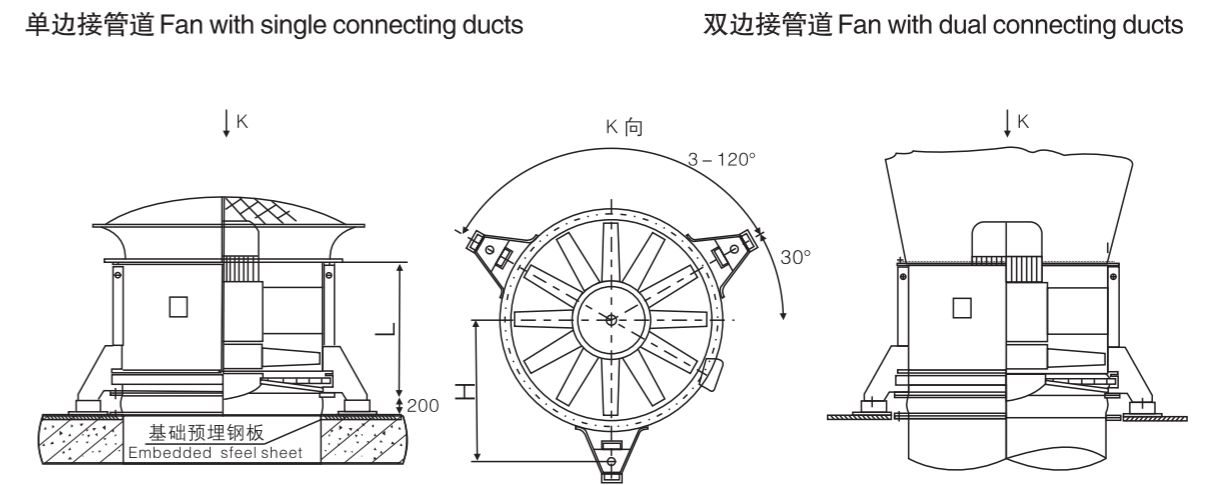

- 1、风机重量请参考《风机性能参数表》，风机各支承点静（动）载荷请参照本公司提供的安装图。
- 2、风机外形尺寸参照外形尺寸图（表），H值尺寸见下表：
- For the fan weight, please refers to the Performance Data Sheet of the Fan. For the static/dynamic load on the support point, refers to the installation drawing.
- Overall dimension of the fan, please refers to the overall dimension drawing. H value is showing in the following table.

机号 Size	12.5#	14#	16#	18#	20#	22#
H	840	965	1065	1160	1260	1410

(图三)DTF 系列风机吊挂式示意图

Hanging arrangement for DTF series fan(refers to Fig.3)

单边接管道 Fan with single connecting ducts

双边接管道 Fan with dual connecting ducts

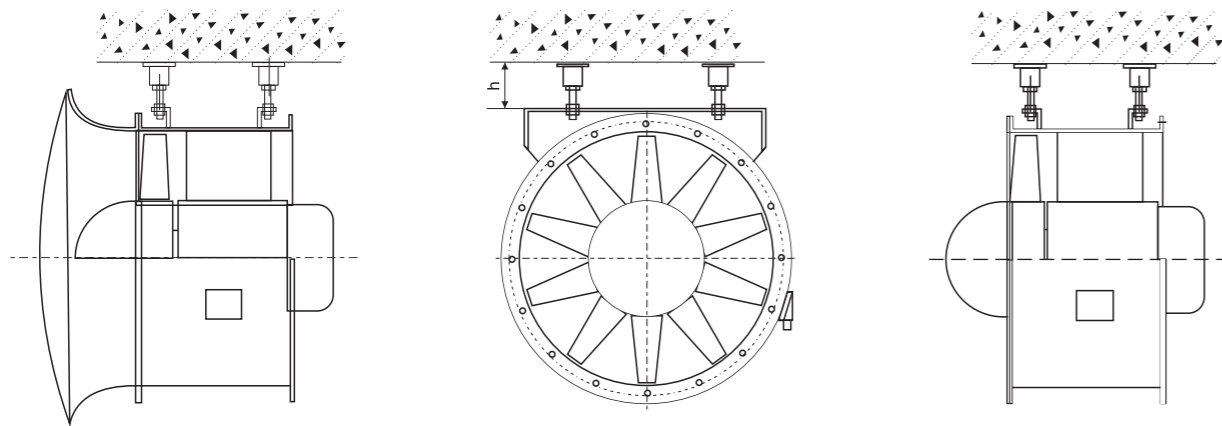

- 1、风机配用电机的功率大于75kW时，由于承受力的问题不宜采用吊挂式安装。
 - 2、h尺寸根据通风系统风管布置位置要求决定（由本公司提供现场安装图）。
 - 3、风机重量参照《风机性能参数表》，风机各支承点静（动）载荷请参照本公司提供的安装图。
 - 4、风机外形尺寸参照外形尺寸图（表）。
- If the motor power more than 75kW, hanging arrangement shall not be considered because of the sustain.
- h value shall be determined according to the layout of the air duct in the ventilation system, referring to the installation sketch.
- For the fan weight, please refers to the Performance Data Sheet of the Fan. For the static/dynamic load on the support point, refers to the installation drawing.
- Overall dimension of the fan, please refers to the overall dimension drawing.

(图四)DTF 系列风机侧墙壁式示意图

Wall arrangement for DTF series fan(refers to Fig.4)

- 1、当风机配用的电机功率大于22kW时，由于承受力的问题不宜采用侧墙式安装。
 - 2、安装平板长度大于L+100，宽度大于B+20。
 - 3、风机外形尺寸请参考外形尺寸图（表），风机重量请参考《风机性能参数表》。
 - 4、风机各支承点静（动）载荷请参照本公司提供的安装图。
- If the motor power more than 22kW, wall arrangement shall not be considered because of the sustain.
- The length of the plate is more than L+100, width of that is more than B+20.
- For the overall dimension of the fan, please refers to the overall dimension drawing. For the fan weight, please refers to the Performance Data Sheet of the Fan.
- For the static/dynamic load on the support point, refers to the installation drawing.

侧墙壁式安装可以单边接管道或双边接管道
For the wall arrangement, the fan is connecting to single duct or dual ducts

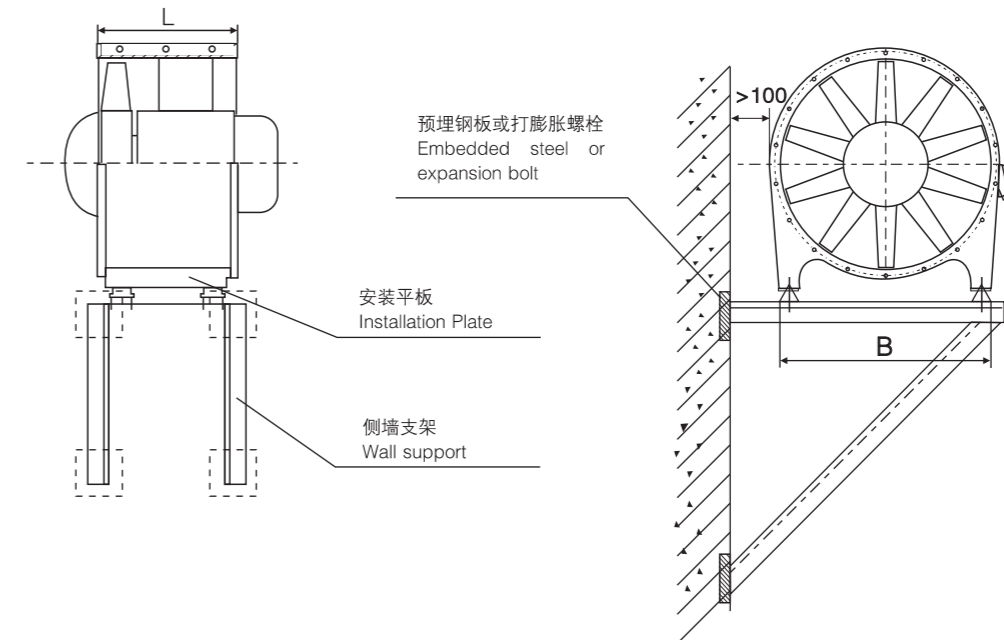

DTF 系列风机外形图和外形尺寸 Overall Drawing and Overall Dimension of DTF Series Fan

DTF(R)-(H)型轴流式通风机外形图 Overall Drawing of DTF(R)-(H) Fan

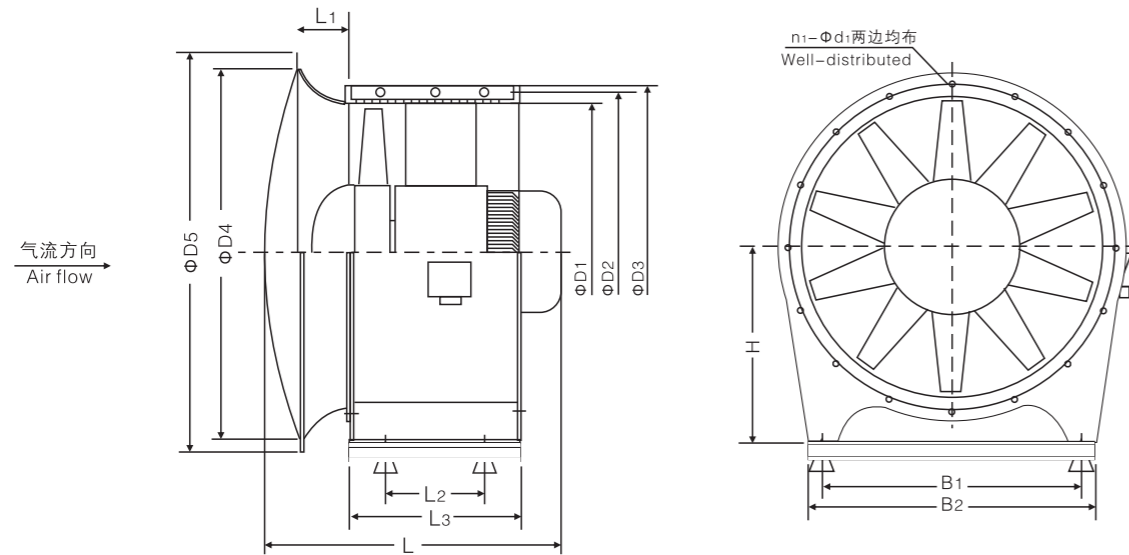

DTF(R)-(H)型轴流式通风机外形尺寸 Overall Dimension of DTF(R)-(H) Fan

Dimension 尺寸 机号 Size	D1	D2	D3	D4	D5	L1	L2	L3	L	H	B1	B2	n1-φd1
10	1010	1070	1110	1300	1335	250	490	650	1080	680	600	700	16-Φ14
11.2	1130	1200	1250	1420	1455	250	590	750	1250	730	970	1040	20-Φ14
12.5	1260	1330	1380	1550	1590	250	600	800	1360	800	1150	1250	20-Φ14
14	1410	1490	1550	1700	1740	250	680	900	1550	880	1280	1400	20-Φ14
15	1510	1590	1650	1900	1950	350	760	1000	1620	980	1320	1500	20-Φ18
16	1610	1700	1770	2000	2050	350	810	1050	1680	1050	1460	1600	24-Φ18
18	1812	1900	1972	2200	2250	350	850	1150	1960	1120	1680	1800	24-Φ18
20	2012	2100	2172	2530	2590	400	980	1300	2300	1165	1820	2000	28-Φ18
22	2216	2330	2416	2800	2900	400	1040	1400	2100	1265	2020	2200	32-Φ18

注：1、上表外形尺寸是指最大的外形尺寸，如通风系统有特殊要求时，风机外壳可适当缩短或伸长；
2、当通风系统需带防喘振装置时，则风机外壳长度应适当增加。

Remarks:

1. The maximum overall dimension is showing in the above table. The length of the fan casing is changeable on the demands of the ventilation system.
2. If the fan with anti_surge system is needed, the length of the fan casing shall be longer than the normal.

DTF 系列风机外形图和外形尺寸 Overall Drawing and Overall Dimension of DTF Series Fan

DTF(R)-(V)型轴流式通风机外形图 Overall Drawing of DTF(R)-(V) Fan

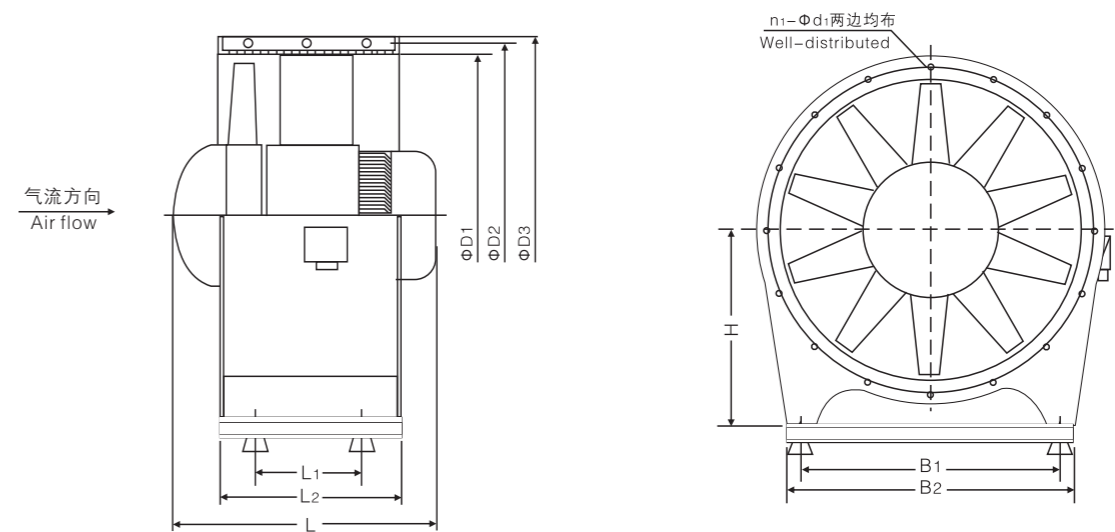

DTF(R)-(V)型轴流式通风机外形尺寸 Overall Dimension of DTF(R)-(V) Fan

Dimension 尺寸 机号 Size	D1	D2	D3	L1	L2	L	H	B1	B2	n1-φd1
8	810	870	910	380	500	650	490	500	600	16-Φ14
9	910	970	1010	460	600	750	540	600	700	16-Φ14
10	1010	1070	1110	490	650	850	600	600	700	16-Φ14
11.2	1130	1200	1250	590	750	1000	660	970	1040	20-Φ14
12.5	1260	1330	1380	700	900	1200	715	1150	1250	20-Φ14
14	1410	1490	1550	750	1000	1450	790	1280	1400	20-Φ14
15	1510	1590	1650	850	1100	1450	850	1320	1500	20-Φ18
16	1610	1700	1770	900	1200	1500	910	1460	1600	24-Φ18
18	1812	1900	1972	1050	1400	1800	1050	1680	1800	24-Φ18
20	2012	2100	2172	1150	1500	2100	1165	1820	2000	28-Φ18
22	2216	2330	2416	1250	1650	1950	1265	2020	2200	32-Φ18

注：1、上表外形尺寸是指最大的外形尺寸，如通风系统有特殊要求时，风机外壳可适当缩短或伸长；
2、当通风系统需带防喘振装置时，则风机外壳长度应适当增加。

Remarks:

1. The maximum overall dimension is showing in the above table. The length of the fan casing is changeable on the demands of the ventilation system.
2. If the fan with anti_surge system is needed, the length of the fan casing shall be longer than the normal.

DTF 系列风机外形图和外形尺寸

Overall Drawing and Overall Dimension of DTF Series Fan

DTF(R)-(S)型轴流式通风机外形图 Overall Drawing of DTF(R)-(S) Fan

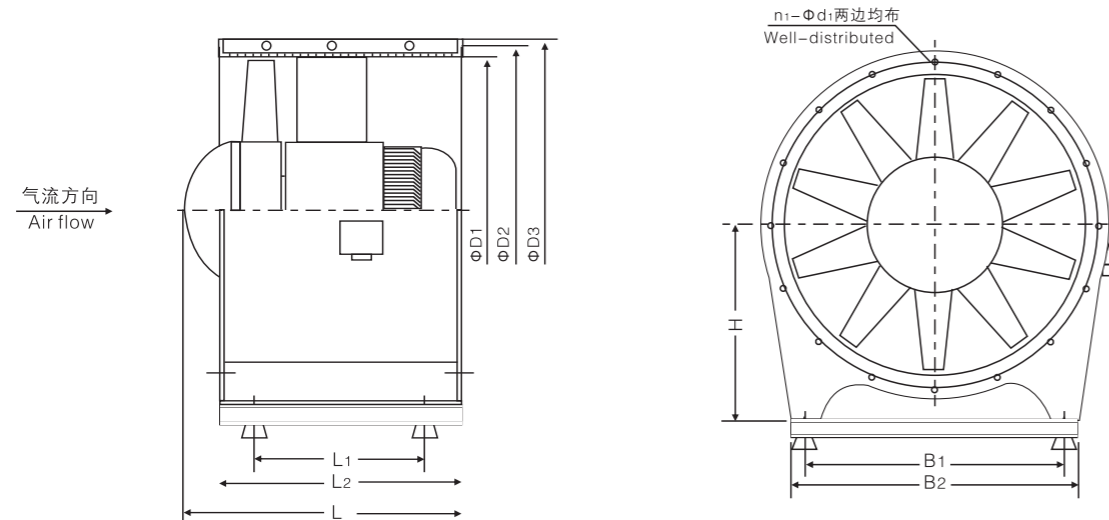

DTF(R)-(S)型轴流式通风机外形尺寸 Overall Dimension of DTF(R)-(S) Fan

Dimension 机号 Size	D1	D2	D3	L1	L2	L	H	B1	B2	n1-φd1
8	810	870	910	420	620	700	488	500	600	16-Φ14
9	910	970	1010	480	680	780	538	600	700	16-Φ14
10	1010	1070	1110	560	780	880	600	600	700	16-Φ14
11.2	1130	1200	1250	700	950	1100	660	970	1040	20-Φ14
12.5	1260	1330	1380	860	1100	1260	715	1150	1250	20-Φ14
14	1410	1490	1550	1110	1350	1520	790	1280	1400	20-Φ14
15	1510	1590	1650	1110	1350	1560	850	1320	1500	20-Φ18
16	1610	1700	1770	1110	1350	1560	940	1460	1600	24-Φ18
18	1812	1900	1972	1250	1550	1790	1050	1680	1800	24-Φ18
20	2012	2100	2172	1450	1750	2000	1165	1820	2000	28-Φ18

注：1、上表外形尺寸是指最大的外形尺寸，如通风系统有特殊要求时，风机外壳可适当缩短或伸长；

2、当通风系统需带防喘振装置时，则风机外壳长度应适当增加。

Remarks:

1. The maximum overall dimension is showing in the above table. The length of the fan casing is changeable on the demands of the ventilation system.

2. If the fan with anti_surge system is needed, the length of the fan casing shall be longer than the normal.

DTF 系列轴流通风机性能曲线图、参数表

Performance Curves and Data of DTF Vane Axial Fan

DTF(R)-8(S/V)-4P轴流通风机性能曲线、参数表（没有防喘圈）

FEG 60

Performance Curves and Data of DTF(R)-8 (S/V) -4P Vane Axial Fan (without anti-stall ring)

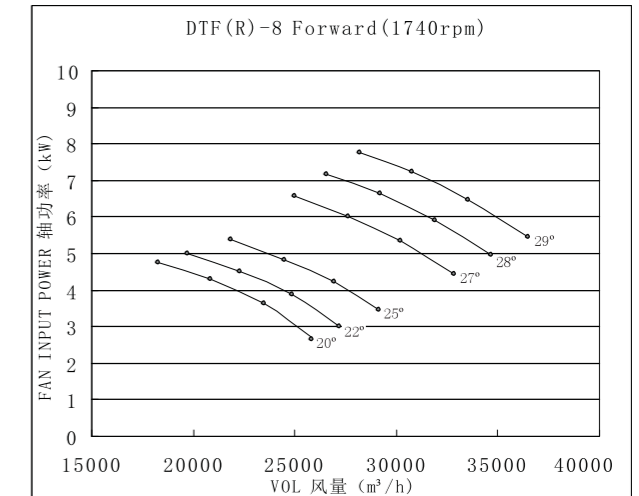
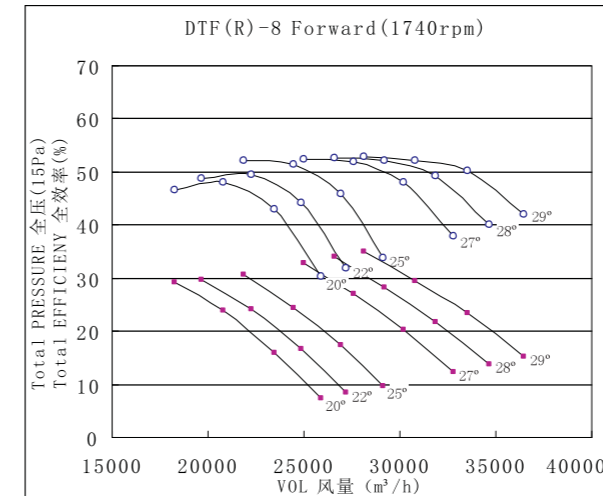

安装角 Pitch	工况点 Work Point	风量 Flow Rate (m³/h)	全压 Total Pressure (Pa)	轴功率 Shaft Power (kW)	电机型号 装机容量 Motor Size Power (kW)	总声功率级 Sound Power Level (dB)	重量Weight(kg)		
							风机 Fan excl. motor	电机 motor	运行时 Operating
20°	1	23453	240	3.63	Y132M-4 7.5	105	100	81	272
	2	20818	359	4.30		106			
	3	18248	438	4.75		109			
22°	1	24848	249	3.88	Y132M-4 7.5	106	100	81	272
	2	22289	361	4.51		107			
	3	19696	447	5.00		109			
25°	1	26940	261	4.25	Y132M-4 7.5	108	100	81	272
	2	24494	364	4.82		107			
	3	21868	461	5.37		109			
27°	1	30231	305	5.36	Y160M-4 11	109	100	124	336
	2	27631	404	6.03		108			
	3	25015	493	6.57		109			
28°	1	31877	328	5.92	Y160M-4 11	109	100	124	336
	2	29199	424	6.64		108			
	3	26589	509	7.16		109			
29°	1	33523	350	6.47	Y160M-4 11	109	100	124	336
	2	30767	444	7.24		109			
	3	28162	526	7.76		109			

各项性能额定值不包括附属物（附件）的影响。经认证的性能是D类安装-管道入口，管道出口。所示值为安装类型D：管道入口，管道出口的声功率级（入口Lwi）。额定值包括管道端部校正影响。所示声功率级额定值以分贝为单位，参考声功率为10⁻¹²瓦，按照AMCA International 标准301计算。

Performance ratings do not include the effects of appurtenances (accessories). Performance certified is for installation type D:Ducted inlet, Ducted outlet . Values shown are for inlet Lwi sound. Power levels for installation type D:Ductedinlet, Ducted outlet. Ratings include the effects of duct end correction.

The sound power level ratings shown are in decibels, referred to 10⁻¹² watts, calculated per AMCA International Standard 301.

The sound power level ratings shown are in decibels, referred to 10⁻¹² watts, calculated per AMCA International Standard 301.

DTF 系列轴流通风机性能曲线图、参数表 Performance Curves and Data of DTF Vane Axial Fan

DTF(R)-8(S/V)-6P轴流通风机性能曲线、参数表 (没有防喘圈)

FEG 60

Performance Curves and Data of DTF(R)-8(S/V)-6P Vane Axial Fan (without anti-stall ring)

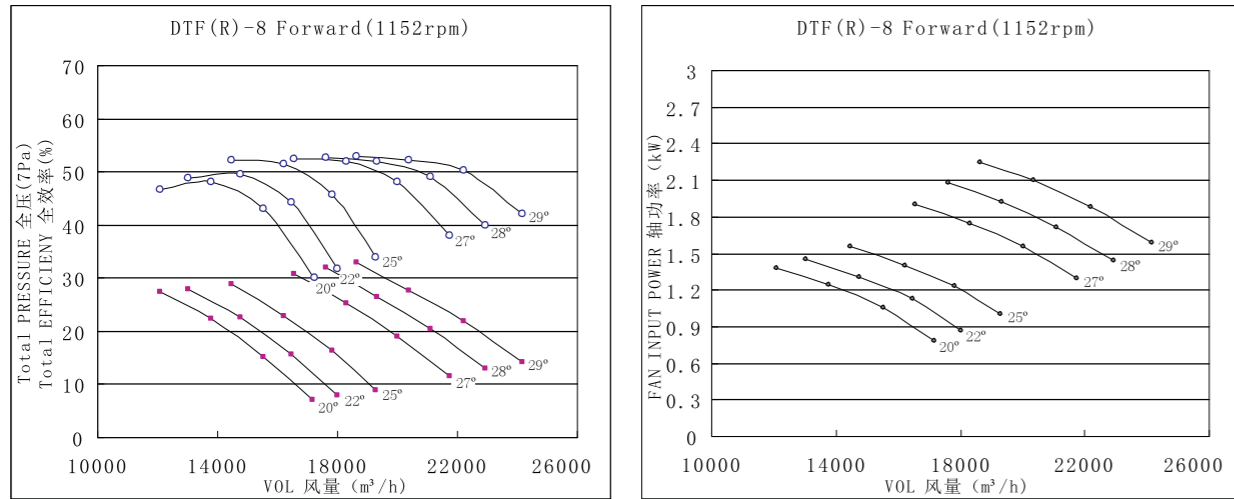

安装角 Pitch	工况点 Work Point	风量 Flow Rate (m³/h)	全压 Total Pressure (Pa)	轴功率 Shaft Power (kW)	电机型号 装机容量 Motor Size Power (kW)	总声功率级 Sound Power Level (dB)	重量Weight(kg)		
							风机 Fan excl. motor	电机 motor	运行时 Operating
20°	1	15528	105	1.05	Y112M-6 2.2	95	100	45	218
	2	13783	157	1.25		97			
	3	12081	192	1.38		99			
22°	1	16451	109	1.13	Y112M-6 2.2	96	100	45	218
	2	14757	158	1.31		97			
	3	13040	196	1.45		99			
25°	1	17836	114	1.23	Y112M-6 2.2	98	100	45	218
	2	16217	160	1.40		97			
	3	14478	202	1.56		99			
27°	1	20015	134	1.56	Y132S-6 3	99	100	63	245
	2	18293	177	1.75		98			
	3	16562	216	1.91		99			
28°	1	21105	144	1.72	Y132S-6 3	99	100	63	245
	2	19332	186	1.93		98			
	3	17603	223	2.08		99			
29°	1	22195	153	1.88	Y132S-6 3	99	100	63	245
	2	20370	194	2.10		99			
	3	18645	230	2.25		99			

各项性能额定值不包括附属物（附件）的影响。经认证的性能是D类安装-管道入口，管道出口。所示值为安装类型D：管道入口，管道出口的声功率级（入口Lwi）。额定值包括管道端部校正影响。所示声功率级额定值以分贝为单位，参考声功率为10⁻¹²瓦，按照AMCA International 标准301计算。

Performance ratings do not include the effects of appurtenances (accessories). Performance certified is for installation type D:Ducted inlet, Ducted outlet. Values shown are for inlet Lwi sound. Power levels for installation type D:Ductedinlet, Ducted outlet. Ratings include the effects of duct end correction.

The sound power level ratings shown are in decibels, referred to 10⁻¹² watts, calculated per AMCA International Standard 301.

DTF 系列轴流通风机性能曲线图、参数表 Performance Curves and Data of DTF Vane Axial Fan

DTF(R)-8(S/V)-4P轴流通风机性能曲线、参数表 (没有防喘圈)

FEG 60

Performance Curves and Data of DTF(R)-8(S/V)-4P Vane Axial Fan (without anti-stall ring)

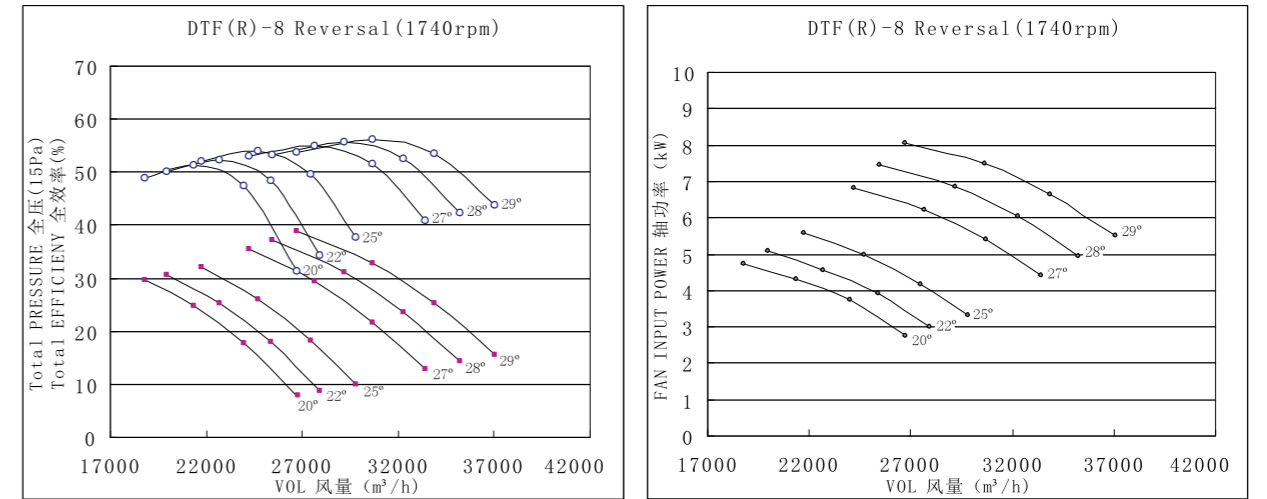

安装角 Pitch	工况点 Work Point	风量 Flow Rate (m³/h)	全压 Total Pressure (Pa)	轴功率 Shaft Power (kW)	电机型号 装机容量 Motor Size Power (kW)	总声功率级 Sound Power Level (dB)	重量Weight(kg)		
							风机 Fan excl. motor	电机 motor	运行时 Operating
20°	1	24002	266	3.74	Y132M-4 7.5	106	100	81	272
	2	21349	372	4.30		107			
	3	18779	444	4.74		109			
22°	1	25396	269	3.92	Y132M-4 7.5	107	100	81	272
	2	22696	379	4.57		108			
	3	19959	458	5.07		110			
25°	1	27488	272	4.18	Y132M-4 7.5	108	100	81	272
	2	24715	390	4.97		108			
	3	21730	481	5.57		111			
27°	1	30678	325	5.41	Y160M-4 11	108	100	124	336
	2	27685	442	6.23		108			
	3	24224	533	6.82		111			
28°	1	32274	352	6.03	Y160M-4 11	108	100	124	336
	2	29170	468	6.86		108			
	3	25472	559	7.45		110			
29°	1	33869	379	6.64	Y160M-4 11	108	100	124	336
	2	30655	494	7.48		108			
	3	26719	585	8.07		110			

各项性能额定值不包括附属物（附件）的影响。经认证的性能是D类安装-管道入口，管道出口。所示值为安装类型D：管道入口，管道出口的声功率级（入口Lwi）。额定值包括管道端部校正影响。所示声功率级额定值以分贝为单位，参考声功率为10⁻¹²瓦，按照AMCA International 标准301计算。

Performance ratings do not include the effects of appurtenances (accessories). Performance certified is for installation type D:Ducted inlet, Ducted outlet. Values shown are for inlet Lwi sound. Power levels for installation type D:Ductedinlet, Ducted outlet. Ratings include the effects of duct end correction.

The sound power level ratings shown are in decibels, referred to 10⁻¹² watts, calculated per AMCA International Standard 301.

DTF 系列轴流通风机性能曲线图、参数表 Performance Curves and Data of DTF Vane Axial Fan

DTF(R)-8(S/V)-6P轴流通风机性能曲线、参数表（没有防喘圈）

FEG 60

Performance Curves and Data of DTF(R)-8(S/V)-6P Vane Axial Fan (without anti-stall ring)

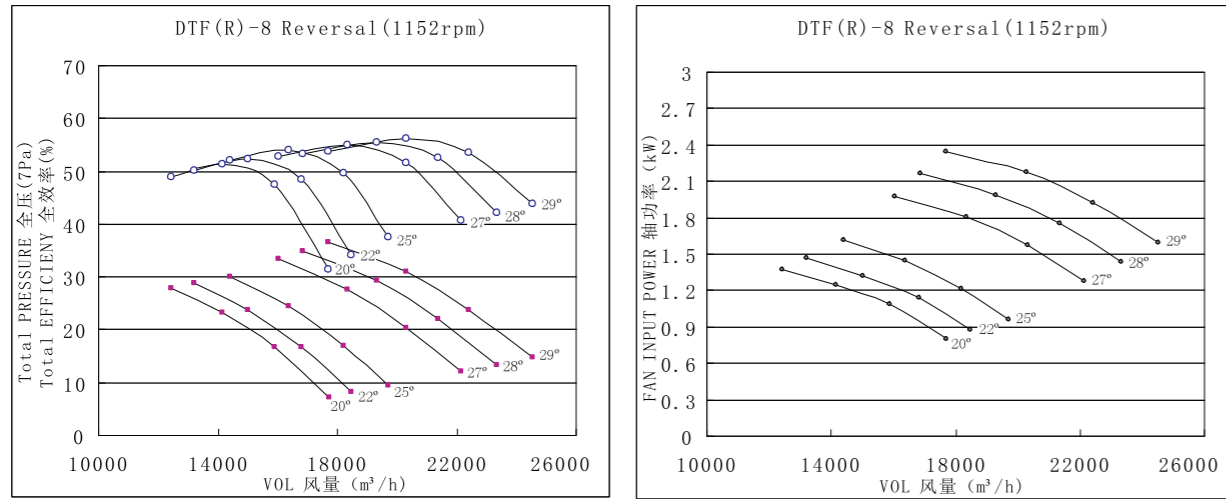

安装角 Pitch	工况点 Work Point	风量 Flow Rate (m³/h)	全压 Total Pressure (Pa)	轴功率 Shaft Power (kW)	电机型号 装机容量 Motor Size Power (kW)	总声功率级 Sound Power Level (dB)	重量Weight(kg)		
							风机 Fan excl. motor	电机 motor	运行时 Operating
20°	1	15891	117	1.09	Y112M-6 2.2	96	100	45	218
	2	14135	163	1.25		97			
	3	12433	194	1.38		99			
22°	1	16814	118	1.14	Y112M-6 2.2	97	100	45	218
	2	15026	166	1.33		98			
	3	13214	201	1.47		100			
25°	1	18199	119	1.21	Y112M-6 2.2	98	100	45	218
	2	16363	171	1.44		98			
	3	14386	211	1.62		101			
27°	1	20311	143	1.57	Y132S-6 3	98	100	63	245
	2	18329	194	1.81		98			
	3	16038	234	1.98		101			
28°	1	21367	154	1.75	Y132S-6 3	98	100	63	245
	2	19312	205	1.99		98			
	3	16864	245	2.16		101			
29°	1	22423	166	1.93	Y132S-6 3	98	100	63	245
	2	20296	217	2.17		98			
	3	17690	256	2.34		101			

各项性能额定值不包括附属物（附件）的影响。经认证的性能是D类安装-管道入口，管道出口。所示值为安装类型D：管道入口，管道出口的声功率级（入口Lwi）。额定值包括管道端部校正影响。所示声功率级额定值以分贝为单位，参考声功率为10⁻¹²瓦，按照AMCA International 标准301计算。

Performance ratings do not include the effects of appurtenances (accessories). Performance certified is for installation type D:Ducted inlet, Ducted outlet

. Values shown are for inlet Lwi sound. Power levels for installation type D:Ductedinlet, Ducted outlet. Ratings include the effects of duct end correction.

The sound power level ratings shown are in decibels, referred to 10⁻¹² watts, calculated per AMCA International Standard 301.

DTF 系列轴流通风机性能曲线图、参数表 Performance Curves and Data of DTF Vane Axial Fan

DTF(R)-9(S/V)-4P轴流通风机性能曲线、参数表（没有防喘圈）

FEG 60

Performance Curves and Data of DTF(R)-9(S/V)-4P Vane Axial Fan (without anti-stall ring)

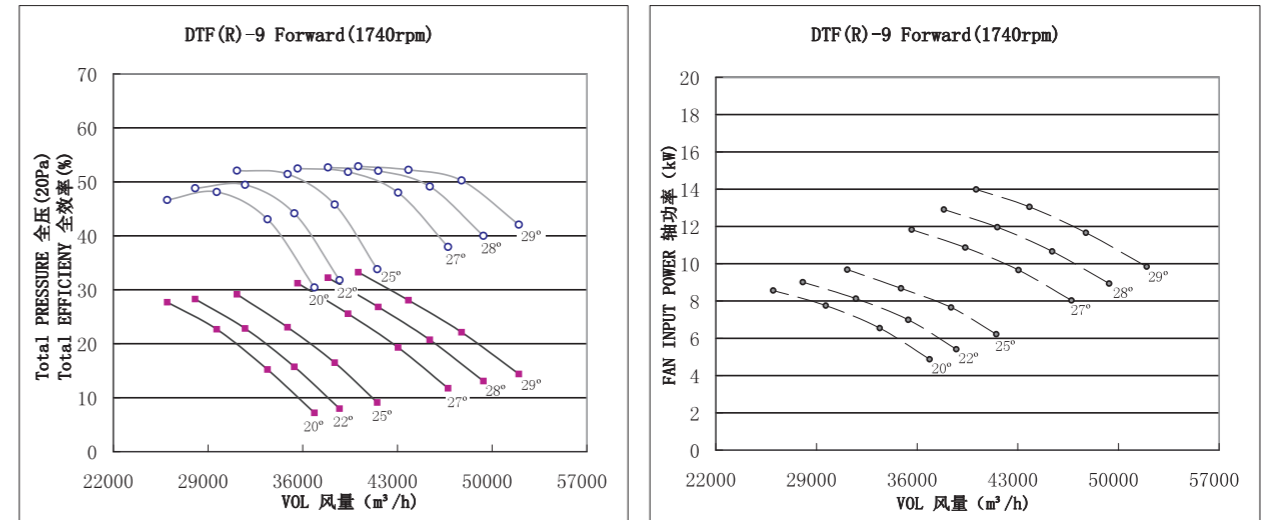

安装角 Pitch	工况点 Work Point	风量 Flow Rate (m³/h)	全压 Total Pressure (Pa)	轴功率 Shaft Power (kW)	电机型号 装机容量 Motor Size Power (kW)	总声功率级 Sound Power Level (dB)	重量Weight(kg)		
							风机 Fan excl. motor	电机 motor	运行时 Operating
20°	1	33393	304	6.55	Y160M-4 11	108	130	124	381
	2	29641	454	7.75		110			
	3	25982	554	8.56		113			
22°	1	35379	315	6.99	Y160M-4 11	110	130	124	381
	2	31735	457	8.12		110			
	3	28043	566	9.01		113			
25°	1	38357	330	7.65	Y160L-4 15	112	130	144	411
	2	34876	461	8.68		111			
	3	31136	583	9.68		113			
27°	1	43044	386	9.66	Y160L-4 15	112	130	144	411
	2	39341	511	10.87		112			
	3	35617	624	11.83		112			
28°	1	45388	415	10.66	Y160L-4 15	113	130	144	411
	2	41574	536	11.96		112			
	3	37857	645	12.91		112			
29°	1	47731	443	11.66	Y180M-4 18.5	113	130	173	455
	2	43807	561	13.05		112			
	3	40098	665	13.98		112			

各项性能额定值不包括附属物（附件）的影响。经认证的性能是D类安装-管道入口，管道出口。所示值为安装类型D：管道入口，管道出口的声功率级（入口Lwi）。额定值包括管道端部校正影响。所示声功率级额定值以分贝为单位，参考声功率为10⁻¹²瓦，按照AMCA International 标准301计算。

Performance ratings do not include the effects of appurtenances (accessories). Performance certified is for installation type D:Ducted inlet, Ducted outlet

. Values shown are for inlet Lwi sound. Power levels for installation type D:Ductedinlet, Ducted outlet. Ratings include the effects of duct end correction.

The sound power level ratings shown are in decibels, referred to 10⁻¹² watts, calculated per AMCA International Standard 301.

DTF 系列轴流通风机性能曲线图、参数表 Performance Curves and Data of DTF Vane Axial Fan

DTF(R)-9(S/V)-6P轴流通风机性能曲线、参数表 (没有防喘圈) **FEG 60**

Performance Curves and Data of DTF(R)-9(S/V)-6P Vane Axial Fan (without anti-stall ring)

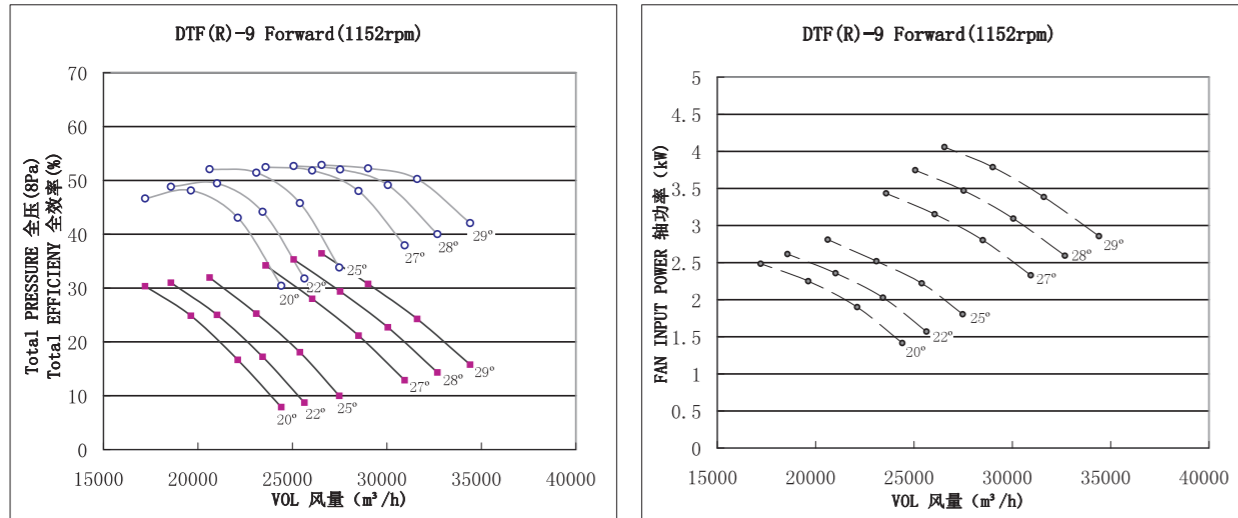

安装角 Pitch	工况点 Work Point	风量 Flow Rate (m³/h)	全压 Total Pressure (Pa)	轴功率 Shaft Power (kW)	电机型号 装机容量 Motor Size Power (kW)	总声功率级 Sound Power Level (dB)	重量Weight(kg)		
							风机 Fan excl. motor	电机 motor	运行时 Operating
20°	1	22109	133	1.90	Y132S-6 3	99	130	63	290
	2	19625	199	2.25		100			
	3	17202	243	2.49		103			
22°	1	23423	138	2.03	Y132S-6 3	100	130	63	290
	2	21011	200	2.36		101			
	3	18567	248	2.62		103			
25°	1	25395	145	2.22	Y132M1-6 4	102	130	73	305
	2	23090	202	2.52		101			
	3	20614	256	2.81		103			
27°	1	28498	169	2.80	Y132M1-6 4	102	130	73	305
	2	26047	224	3.15		102			
	3	23581	274	3.43		103			
28°	1	30050	182	3.09	Y132M2-6 5.5	103	130	84	321
	2	27525	235	3.47		102			
	3	25064	283	3.75		102			
29°	1	31601	194	3.39	Y132M2-6 5.5	103	130	84	321
	2	29003	246	3.79		102			
	3	26548	292	4.06		102			

各项性能额定值不包括附属物（附件）的影响。经认证的性能是D类安装-管道入口，管道出口。所示值为安装类型D：管道入口，管道出口的声功率级（入口Lwi）。额定值包括管道端部校正影响。所示声功率级额定值以分贝为单位，参考声功率为10⁻¹²瓦，按照AMCA International 标准301计算。

Performance ratings do not include the effects of appurtenances (accessories). Performance certified is for installation type D:Ducted inlet, Ducted outlet. Values shown are for inlet Lwi sound. Power levels for installation type D:Ductedinlet, Ducted outlet. Ratings include the effects of duct end correction.

The sound power level ratings shown are in decibels, referred to 10⁻¹² watts, calculated per AMCA International Standard 301.

DTF 系列轴流通风机性能曲线图、参数表 Performance Curves and Data of DTF Vane Axial Fan

DTF(R)-9(S/V)-4P轴流通风机性能曲线、参数表 (没有防喘圈) **FEG 60**

Performance Curves and Data of DTF(R)-9(S/V)-4P Vane Axial Fan (without anti-stall ring)

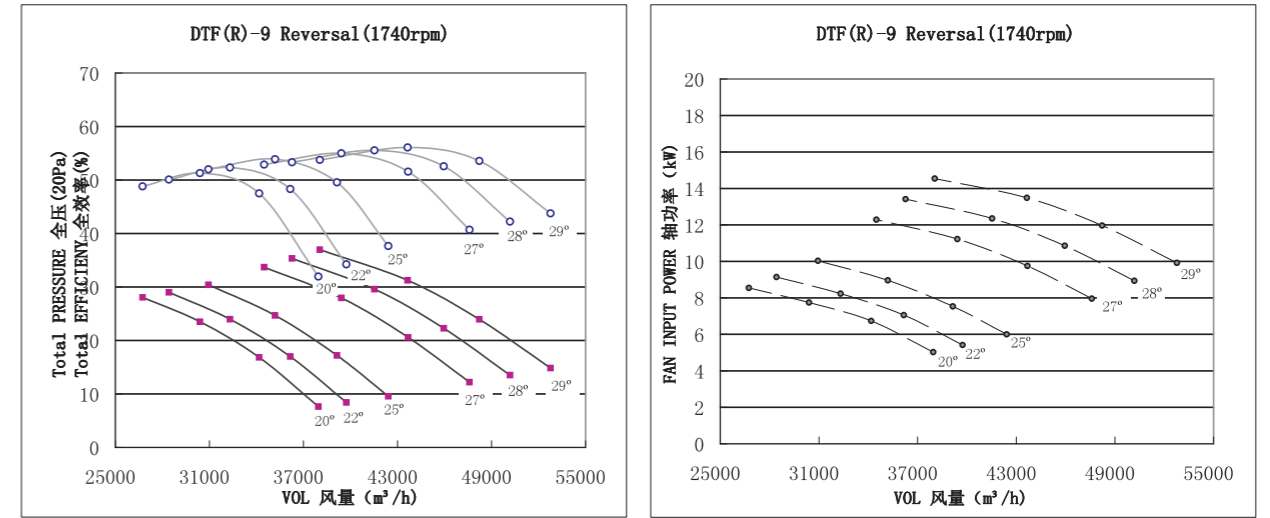

安装角 Pitch	工况点 Work Point	风量 Flow Rate (m³/h)	全压 Total Pressure (Pa)	轴功率 Shaft Power (kW)	电机型号 装机容量 Motor Size Power (kW)	总声功率级 Sound Power Level (dB)	重量Weight(kg)		
							风机 Fan excl. motor	电机 motor	运行时 Operating
20°	1	34175	337	6.74	Y160M-4 11	110	130	124	381
	2	30398	470	7.74		111			
	3	26738	561	8.55		112			
22°	1	36160	340	7.06	Y160M-4 11	110	130	124	381
	2	32315	480	8.23		111			
	3	28419	580	9.14		113			
25°	1	39138	344	7.54	Y160L-4 15	112	130	144	411
	2	35190	494	8.96		112			
	3	30939	609	10.04		114			
27°	1	43681	412	9.75	Y160L-4 15	112	130	144	411
	2	39418	560	11.22		112			
	3	34491	674	12.29		114			
28°	1	45952	446	10.86	Y180M-4 18.5	112	130	173	455
	2	41533	592	12.36		111			
	3	36267	707	13.42		114			
29°	1	48223	479	11.97	Y180M-4 18.5	112	130	173	455
	2	43647	625	13.49		111			
	3	38044	740	14.55		114			

各项性能额定值不包括附属物（附件）的影响。经认证的性能是D类安装-管道入口，管道出口。所示值为安装类型D：管道入口，管道出口的声功率级（入口Lwi）。额定值包括管道端部校正影响。所示声功率级额定值以分贝为单位，参考声功率为10⁻¹²瓦，按照AMCA International 标准301计算。

Performance ratings do not include the effects of appurtenances (accessories). Performance certified is for installation type D:Ducted inlet, Ducted outlet. Values shown are for inlet Lwi sound. Power levels for installation type D:Ductedinlet, Ducted outlet. Ratings include the effects of duct end correction.

The sound power level ratings shown are in decibels, referred to 10⁻¹² watts, calculated per AMCA International Standard 301.

DTF 系列轴流通风机性能曲线图、参数表 Performance Curves and Data of DTF Vane Axial Fan

DTF(R)-9(S/V)-6P轴流通风机性能曲线、参数表 (没有防喘圈)

FEG 60

Performance Curves and Data of DTF(R)-9 (S/V) -6P Vane Axial Fan (without anti-stall ring)

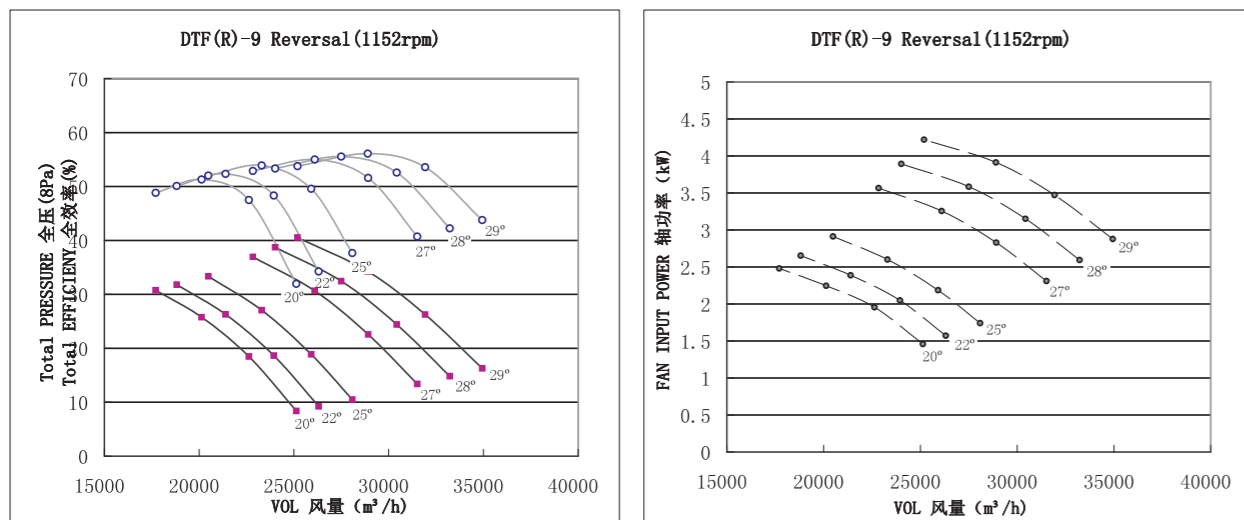

安装角 Pitch	工况点 Work Point	风量 Flow Rate (m³/h)	全压 Total Pressure (Pa)	轴功率 Shaft Power (kW)	电机型号 装机容量 Motor Size Power (kW)	总声功率级 Sound Power Level (dB)	重量Weight(kg)		
							风机 Fan excl. motor	电机 motor	运行时 Operating
20°	1	22626	148	1.96	Y132S-6 3	100	130	63	290
	2	20126	206	2.25		101			
	3	17702	246	2.48		103			
22°	1	23941	149	2.05	Y132S-6 3	101	130	63	290
	2	21394	210	2.39		101			
	3	18815	254	2.65		103			
25°	1	25912	151	2.19	Y132M1-6 4	102	130	73	305
	2	23298	216	2.60		102			
	3	20484	267	2.91		105			
27°	1	28920	181	2.83	Y132M2-6 5.5	102	130	84	321
	2	26098	245	3.26		102			
	3	22836	296	3.57		104			
28°	1	30423	195	3.15	Y132M2-6 5.5	102	130	84	321
	2	27497	260	3.59		102			
	3	24012	310	3.89		104			
29°	1	31927	210	3.47	Y132M2-6 5.5	102	130	84	321
	2	28897	274	3.91		102			
	3	25187	324	4.22		104			

各项性能额定值不包括附属物（附件）的影响。经认证的性能是D类安装-管道入口，管道出口。所示值为安装类型D：管道入口，管道出口的声功率级（入口Lwi）。额定值包括管道端部校正影响。所示声功率级额定值以分贝为单位，参考声功率为10⁻¹²瓦，按照AMCA International 标准301计算。

Performance ratings do not include the effects of appurtenances (accessories). Performance certified is for installation type D:Ducted inlet, Ducted outlet

. Values shown are for inlet Lwi sound. Power levels for installation type D:Ductedinlet, Ducted outlet. Ratings include the effects of duct end correction.

The sound power level ratings shown are in decibels, referred to 10⁻¹² watts, calculated per AMCA International Standard 301.

DTF 系列轴流通风机性能曲线图、参数表 Performance Curves and Data of DTF Vane Axial Fan

DTF-10(H/S/V) - 4P 轴流通风机性能曲线、参数表 (没有防喘圈)

FEG 71

Performance Curves and Data of DTF-10 (H/S/V) -4P Vane Axial Fan (without anti-stall ring)

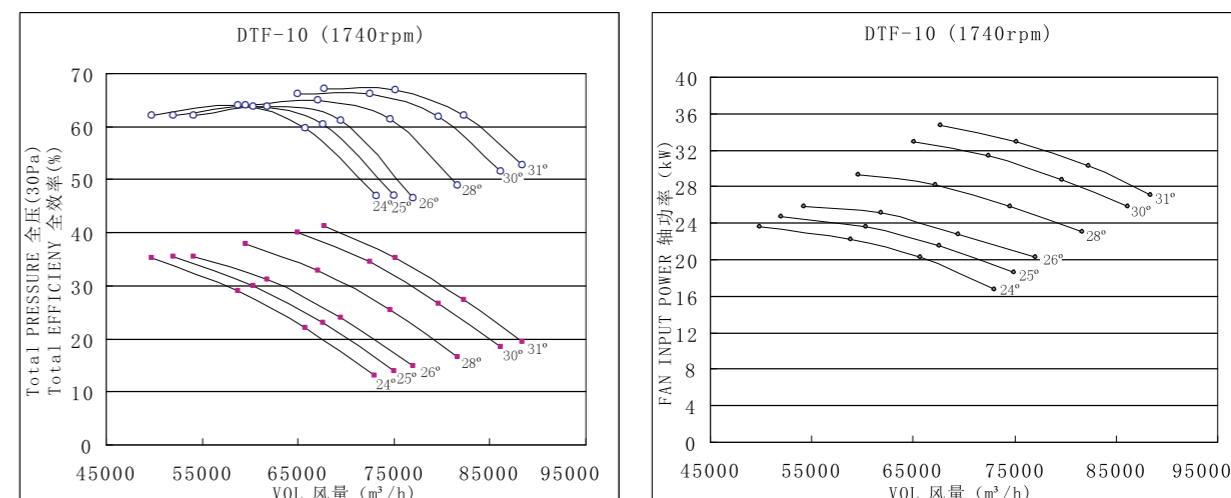

安装角 Pitch	工况点 Work Point	风量 Flow Rate (m³/h)	全压 Total Pressure (Pa)	轴功率 Shaft Power (kW)	电机型号 装机容量 Motor Size Power (kW)	总声功率级 Sound Power Level (dB)	重量Weight(kg)		
							风机 Fan excl. motor	电机 motor	运行时 Operating
24°	1	65759	661	20.25	Y200L-4 30	117	170	255	638
	2	58783	869	22.19		117			
	3	49815	1060	23.59		119			
25°	1	67598	691	21.52	Y200L-4 30	117	170	255	638
	2	60303	902	23.66		117			
	3	51998	1063	24.69		119			
26°	1	69438	721	22.80	Y255S-4 37	118	170	284	681
	2	61822	936	25.12		118			
	3	54180	1067	25.78		119			
28°	1	74576	762	25.79	Y255S-4 37	118	170	284	681
	2	67140	984	28.26		118			
	3	59606	1134	29.33		119			
30°	1	79714	802	28.78	Y225M-4 45	119	170	320	735
	2	72457	1033	31.40		118			
	3	65031	1201	32.88		119			
31°	1	82283	822	30.28	Y225M-4 45	119	170	320	735
	2	75115	1057	32.96		119			
	3	67744	1235	34.65		119			

各项性能额定值不包括附属物（附件）的影响。经认证的性能是D类安装-管道入口，管道出口。所示值为安装类型D：管道入口，管道出口的声功率级（入口Lwi）。额定值包括管道端部校正影响。所示声功率级额定值以分贝为单位，参考声功率为10⁻¹²瓦，按照AMCA International 标准301计算。

Performance ratings do not include the effects of appurtenances (accessories). Performance certified is for installation type D:Ducted inlet, Ducted outlet.

Values shown are for inlet Lwi sound. Power levels for installation type D:Ductedinlet, Ducted outlet. Ratings include the effects of duct end correction.

The sound power level ratings shown are in decibels, referred to 10⁻¹² watts, calculated per AMCA International Standard 301.

DTF 系列轴流通风机性能曲线图、参数表 Performance Curves and Data of DTF Vane Axial Fan

DTF-10(H/S/V) – 6P 轴流通风机性能曲线、参数表 (没有防喘圈)

FEG 71

Performance Curves and Data of DTF-10 (H/S/V) – 6P Vane Axial Fan (without anti-stall ring)

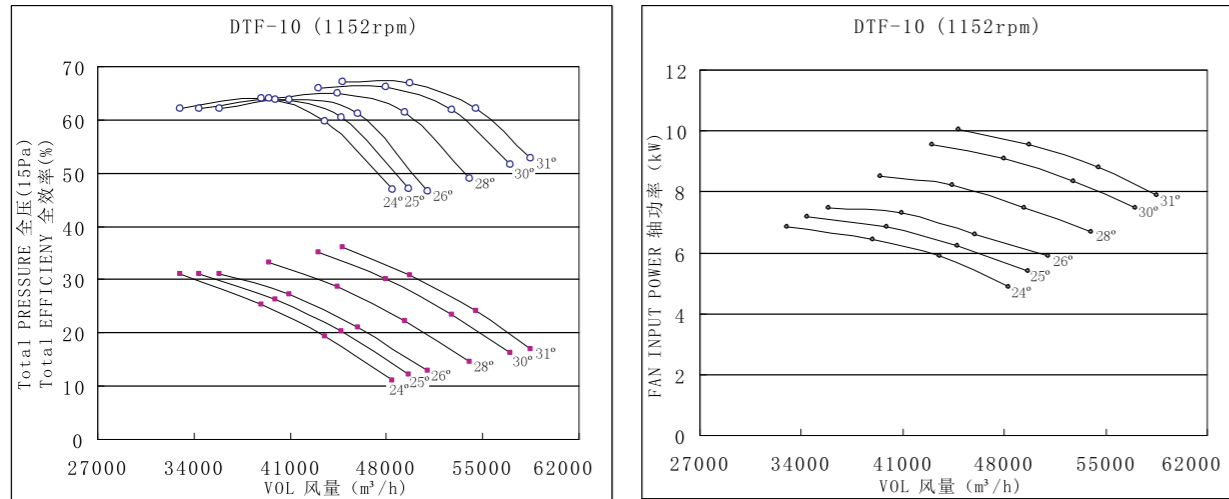

安装角 Pitch	工况点 Work Point	风量 Flow Rate (m³/h)	全压 Total Pressure (Pa)	轴功率 Shaft Power (kW)	电机型号 装机容量 Motor Size Power (kW)	总声功率级 Sound Power Level (dB)	重量Weight(kg)		
							风机 Fan excl. motor	电机 motor	运行时 Operating
24°	1	43537	290	5.88	Y160L-611	107	170	146	474
	2	38918	381	6.44		107			
	3	32981	465	6.85		109			
25°	1	44755	303	6.25	Y160L-611	108	170	146	474
	2	39924	396	6.87		107			
	3	34426	466	7.16		109			
26°	1	45973	316	6.62	Y160L-611	108	170	146	474
	2	40931	410	7.29		108			
	3	35871	468	7.48		109			
28°	1	49374	334	7.48	Y160L-611	109	170	146	474
	2	44451	431	8.20		108			
	3	39463	497	8.51		109			
30°	1	52776	351	8.35	Y180L-615	109	170	186	534
	2	47971	453	9.11		109			
	3	43055	526	9.54		109			
31°	1	54477	360	8.79	Y180L-615	109	170	186	534
	2	49731	463	9.57		109			
	3	44851	541	10.06		109			

各项性能额定值不包括附属物（附件）的影响。经认证的性能是D类安装-管道入口，管道出口。所示值为安装类型D：管道入口，管道出口的声功率级（入口Lwi）。额定值包括管道端部校正影响。所示声功率级额定值以分贝为单位，参考声功率为10⁻¹²瓦，按照AMCA International 标准301计算。

Performance ratings do not include the effects of appurtenances (accessories). Performance certified is for installation type D:Ducted inlet, Ducted outlet.

Values shown are for inlet Lwi sound. Power levels for installation type D:Ductedinlet, Ducted outlet. Ratings include the effects of duct end correction.

The sound power level ratings shown are in decibels, referred to 10⁻¹² watts, calculated per AMCA International Standard 301.

DTF 系列轴流通风机性能曲线图、参数表 Performance Curves and Data of DTF Vane Axial Fan

DTF-10(H/S/V) – 8P 轴流通风机性能曲线、参数表 (没有防喘圈)

FEG 71

Performance Curves and Data of DTF-10 (H/S/V) – 8P Vane Axial Fan (without anti-stall ring)

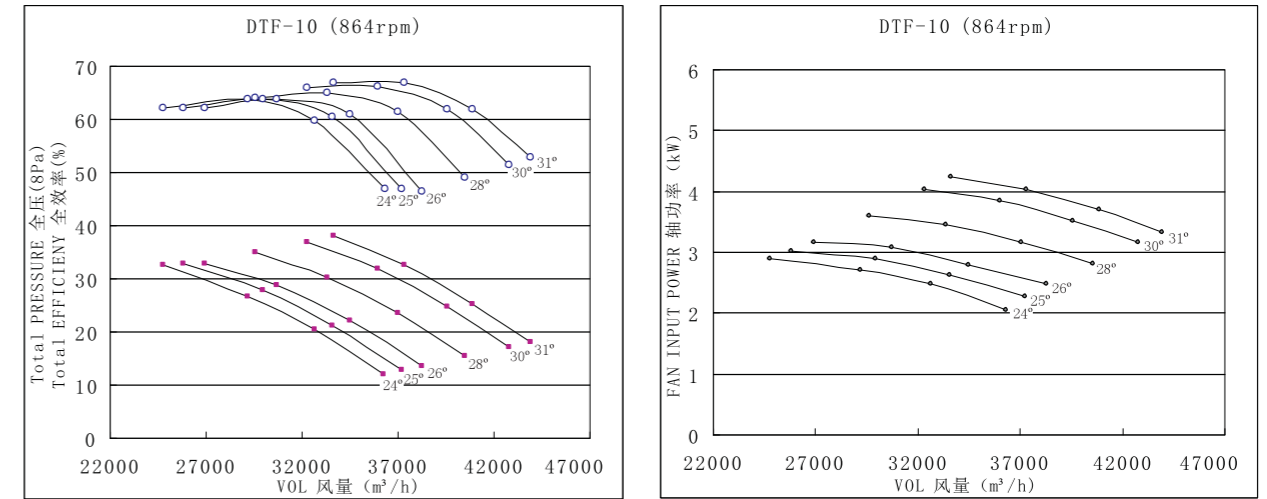

安装角 Pitch	工况点 Work Point	风量 Flow Rate (m³/h)	全压 Total Pressure (Pa)	轴功率 Shaft Power (kW)	电机型号 装机容量 Motor Size Power (kW)	总声功率级 Sound Power Level (dB)	重量Weight(kg)		
							风机 Fan excl. motor	电机 motor	运行时 Operating
24°	1	32653	163	2.48	Y160M1-84	100	170	118	432
	2	29189	214	2.72		100			
	3	24736	261	2.89		102			
25°	1	33566	170	2.64	Y160M1-84	101	170	118	432
	2	29943	223	2.90		100			
	3	25820	262	3.02		102			
26°	1	34480	178	2.79	Y160M1-84	101	170	118	432
	2	30698	231	3.08		101			
	3	26903	263	3.16		103			
28°	1	37031	188	3.16	Y160M2-85.5	102	170	121	437
	2	33338	243	3.46		101			
	3	29597	280	3.59		102			
30°	1	39582	198	3.52	Y160M2-85.5	102	170	121	437
	2	35978	255	3.84		102			
	3	32291	296	4.03		102			
31°	1	40858	203	3.71	Y160M2-85.5	103	170	121	437
	2	37299	261	4.04		102			
	3	33638	304	4.24		102			

各项性能额定值不包括附属物（附件）的影响。经认证的性能是D类安装-管道入口，管道出口。所示值为安装类型D：管道入口，管道出口的声功率级（入口Lwi）。额定值包括管道端部校正影响。所示声功率级额定值以分贝为单位，参考声功率为10⁻¹²瓦，按照AMCA International 标准301计算。

Performance ratings do not include the effects of appurtenances (accessories). Performance certified is for installation type D:Ducted inlet, Ducted outlet.

Values shown are for inlet Lwi sound. Power levels for installation type D:Ductedinlet, Ducted outlet. Ratings include the effects of duct end correction.

The sound power level ratings shown are in decibels, referred to 10⁻¹² watts, calculated per AMCA International Standard 301.

DTF 系列轴流通风机性能曲线图、参数表 Performance Curves and Data of DTF Vane Axial Fan

DTF-11.2(H/S/V) – 4P 轴流通风机性能曲线、参数表 (没有防喘圈)

FEG 71

Performance Curves and Data of DTF-11.2 (H/S/V) – 4P Vane Axial Fan (without anti-stall ring)

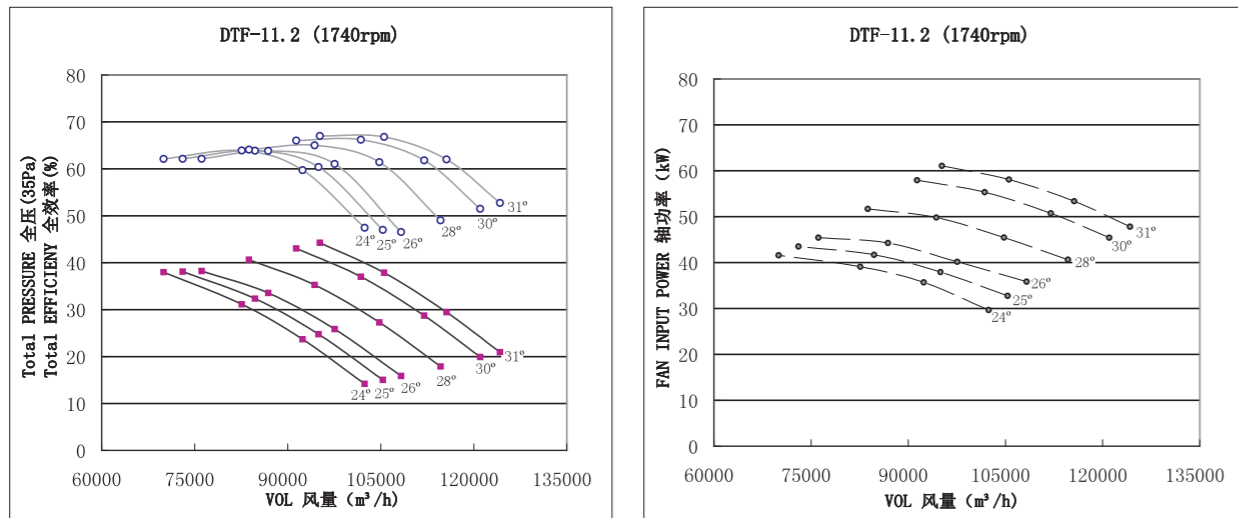

安装角 Pitch	工况点 Work Point	风量 Flow Rate (m³/h)	全压 Total Pressure (Pa)	轴功率 Shaft Power (kW)	电机型号 装机容量 Motor Size Power (kW)	总声功率级 Sound Power Level (dB)	重量Weight(kg)		
							风机 Fan excl. motor	电机 motor	运行时 Operating
24°	1	92386	829	35.69	Y250M-4 55	120	220	427	971
	2	82585	1090	39.10		120			
	3	69987	1330	41.58		122			
25°	1	94971	867	37.93	Y250M-4 55	121	220	427	971
	2	84721	1132	41.69		121			
	3	73053	1334	43.51		122			
26°	1	97556	905	40.17	Y250M-4 55	121	220	427	971
	2	86856	1174	44.28		121			
	3	76119	1338	45.44		123			
28°	1	104774	955	45.45	Y280S-4 75	122	220	560	1170
	2	94326	1235	49.80		121			
	3	83742	1422	51.69		122			
30°	1	111992	1006	50.72	Y280S-4 75	122	220	560	1170
	2	101796	1295	55.33		122			
	3	91364	1507	57.95		122			
31°	1	115601	1031	53.36	Y280S-4 75	123	220	560	1170
	2	105532	1326	58.09		122			
	3	95175	1549	61.07		122			

各项性能额定值不包括附属物（附件）的影响。经认证的性能是D类安装-管道入口，管道出口。所示值为安装类型D：管道入口，管道出口的声功率级（入口Lwi）。额定值包括管道端部校正影响。所示声功率级额定值以分贝为单位，参考声功率为10⁻¹²瓦，按照AMCA International 标准301计算。

Performance ratings do not include the effects of appurtenances (accessories). Performance certified is for installation type D:Ducted inlet, Ducted outlet.

Values shown are for inlet Lwi sound. Power levels for installation type D:Ductedinlet, Ducted outlet. Ratings include the effects of duct end correction.

The sound power level ratings shown are in decibels, referred to 10⁻¹² watts, calculated per AMCA International Standard 301.

DTF 系列轴流通风机性能曲线图、参数表 Performance Curves and Data of DTF Vane Axial Fan

DTF-11.2(H/S/V) – 6P 轴流通风机性能曲线、参数表 (没有防喘圈)

FEG 71

Performance Curves and Data of DTF-11.2 (H/S/V) – 6P Vane Axial Fan (without anti-stall ring)

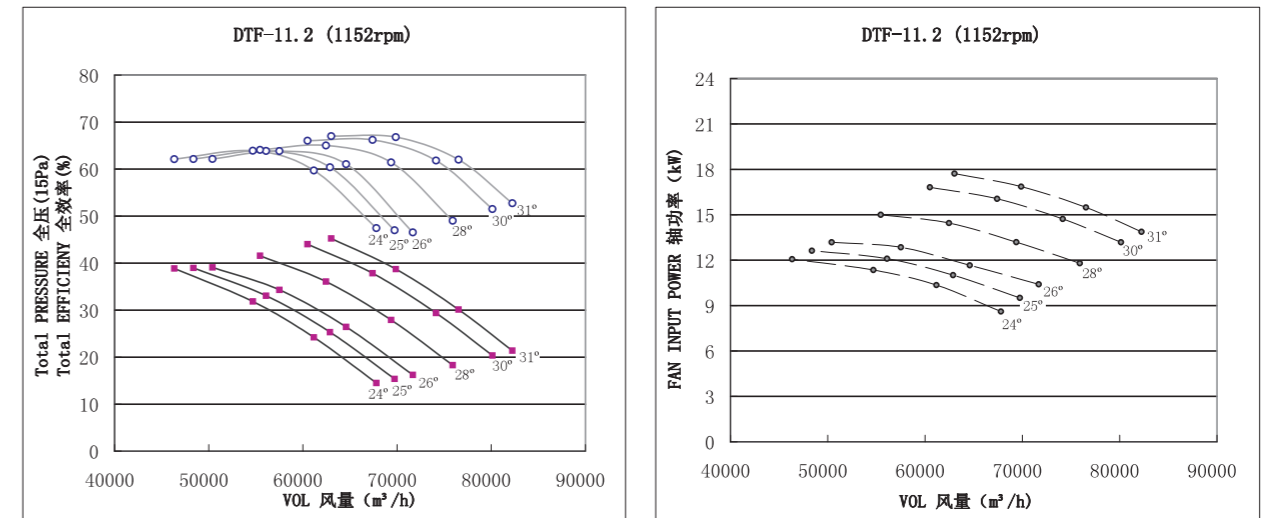

安装角 Pitch	工况点 Work Point	风量 Flow Rate (m³/h)	全压 Total Pressure (Pa)	轴功率 Shaft Power (kW)	电机型号 装机容量 Motor Size Power (kW)	总声功率级 Sound Power Level (dB)	重量Weight(kg)		
							风机 Fan excl. motor	电机 motor	运行时 Operating
24°	1	61166	363	10.36	Y180L-6 15	111	220	186	609
	2	54677	478	11.35		110			
	3	46336	583	12.07		112			
25°	1	62877	380	11.01	Y180L-6 15	111	220	186	609
	2	56091	496	12.10		111			
	3	48366	585	12.63		113			
26°	1	64588	397	11.66	Y200L1-6 18.5	111	220	235	683
	2	57505	515	12.85		111			
	3	50396	587	13.19		113			
28°	1	69367	419	13.19	Y200L1-6 18.5	112	220	235	683
	2	62450	541	14.45		112			
	3	55443	623	15.00		113			
30°	1	74146	441	14.72	Y200L2-6 22	113	220	260	720
	2	67396	568	16.06		112			
	3	60489	660	16.82		112			
31°	1	76536	452	15.49	Y200L2-6 22	113	220	260	720
	2	69869	581	16.86		112			
	3	63012	679	17.72		112			

各项性能额定值不包括附属物（附件）的影响。经认证的性能是D类安装-管道入口，管道出口。所示值为安装类型D：管道入口，管道出口的声功率级（入口Lwi）。额定值包括管道端部校正影响。所示声功率级额定值以分贝为单位，参考声功率为10⁻¹²瓦，按照AMCA International 标准301计算。

Performance ratings do not include the effects of appurtenances (accessories). Performance certified is for installation type D:Ducted inlet, Ducted outlet.

Values shown are for inlet Lwi sound. Power levels for installation type D:Ductedinlet, Ducted outlet. Ratings include the effects of duct end correction.

The sound power level ratings shown are in decibels, referred to 10⁻¹² watts, calculated per AMCA International Standard 301.

DTF 系列轴流通风机性能曲线图、参数表 Performance Curves and Data of DTF Vane Axial Fan

DTF-11.2(H/S/V) – 8P 轴流通风机性能曲线、参数表 (没有防喘圈)

FEG 71

Performance Curves and Data of DTF-11.2 (H/S/V) – 8P Vane Axial Fan (without anti-stall ring)

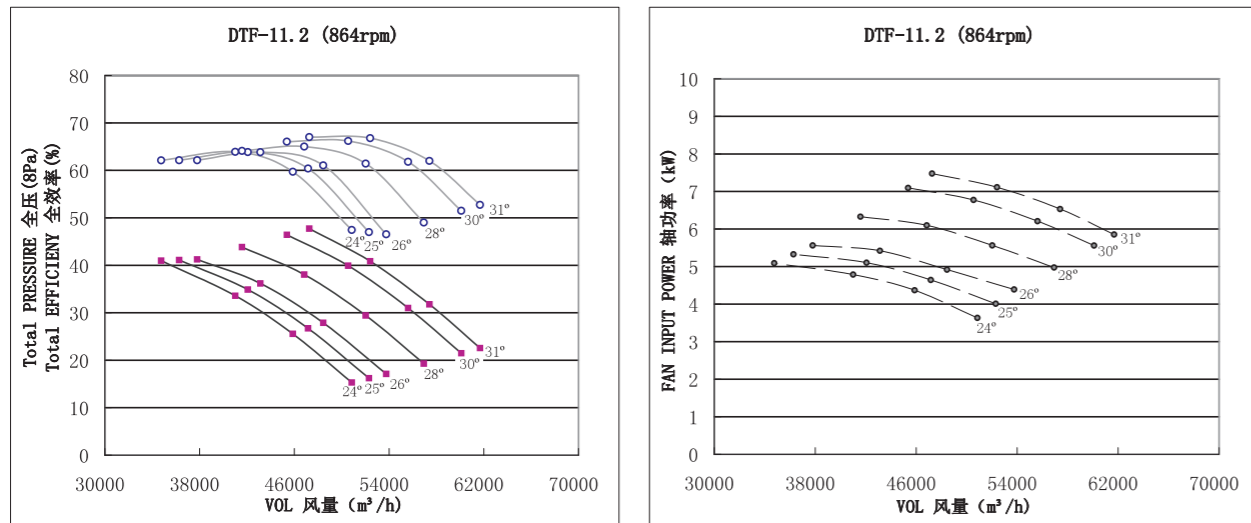

安装角 Pitch	工况点 Work Point	风量 Flow Rate (m³/h)	全压 Total Pressure (Pa)	轴功率 Shaft Power (kW)	电机型号装机容量 Motor Size Power (kW)	总声功率级 Sound Power Level (dB)	重量Weight(kg)		
							风机 Fan excl. motor	电机 motor	运行时 Operating
24°	1	45875	204	4.37	Y160L-8 7.5	104	220	147	551
	2	41008	269	4.79		104			
	3	34752	328	5.09		106			
25°	1	47158	214	4.64	Y160L-8 7.5	104	220	147	551
	2	42068	279	5.10		104			
	3	36275	329	5.33		106			
26°	1	48441	223	4.92	Y160L-8 7.5	105	220	147	551
	2	43128	289	5.42		104			
	3	37797	330	5.56		106			
28°	1	52026	236	5.56	Y160L-8 7.5	105	220	147	551
	2	46838	304	6.10		105			
	3	41582	351	6.33		106			
30°	1	55610	248	6.21	Y180L-8 11	106	220	182	603
	2	50547	319	6.77		105			
	3	45367	371	7.09		105			
31°	1	57402	254	6.53	Y180L-8 11	106	220	182	603
	2	52402	327	7.11		105			
	3	47259	382	7.48		105			

各项性能额定值不包括附属物(附件)的影响。经认证的性能是D类安装-管道入口,管道出口。所示值为安装类型D:管道入口,管道出口的声功率级(入口Lwi)。额定值包括管道端部校正影响。所示声功率级额定值以分贝为单位,参考声功率为10⁻¹²瓦,按照AMCA International 标准301计算。

Performance ratings do not include the effects of appurtenances (accessories). Performance certified is for installation type D:Ducted inlet, Ducted outlet.

Values shown are for inlet Lwi sound. Power levels for installation type D:Ductedinlet, Ducted outlet. Ratings include the effects of duct end correction.

The sound power level ratings shown are in decibels, referred to 10⁻¹² watts, calculated per AMCA International Standard 301.

DTF 系列轴流通风机性能曲线图、参数表 Performance Curves and Data of DTF Vane Axial Fan

DTF-12.5(H/S/V) – 4P 轴流通风机性能曲线、参数表 (没有防喘圈)

FEG 71

Performance Curves and Data of DTF-12.5 (H/S/V) – 4P Vane Axial Fan (without anti-stall ring)

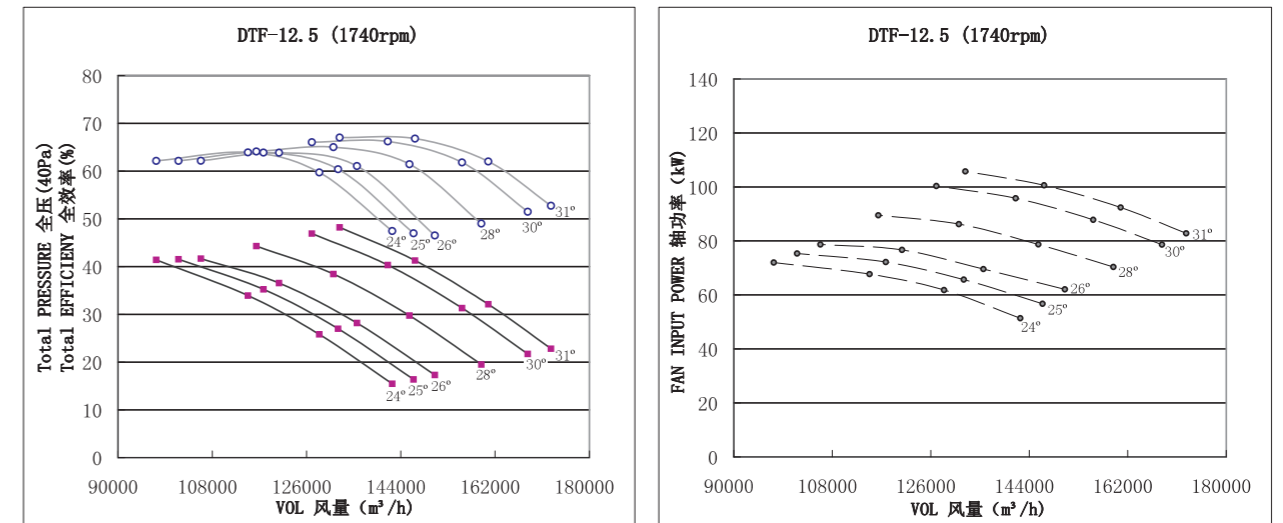

安装角 Pitch	工况点 Work Point	风量 Flow Rate (m³/h)	全压 Total Pressure (Pa)	轴功率 Shaft Power (kW)	电机型号装机容量 Motor Size Power (kW)	总声功率级 Sound Power Level (dB)	重量Weight(kg)		
							风机 Fan excl. motor	电机 motor	运行时 Operating
24°	1	128435	1033	61.80	Y280S-4 90	124	330	667	1496
	2	114810	1358	67.71		124			
	3	97295	1656	72.00		126			
25°	1	132028	1080	65.69	Y280S-4 90	124	330	667	1496
	2	117778	1410	72.19		124			
	3	101558	1662	75.34		126			
26°	1	135621	1127	69.57	Y315S-4 110	125	330	1000	1995
	2	120747	1462	76.67		124			
	3	105821	1667	78.68		126			
28°	1	145656	1190	78.70	Y315S-4 110	125	330	1000	1995
	2	131132	1538	86.24		125			
	3	116417	1772	89.51		126			
30°	1	155691	1253	87.84	Y315M-4 132	126	330	1100	2145
	2	141517	1613	95.81		125			
	3	127013	1877	100.34		125			
31°	1	160708	1284	92.41	Y315M-4 132	126	330	1100	2145
	2	146709	1651	100.60		125			
	3	132312	1929	105.76		125			

各项性能额定值不包括附属物(附件)的影响。经认证的性能是D类安装-管道入口,管道出口。所示值为安装类型D:管道入口,管道出口的声功率级(入口Lwi)。额定值包括管道端部校正影响。所示声功率级额定值以分贝为单位,参考声功率为10⁻¹²瓦,按照AMCA International 标准301计算。

Performance ratings do not include the effects of appurtenances (accessories). Performance certified is for installation type D:Ducted inlet, Ducted outlet.

Values shown are for inlet Lwi sound. Power levels for installation type D:Ductedinlet, Ducted outlet. Ratings include the effects of duct end correction.

The sound power level ratings shown are in decibels, referred to 10⁻¹² watts, calculated per AMCA International Standard 301.

DTF 系列轴流通风机性能曲线图、参数表 Performance Curves and Data of DTF Vane Axial Fan

DTF-12.5(H/S/V) – 6P 轴流通风机性能曲线、参数表 (没有防喘圈)

FEG 71

Performance Curves and Data of DTF-12.5 (H/S/V) – 6P Vane Axial Fan (without anti-stall ring)

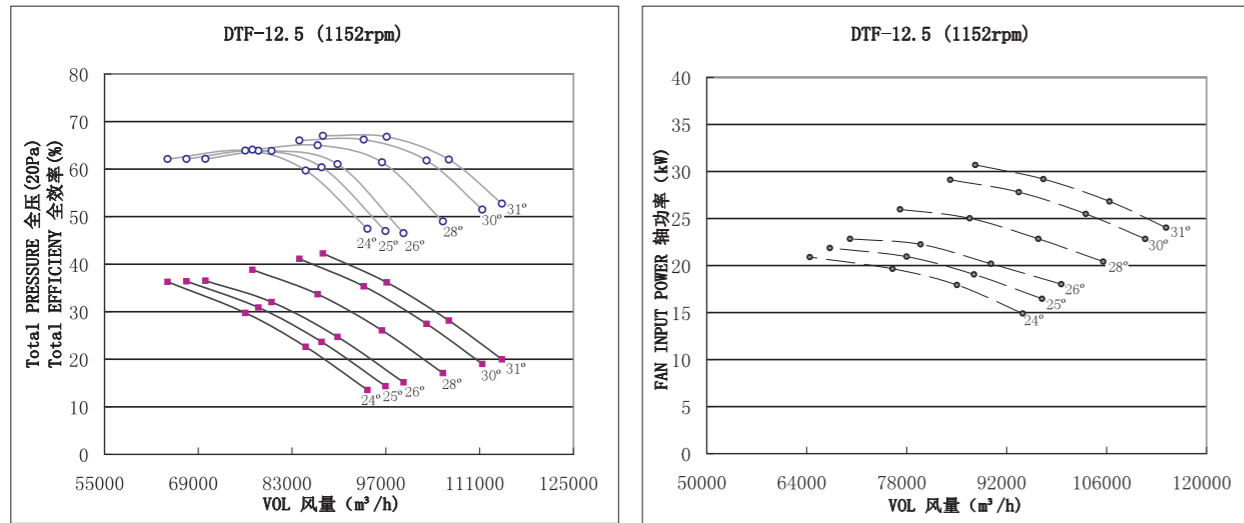

安装角 Pitch	工况点 Work Point	风量 Flow Rate (m³/h)	全压 Total Pressure (Pa)	轴功率 Shaft Power (kW)	电机型号装机容量 Motor Size Power (kW)	总声功率级 Sound Power Level (dB)	重量Weight(kg)		
							风机 Fan excl. motor	电机 motor	运行时 Operating
24°	1	85033	453	17.94	Y225M-6 30	114	330	302	948
	2	76012	595	19.65		114			
	3	64416	726	20.90		116			
25°	1	87412	473	19.06	Y225M-6 30	114	330	302	948
	2	77977	618	20.95		114			
	3	67239	728	21.86		116			
26°	1	89791	494	20.19	Y225M-6 30	115	330	302	948
	2	79943	641	22.25		115			
	3	70061	731	22.83		116			
28°	1	96434	522	22.84	Y225M-6 30	115	330	302	948
	2	86818	674	25.03		115			
	3	77076	777	25.98		116			
30°	1	103078	549	25.49	Y250M-6 37	116	330	400	1095
	2	93694	707	27.81		115			
	3	84092	823	29.12		116			
31°	1	106400	563	26.82	Y250M-6 37	116	330	400	1095
	2	97132	724	29.19		116			
	3	87599	846	30.69		115			

各项性能额定值不包括附属物（附件）的影响。经认证的性能是D类安装-管道入口，管道出口。所示值为安装类型D：管道入口，管道出口的声功率级（入口Lwi）。额定值包括管道端部校正影响。所示声功率级额定值以分贝为单位，参考声功率为10⁻¹²瓦，按照AMCA International 标准301计算。

Performance ratings do not include the effects of appurtenances (accessories). Performance certified is for installation type D:Ducted inlet, Ducted outlet.

Values shown are for inlet Lwi sound. Power levels for installation type D:Ductedinlet, Ducted outlet. Ratings include the effects of duct end correction.

The sound power level ratings shown are in decibels, referred to 10⁻¹² watts, calculated per AMCA International Standard 301.

DTF 系列轴流通风机性能曲线图、参数表 Performance Curves and Data of DTF Vane Axial Fan

DTF-12.5(H/S/V) – 8P 轴流通风机性能曲线、参数表 (没有防喘圈)

FEG 71

Performance Curves and Data of DTF-12.5 (H/S/V) – 8P Vane Axial Fan (without anti-stall ring)

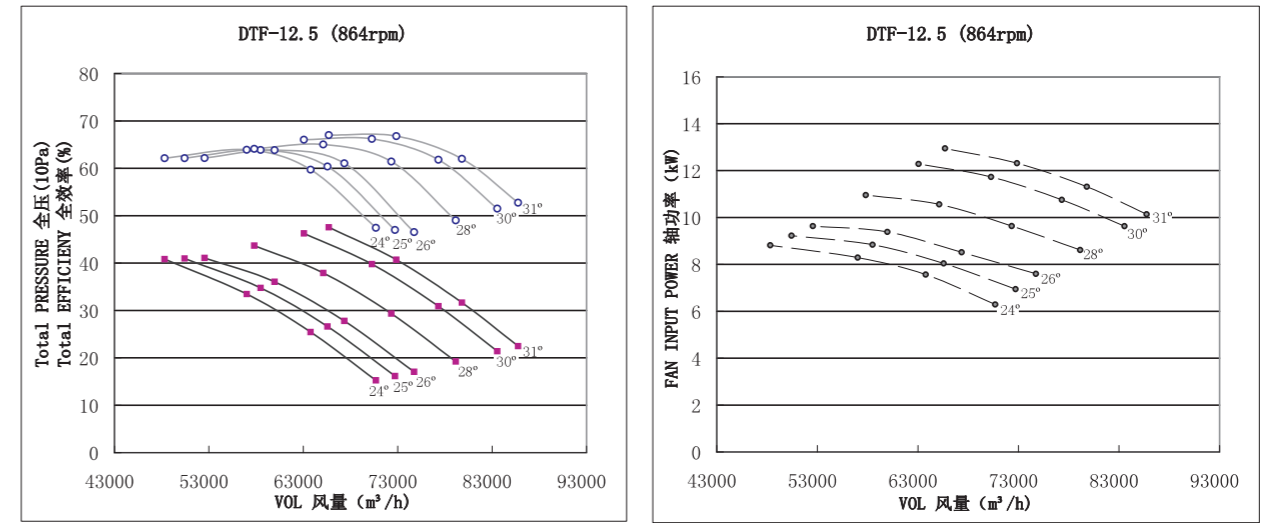

安装角 Pitch	工况点 Work Point	风量 Flow Rate (m³/h)	全压 Total Pressure (Pa)	轴功率 Shaft Power (kW)	电机型号装机容量 Motor Size Power (kW)	总声功率级 Sound Power Level (dB)	重量Weight(kg)		
							风机 Fan excl. motor	电机 motor	运行时 Operating
24°	1	63775	255	7.57	Y180L-8 11	107	330	182	768
	2	57009	335	8.29		107			
	3	48312	408	8.82		109			
25°	1	65559	266	8.04	Y180L-8 11	107	330	182	768
	2	58483	348	8.84		107			
	3	50429	410	9.22		109			
26°	1	67343	278	8.52	Y200L-8 15	108	330	290	930
	2	59957	361	9.39		108			
	3	52546	411	9.63		109			
28°	1	72326	293	9.64	Y200L-8 15	109	330	290	930
	2	65114	379	10.56		108			
	3	57807	437	10.96		109			
30°	1	77309	309	10.75	Y200L-8 15	109	330	290	930
	2	70270	398	11.73		108			
	3	63069	463	12.28		109			
31°	1	79800	317	11.31	Y200L-8 15	109	330	290	930
	2	72849	407	12.32		109			
	3	65700	476	12.95		109			

各项性能额定值不包括附属物（附件）的影响。经认证的性能是D类安装-管道入口，管道出口。所示值为安装类型D：管道入口，管道出口的声功率级（入口Lwi）。额定值包括管道端部校正影响。所示声功率级额定值以分贝为单位，参考声功率为10⁻¹²瓦，按照AMCA International 标准301计算。

Performance ratings do not include the effects of appurtenances (accessories). Performance certified is for installation type D:Ducted inlet, Ducted outlet.

Values shown are for inlet Lwi sound. Power levels for installation type D:Ductedinlet, Ducted outlet. Ratings include the effects of duct end correction.

The sound power level ratings shown are in decibels, referred to 10⁻¹² watts, calculated per AMCA International Standard 301.

DTF 系列轴流通风机性能曲线图、参数表 Performance Curves and Data of DTF Vane Axial Fan

DTF-14(H/S/V) – 4P 轴流通风机性能曲线、参数表 (带防喘圈)

FEG 75

Performance Curves and Data of DTF-14 (H/S/V) – 4P Vane Axial Fan (with anti-stall ring)

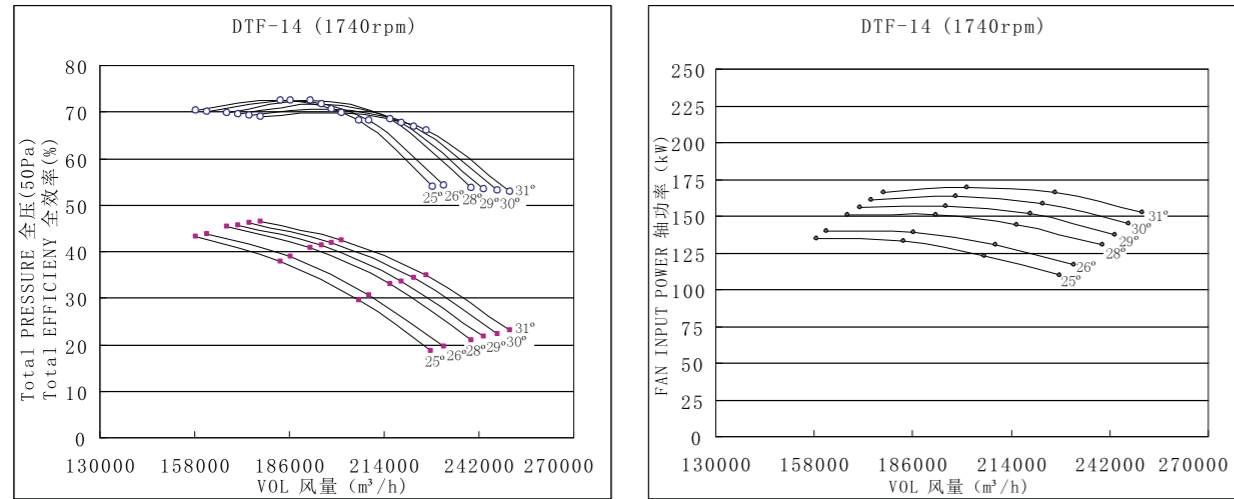

安装角 Pitch	工况点 Work Point	风量 Flow Rate (m³/h)	全压 Total Pressure (Pa)	轴功率 Shaft Power (kW)	电机型号 装机容量 Motor Size Power (kW)	总声功率级 Sound Power Level (dB)	重量Weight(kg)		
							风机 Fan excl. motor	电机 motor	运行时 Operating
25°	1	206449	1477	123.23	Y315L1-4 160	126	463	1160	2435
	2	183260	1889	133.13		124			
	3	158529	2156	134.73		125			
26°	1	209535	1534	130.31	Y315L1-4 160	126	463	1160	2435
	2	186312	1942	139.05		124			
	3	161553	2192	140.00		125			
28°	1	215707	1647	144.47	Y355S1-4 185	126	463	1600	3095
	2	192418	2047	150.88		125			
	3	167600	2265	150.54		125			
29°	1	219269	1679	151.58	Y355S1-4 185	125	463	400	1295
	2	195403	2071	157.09		125			
	3	170924	2285	155.84		125			
30°	1	222831	1712	158.69	Y355S1-4 185	125	463	400	1295
	2	198389	2095	163.29		124			
	3	174248	2305	161.13		125			
31°	1	226393	1744	165.80	Y355S2-4 200	125	463	1650	3170
	2	201375	2119	169.50		124			
	3	177572	2325	166.43		125			

各项性能额定值不包括附属物（附件）的影响。经认证的性能是A类安装-自由入口，自由出口。所示值为安装类型A：自由入口，自由出口的声功率级（出口Lwo）。所示声功率级额定值以分贝为单位，参考声功率为10⁻¹²瓦，按照AMCA International 标准301计算。

Performance ratings do not include the effects of appurtenances (accessories). Performance certified is for installation type A- Free inlet, Free outlet. Values shown are for outlet Lwo sound. power levels for installation type A:Freeinlet, Free outlet. The sound power level ratings shown are in decibels, referred to 10⁻¹² watts, calculated per AMCA International Standard 301.

DTF 系列轴流通风机性能曲线图、参数表 Performance Curves and Data of DTF Vane Axial Fan

DTF-14(H/S/V) – 6P 轴流通风机性能曲线、参数表 (带防喘圈)

FEG 75

Performance Curves and Data of DTF-14 (H/S/V) – 6P Vane Axial Fan (with anti-stall ring)

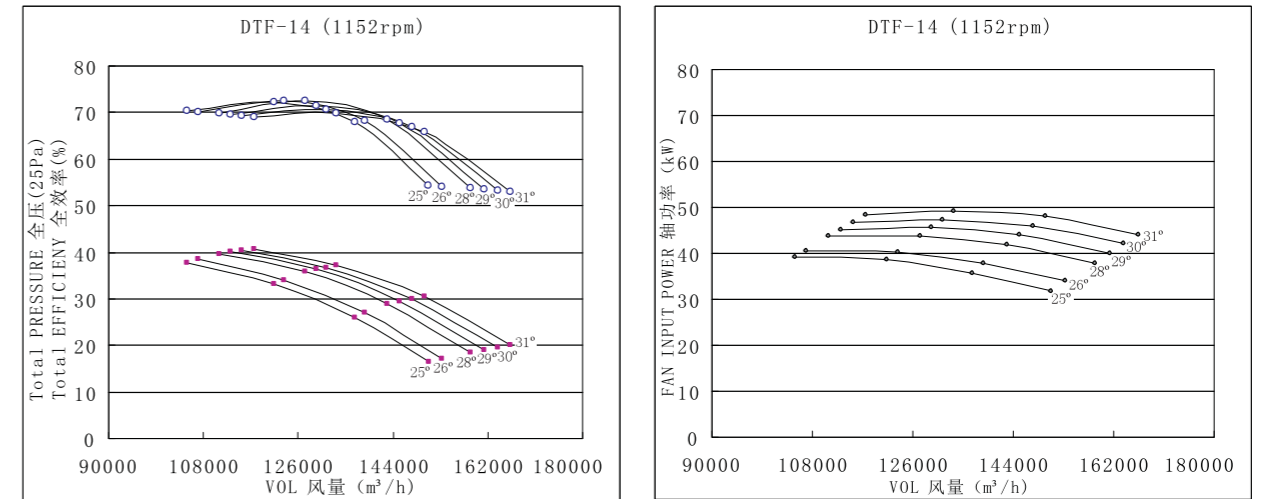

安装角 Pitch	工况点 Work Point	风量 Flow Rate (m³/h)	全压 Total Pressure (Pa)	轴功率 Shaft Power (kW)	电机型号 装机容量 Motor Size Power (kW)	总声功率级 Sound Power Level (dB)	重量Weight(kg)		
							风机 Fan excl. motor	电机 motor	运行时 Operating
25°	1	136683	648	35.76	Y280S-6 45	116	463	533	1494
	2	121330	828	38.64		114			
	3	104957	945	39.10		116			
26°	1	138727	672	37.82	Y280M-6 55	116	463	590	1580
	2	123352	851	40.35		115			
	3	106959	961	40.63		116			
28°	1	142813	722	41.93	Y280M-6 55	116	463	590	1580
	2	127394	897	43.79		115			
	3	110962	993	43.69		116			
29°	1	145171	736	43.99	Y280M-6 55	116	463	590	1580
	2	129371	908	45.59		115			
	3	113163	1002	45.22		115			
30°	1	147530	750	46.05	Y280M-6 55	115	463	590	1580
	2	131347	918	47.39		115			
	3	115364	1010	46.76		115			
31°	1	149888	764	48.12	Y315S-6 75	115	463	990	2180
	2	133324	929	49.19		114			
	3	117565	1019	48.30		115			

各项性能额定值不包括附属物（附件）的影响。经认证的性能是A类安装-自由入口，自由出口。所示值为安装类型A：自由入口，自由出口的声功率级（出口Lwo）。所示声功率级额定值以分贝为单位，参考声功率为10⁻¹²瓦，按照AMCA International 标准301计算。

Performance ratings do not include the effects of appurtenances (accessories). Performance certified is for installation type A- Free inlet, Free outlet. Values shown are for outlet Lwo sound. power levels for installation type A:Freeinlet, Free outlet. The sound power level ratings shown are in decibels, referred to 10⁻¹² watts, calculated per AMCA International Standard 301.

DTF 系列轴流通风机性能曲线图、参数表 Performance Curves and Data of DTF Vane Axial Fan

DTF-14(H/S/V) – 8P 轴流通风机性能曲线、参数表 (带防喘圈)

FEG 75

Performance Curves and Data of DTF-14 (H/S/V) – 8P Vane Axial Fan (with anti-stall ring)

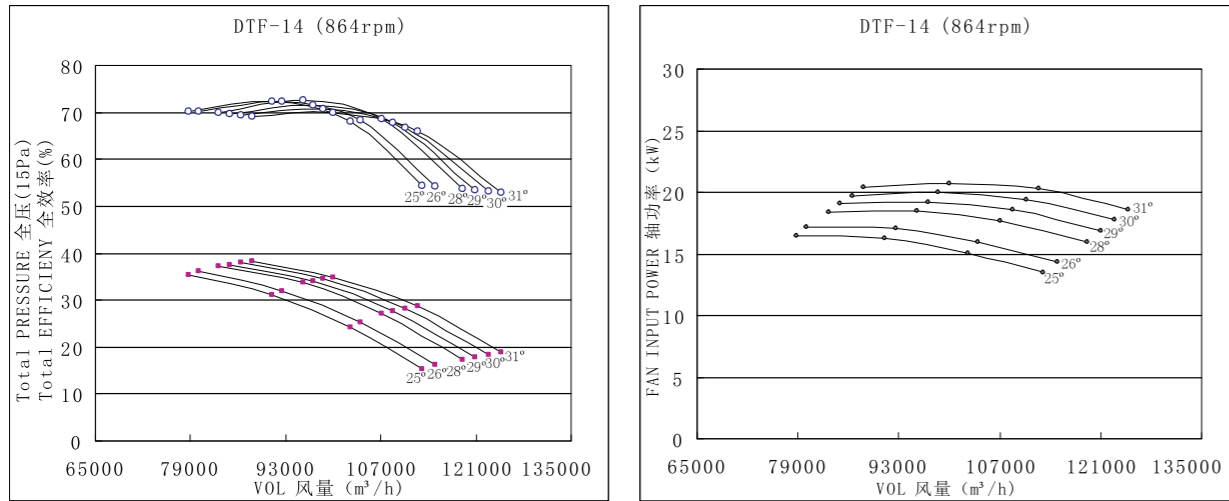

安装角 Pitch	工况点 Work Point	风量 Flow Rate (m³/h)	全压 Total Pressure (Pa)	轴功率 Shaft Power (kW)	电机型号 装机容量 Motor Size Power (kW)	总声功率级 Sound Power Level (dB)	重量Weight(kg)		
							风机 Fan excl. motor	电机 motor	运行时 Operating
25°	1	102513	364	15.09	Y225M-8 22	109	463	303	1149
	2	90998	466	16.30		108			
	3	78718	532	16.50		109			
26°	1	104045	378	15.95	Y225M-8 22	109	463	303	1149
	2	92514	479	17.02		108			
	3	80219	540	17.14		109			
28°	1	107110	406	17.69	Y225M-8 22	109	463	303	1149
	2	95545	505	18.47		108			
	3	83222	558	18.43		109			
29°	1	108879	414	18.56	Y250M-8 30	109	463	400	1295
	2	97028	511	19.23		108			
	3	84872	563	19.08		109			
30°	1	110647	422	19.43	Y250M-8 30	109	463	400	1295
	2	98511	517	19.99		108			
	3	86523	568	19.73		108			
31°	1	112416	430	20.30	Y250M-8 30	108	463	400	1295
	2	99993	523	20.75		108			
	3	88174	573	20.38		108			

各项性能额定值不包括附属物 (附件) 的影响。经认证的性能是A类安装-自由入口, 自由出口。所示值为安装类型A: 自由入口, 自由出口的声功率级 (出口Lwo)。所示声功率级额定值以分贝为单位, 参考声功率为10⁻¹²瓦, 按照AMCA International 标准301计算。

Performance ratings do not include the effects of appurtenances (accessories). Performance certified is for installation type A- Free inlet, Free outlet. Values shown are for outlet Lwo sound. power levels for installation type A: Freeinlet, Free outlet. The sound power level ratings shown are in decibels, referred to 10⁻¹² watts, calculated per AMCA International Standard 301.

DTF 系列轴流通风机性能曲线图、参数表 Performance Curves and Data of DTF Vane Axial Fan

DTF-15(H/S/V) – 6P 轴流通风机性能曲线、参数表 (带防喘圈)

FEG 75

Performance Curves and Data of DTF-15 (H/S/V) – 6P Vane Axial Fan (with anti-stall ring)

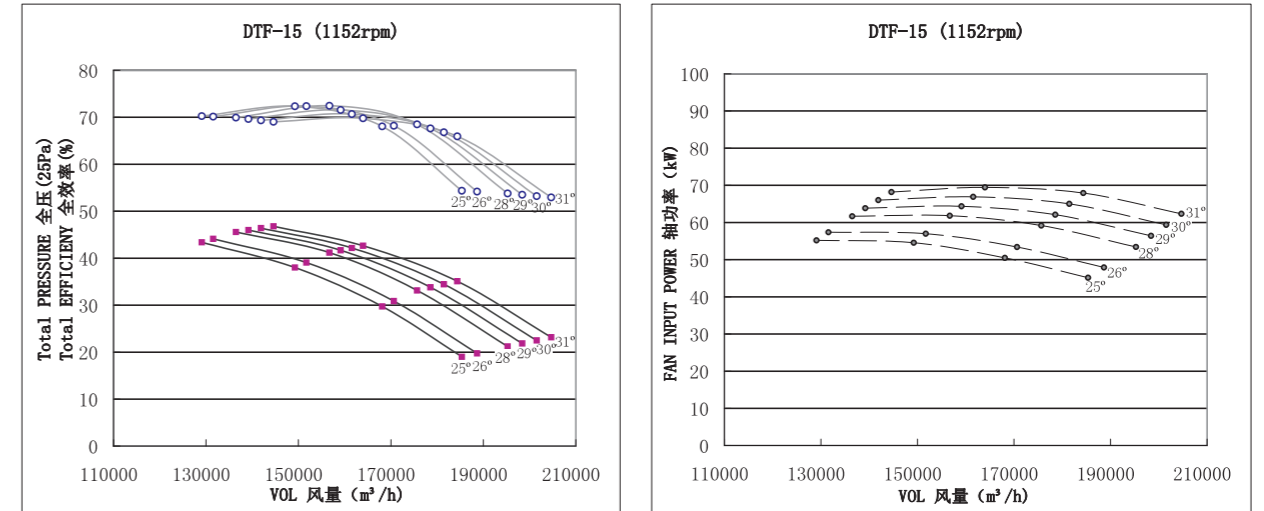

安装角 Pitch	工况点 Work Point	风量 Flow Rate (m³/h)	全压 Total Pressure (Pa)	轴功率 Shaft Power (kW)	电机型号 装机容量 Motor Size Power (kW)	总声功率级 Sound Power Level (dB)	重量Weight(kg)		
							风机 Fan excl. motor	电机 motor	运行时 Operating
25°	1	168115	743	50.49	Y315S-6 75	118	550	990	2310
	2	149231	951	54.55		117			
	3	129093	1085	55.21		118			
26°	1	170628	772	53.40	Y315S-6 75	118	550	990	2310
	2	151717	977	56.98		117			
	3	131555	1103	57.37		118			
28°	1	175654	829	59.20	Y315S-6 75	118	550	990	2310
	2	156689	1030	61.82		117			
	3	136479	1140	61.68		118			
29°	1	178554	845	62.11	Y315S-6 75	118	550	990	2310
	2	159120	1042	64.37		117			
	3	139186	1150	63.85		117			
30°	1	181455	861	65.02	Y315M-6 90	118	550	1050	2400
	2	161552	1054	66.91		117			
	3	141893	1160	66.02		117			
31°	1	184356	878	67.94	Y315M-6 90	117	550	1050	2400
	2	163983	1066	69.46		117			
	3	144600	1170	68.19		117			

各项性能额定值不包括附属物 (附件) 的影响。经认证的性能是A类安装-自由入口, 自由出口。所示值为安装类型A: 自由入口, 自由出口的声功率级 (出口Lwo)。所示声功率级额定值以分贝为单位, 参考声功率为10⁻¹²瓦, 按照AMCA International 标准301计算。

Performance ratings do not include the effects of appurtenances (accessories). Performance certified is for installation type A- Free inlet, Free outlet. Values shown are for outlet Lwo sound. power levels for installation type A: Freeinlet, Free outlet. The sound power level ratings shown are in decibels, referred to 10⁻¹² watts, calculated per AMCA International Standard 301.

DTF 系列轴流通风机性能曲线图、参数表 Performance Curves and Data of DTF Vane Axial Fan

DTF-15(H/S/V) – 8P 轴流通风机性能曲线、参数表 (带防喘圈)

FEG 75

Performance Curves and Data of DTF-15 (H/S/V) – 8P Vane Axial Fan (with anti-stall ring)

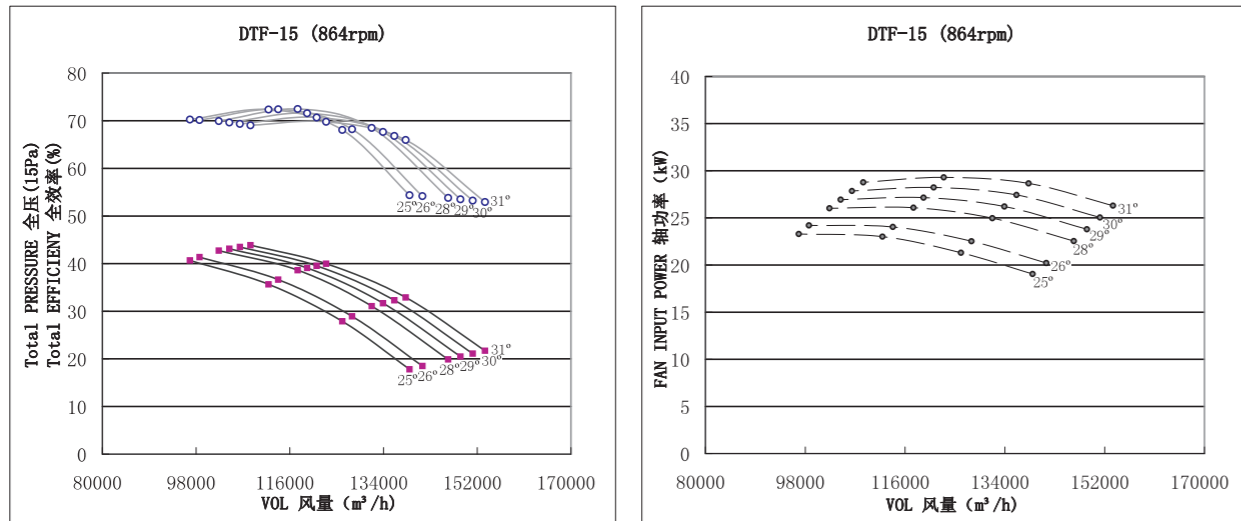

安装角 Pitch	工况点 Work Point	风量 Flow Rate (m³/h)	全压 Total Pressure (Pa)	轴功率 Shaft Power (kW)	电机型号装机容量 Motor Size Power (kW)	总声功率级 Sound Power Level (dB)	重量Weight(kg)		
							风机 Fan excl. motor	电机 motor	运行时 Operating
25°	1	126086	418	21.30	Y250M-8 30	111	550	400	1425
	2	111923	535	23.01		110			
	3	96820	610	23.29		111			
26°	1	127971	434	22.53	Y250M-8 30	111	550	400	1425
	2	113788	550	24.04		110			
	3	98666	620	24.20		111			
28°	1	131740	466	24.97	Y250M-8 30	111	550	400	1425
	2	117517	579	26.08		110			
	3	102359	641	26.02		111			
29°	1	133916	475	26.20	Y280S-8 37	111	550	990	2310
	2	119340	586	27.15		110			
	3	104389	647	26.94		111			
30°	1	136091	484	27.43	Y280S-8 37	111	550	1050	2400
	2	121164	593	28.23		110			
	3	106420	652	27.85		110			
31°	1	138267	494	28.66	Y280S-8 37	111	550	1050	2400
	2	122987	600	29.30		110			
	3	108450	658	28.77		110			

各项性能额定值不包括附属物（附件）的影响。经认证的性能是A类安装-自由入口，自由出口。所示值为安装类型A：自由入口，自由出口的声功率级（出口Lwo）。所示声功率级额定值以分贝为单位，参考声功率为10⁻¹²瓦，按照AMCA International 标准301计算。

Performance ratings do not include the effects of appurtenances (accessories). Performance certified is for installation type A- Free inlet , Free outlet.

Values shown are for outlet Lwo sound. power levels for installation type A:Freeinlet, Free outlet. The sound power level ratings shown are in decibels,

referred to 10⁻¹² watts, calculated per AMCA International Standard 301.

DTF 系列轴流通风机性能曲线图、参数表 Performance Curves and Data of DTF Vane Axial Fan

DTF-16(H/S/V) – 6P 轴流通风机性能曲线、参数表 (带防喘圈)

FEG 75

Performance Curves and Data of DTF-16 (H/S/V) – 6P Vane Axial Fan (with anti-stall ring)

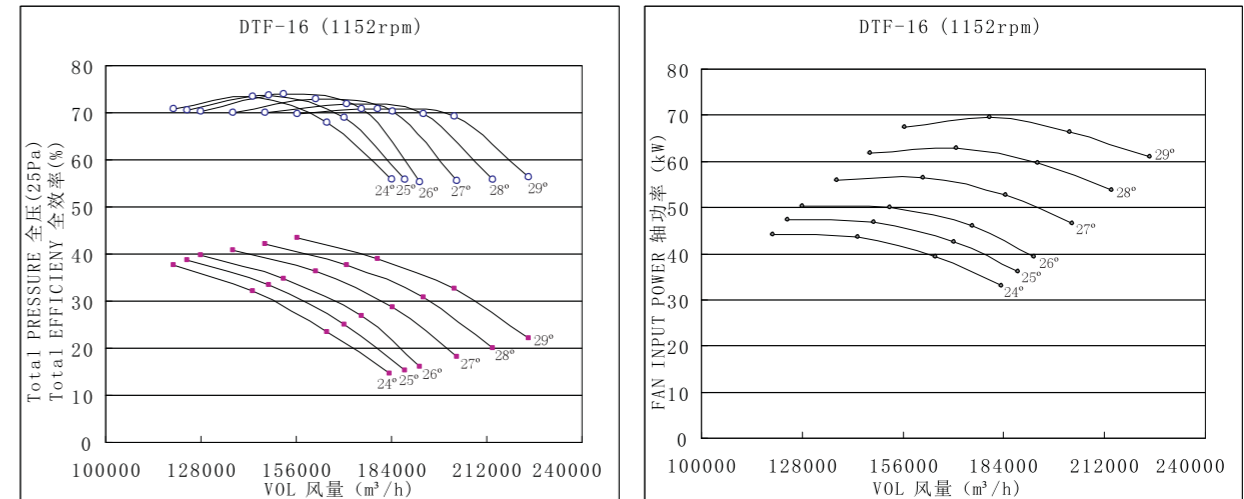

安装角 Pitch	工况点 Work Point	风量 Flow Rate (m³/h)	全压 Total Pressure (Pa)	轴功率 Shaft Power (kW)	电机型号装机容量 Motor Size Power (kW)	总声功率级 Sound Power Level (dB)	重量Weight(kg)		
							风机 Fan excl. motor	电机 motor	运行时 Operating
24°	1	164992	584	39.44	Y280M-6 55	118	1020	590	2415
	2	143344	802	43.49		119			
	3	119846	940	44.14		116			
25°	1	170214	626	42.67	Y280M-6 55	119	1020	590	2415
	2	147931	836	46.71		118			
	3	123918	966	47.23		118			
26°	1	175435	669	45.90	Y315S-6 75	120	1020	990	3015
	2	152517	871	49.93		118			
	3	127991	993	50.32		119			
27°	1	184432	718	52.76	Y315S-6 75	122	1020	990	3015
	2	161721	906	56.45		120			
	3	137505	1023	56.01		121			
28°	1	193428	768	59.62	Y315S-6 75	124	1020	1050	3015
	2	170925	941	62.98		122			
	3	147018	1053	61.71		122			
29°	1	202425	817	66.47	Y315M-6 90	126	1020	1050	3105
	2	180129	977	69.51		124			
	3	156532	1083	67.40		124			

各项性能额定值不包括附属物（附件）的影响。经认证的性能是A类安装-自由入口，自由出口。所示值为安装类型A：自由入口，自由出口的声功率级（出口Lwo）。所示声功率级额定值以分贝为单位，参考声功率为10⁻¹²瓦，按照AMCA International 标准301计算。

Performance ratings do not include the effects of appurtenances (accessories). Performance certified is for installation type A- Free inlet , Free outlet.

Values shown are for outlet Lwo sound. power levels for installation type A:Freeinlet, Free outlet. The sound power level ratings shown are in decibels,

referred to 10⁻¹² watts, calculated per AMCA International Standard 301.

DTF 系列轴流通风机性能曲线图、参数表 Performance Curves and Data of DTF Vane Axial Fan

DTF-16(H/S/V) – 8P 轴流通风机性能曲线、参数表 (带防喘圈)

FEG 75

Performance Curves and Data of DTF-16 (H/S/V) – 8P Vane Axial Fan (with anti-stall ring)

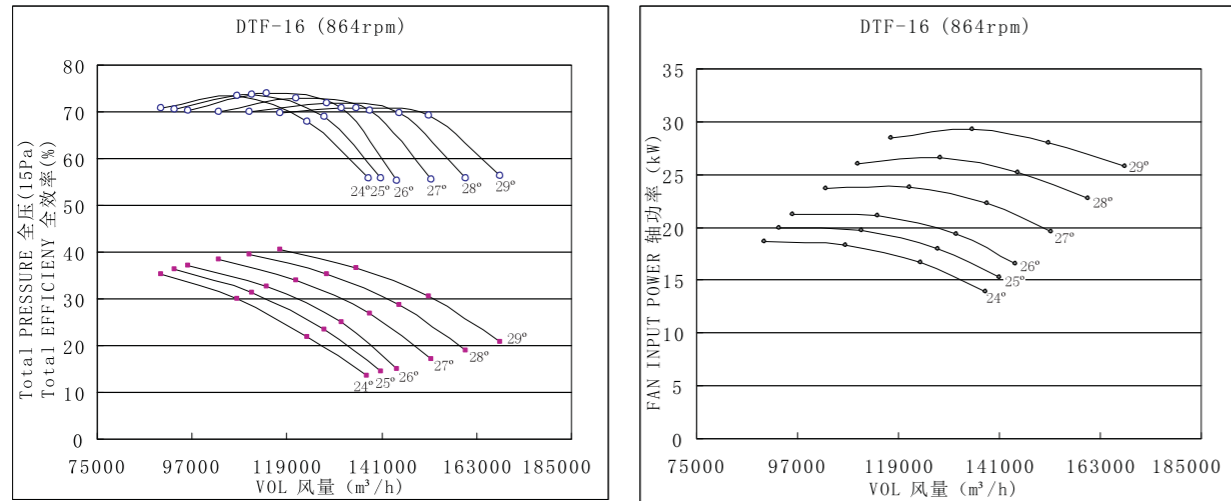

安装角 Pitch	工况点 Work Point	风量 Flow Rate (m³/h)	全压 Total Pressure (Pa)	轴功率 Shaft Power (kW)	电机型号装机容量 Motor Size Power (kW)	总声功率级 Sound Power Level (dB)	重量Weight(kg)		
							风机 Fan excl. motor	电机 motor	运行时 Operating
24°	1	123744	328	16.64	Y225M-8 22	112	1020	303	1985
	2	107508	451	18.35		110			
	3	89884	529	18.62		119			
25°	1	127660	352	18.00	Y250M-8 30	111	1020	400	2130
	2	110948	470	19.71		111			
	3	92939	543	19.92		116			
26°	1	131576	376	19.36	Y250M-8 30	111	1020	400	2130
	2	114388	490	21.06		112			
	3	95993	558	21.23		114			
27°	1	138324	404	22.26	Y250M-8 30	113	1020	400	2130
	2	121291	510	23.82		114			
	3	103128	575	23.63		115			
28°	1	145071	432	25.15	Y250M-8 30	115	1020	400	2130
	2	128194	530	26.57		116			
	3	110264	592	26.03		117			
29°	1	151819	460	28.04	Y280S-8 37	117	1020	522	2313
	2	135097	549	29.32		117			
	3	117399	609	28.44		119			

各项性能额定值不包括附属物 (附件) 的影响。经认证的性能是A类安装-自由入口, 自由出口。所示值为安装类型A: 自由入口, 自由出口的声功率级 (出口Lwo)。所示声功率级额定值以分贝为单位, 参考声功率为10⁻¹²瓦, 按照AMCA International 标准301计算。

Performance ratings do not include the effects of appurtenances (accessories). Performance certified is for installation type A- Free inlet, Free outlet. Values shown are for outlet Lwo sound. power levels for installation type A: Freeinlet, Free outlet. The sound power level ratings shown are in decibels, referred to 10⁻¹² watts, calculated per AMCA International Standard 301.

DTF 系列轴流通风机性能曲线图、参数表 Performance Curves and Data of DTF Vane Axial Fan

DTF-16(H/S/V) – 6P 轴流通风机性能曲线、参数表 (没有防喘圈)

FEG 75

Performance Curves and Data of DTF-16 (H/S/V) – 6P Vane Axial Fan (without anti-stall ring)

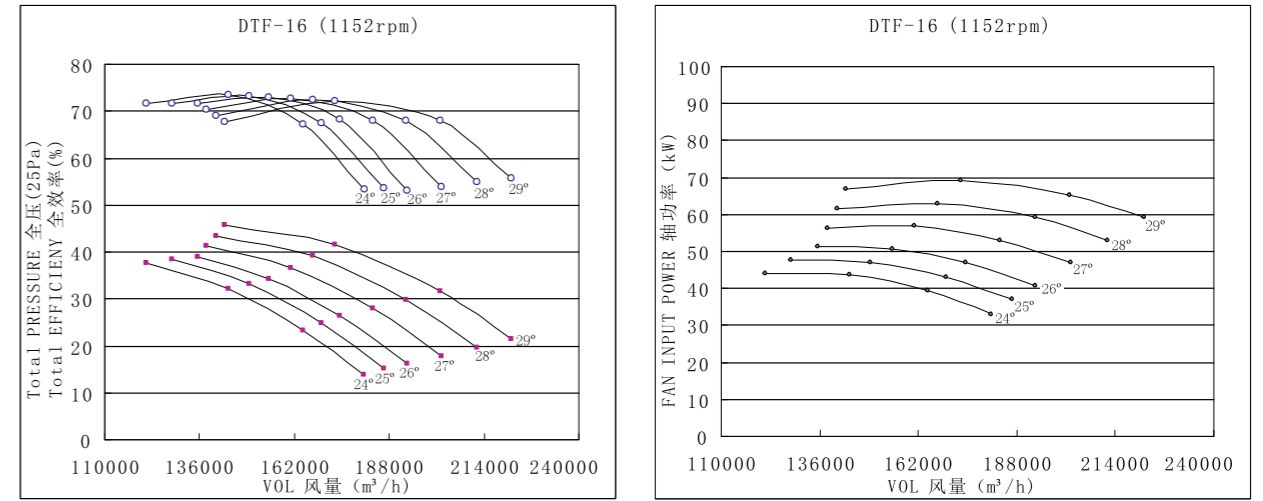

安装角 Pitch	工况点 Work Point	风量 Flow Rate (m³/h)	全压 Total Pressure (Pa)	轴功率 Shaft Power (kW)	电机型号装机容量 Motor Size Power (kW)	总声功率级 Sound Power Level (dB)	重量Weight(kg)		
							风机 Fan excl. motor	电机 motor	运行时 Operating
24°	1	164420	579	39.28	Y280M-6 55	119	1020	590	2415
	2	143916	802	43.60		118			
	3	121488	940	44.13		123			
25°	1	169475	618	43.14	Y280M-6 55	119	1020	590	2415
	2	149486	828	47.14		118			
	3	128489	958	47.69		122			
26°	1	174531	658	46.99	Y315S-6 75	120	1020	990	3015
	2	155056	855	50.67		117			
	3	135489	977	51.25		120			
27°	1	183666	702	53.06	Y315S-6 75	121	1020	990	3015
	2	161080	917	56.81		120			
	3	138011	1032	56.43		122			
28°	1	192801	747	59.14	Y315S-6 75	123	1020	990	3015
	2	167105	979	62.95		122			
	3	140532	1086	61.62		124			
29°	1	201935	791	65.21	Y315M-6 90	124	1020	1050	3105
	2	173129	1040	69.09		124			
	3	143054	1141	66.80		126			

各项性能额定值不包括附属物 (附件) 的影响。经认证的性能是A类安装-自由入口, 自由出口。所示值为安装类型A: 自由入口, 自由出口的声功率级 (出口Lwo)。所示声功率级额定值以分贝为单位, 参考声功率为10⁻¹²瓦, 按照AMCA International 标准301计算。

Performance ratings do not include the effects of appurtenances (accessories). Performance certified is for installation type A- Free inlet, Free outlet. Values shown are for outlet Lwo sound. power levels for installation type A: Freeinlet, Free outlet. The sound power level ratings shown are in decibels, referred to 10⁻¹² watts, calculated per AMCA International Standard 301.

DTF 系列轴流通风机性能曲线图、参数表 Performance Curves and Data of DTF Vane Axial Fan

DTF-16(H/S/V) – 8P 轴流通风机性能曲线、参数表 (没有防喘圈)

FEG 75

Performance Curves and Data of DTF-16 (H/S/V) – 8P Vane Axial Fan (without anti-stall ring)

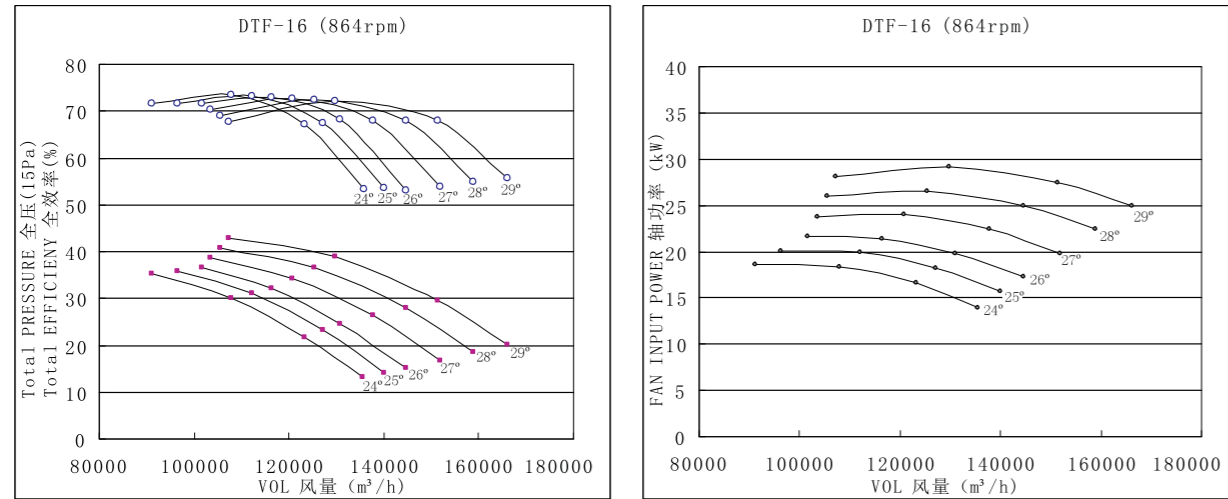

安装角 Pitch	工况点 Work Point	风量 Flow Rate (m³/h)	全压 Total Pressure (Pa)	轴功率 Shaft Power (kW)	电机型号 装机容量 Motor Size Power (kW)	总声功率级 Sound Power Level (dB)	重量Weight(kg)		
							风机 Fan excl. motor	电机 motor	运行时 Operating
24°	1	123315	325	16.57	Y225M-8 22	112	1020	303	1985
	2	107937	451	18.39		111			
	3	91116	529	18.62		116			
25°	1	127106	348	18.20	Y250M-8 30	113	1020	400	2130
	2	112114	466	19.89		111			
	3	96366	539	20.12		115			
26°	1	130898	370	19.82	Y250M-8 30	113	1020	400	2130
	2	116292	481	21.38		110			
	3	101617	549	21.62		113			
27°	1	137749	395	22.39	Y250M-8 30	114	1020	400	2130
	2	120810	516	23.97		113			
	3	103508	580	23.81		115			
28°	1	144600	420	24.95	Y250M-8 30	116	1020	400	2130
	2	125328	550	26.56		115			
	3	105399	611	25.99		117			
29°	1	151452	445	27.51	Y280S-8 37	117	1020	522	2313
	2	129847	585	29.15		117			
	3	107290	642	28.18		119			

各项性能额定值不包括附属物（附件）的影响。经认证的性能是A类安装-自由入口，自由出口。所示值为安装类型A：自由入口，自由出口的声功率级（出口Lwo）。所示声功率级额定值以分贝为单位，参考声功率为10⁻¹²瓦，按照AMCA International 标准301计算。

Performance ratings do not include the effects of appurtenances (accessories). Performance certified is for installation type A- Free inlet , Free outlet. Values shown are for outlet Lwo sound. power levels for installation type A:Freeinlet, Free outlet. The sound power level ratings shown are in decibels, referred to 10⁻¹² watts, calculated per AMCA International Standard 301.

DTF 系列轴流通风机性能曲线图、参数表 Performance Curves and Data of DTF Vane Axial Fan

DTF-18(H/S/V) – 6P 轴流通风机性能曲线、参数表 (带防喘圈)

FEG 80

Performance Curves and Data of DTF-18 (H/S/V) – 6P Vane Axial Fan (with anti-stall ring)

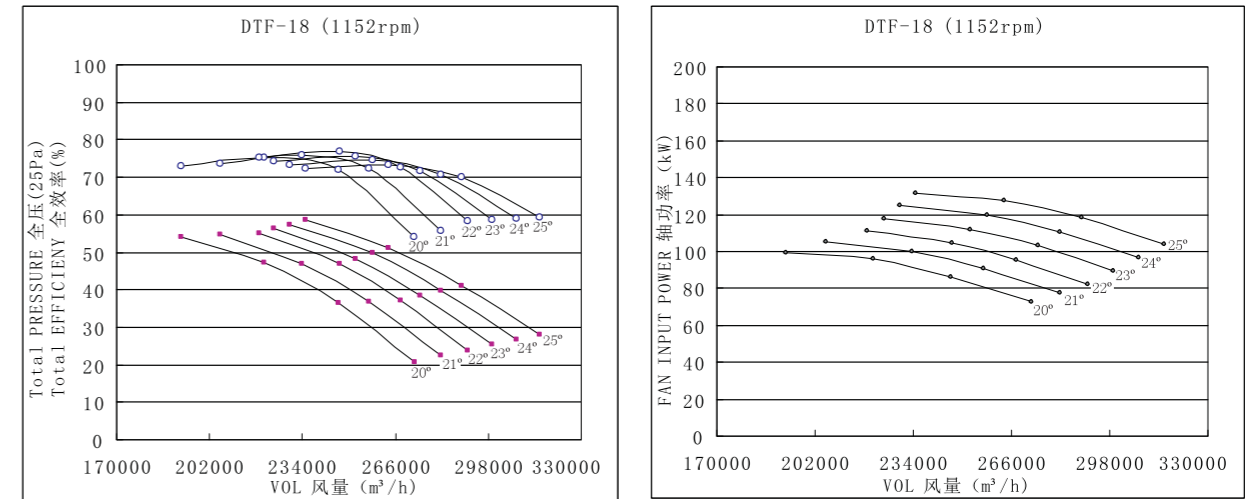

安装角 Pitch	工况点 Work Point	风量 Flow Rate (m³/h)	全压 Total Pressure (Pa)	轴功率 Shaft Power (kW)	电机型号 装机容量 Motor Size Power (kW)	总声功率级 Sound Power Level (dB)	重量Weight(kg)		
							风机 Fan excl. motor	电机 motor	运行时 Operating
20°	1	246237	910	86.29	Y315L2-6 132	125	1125	1190	3473
	2	220797	1181	95.74		124			
	3	192335	1354	99.45		124			
21°	1	256955	921	90.86	Y315L2-6 132	125	1125	1190	3473
	2	233784	1175	100.07		124			
	3	205695	1365	105.19		124			
22°	1	267672	932	95.42	Y315L2-6 132	126	1125	1190	3473
	2	246770	1170	104.41		123			
	3	219055	1376	110.93		124			
23°	1	274699	964	103.13	Y355M1-6 160	128	1125	1590	4073
	2	252426	1206	112.06		127			
	3	224364	1405	117.84		127			
24°	1	281725	997	110.85	Y355M1-6 160	130	1125	1590	4073
	2	258082	1242	119.71		130			
	3	229672	1434	124.74		130			
25°	1	288752	1029	118.56	Y355M1-6 160	133	1125	1590	4073
	2	263738	1278	127.37		133			
	3	234980	1463	131.65		133			

各项性能额定值不包括附属物（附件）的影响。经认证的性能是A类安装-自由入口，自由出口。所示值为安装类型A：自由入口，自由出口的声功率级（出口Lwo）。所示声功率级额定值以分贝为单位，参考声功率为10⁻¹²瓦，按照AMCA International 标准301计算。

Performance ratings do not include the effects of appurtenances (accessories). Performance certified is for installation type A- Free inlet , Free outlet. Values shown are for outlet Lwo sound. power levels for installation type A:Freeinlet, Free outlet. The sound power level ratings shown are in decibels, referred to 10⁻¹² watts, calculated per AMCA International Standard 301.

DTF 系列轴流通风机性能曲线图、参数表 Performance Curves and Data of DTF Vane Axial Fan

DTF-18(H/S/V) – 8P 轴流通风机性能曲线、参数表 (带防喘圈)

FEG 80

Performance Curves and Data of DTF-18 (H/S/V) – 8P Vane Axial Fan (with anti-stall ring)

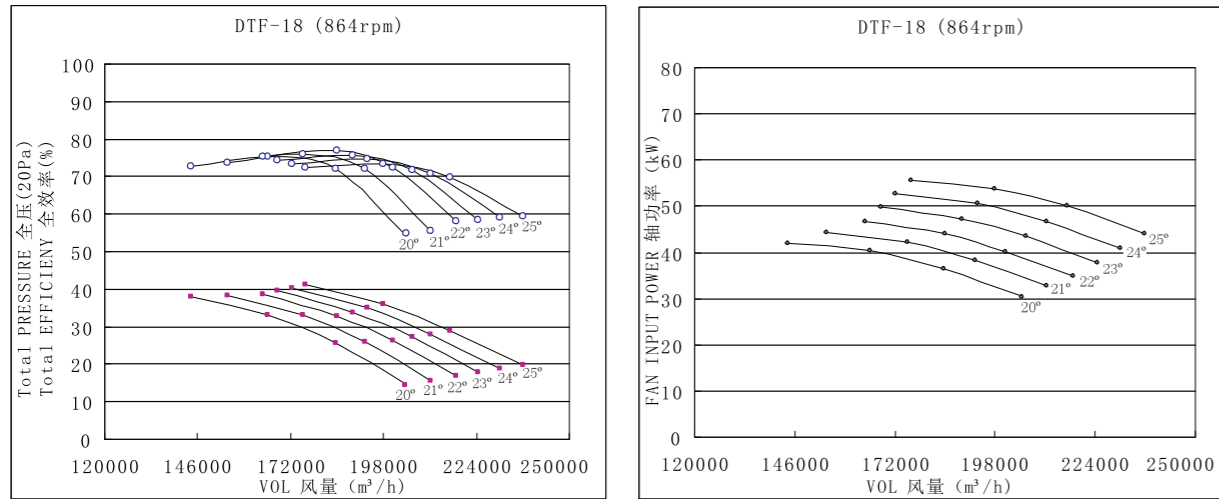

安装角 Pitch	工况点 Work Point	风量 Flow Rate (m³/h)	全压 Total Pressure (Pa)	轴功率 Shaft Power (kW)	电机型号 装机容量 Motor Size Power (kW)	总声功率级 Sound Power Level (dB)	重量Weight(kg)		
							风机 Fan excl. motor	电机 motor	运行时 Operating
20°	1	184678	512	36.40	Y315S-8 55	118	1125	830	2933
	2	165598	664	40.39		117			
	3	144251	762	41.96		117			
21°	1	192716	518	38.33	Y315S-8 55	119	1125	830	2933
	2	175338	661	42.22		117			
	3	154271	768	44.38		117			
22°	1	200754	524	40.26	Y315S-8 55	119	1125	830	2933
	2	185078	658	44.05		117			
	3	164291	774	46.80		118			
23°	1	206024	542	43.51	Y315M-8 75	121	1125	990	3173
	2	189320	678	47.28		120			
	3	168273	790	49.71		120			
24°	1	211294	561	46.76	Y315M-8 75	123	1125	990	3173
	2	193562	699	50.50		123			
	3	172254	806	52.63		123			
25°	1	216564	579	50.02	Y315M-8 75	126	1125	990	3173
	2	197804	719	53.73		126			
	3	176235	823	55.54		126			

各项性能额定值不包括附属物 (附件) 的影响。经认证的性能是A类安装-自由入口, 自由出口。所示值为安装类型A: 自由入口, 自由出口的声功率级 (出口Lwo)。所示声功率级额定值以分贝为单位, 参考声功率为10⁻¹²瓦, 按照AMCA International 标准301计算。

Performance ratings do not include the effects of appurtenances (accessories). Performance certified is for installation type A- Free inlet, Free outlet. Values shown are for outlet Lwo sound. power levels for installation type A:Freeinlet, Free outlet. The sound power level ratings shown are in decibels, referred to 10⁻¹² watts, calculated per AMCA International Standard 301.

DTF 系列轴流通风机性能曲线图、参数表 Performance Curves and Data of DTF Vane Axial Fan

DTF-20(H/S/V) – 6P 轴流通风机性能曲线、参数表 (带防喘圈)

FEG 80

Performance Curves and Data of DTF-20 (H/S/V) – 6P Vane Axial Fan (with anti-stall ring)

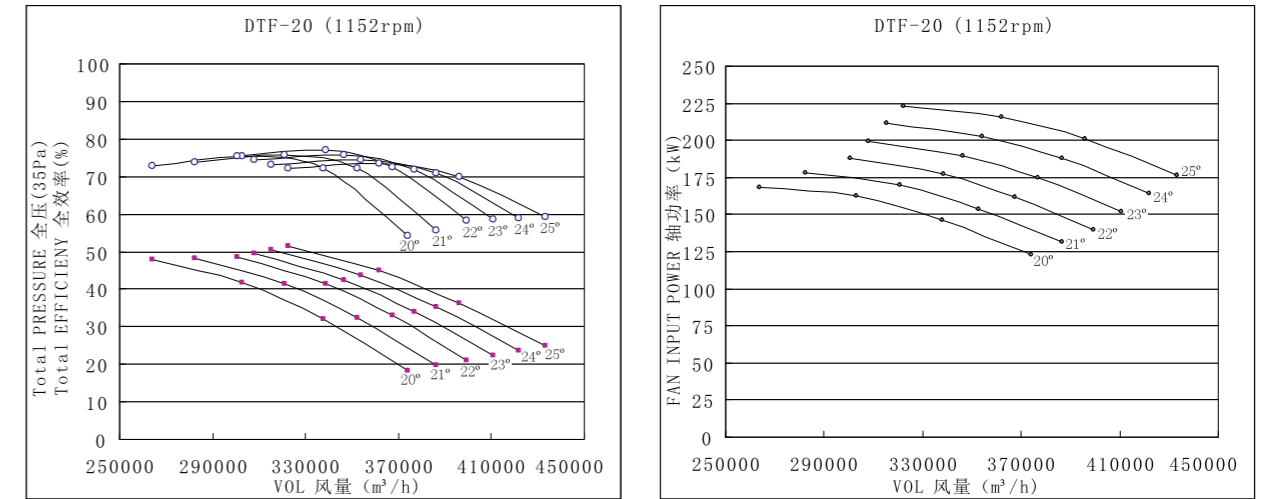

安装角 Pitch	工况点 Work Point	风量 Flow Rate (m³/h)	全压 Total Pressure (Pa)	轴功率 Shaft Power (kW)	电机型号 装机容量 Motor Size Power (kW)	总声功率级 Sound Power Level (dB)	重量Weight(kg)		
							风机 Fan excl. motor	电机 motor	运行时 Operating
20°	1	337858	1124	146.20	Y355M2-6 200	128	1880	1750	5445
	2	302952	1458	162.21		127			
	3	263900	1672	168.49		127			
21°	1	352563	1137	153.93	Y355L1-6 220	129	1880	2130	6015
	2	320770	1451	169.55		127			
	3	282231	1685	178.21		127			
22°	1	367268	1150	161.66	Y355L1-6 220	129	1880	2130	6015
	2	338589	1445	176.89		127			
	3	300562	1699	187.94		128			
23°	1	376909	1191	174.73	Y355L2-6 250	131	1880	2200	6120
	2	346350	1489	189.85		130			
	3	307845	1735	199.64		130			
24°	1	386550	1231	187.80	Y355L2-6 250	134	1880	2200	6120
	2	354110	1534	202.82		133			
	3	315129	1770	211.34		133			
25°	1	396191	1271	200.87	Y355L2-6 250	136	1880	2200	6120
	2	361871	1578	215.79		136			
	3	322413	1806	223.04		136			

各项性能额定值不包括附属物 (附件) 的影响。经认证的性能是A类安装-自由入口, 自由出口。所示值为安装类型A: 自由入口, 自由出口的声功率级 (出口Lwo)。所示声功率级额定值以分贝为单位, 参考声功率为10⁻¹²瓦, 按照AMCA International 标准301计算。

Performance ratings do not include the effects of appurtenances (accessories). Performance certified is for installation type A- Free inlet, Free outlet. Values shown are for outlet Lwo sound. power levels for installation type A:Freeinlet, Free outlet. The sound power level ratings shown are in decibels, referred to 10⁻¹² watts, calculated per AMCA International Standard 301.

DTF 系列轴流通风机性能曲线图及参数表 Performance Curves and Data of DTF Vane Axial Fan

DTF-20(H/S/V) – 8P 轴流通风机性能曲线、参数表 (带防喘圈)

FEG 80

Performance Curves and Data of DTF-20 (H/S/V) – 8P Vane Axial Fan (with anti-stall ring)

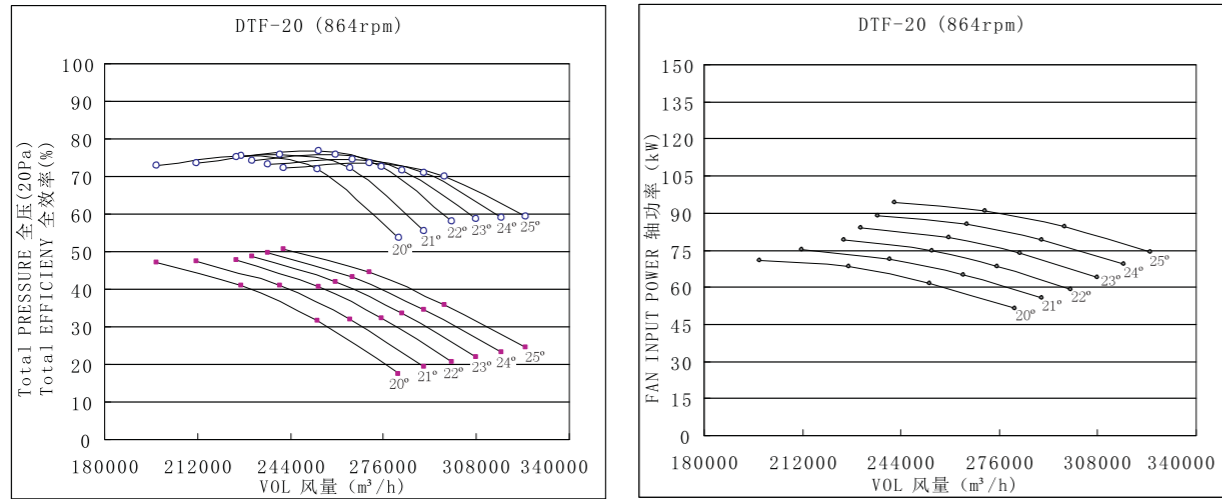

安装角 Pitch	工况点 Work Point	风量 Flow Rate (m³/h)	全压 Total Pressure (Pa)	轴功率 Shaft Power (kW)	电机型号 装机容量 Motor Size Power (kW)	总声功率级 Sound Power Level (dB)	重量Weight(kg)		
							风机 Fan excl. motor	电机 motor	运行时 Operating
20°	1	253393	632	61.68	Y315L1-8 90	121	1880	1130	4515
	2	227214	820	68.43		120			
	3	197925	941	71.08		120			
21°	1	264422	640	64.94	Y315L1-8 90	122	1880	1130	4515
	2	240578	816	71.53		120			
	3	211673	948	75.18		121			
22°	1	275451	647	68.20	Y315L1-8 90	122	1880	1130	4515
	2	253942	813	74.62		120			
	3	225421	956	79.29		121			
23°	1	282682	670	73.71	Y315L2-8 110	124	1880	1230	4665
	2	259762	838	80.09		123			
	3	230884	976	84.22		124			
24°	1	289913	692	79.23	Y315L2-8 110	127	1880	1230	4665
	2	265583	863	85.57		126			
	3	236347	996	89.16		126			
25°	1	297143	715	84.74	Y315L2-8 110	129	1880	1230	4665
	2	271403	888	91.04		129			
	3	241809	1016	94.09		129			

各项性能额定值不包括附属物（附件）的影响。经认证的性能是A类安装-自由入口，自由出口。所示值为安装类型A：自由入口，自由出口的声功率级（出口Lwo）。所示声功率级额定值以分贝为单位，参考声功率为10⁻¹²瓦，按照AMCA International 标准301计算。

Performance ratings do not include the effects of appurtenances (accessories). Performance certified is for installation type A- Free inlet , Free outlet. Values shown are for outlet Lwo sound. power levels for installation type A:Freeinlet, Free outlet. The sound power level ratings shown are in decibels, referred to 10⁻¹² watts, calculated per AMCA International Standard 301.

DTF 系列轴流通风机性能曲线图、参数表 Performance Curves and Data of DTF Vane Axial Fan

DTF-25(H/S/V) – 8P 轴流通风机性能曲线、参数表 (带防喘圈)

FEG 80

Performance Curves and Data of DTF-25 (H/S/V) – 8P Vane Axial Fan (with anti-stall ring)

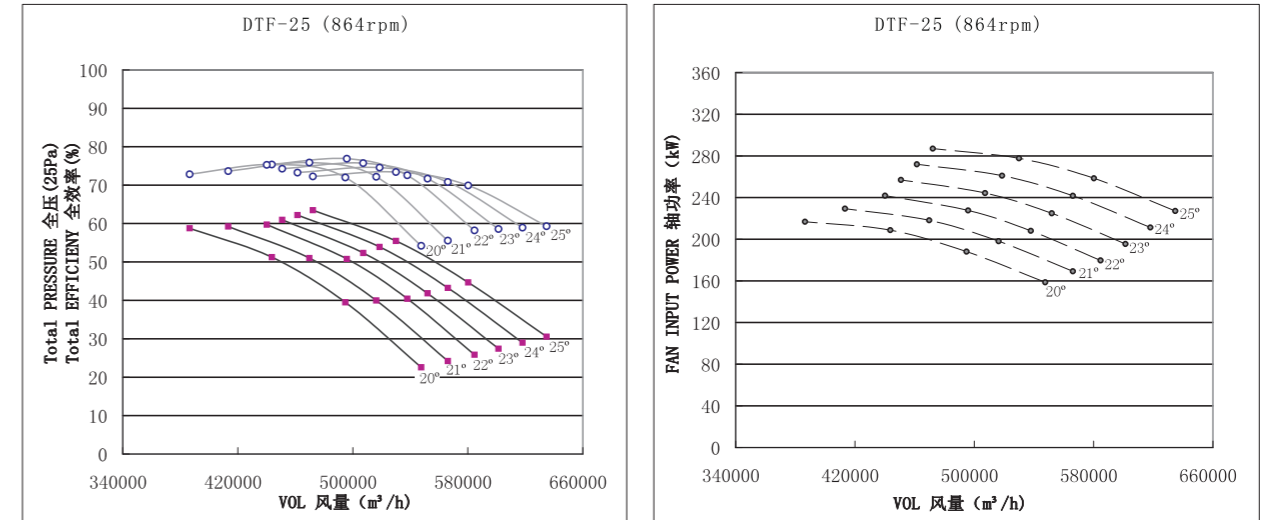

安装角 Pitch	工况点 Work Point	风量 Flow Rate (m³/h)	全压 Total Pressure (Pa)	轴功率 Shaft Power (kW)	电机型号 装机容量 Motor Size Power (kW)	总声功率级 Sound Power Level (dB)	重量Weight(kg)		
							风机 Fan excl. motor	电机 motor	运行时 Operating
20°	1	494786	987	188.14	Y400S-8 250	128	3350	2376	8589
	2	443667	1281	208.75		127			
	3	386476	1469	216.83		128			
21°	1	516321	999	198.10	Y400M-8 280	129	3350	2452	8703
	2	469762	1275	218.19		127			
	3	413321	1481	229.35		127			
22°	1	537857	1011	208.05	Y400M-8 280	129	3350	2452	8703
	2	495857	1270	227.64		127			
	3	440167	1493	241.87		128			
23°	1	551976	1046	224.87	Y400L-8 315	131	3350	2587	8906
	2	507222	1309	244.33		130			
	3	450833	1524	256.92		130			
24°	1	566095	1081	241.68	Y400L-8 315	134	3350	2587	8906
	2	518587	1348	261.02		133			
	3	461500	1556	271.98		133			
25°	1	580214	1117	258.50	Y450L-8 355	136	3350	3290	9960
	2	529952	1387	277.71		136			
	3	472167	1587	287.04		136			

各项性能额定值不包括附属物（附件）的影响。经认证的性能是A类安装-自由入口，自由出口。所示值为安装类型A：自由入口，自由出口的声功率级（出口Lwo）。所示声功率级额定值以分贝为单位，参考声功率为10⁻¹²瓦，按照AMCA International 标准301计算。

Performance ratings do not include the effects of appurtenances (accessories). Performance certified is for installation type A- Free inlet , Free outlet. Values shown are for outlet Lwo sound. power levels for installation type A:Freeinlet, Free outlet. The sound power level ratings shown are in decibels, referred to 10⁻¹² watts, calculated per AMCA International Standard 301.

DTF 系列轴流通风机性能曲线图、参数表 Performance Curves and Data of DTF Vane Axial Fan

DTF-25(H/S/V) – 10P 轴流通风机性能曲线、参数表 (带防喘圈) **FEG 80**

Performance Curves and Data of DTF-25 (H/S/V) – 10P Vane Axial Fan (with anti-stall ring)

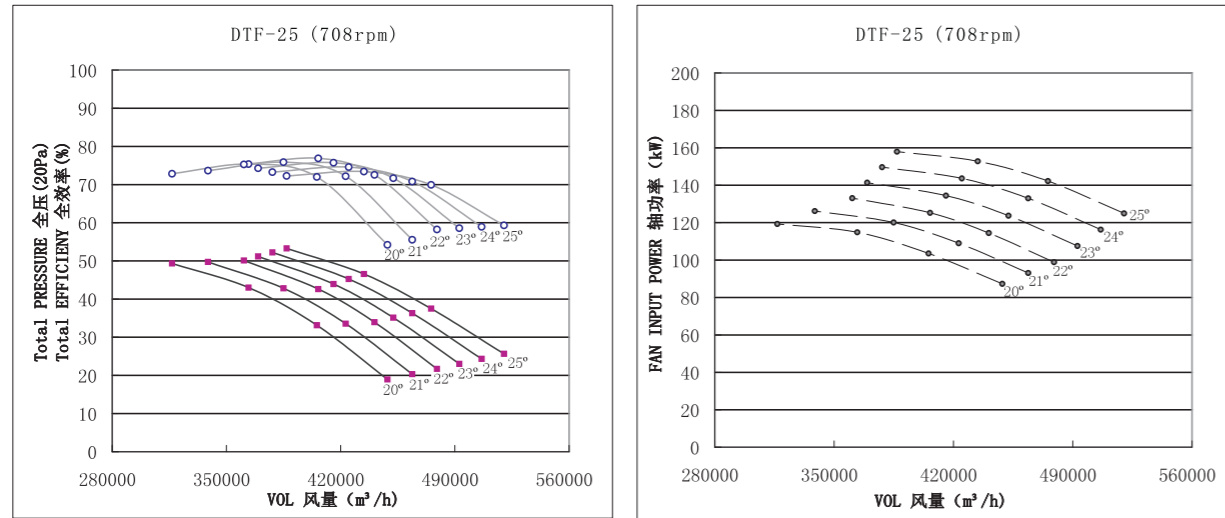

安装角 Pitch	工况点 Work Point	风量 Flow Rate (m³/h)	全压 Total Pressure (Pa)	轴功率 Shaft Power (kW)	电机型号 装机容量 Motor Size Power (kW)	总声功率级 Sound Power Level (dB)	重量Weight(kg)		
							风机 Fan excl. motor	电机 motor	运行时 Operating
20°	1	405449	663	103.53	Y355L1-10 160	124	3350	1880	7845
	2	363560	860	114.86		122			
	3	316696	987	119.31		122			
21°	1	423097	671	109.00	Y355L1-10 160	124	3350	1880	7845
	2	384944	856	120.06		122			
	3	338694	995	126.20		123			
22°	1	440744	679	114.48	Y355L1-10 160	124	3350	1880	7845
	2	406327	852	125.26		122			
	3	360692	1002	133.09		123			
23°	1	452314	703	123.73	Y355L2-10 185	127	3350	2365	8573
	2	415640	879	134.44		125			
	3	369433	1024	141.37		126			
24°	1	463884	726	132.99	Y355L2-10 185	129	3350	2365	8573
	2	424953	905	143.62		128			
	3	378174	1045	149.66		128			
25°	1	475453	750	142.24	Y355L2-10 185	131	3350	2365	8573
	2	434267	931	152.81		131			
	3	386914	1066	157.94		131			

各项性能额定值不包括附属物(附件)的影响。经认证的性能是A类安装-自由入口,自由出口。所示值为安装类型A:自由入口,自由出口的声功率级(出口Lwo)。所示声功率级额定值以分贝为单位,参考声功率为10⁻¹²瓦,按照AMCA International标准301计算。

Performance ratings do not include the effects of appurtenances (accessories). Performance certified is for installation type A- Free inlet, Free outlet. Values shown are for outlet Lwo sound. power levels for installation type A:Freeinlet, Free outlet. The sound power level ratings shown are in decibels, referred to 10⁻¹² watts, calculated per AMCA International Standard 301.

DTF 系列轴流通风机性能曲线图、参数表 Performance Curves and Data of DTF Vane Axial Fan

DTF-28(H/S/V) – 8P 轴流通风机性能曲线、参数表 (带防喘圈) **FEG 80**

Performance Curves and Data of DTF-28 (H/S/V) – 8P Vane Axial Fan (with anti-stall ring)

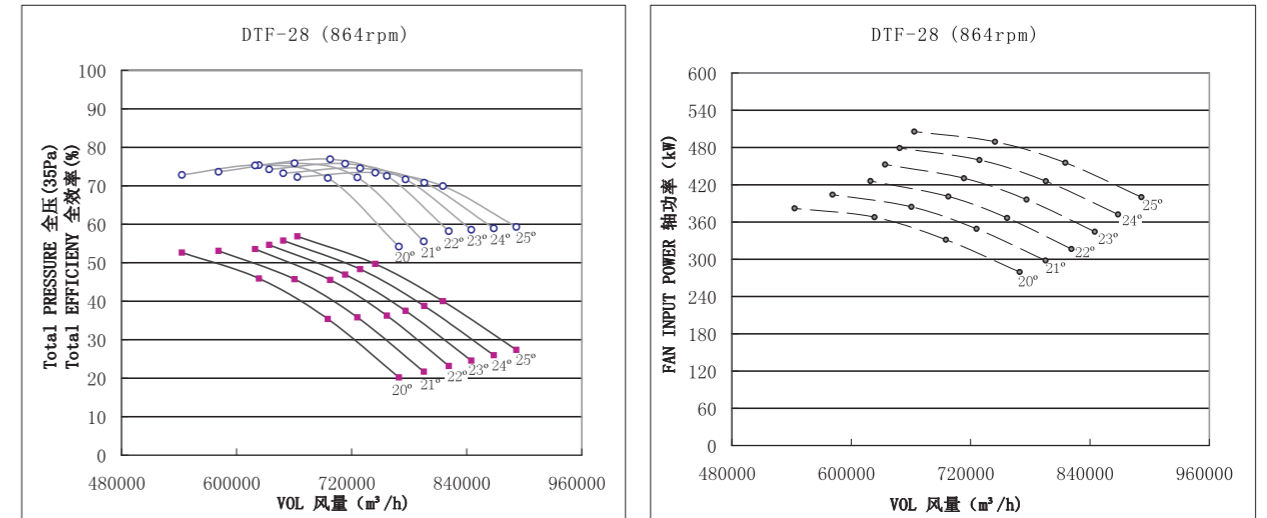

安装角 Pitch	工况点 Work Point	风量 Flow Rate (m³/h)	全压 Total Pressure (Pa)	轴功率 Shaft Power (kW)	电机型号 装机容量 Motor Size Power (kW)	总声功率级 Sound Power Level (dB)	重量Weight(kg)		
							风机 Fan excl. motor	电机 motor	运行时 Operating
20°	1	695138	1239	331.57	Y4503-8 450	132	4150	3250	11100
	2	623320	1607	367.88		130			
	3	542971	1843	382.13		131			
21°	1	725394	1253	349.11	Y5001-8 500	132	4150	4320	12705
	2	659982	1600	384.53		130			
	3	580687	1858	404.19		131			
22°	1	755651	1268	366.65	Y5001-8 500	132	4150	4320	12705
	2	696644	1593	401.18		130			
	3	618402	1873	426.25		131			
23°	1	775487	1312	396.29	Y5002-8 560	135	4150	4470	12930
	2	712611	1642	430.59		133			
	3	633388	1912	452.79		134			
24°	1	795323	1357	425.93	Y5002-8 560	137	4150	4470	12930
	2	728578	1691	460.00		136			
	3	648374	1951	479.32		137			
25°	1	815159	1401	455.57	Y5003-8 630	139	4150	4640	13185
	2	744545	1740	489.41		139			
	3	663360	1991	505.86		139			

各项性能额定值不包括附属物(附件)的影响。经认证的性能是A类安装-自由入口,自由出口。所示值为安装类型A:自由入口,自由出口的声功率级(出口Lwo)。所示声功率级额定值以分贝为单位,参考声功率为10⁻¹²瓦,按照AMCA International标准301计算。

Performance ratings do not include the effects of appurtenances (accessories). Performance certified is for installation type A- Free inlet, Free outlet. Values shown are for outlet Lwo sound. power levels for installation type A:Freeinlet, Free outlet. The sound power level ratings shown are in decibels, referred to 10⁻¹² watts, calculated per AMCA International Standard 301.

DTF 系列轴流通风机性能曲线图、参数表 Performance Curves and Data of DTF Vane Axial Fan

DTF-28(H/S/V) – 10P 轴流通风机性能曲线、参数表（带防喘圈）

FEG 80

Performance Curves and Data of DTF-28 (H/S/V) – 10P Vane Axial Fan (with anti-stall ring)

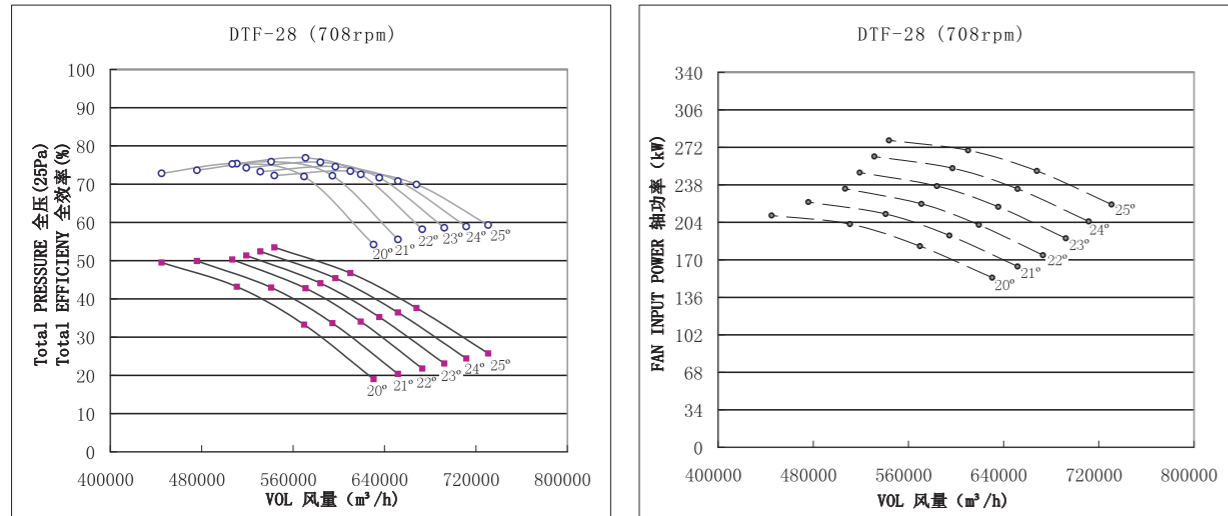

安装角 Pitch	工况点 Work Point	风量 Flow Rate (m³/h)	全压 Total Pressure (Pa)	轴功率 Shaft Power (kW)	电机型号 装机容量 Motor Size Power (kW)	总声 功率级 Sound Power Level (dB)	重量Weight(kg)		
							风机 Fan excl. motor	电机 motor	运行时 Operating
20°	1	569627	832	182.45	Y400L2-10 250	127	4150	2540	10035
	2	510776	1079	202.43		126			
	3	444935	1238	210.27		126			
21°	1	594420	842	192.10	Y4503-10 280	127	4150	3250	11100
	2	540818	1074	211.59		126			
	3	475841	1248	222.41		126			
22°	1	619214	852	201.75	Y4503-10 280	128	4150	3250	11100
	2	570861	1069	220.75		125			
	3	506746	1257	234.54		126			
23°	1	635468	881	218.06	Y4504-10 315	130	4150	3300	11175
	2	583945	1102	236.93		128			
	3	519027	1284	249.14		129			
24°	1	651723	911	234.37	Y4504-10 315	132	4150	3300	11175
	2	597029	1135	253.11		132			
	3	531307	1310	263.75		132			
25°	1	667978	941	250.68	Y4504-10 315	135	4150	3300	11175
	2	610113	1168	269.30		135			
	3	543587	1337	278.35		135			

各项性能额定值不包括附属物（附件）的影响。经认证的性能是A类安装-自由入口，自由出口。所示值为安装类型A：自由入口，自由出口的声功率级（出口Lwo）。所示声功率级额定值以分贝为单位，参考声功率为10⁻¹²瓦，按照AMCA International 标准301计算。

Performance ratings do not include the effects of appurtenances (accessories). Performance certified is for installation type A- Free inlet, Free outlet.

Values shown are for outlet Lwo sound power levels for installation type A: Free inlet, Free outlet. The sound power level ratings shown are in decibels, referred to 10⁻¹² watts, calculated per AMCA International Standard 301.