



Est. 1938

Direct Drive Propeller Wall Fans

Models FN and FQ

Models FN and FQ are high capacity direct drive propeller wall fans designed to deliver large volumes of air at relatively low static pressures. Typical applications include manufacturing and assembly facilities, warehouses, parking garages, sports and agricultural facilities.

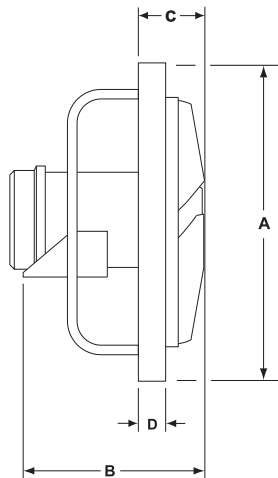

EXHAUST FAN DIMENSIONS				
Fan Model	A	B	C	D
FQ09	14.00	7.57	2.06	1.83
FQ10	14.00	7.57	2.06	1.83
FQ12	18.00	15.00	4.50	1.54
FQ14	18.00	15.00	4.50	1.54
FN14	18.00	11.00	3.75	1.50
FQ16	23.00	19.00	5.50	1.50
FN16	23.00	13.00	4.50	1.50
FQ18	23.00	19.00	5.50	1.50
FN18	23.00	13.00	4.50	1.50
FQ21	26.50	17.25	6.00	1.50
FN21	26.50	15.00	5.00	1.75
FQ24	30.00	20.00	6.50	1.75
FN24	30.00	17.50	6.00	1.75
FQ30	37.50	26.25	7.50	1.75
FN30	37.50	22.44	8.00	1.75
FQ36	45.00	24.75	8.00	1.63
FN36	45.00	20.00	9.00	1.75
FN42	60.00	24.00	2.88	3.06
FN48	64.00	25.50	3.00	3.06

Dimensions are shown in inches.



U.L. 705 Listed

Consult your Acme representative for availability.



Acme Engineering & Manufacturing Corporation certifies that the models shown herein are licensed to bear the AMCA Seal. The ratings shown are based on tests and procedures performed in accordance with AMCA Publication 211 and AMCA Publication 311 and comply with the requirements of the AMCA Certified Ratings Program.

Construction Features

Model FN

- Capacities range up to 22,400 CFM
- Up to 1 inch static pressure
- Available in 9 sizes from 14" to 48"
- Available for either exhaust or supply ventilation
- Precision balanced heavy duty all welded aluminum propeller with tapered, circular arc airfoil blades



FN MODEL

Model FQ

- Capacities up to 17,800 CFM
- Up to 7/8 inch static pressure
- Available for either exhaust or supply ventilation except models FQ98, 108, 129 and 1210 for exhaust only
- Precision balanced aluminum propeller with advanced teardrop blade design for exceptionally low noise and minimum air turbulence



FQ MODEL

Other Features

Frame and Orifice

- Constructed of all welded heavy gauge steel with charcoal baked enamel
- Deep rolled, streamlined orifice for efficient performance
- Heavy wall steel tube frame for extra strength
- Designed to operate in any position

Motors

- Totally enclosed continuous duty type with sealed ball bearing

Finish

- Charcoal baked enamel finish is standard on all steel parts

Options/Accessories

- Safety Guards
- Dampers
- Coatings
- Solid State Controllers
- Wall Collar Package
- Wall Box Package
- Weather Hood
- Disconnect Switch

PERFORMANCE DATA																
Fan Model	RPM	Tip Speed Ft/Min	HP	Sones @ .100"SP	CFM vs. Static Pressure										Max. BHP	Est. Ship Wt. lbs.
					.000"	.100"	.125"	.250"	.375"	.500"	.625"	.750"	.875"	1.000"		
FQ098LO	1500	3435	1/28	8.0	455	355										15
FQ098HI	1650	3780	1/28	10.0	500	410	385								* 70	15
FQ108LO	1500	3925	1/28	6.0	620	530	505									17
FQ108HI	1650	4320	1/28	6.0	685	600	580								*120	17
FQ1210LO	980	3030	1/28	4.0	870	645	565								.027	27
FQ1210HI	1060	3280	1/28	4.0	940	750	685								.034	27
FQ129LO	1350	4180	1/8	5.0	1200	1075	1030								.069	27
FQ129HI	1550	4795	1/8	6.0	1380	1280	1245	1035							.105	27
FQ12D4	1760	5445	1/6	8.0	1565	1475	1450	1295	1090						.158	29
FQ14C6	1160	4150	1/8	7.0	1625	1440	1375								.100	32
FQ14F4	1760	6295	1/3	14.0	2460	2380	2350	2170	1940						.353	35
FN14D4	1760	6450	1/6	14.0	1880	1780	1750	1600	1430						.208	32
FN14E4	1760	6450	1/4	14.0	2160	2050	2020	1850	1640	1300	965	760			.300	35
FQ16C6	1160	4800	1/6	8.0	2180	2020	1960	1620							.148	37
FQ16F4	1760	7280	1/3	16.0	2580	2490	2460	2320	2150	1850					.390	40
FQ16H4	1760	7280	3/4	17.0	3710	3600	3570	3430	3240	3010	2770				.685	40
FN16F4	1760	7370	1/3	18.1	3229	3038	2990	2683	2212	1766	1510	1325	1178	1033	.530	36
FQ18E6	1160	5505	1/4	9.0	3210	2960	2890	2500							.253	40
FQ18G6	1160	5505	1/2	12.0	4030	3720	3640	3300	2730						.470	48
FQ18H4	1760	8350	3/4	17.0	4870	4720	4670	4450	4220	3960	3700	3350			.870	48
FN18G4	1760	8290	1/2	22	4142	3954	3906	3605	3229	2865	2329	1995	1827	1652	.750	33
FQ21G6	1160	6325	1/2	13.0	5250	5020	4950	4550	4080						.610	83
FQ21K4	1760	9595	1 1/2	24	6750	6570	6530	6300	6050	5780	5490	5160	4700		1.510	91
FN21J4	1760	9670	1	30	6009	5837	5793	5575	5333	5053	4741	4357	3762	3116	1.100	68
FN21K4	1760	9670	1 1/2	30	8150	7930	7880	7590	7250	6880	6440	5840			1.712	82
FQ24F8	860	5430	1/3	10.0	5550	5110	4990	4200							.389	93
FQ24H6	1160	7325	3/4	14.0	7140	6820	6750	6260	5660	4850					.882	93
FN24J6	1160	7280	1	23	8150	7760	7660	7080	6350						.980	121
FN24J4	1760	11050	1	39	6420	6220	6190	5950	5700	5450	5170	4870	4530	4180	1.070	85
FN24L4	1760	11050	2	40	9590	9400	9360	9110	8870	8590	8210	7950	7600	7200	2.100	99
FQ30H8	860	6700	3/4	18	8860	8310	8150	7330	6380						.830	132
FQ30K8	860	6700	1 1/2	14.0	11600	10970	10800	9950	9000						1.370	168
FQ30M6	1160	9035	3	21	15100	14660	14570	13980	13330	12610	11900	11130			3.060	174
FN30L6	1160	9110	2	30	12450	12100	12000	11500	10900	10300	9580	8720	7750		1.96	175
FN30M6	1160	9110	3	31	16040	15500	15420	14750	14000	13150	12050				3.03	213
FQ36K8	860	8020	1 1/2	21	14450	13800	13620	12580	11570						1.640	197
FQ36L8	860	8020	2	22	17800	17000	16800	15800	14700	13300					2.420	203
FN36K8	860	8100	1 1/2	27	13160	12650	12520	11800	10950	9900	8500	6600	5250	4000	1.66	199
FN36L6	1160	10930	2	43	14280	13920	13820	13300	12700	12050	11400	10700	10000		2.26	204
FN36M6	1160	10930	3	43	17740	17360	17270	16780	16200	15600	15000	14300			3.14	244
FN42K8	860	9456	1 1/2	32	17560	16700	16340	14970							1.80	212
FN42L8	860	9456	2	33	19400	18600	18220	16980							2.26	222
FN42M8	860	9456	3	43	22320	21650	21450	20460	19000	16250					3.45	230
FN48K8	860	10800	1 1/2	36	17120	15900	15530	13950	12400	10640	9025	7420	6000	4300	1.71	223
FN48L8	860	10800	2	39	19340	18200	17930	16550	15060	13360	11630	9900	8240	6840	2.19	233
FN48M8	860	10800	3	41	22400	21600	21440	20360	18940	17170	15260	13110	11285	10090	3.01	241

Performance certified is for installation Type A: Free inlet, Free Outlet. The sound ratings shown are loudness values in hemispherical sones at 1.5 m (5 ft) in a hemispherical free field calculated per AMCA Standard 301. Values shown are for Installation Type A: Free Inlet hemispherical sone levels.

Performance ratings do not include the effects of appurtenances (accessories) on models FQ12 through FQ48. Performance ratings include the effect of a back guard (motor side) on models FQ09 and FQ10.

Model numbers shown are for Exhaust Fans with standard direction of airflow (motor on intake side of propeller). To order Supply Fans with direction of airflow reversed (motor on discharge side of propeller) add letter "R" to the model number; example: FN-R14. The brake horsepower capability of a fan motor is dependent on the degree of cooling the motor receives from the moving airstream over the motor. The motor loading beyond the motor nameplate rating does not overheat the motor and is within NEMA recommended limits. It is therefore not detrimental to the motor and is economically desirable.

*Watts

For more information on this product contact your sales support.



Your Representative is

ACME ENGINEERING & MANUFACTURING CORPORATION

P.O. Box 978 | Muskogee, Oklahoma 74402 | Telephone 918/682-7791
Fax 918/682-0134 | www.acmefan.com | e-mail: acmefan@acmefan.com

Member Air Movement and Control Association International, Inc.