

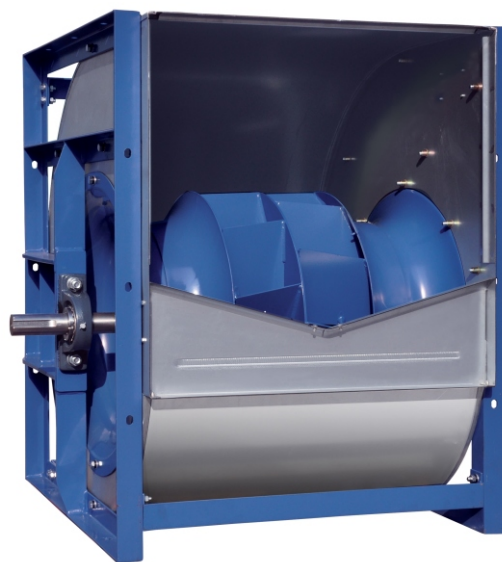

TDF带式传动空调风机

后倾叶轮、双进风
带式传动

TDF Series
DWDI, Backward Blades
CENTRIFUGAL FAN



广东肇庆德通有限公司
Guangdong Zhaoqing Deton Company Ltd.
August 2024



Guangdong Zhaoqing Deton Company Ltd. certifies that the TDF series for model TDF 315 to TDF 1000 shown herein are licensed to bear the AMCA Seal. The ratings shown are based on tests and procedures performed in accordance with AMCA Publication 211 and AMCA Publication 311 and comply with the requirements of the AMCA Certified Ratings Program.

产品命名方式 Designation of Products

TDF - 355 - HM - LG



产品特征 Technical specification

- 叶轮:** 叶轮采用优质钢板制成,按三元流设计叶片与激光加工的中盘及拉伸前盘焊接而成.具有高精度特性.高转速叶轮还焊接有叶轮加强环加强叶轮结构.

Wheel: backward blade.made of high grade steel sheet, it is to provide a highly efficient and low noise and special-designed blades are welded on the center disc,and inlet belling of impeller.
- 机壳:** 机壳采用优质热镀锌钢板制成.侧板采用数控激光切割而成保证高精度的型线.侧板与涡板之间采用咬口工艺连接, G型风机采用加厚焊接涡壳.

Scroll: made of high grade galvanized steelsheet, and it is cutted by laser-cutting machine with high quality. The scroll plate is connected to the side plate by pittsburgh lock way and welding.
- 框架:** 框架采用角钢或折边角钢焊接或TOX铆接而成,表面采用喷涂处理.

Frame: made of angle sections steel ,and painted with polyester coatings.
- 轴承:** 轴承采用优质调心滚珠轴承. H及G式风机采用带座轴承.

Bearing: out-spherical ball bearing are used in TDF.
- 主轴:** 主轴采用优质 45号钢精加工而成,确保主轴的尺寸及行位公差.每根主轴都经过防锈处理.

Shaft: the shaft is made of C45 carbon steel with high tolerance levels.shaft is provided corrosion resistance.
- 平衡:** 每个叶轮在装配前都经过动平衡,平衡精度满足ISO1940 和AMCA204 标准中G2.5标准.

Balance: all wheel are statically and dynamically balanced to ISO1940 and AMCA 204-G2.5 standard.

轴承配套形式Bearing type

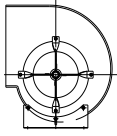
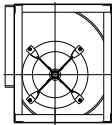
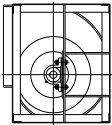
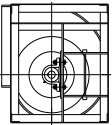
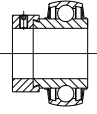
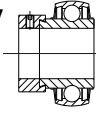
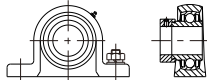
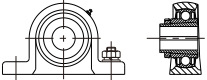
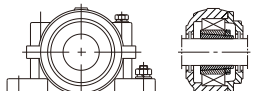
风机形式 Fan type	D 	K 	H 	G 
轻型负载 Light duty	DL 轻载荷 Light duty 	KL 轻载荷 Light duty 	HL 轻载荷 Light duty 	
中型负载 Medium duty			HM 中载荷 Medium duty 	GM 中载荷 Medium duty 

运转极限Operational limits

形式Type		200	225	250	280	315	355	400	450	500	560	630	710	800	900	1000
最大输入功率 Max. power	D-K L kW	1.5	1.5	2	3	4	4.5	5.5	7.5							
	H L kW	2	3	3	5.5	5.5	5.5	6	8	12	14	20	20	18.5	25	
		M kW	2	3	4	8	8	15	15	15	22	30	35	40	30	43
	G M kW									30	38.5	40	60	65	65	80
风机最高转速 Max. speed	D-K L rpm	3600	3400	3000	2800	2600	2100	1800	1500							
	H L rpm	3800	3600	3400	3200	2900	2400	2000	1800	1700	1500	1400	1300	1000	900	
		M rpm	4200	4000	3800	3600	3500	3000	2600	2500	2400	2100	1900	1700	1200	1100
	G M rpm									2800	2500	2200	2000	1600	1400	1300
温度/最低-20℃ Temp. /min. -20℃	D-K Max.℃	85	85	85	85	85	85	85	85							
	H-G Max.℃	100	100	100	100	100	100	100	100	100	100	100	100	100	100	100
风机重量 Fan weight	D	L kg	12	15	19	25	26	37	42	58						
		K L kg	12.5	16	20	26	27	41	45	62						
	H	L kg	16	19	23	29	39	51.5	65	86.5	113	154.5	192.5	246.5	299	368
		M kg	16	19	23	29	40	53	67	89	115.5	158	197	251	299	368
	G M kg										124	166	212	271	323	397



TDF200

Air Density: 1.2 kg/m³

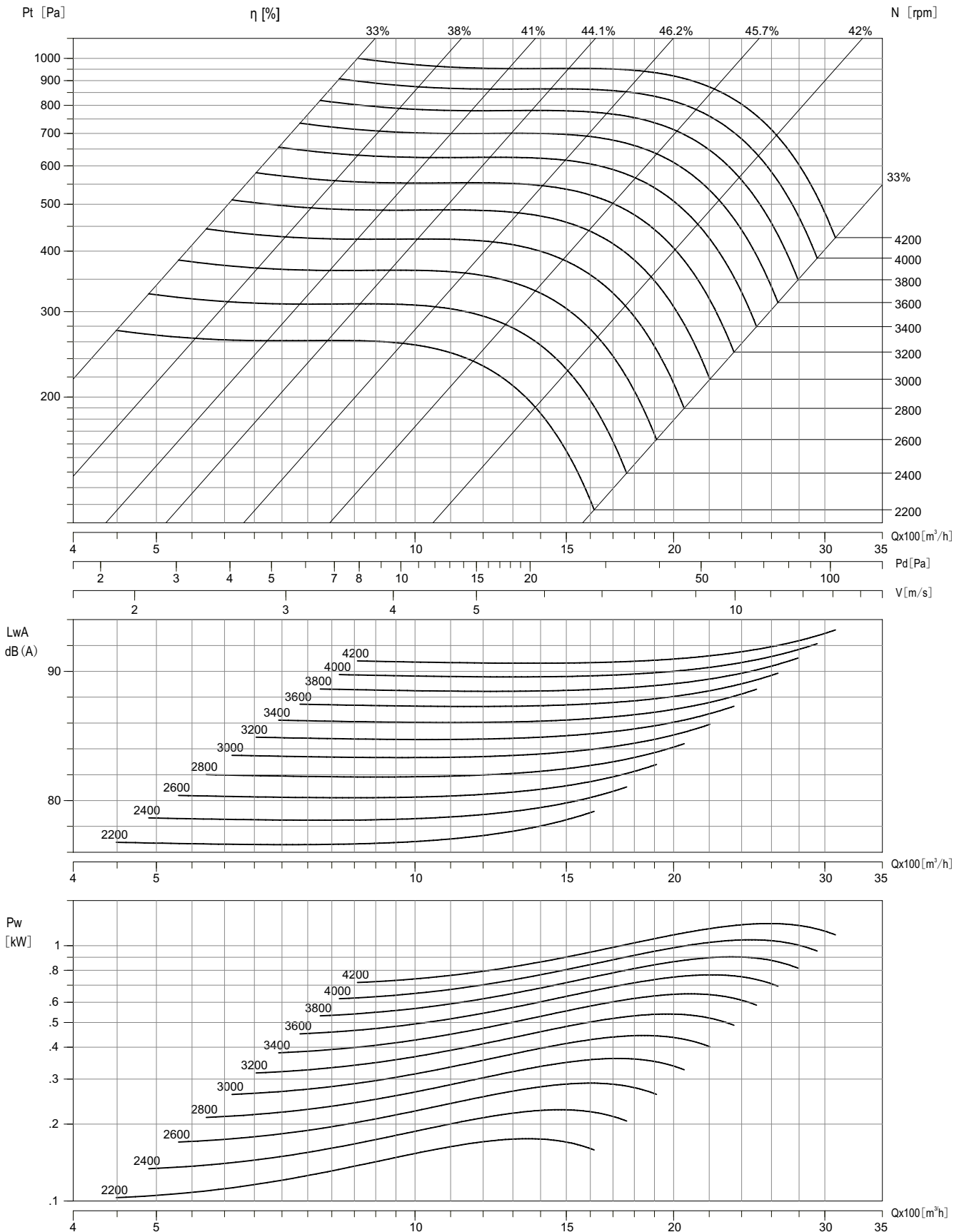

Performance shown is for installation type B-Free inlet, Ducted outlet. Performance ratings do not include the effects of appurtenances (accessories). Power rating kW does not include transmission losses. The A-weighted sound ratings shown have been calculated per AMCA International Standard 301. Values shown are for inlet L_{wiA} sound power levels for Installation type B: free inlet, ducted outlet.

MODEL TDF200 IS NOT LICENSED TO BEAR THE AMCA CERTIFIED RATINGS SEAL.



TDF225

Air Density: 1.2 kg/m³

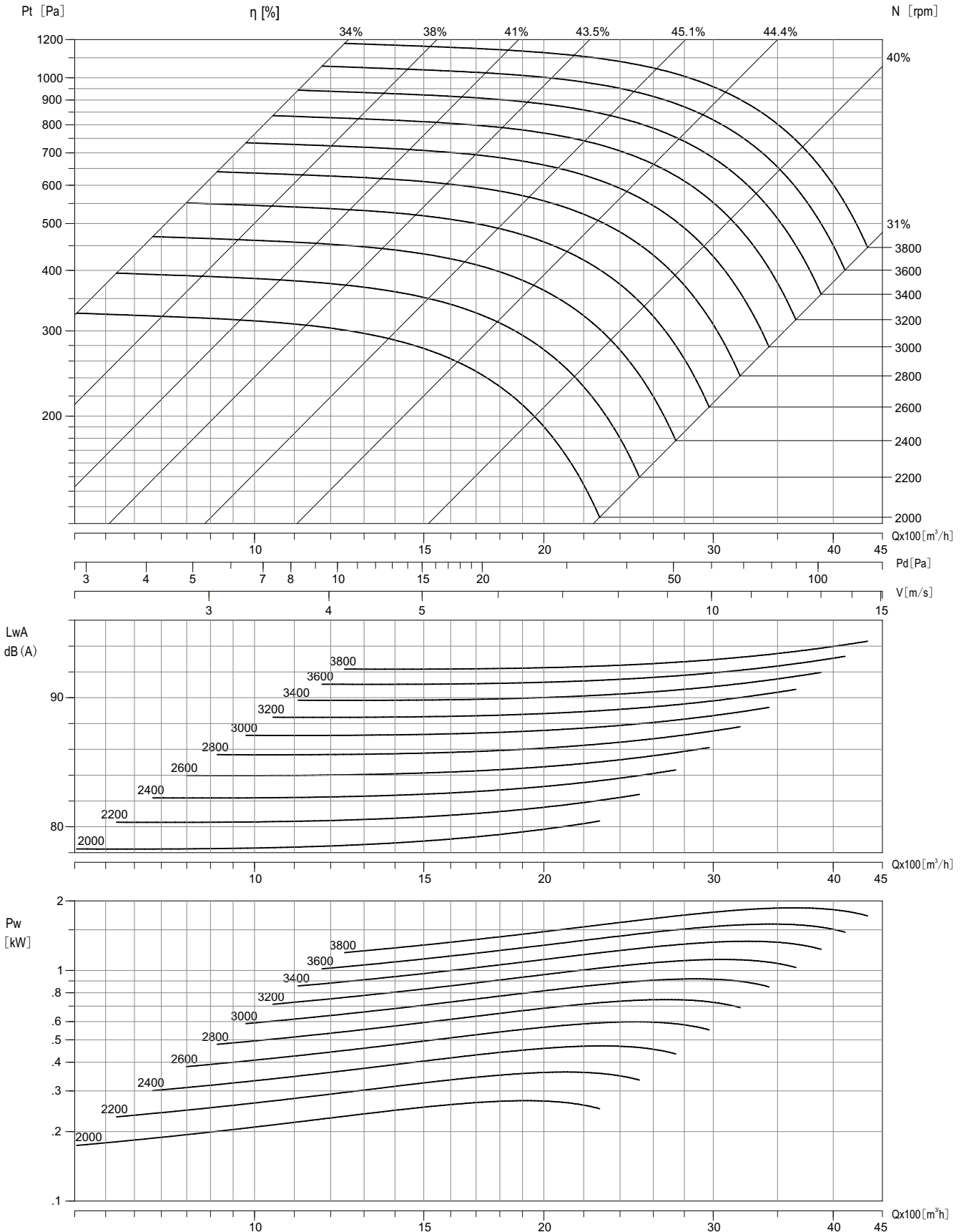

Performance shown is for installation type B-Free inlet, Ducted outlet. Performance ratings do not include the effects of appurtenances (accessories). Power rating kW does not include transmission losses. The A-weighted sound ratings shown have been calculated per AMCA International Standard 301. Values shown are for inlet LwiA sound power levels for Installation type B: free inlet, ducted outlet.

MODEL TDF225 IS NOT LICENSED TO BEAR THE AMCA CERTIFIED RATINGS SEAL.



TDF250

Air Density: 1.2 kg/m³

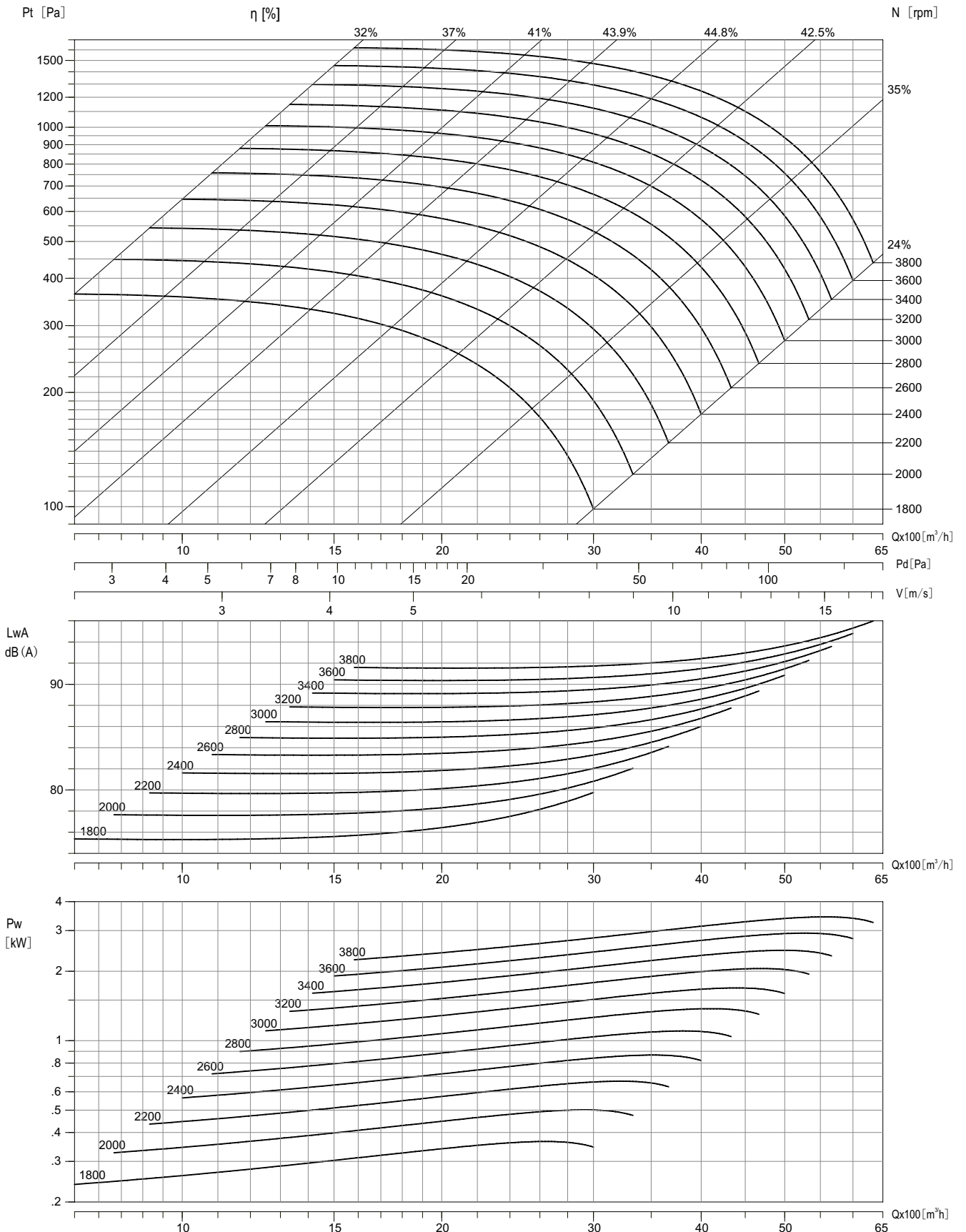

Performance shown is for installation type B-Free inlet, Ducted outlet. Performance ratings do not include the effects of appurtenances (accessories). Power rating kW does not include transmission losses. The A-weighted sound ratings shown have been calculated per AMCA International Standard 301. Values shown are for inlet LwiA sound power levels for Installation type B: free inlet, ducted outlet.

MODEL TDF250 IS NOT LICENSED TO BEAR THE AMCA CERTIFIED RATINGS SEAL.



TDF280

Air Density: 1.2 kg/m³

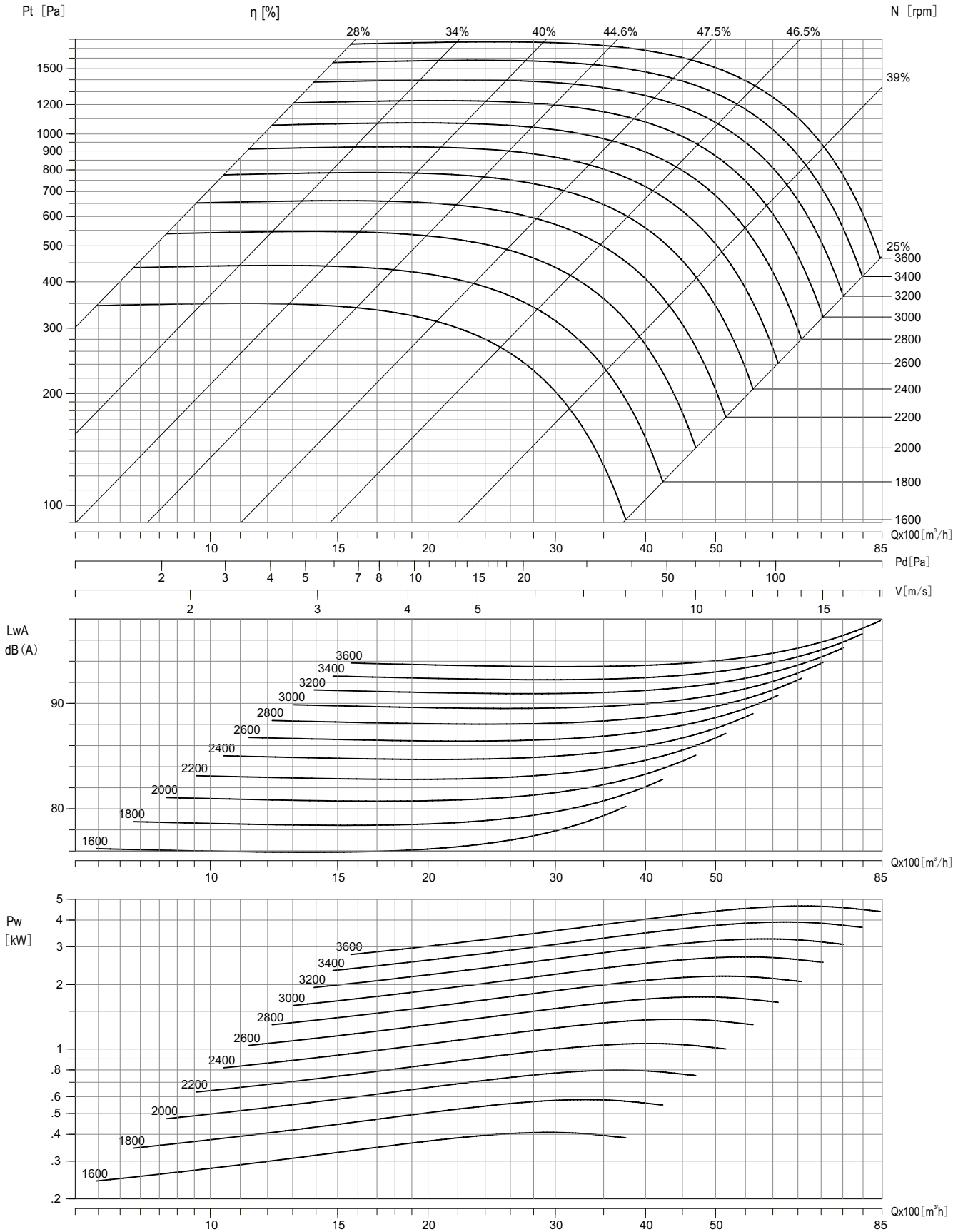

Performance shown is for installation type B-Free inlet, Ducted outlet. Performance ratings do not include the effects of appurtenances (accessories). Power rating kW does not include transmission losses. The A-weighted sound ratings shown have been calculated per AMCA International Standard 301. Values shown are for inlet LwiA sound power levels for Installation type B: free inlet, ducted outlet.

MODEL TDF280 IS NOT LICENSED TO BEAR THE AMCA CERTIFIED RATINGS SEAL.

TDF315

Air Density: 1.2 kg/m³

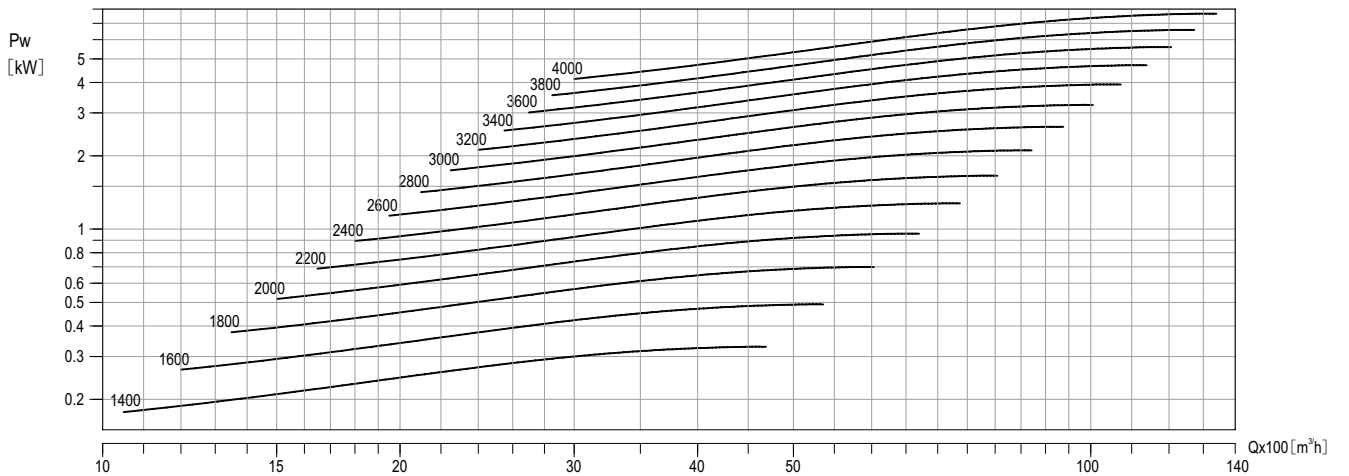
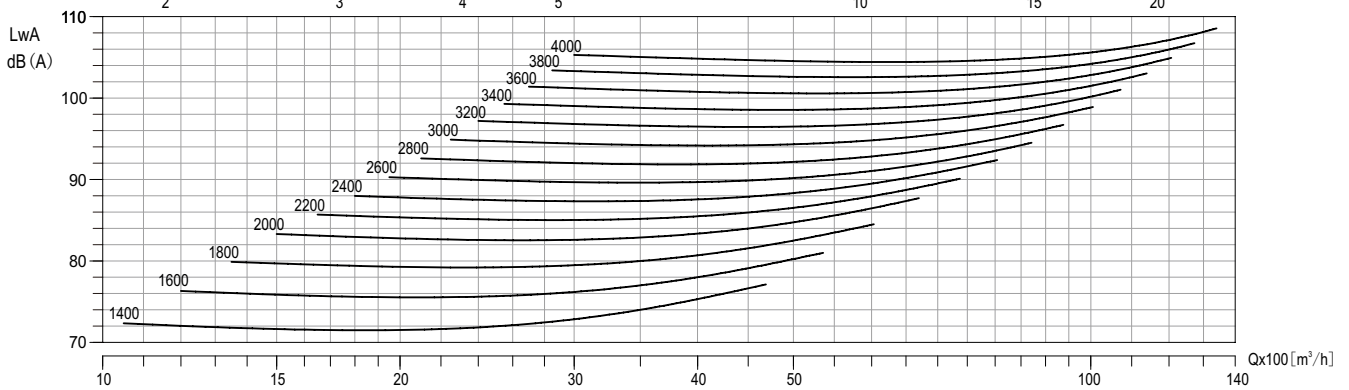
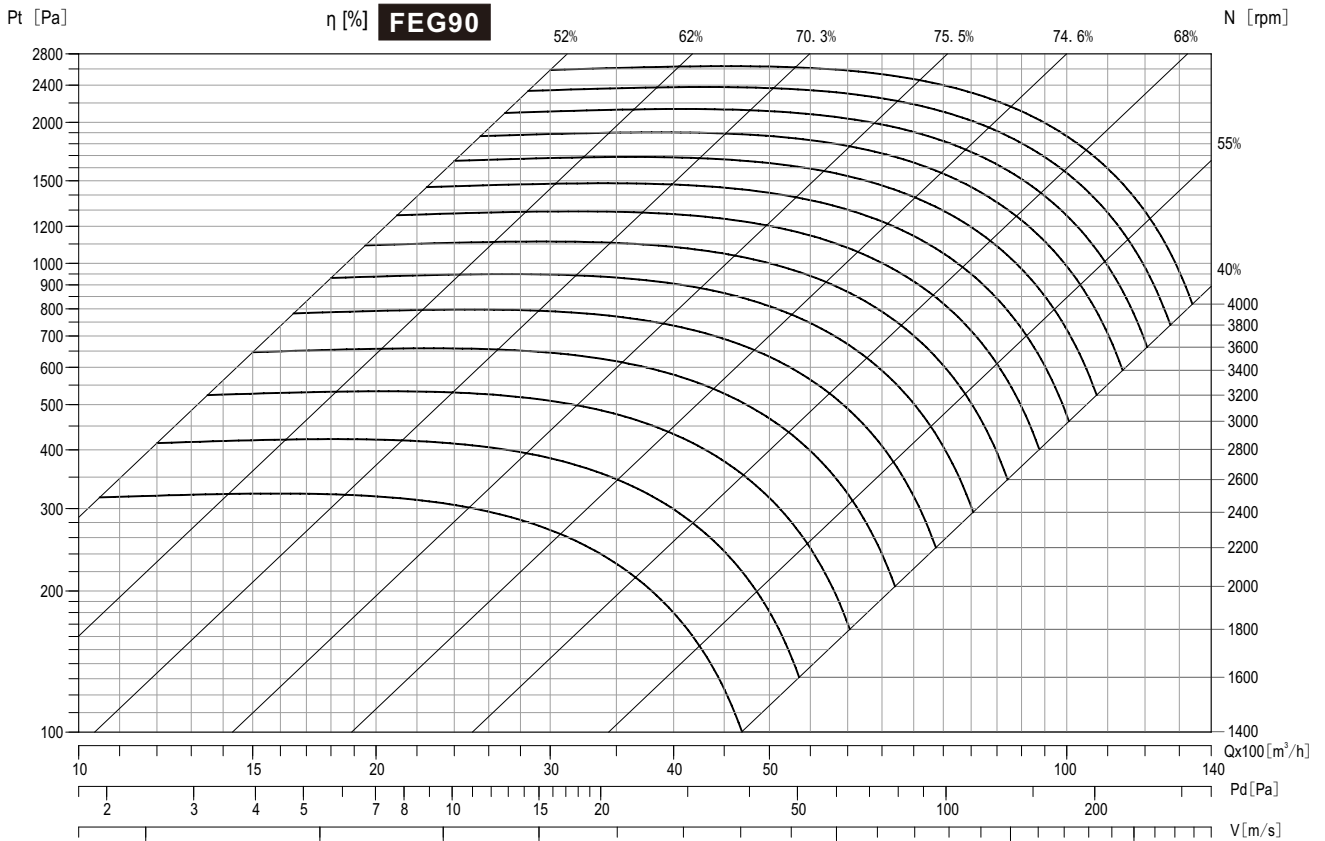

Performance certified is for installation type B-Free inlet, Ducted outlet. Performance ratings do not include the effects of appurtenances (accessories). Power rating kW does not include transmission losses. The A-weighted sound ratings shown have been calculated per AMCA International Standard 301. Values shown are for inlet LwiA sound power levels for Installation type B: free inlet, ducted outlet.



TDF355

Air Density: 1.2 kg/m³

η [%] **FEG75**

N [rpm]

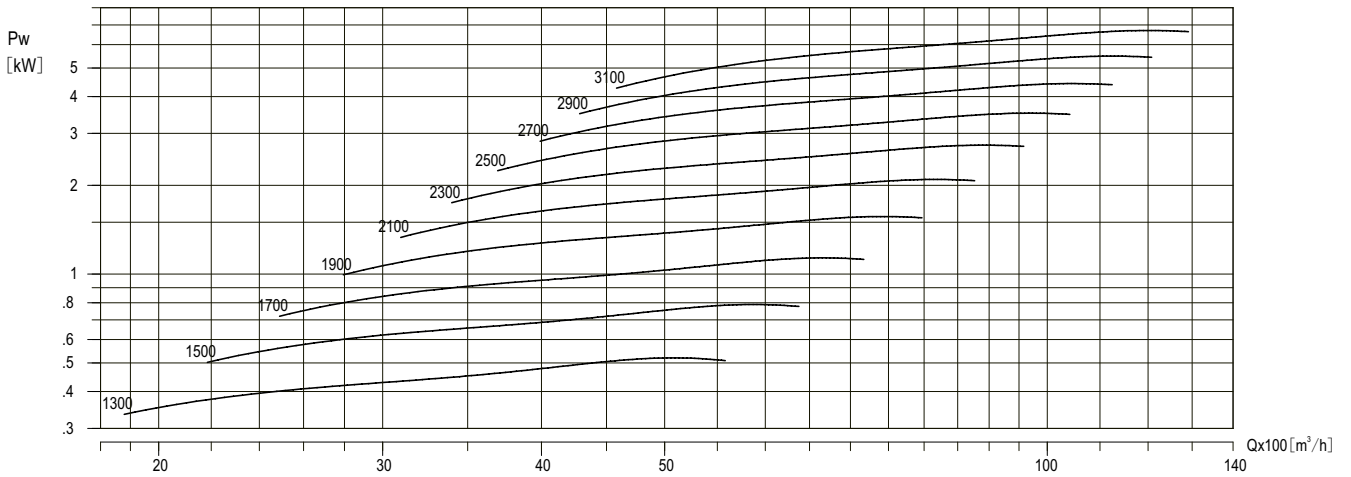
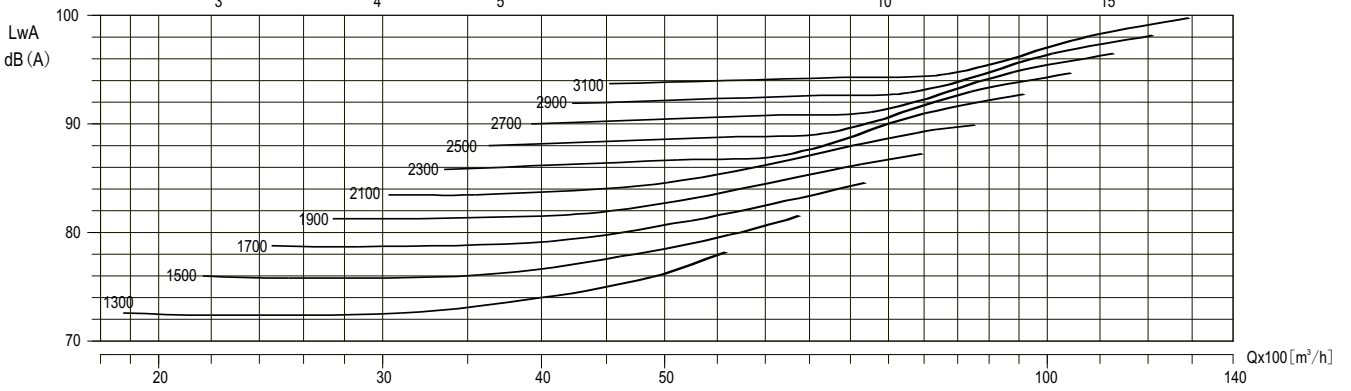
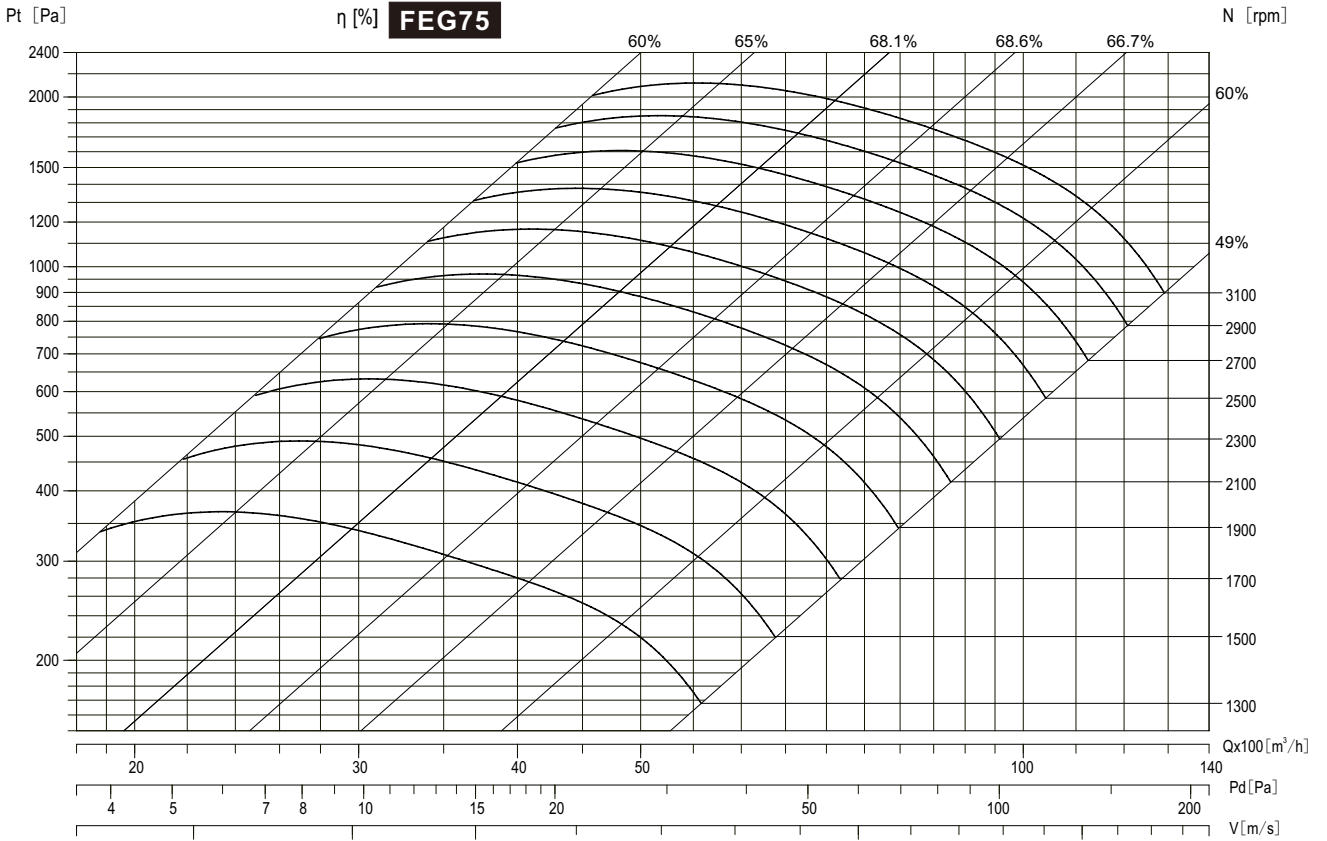

Performance certified is for installation type B-Free inlet, Ducted outlet. Performance ratings do not include the effects of appurtenances (accessories). Power rating kW does not include transmission losses. The A-weighted sound ratings shown have been calculated per AMCA International Standard 301. Values shown are for inlet LwiA sound power levels for Installation type B: free inlet, ducted outlet.



TDF400

Air Density: 1.2 kg/m³

η [%] **FEG85**

N [rpm]

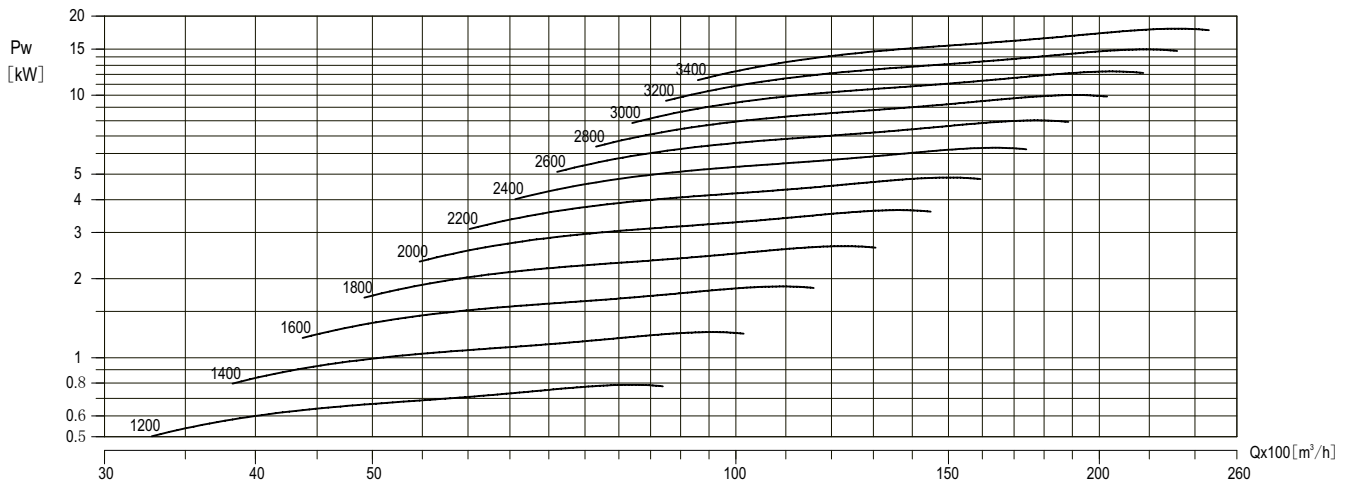
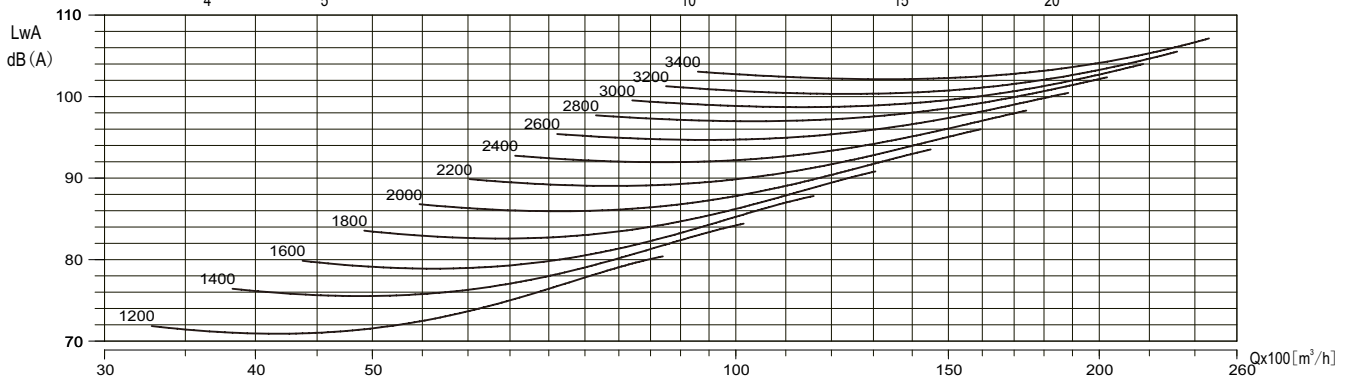
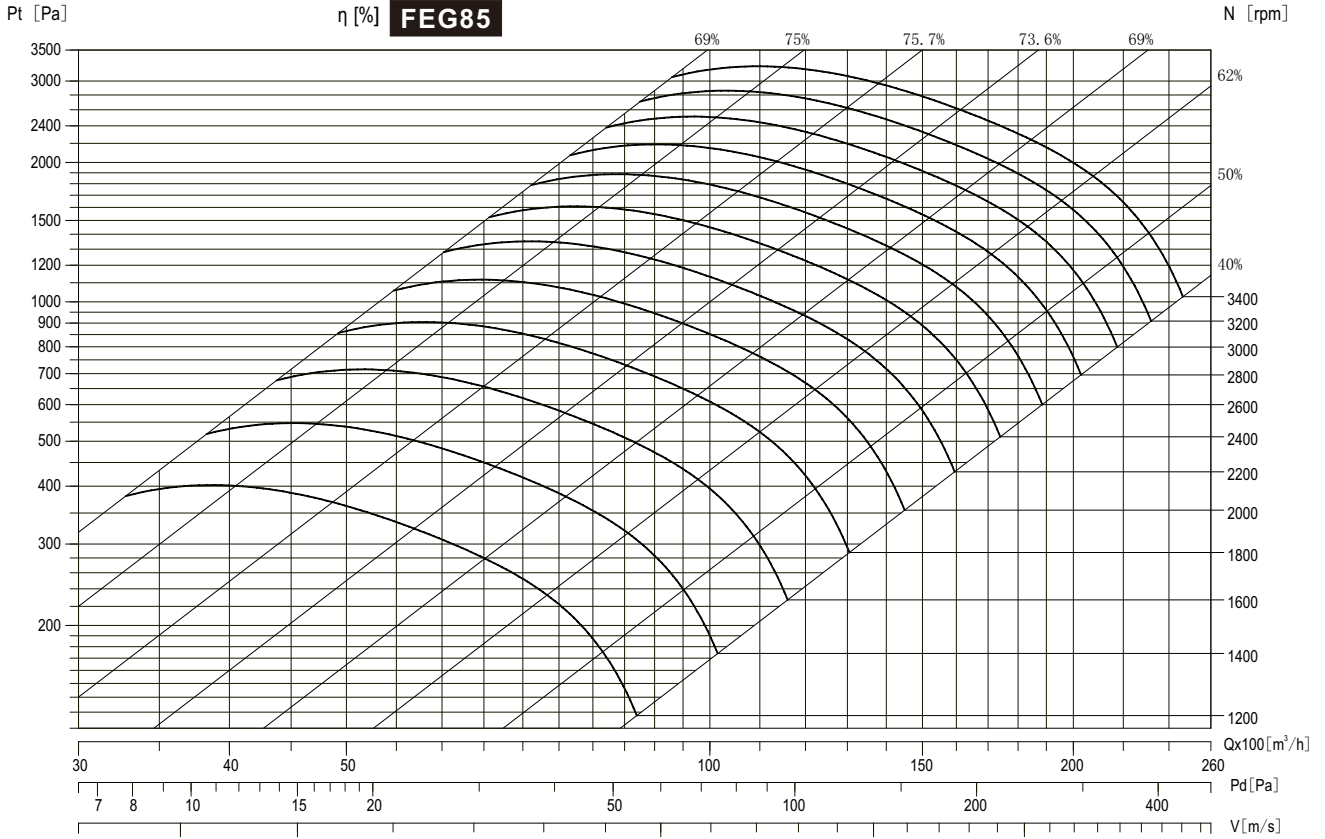

Performance certified is for installation type B-Free inlet, Ducted outlet. Performance ratings do not include the effects of appurtenances (accessories). Power rating kW does not include transmission losses. The A-weighted sound ratings shown have been calculated per AMCA International Standard 301. Values shown are for inlet LwiA sound power levels for Installation type B: free inlet, ducted outlet.



TDF450

Air Density: 1.2 kg/m³

η [%] **FEG85**

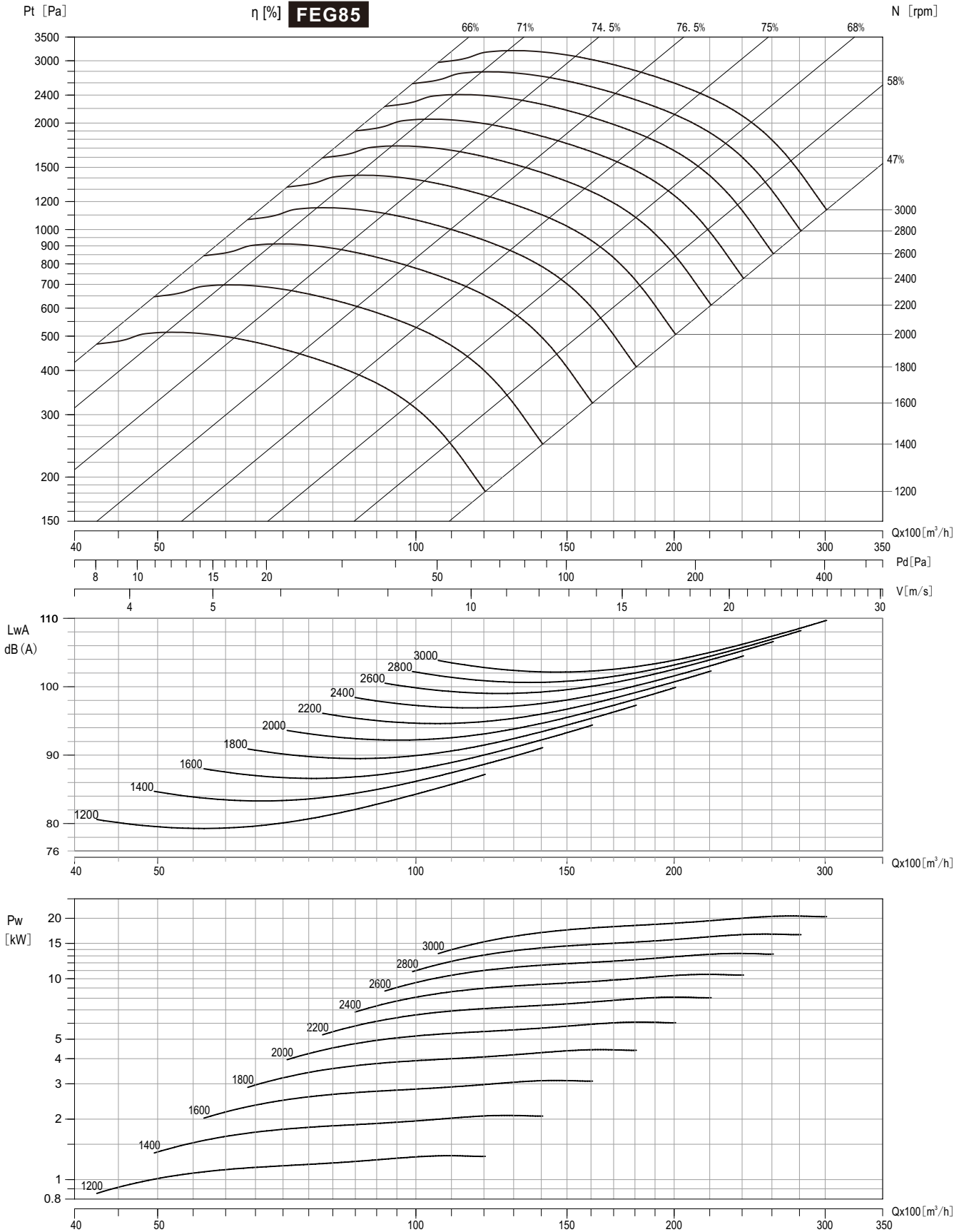

Performance certified is for installation type B-Free inlet, Ducted outlet. Performance ratings do not include the effects of appurtenances (accessories). Power rating kW does not include transmission losses. The A-weighted sound ratings shown have been calculated per AMCA International Standard 301. Values shown are for inlet LwA sound power levels for Installation type B: free inlet, ducted outlet.

TDF500

Air Density: 1.2 kg/m³

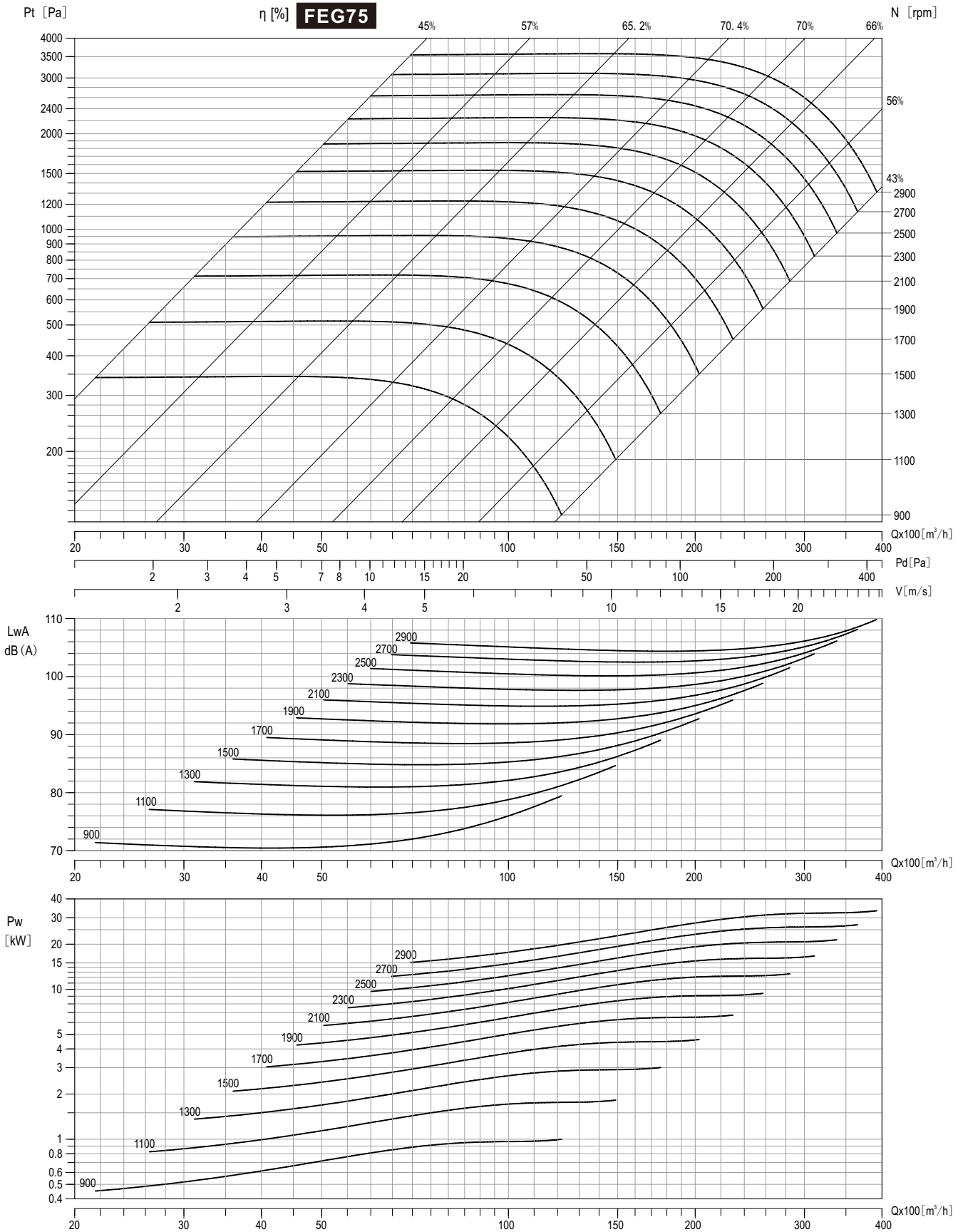

Performance certified is for installation type B-Free inlet, Ducted outlet. Performance ratings do not include the effects of appurtenances (accessories). Power rating kW does not include transmission losses. The A-weighted sound ratings shown have been calculated per AMCA International Standard 301. Values shown are for inlet LwiA sound power levels for Installation type B: free inlet, ducted outlet.



TDF560

Air Density: 1.2 kg/m³

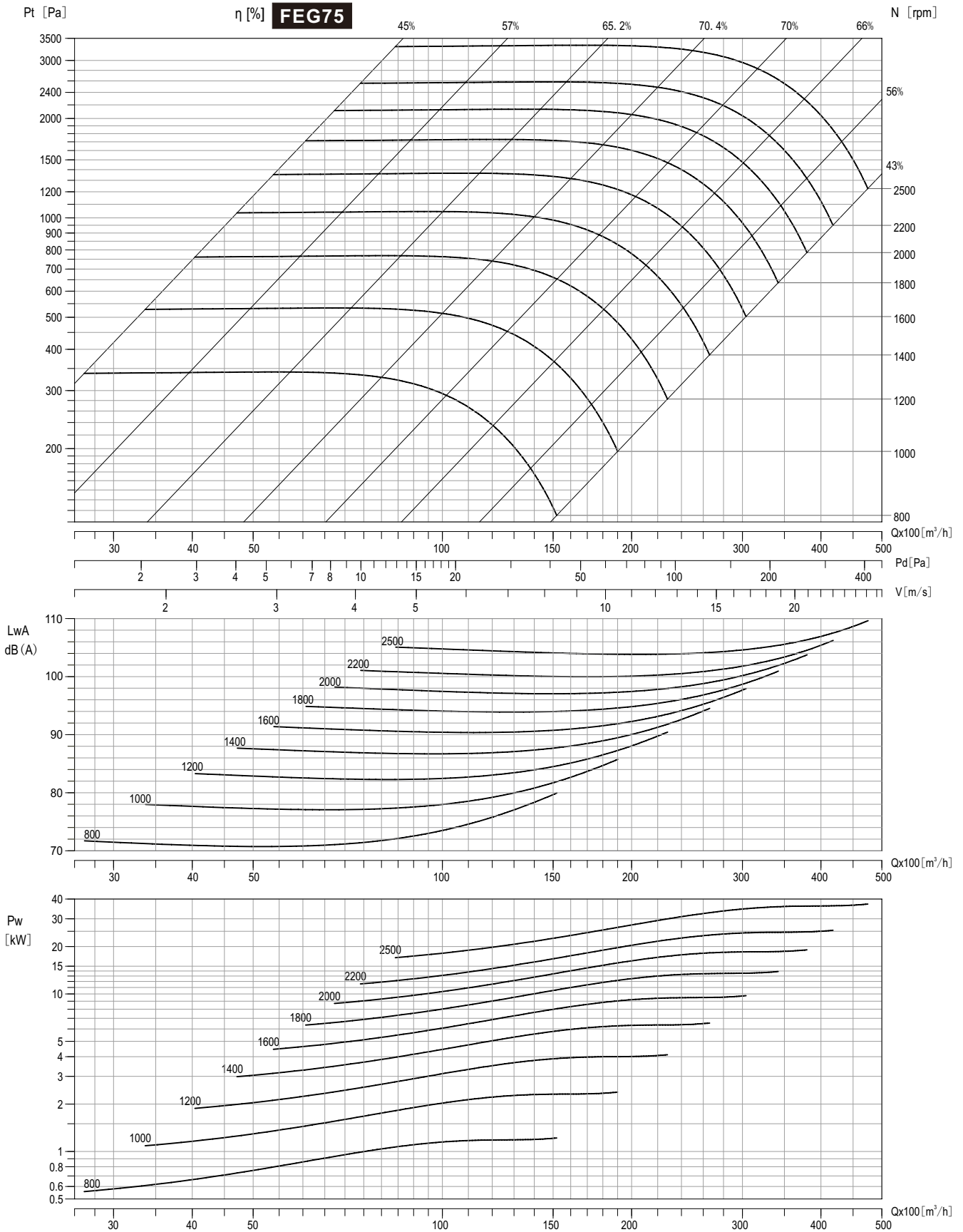

Performance certified is for installation type B-Free inlet, Ducted outlet. Performance ratings do not include the effects of appurtenances (accessories). Power rating kW does not include transmission losses. The A-weighted sound ratings shown have been calculated per AMCA International Standard 301. Values shown are for inlet LwiA sound power levels for Installation type B: free inlet, ducted outlet.

TDF630

Air Density: 1.2 kg/m³

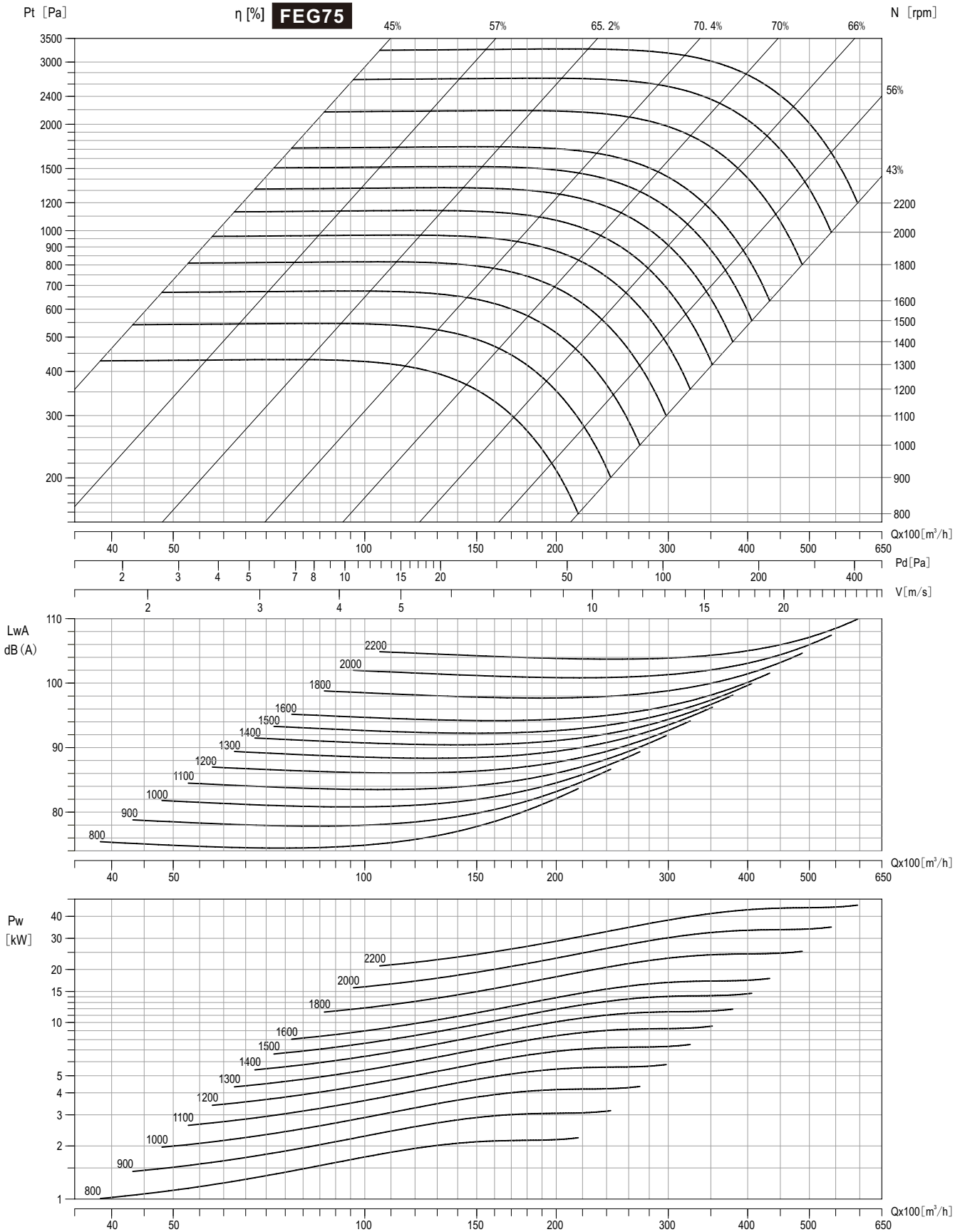

Performance certified is for installation type B-Free inlet, Ducted outlet. Performance ratings do not include the effects of appurtenances (accessories). Power rating kW does not include transmission losses. The A-weighted sound ratings shown have been calculated per AMCA International Standard 301. Values shown are for inlet LwiA sound power levels for Installation type B: free inlet, ducted outlet.



TDF710

Air Density: 1.2 kg/m³

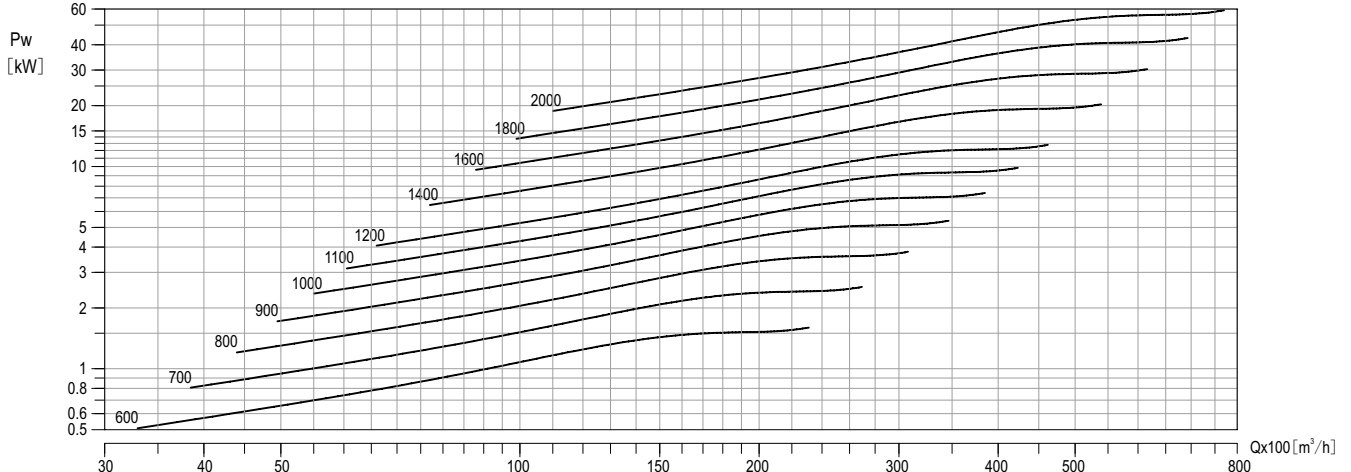
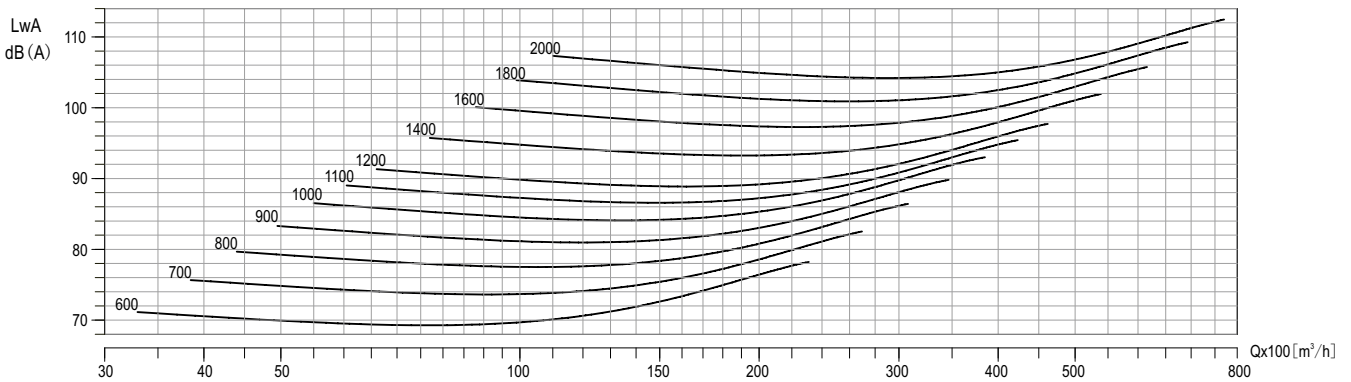
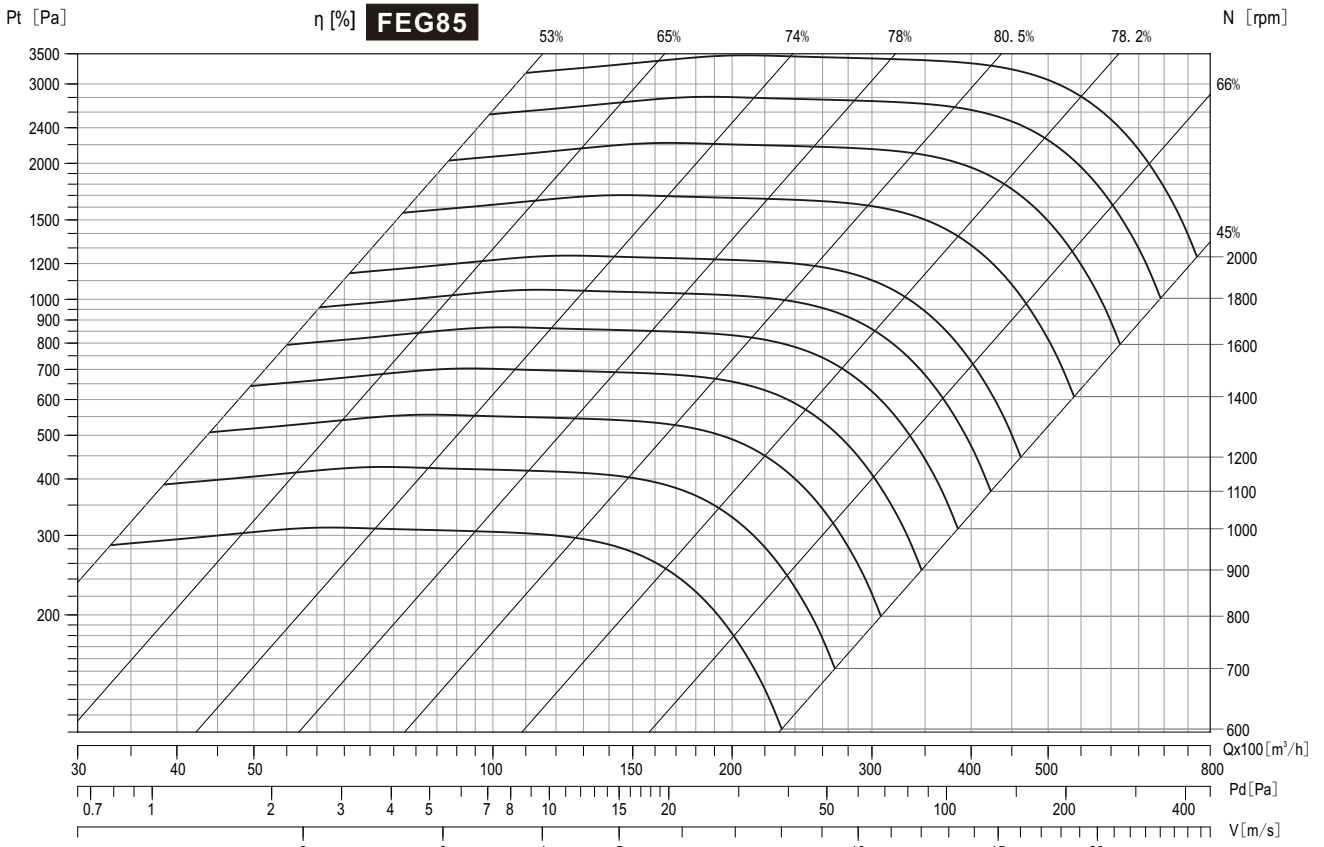

Performance certified is for installation type B-Free inlet, Ducted outlet. Performance ratings do not include the effects of appurtenances (accessories). Power rating kW does not include transmission losses. The A-weighted sound ratings shown have been calculated per AMCA International Standard 301. Values shown are for inlet LwiA sound power levels for Installation type B: free inlet, ducted outlet.

TDF800

Air Density: 1.2 kg/m³

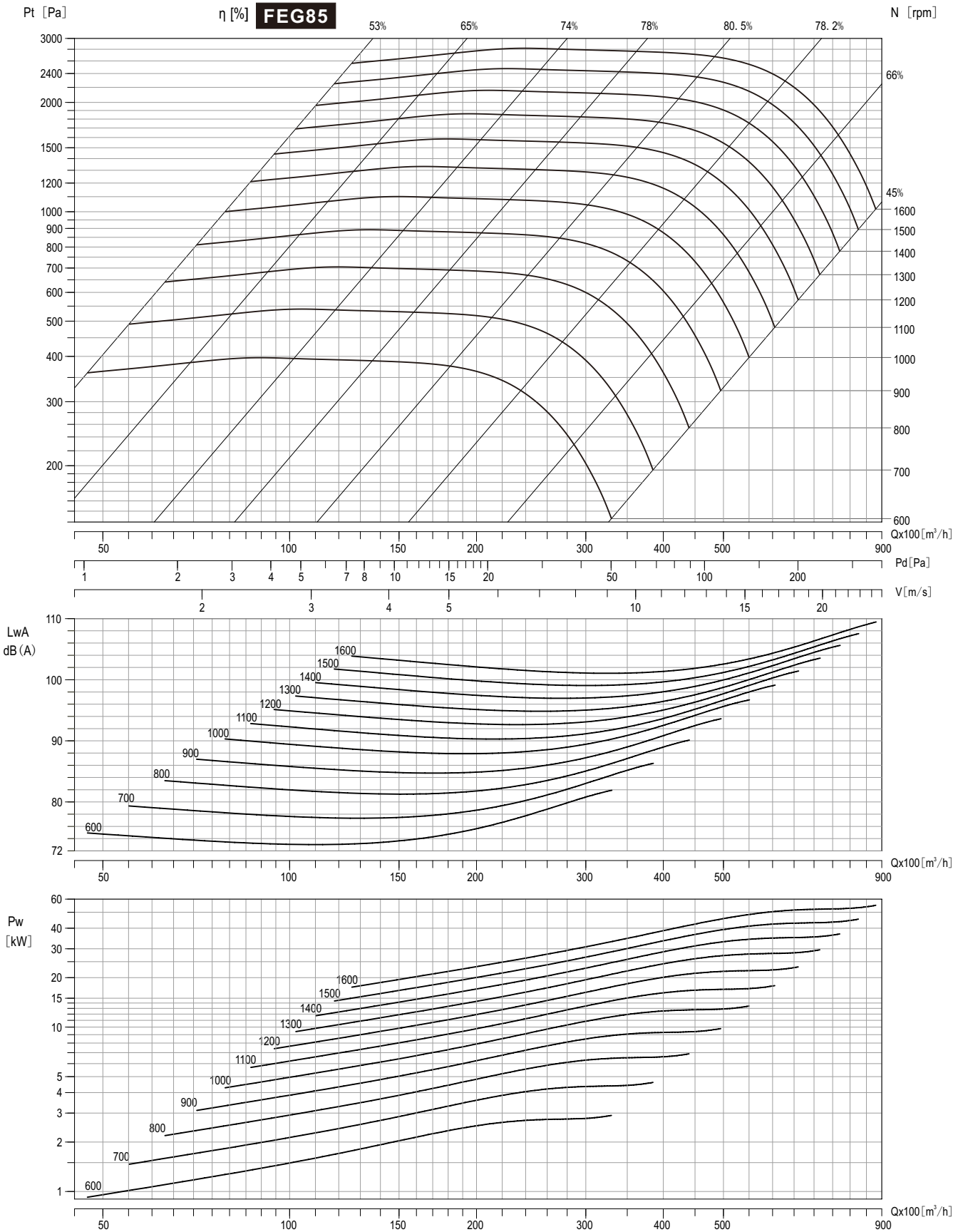

Performance certified is for installation type B-Free inlet, Ducted outlet. Performance ratings do not include the effects of appurtenances (accessories). Power rating kW does not include transmission losses. The A-weighted sound ratings shown have been calculated per AMCA International Standard 301. Values shown are for inlet LwiA sound power levels for Installation type B: free inlet, ducted outlet.



TDF900

Air Density: 1.2 kg/m³

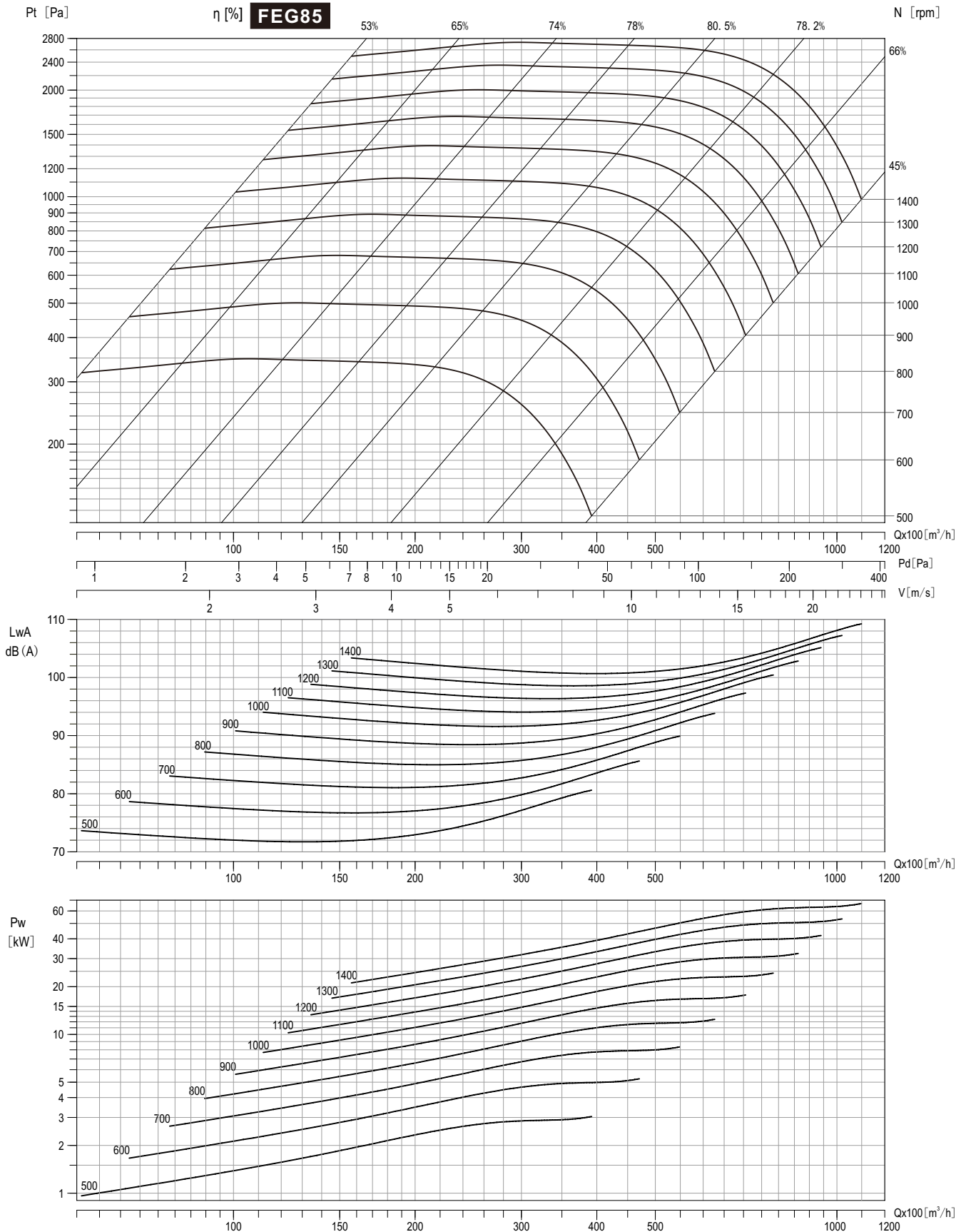

Performance certified is for installation type B-Free inlet, Ducted outlet. Performance ratings do not include the effects of appurtenances (accessories). Power rating kW does not include transmission losses. The A-weighted sound ratings shown have been calculated per AMCA International Standard 301. Values shown are for inlet LwiA sound power levels for Installation type B: free inlet, ducted outlet.

TDF1000

Air Density: 1.2 kg/m³

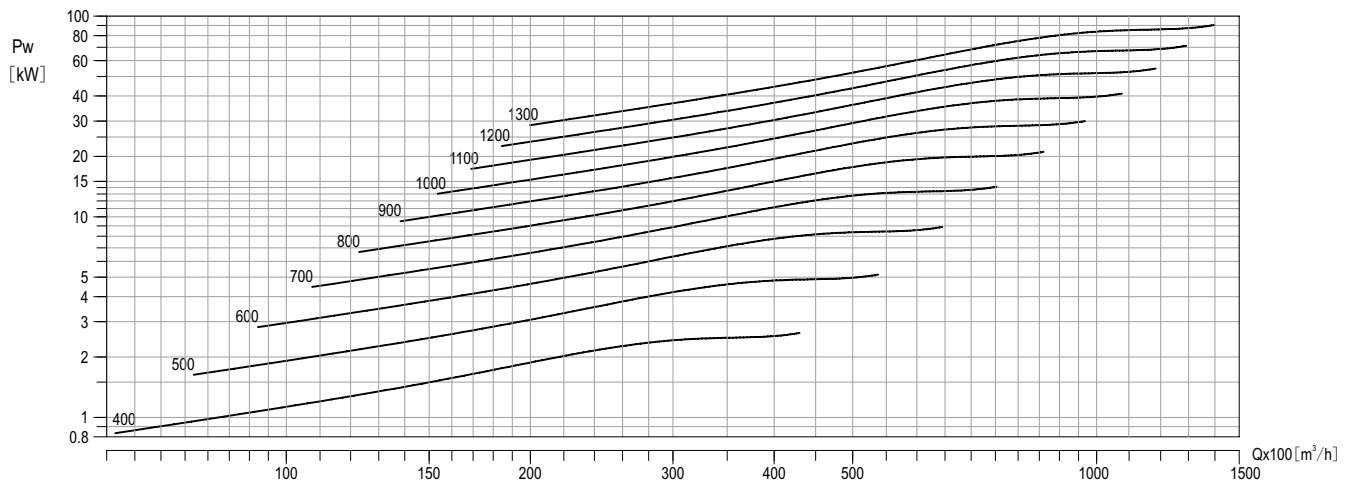
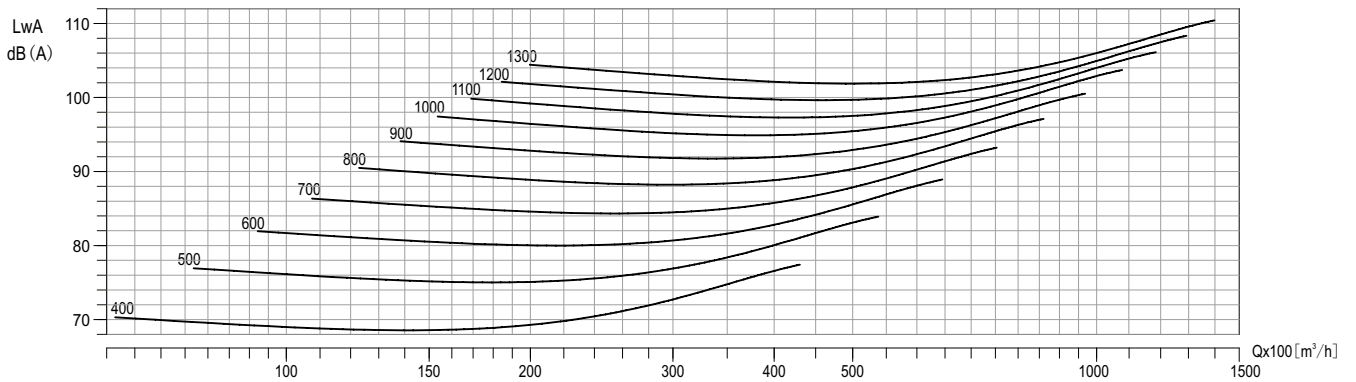
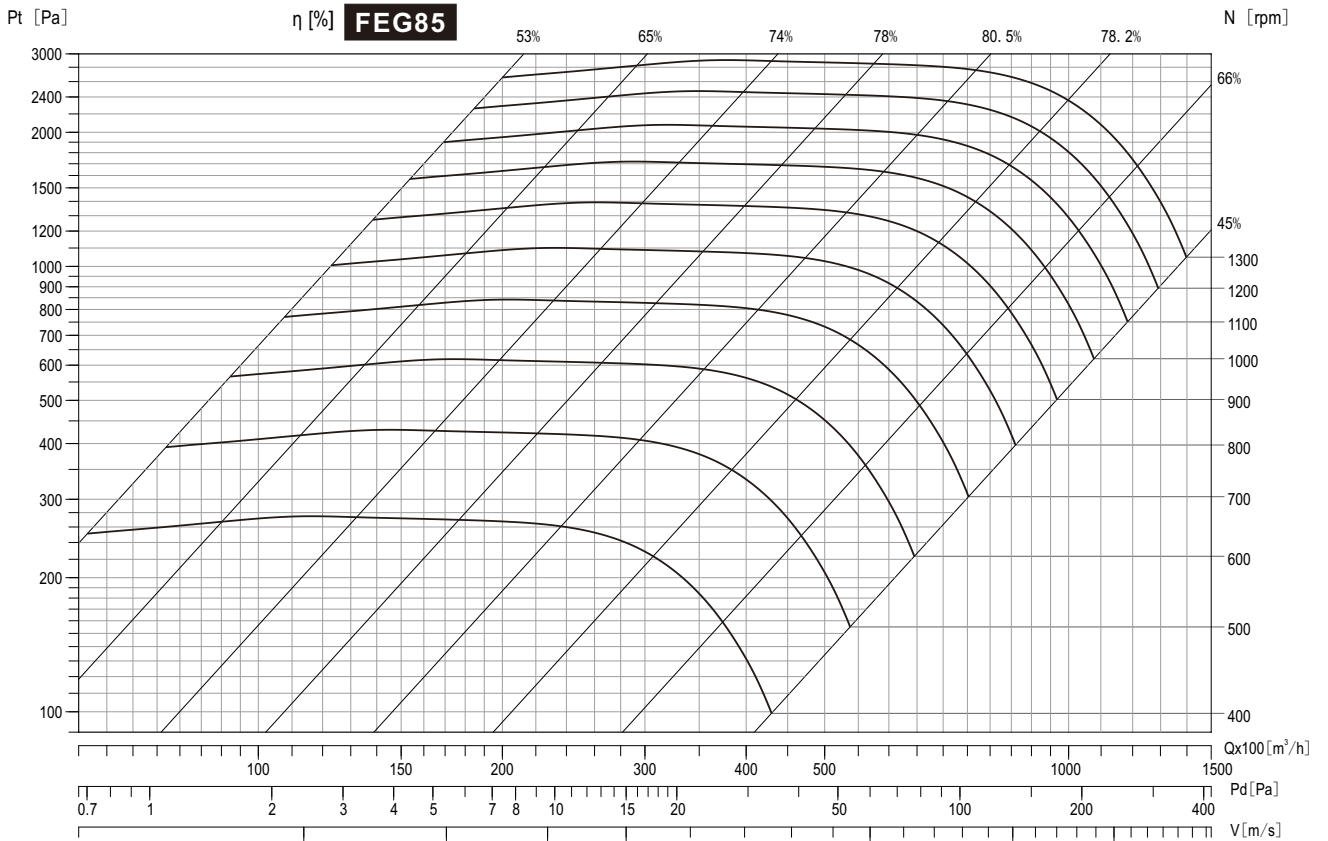

Performance certified is for installation type B-Free inlet, Ducted outlet. Performance ratings do not include the effects of appurtenances (accessories). Power rating kW does not include transmission losses. The A-weighted sound ratings shown have been calculated per AMCA International Standard 301. Values shown are for inlet LwiA sound power levels for Installation type B: free inlet, ducted outlet.

TDF -D Dimension

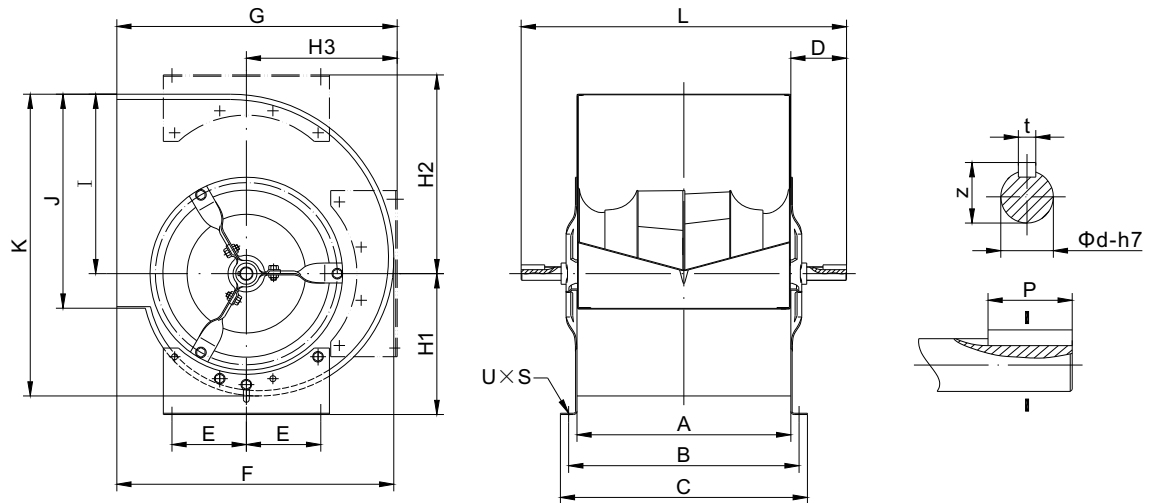

[mm]

ModeI	A	B	C	D	E	F	G	H1	H2	H3	I	J	K	L	ϕd	t	z	P	UXS
TDF200	256	281	306	82	224	306	348	181	245	184	215	256	364	420	20	6	22.8	40	11X16
TDF225	288	313	338	86	224	348	384	197	274	204	243	288	408	460	20	6	22.8	40	11X16
TDF250	322	347	372	84	224	384	422	212	299	227	270	322	454	490	20	6	22.8	40	11X16
TDF280	361	391	421	90	280	432	470	236	331	255	302	361	510	540	25	8	28.3	40	11X16
TDF315	404	434	464	98	280	480	519	261	370	283	340	404	572	600	25	8	28.3	40	11X16
TDF355	452	492	532	110	315	548	580	274	411	320	383	452	644	672	30	8	33.3	40	11X16
TDF400	506	546	586	93	110	612	649	302	462	359	432	506	724	726	30	8	33.3	40	11X16
TDF450	568	608	648	115	123	681	729	336	518	407	486	568	816	814	35	10	38.3	50	13X18

TDF -K Dimension

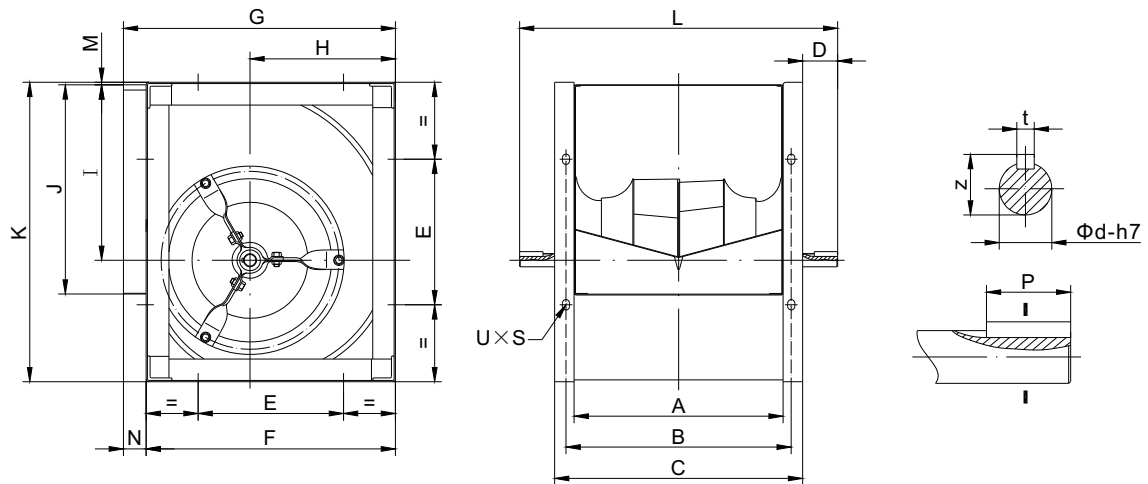

[mm]

ModeI	A	B	C	D	E	E1	F	G	H	I	J	K	L	M	N	ϕd	t	z	P	UXS
TDF200	256	281	316	52	224	/	306	343	179	215	256	370	420	4	37	20	6	22.8	40	11X16
TDF225	288	313	348	56	224	/	348	383	203	243	288	415	460	3	35	20	6	22.8	40	11X16
TDF250	322	347	382	54	224	/	384	419	224	270	322	461	490	4	35	20	6	22.8	40	11X16
TDF280	361	391	421	60	280	/	432	466	251	302	361	518	540	5	34	25	8	28.3	40	11X16
TDF315	404	434	464	68	280	/	480	518	282	340	404	578	600	3	38	25	8	28.3	40	13X18
TDF355	452	492	532	70	315	/	548	578	318	383	452	654	672	6	30	30	8	33.3	40	13X18
TDF400	506	546	586	70	355	/	612	650	360	432	506	736	726	5	38	30	8	33.3	40	13X18
TDF450	568	608	648	83	400	/	681	726	404	486	568	827	814	5	45	35	10	38.3	50	13X18

说明：所有尺寸允许偏差±4mm

Note: Overall dimension tolerance arange ±4mm .

TDF -HL Dimension

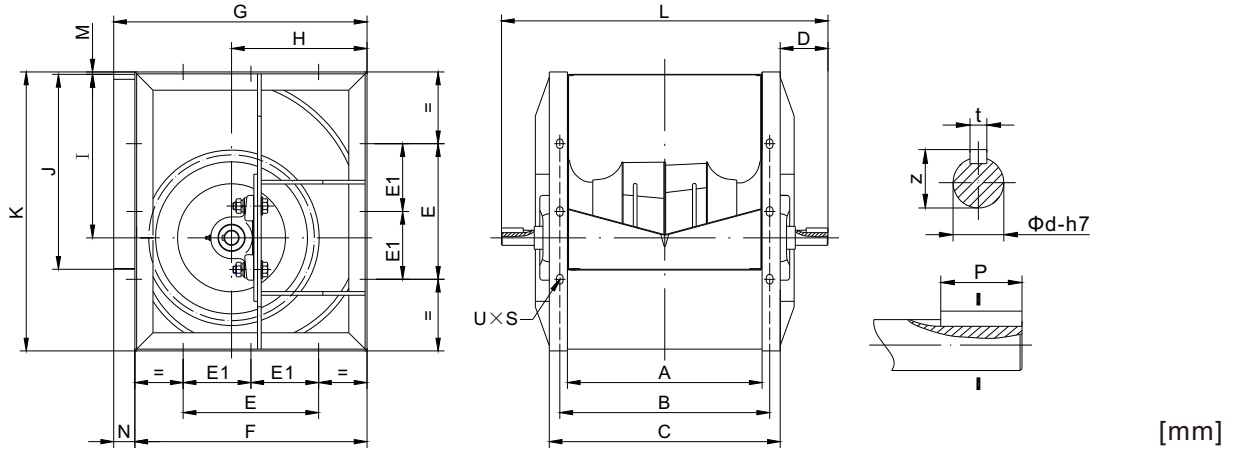

Model	A	B	C	D	E	E1	F	G	H	I	J	K	L	M	N	ϕd	t	z	P	UXS
TDF200	256	281	316	77	224		306	343	179	215	256	370	470	4	37	20	6	22.5	40	11X16
TDF225	288	313	348	81	224		348	383	203	243	288	415	510	3	35	25	8	28.3	40	11X16
TDF250	322	347	382	79	224		384	419	224	270	322	461	540	4	35	25	8	28.3	40	11X16
TDF280	361	391	421	77	280		432	466	251	302	361	518	575	5	34	25	8	28.3	40	11X16
TDF315	404	434	464	84	280		480	518	282	340	404	578	632	3	38	25	8	28.3	40	13X18
TDF355	452	492	532	84	315		548	578	318	383	452	654	700	6	30	30	8	33.3	40	13X18
TDF400	506	546	586	87	355		612	650	360	432	506	736	760	5	38	30	8	33.3	40	13X18
TDF450	568	608	648	98.5	400		681	726	404	486	568	827	845	5	45	35	10	38.3	50	13X18
TDF500	638	678	718	98.5	450		750	800	448	538	638	918	915	5	50	35	10	38.3	50	13X18
TDF560	714	764	814	93		250	844	892	502	603	714	1030	1000	7	48	40	12	43.3	70	13X18
TDF630	800	850	900	95		280	945	998	564	679	800	1157	1090	6	53	45	14	48.5	70	13X18
TDF710	898	948	998	129		315	1057	1120	636	765	898	1302	1255	7	63	50	14	53.5	90	17X22
TDF800	1006	1056	1106	141		355	1180	1254	714	862	1006	1468	1388	7	74	55	16	59	90	17X22
TDF900	1130	1180	1256	155		400	1319	1408	804	971	1130	1648	1566	7	89	60	18	64	90	17X22

TDF -HM Dimension

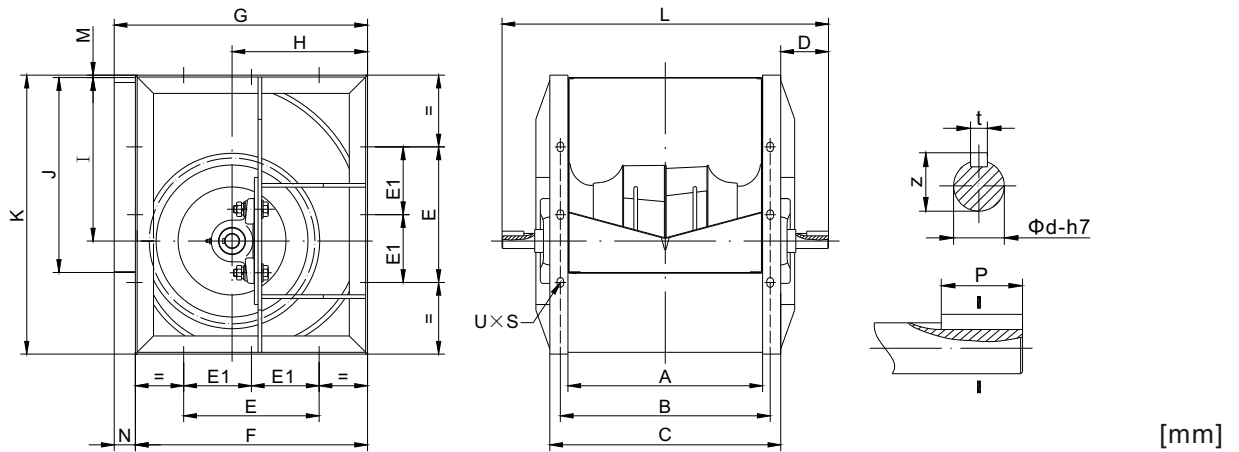

Model	A	B	C	D	E	E1	F	G	H	I	J	K	L	M	N	ϕd	t	z	P	UXS
TDF200	256	281	316	77	224		306	343	179	215	256	370	470	4	37	20	6	22.8	40	11X16
TDF225	288	313	348	81	224		348	383	203	243	288	415	510	3	35	25	8	28.3	40	11X16
TDF250	322	347	382	79	224		384	419	224	270	322	461	540	4	35	25	8	28.3	40	11X16
TDF280	361	391	421	77	280		432	466	251	302	361	518	575	5	34	25	8	28.3	40	11X16
TDF315	404	434	464	84	280		480	518	282	340	404	578	632	3	38	30	10	33.3	50	13X18
TDF355	452	492	532	93	315		548	578	318	383	452	654	718	6	30	35	10	38.3	50	13X18
TDF400	506	546	586	93	355		612	650	360	432	506	736	772	5	38	35	10	38.3	50	13X18
TDF450	568	608	648	115	400		681	726	404	486	568	827	878	5	45	40	12	43.3	70	13X18
TDF500	638	678	718	119	450		750	800	448	538	638	918	956	5	50	40	12	43.3	70	13X18
TDF560	714	764	814	128		250	844	892	502	603	714	1030	1070	7	48	45	14	48.3	70	13X18
TDF630	800	850	900	127.5		280	945	998	564	679	800	1157	1155	6	53	50	14	53.8	90	13X18
TDF710	898	948	998	141		315	1057	1120	636	765	888	1302	1280	7	63	55	16	59	90	17X22
TDF800	1006	1056	1106	141		355	1180	1254	714	862	996	1468	1388	7	74	55	16	59	90	17X22
TDF900	1130	1180	1256	155		400	1319	1408	804	971	1120	1648	1566	7	89	60	18	64	100	17X22
TDF1000	1266	1316	1392	213		450	1450	1540	884	1066	1256	1810	1818	9	90	65	18	69	100	17X22

说明：所有尺寸允许偏差±4mm

Note: Overall dimension tolerance arange ±4mm .

TDF -GM Dimension

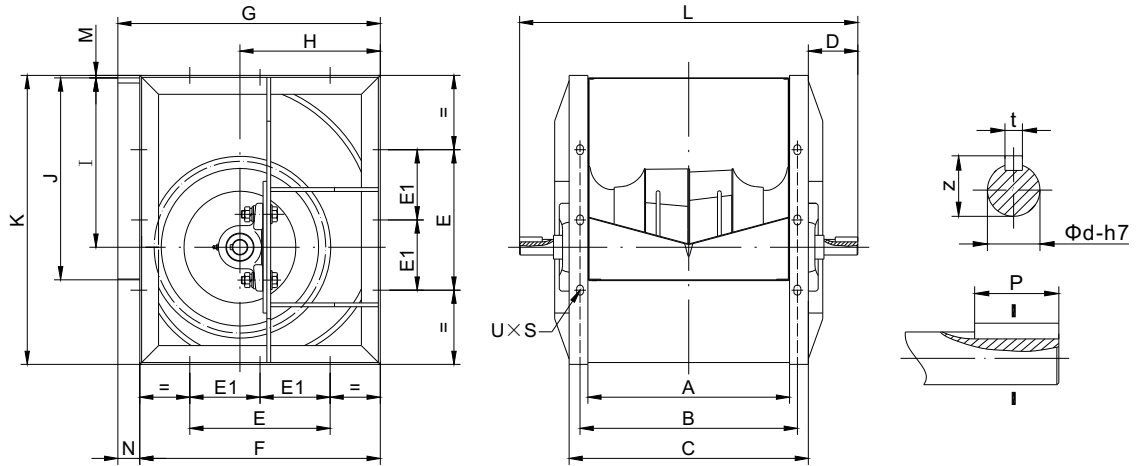

[mm]

Model	A	B	C	D	E	E1	F	G	H	I	J	K	L	M	N	ϕd	t	z	P	UXS
TDF500	638	678	718	171	450		750	800	448	538	638	918	1060	5	50	40	12	43.3	70	13X18
TDF560	714	764	814	173		250	844	892	502	603	714	1030	1160	7	48	50	14	53.8	70	13X18
TDF630	800	850	900	200		280	945	998	564	679	800	1157	1300	6	53	50	14	53.8	90	13X18
TDF710	898	948	998	217		315	1057	1120	636	765	888	1302	1432	7	63	60	18	64	90	17X22
TDF800	1006	1056	1106	217		355	1180	1254	714	862	996	1468	1540	7	74	60	18	64	90	17X22
TDF900	1130	1180	1256	208		400	1319	1408	804	971	1120	1648	1672	7	89	65	18	69	100	17X22
TDF1000	1266	1316	1392	213		450	1450	1540	884	1066	1256	1810	1818	9	90	65	18	69	100	17X22

说明：所有尺寸允许偏差 $\pm 4\text{mm}$

Note: Overall dimension tolerance arange $\pm 4\text{mm}$.

广东肇庆德通有限公司

Guangdong Zhaoqing Deton Company Ltd.

地址：广东省德庆县新圩镇榄树桥开发区
邮编：526600
公司网址：www.detonfan.com

销售部： e-mail: dtmarket@detonfan.com
Marketing dept. Tel: 0086-758-7731700 7732309 7732343
fax: 0086-758-7731245 7732583

出口部： e-mail: deton@detonfan.com
Export dept. Tel: 0086-758-7787212 7787650
fax: 0086-758-7787112

技术服务部： e-mail: rd@detonfan.com
Technology dept. Tel: 0086-758-7731817
fax: 0086-758-7732363-29

资料如有更改，恕不另行通知